

Existing Structure: Three span cast in place concrete deck bridge on steel stringers supported by concrete abutments and piers founded on timber piling. 24'-0" clear deck width, 84'-11" Bk.-Bk. abutments and steel railing. 20° Skew Exist. S.N. 009-3004

Benchmark: BM#1: 60D Nail and Washer in Power Pole. Sta. 311+78.4, 40.5' Rt. Elev. 490.30

Salvage: Steel beams to Cass County

Estimated Quantity to be Removed: Structural Steel - 30,000 Lbs
Concrete Structures - 43.3 Cu. Yds. (Substructure)
58.2 Cu. Yds. (Superstructure)

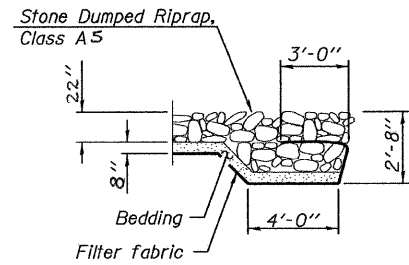
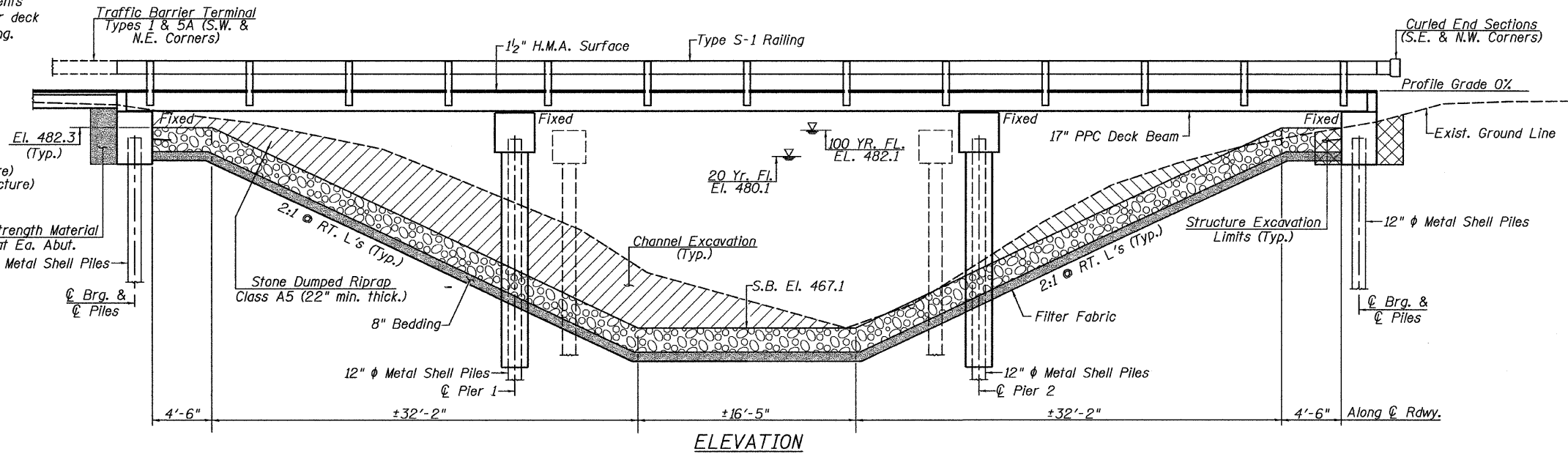

SECTION A-A

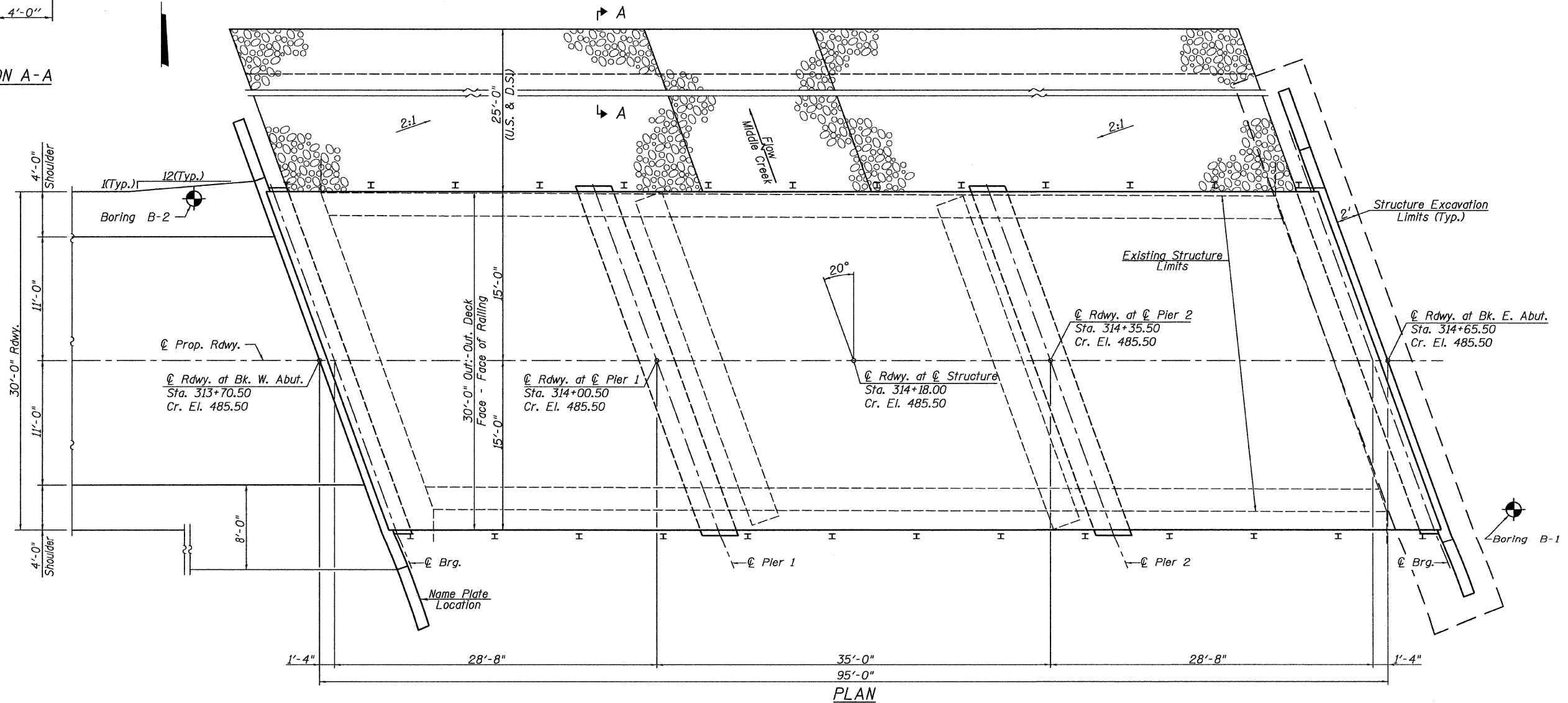

FILE NAME =	USER NAME = #USER#	DESIGNED -	REVISED -	<p>Allen Henderson & Associates, Inc. Civil and Structural Engineers Springfield, IL 62703 Phone: (217)544-8033 IL Design Firm No. 184-001907</p>	<p>GENERAL PLAN & ELEVATION</p> <p>SCALE: 1" = 10' SHEET NO. 5 OF 18 SHEETS STA. 313+70.50 TO STA. 314+65.50</p>	F.A.S. RTE.	SECTION	COUNTY	TOTAL SHEETS	SHEET NO.
#FILE#		DRAWN -	REVISED -			575	09-00074-00-BR	CASS	18	5
PLOT SCALE = #SCALE#		CHECKED -	REVISED -			CONTRACT NO. 93508				
PLOT DATE = #DATE#		DATE -	REVISED -			FED. ROAD DIST. NO. ILLINOIS FED. AID PROJECT				