

F.A.U. RTE.	SECTION	COUNTY	TOTAL SHEETS	SHEET NO.
7982	*	SANGAMON	68	28

STA.	TO STA.
FED. ROAD DIST. NO.	ILLINOIS FED. AID PROJECT
* 09-00447-03-PV	CITY OF SPRINGFIELD

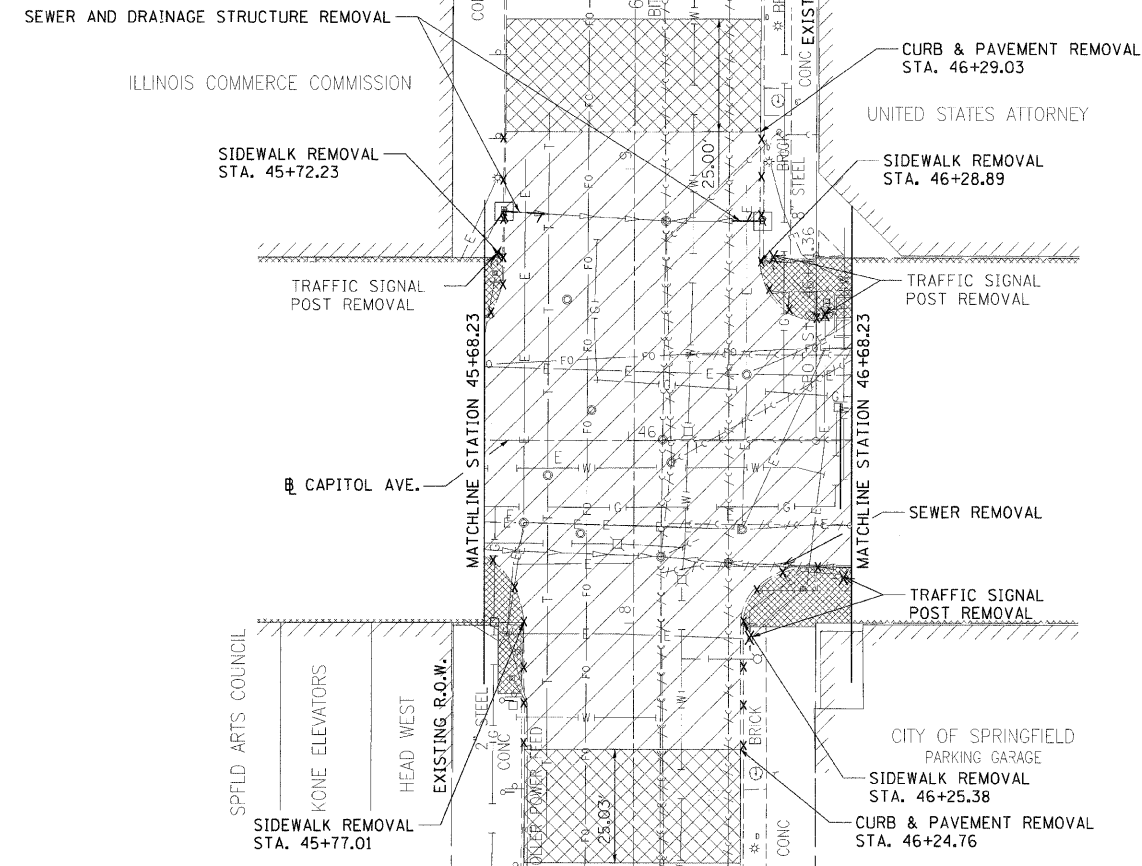

- LEGEND**
- CONCRETE SIDEWALK REMOVAL [diagonal hatching]
  - CURB & GUTTER REMOVAL [X X X X X X]
  - PAVEMENT REMOVAL [diagonal hatching]
  - BRICK SIDEWALK REMOVAL [diagonal hatching]
  - BITUMINOUS REMOVAL [diagonal hatching]
  - DRIVEWAY PAVEMENT REMOVAL [diagonal hatching]
  - BITUMINOUS MILLING [diagonal hatching]
  - TREE REMOVAL [X with slash]
  - TRAFFIC SIGNAL POST REMOVAL [star symbol]
  - SEWER REMOVAL [dashed line]
  - DRAINAGE STRUCTURE REMOVAL [R in box]
- \* NOTE: THESE ITEMS TO BE PAID FOR AS SPECIAL EXCAVATION (CU. YD.)

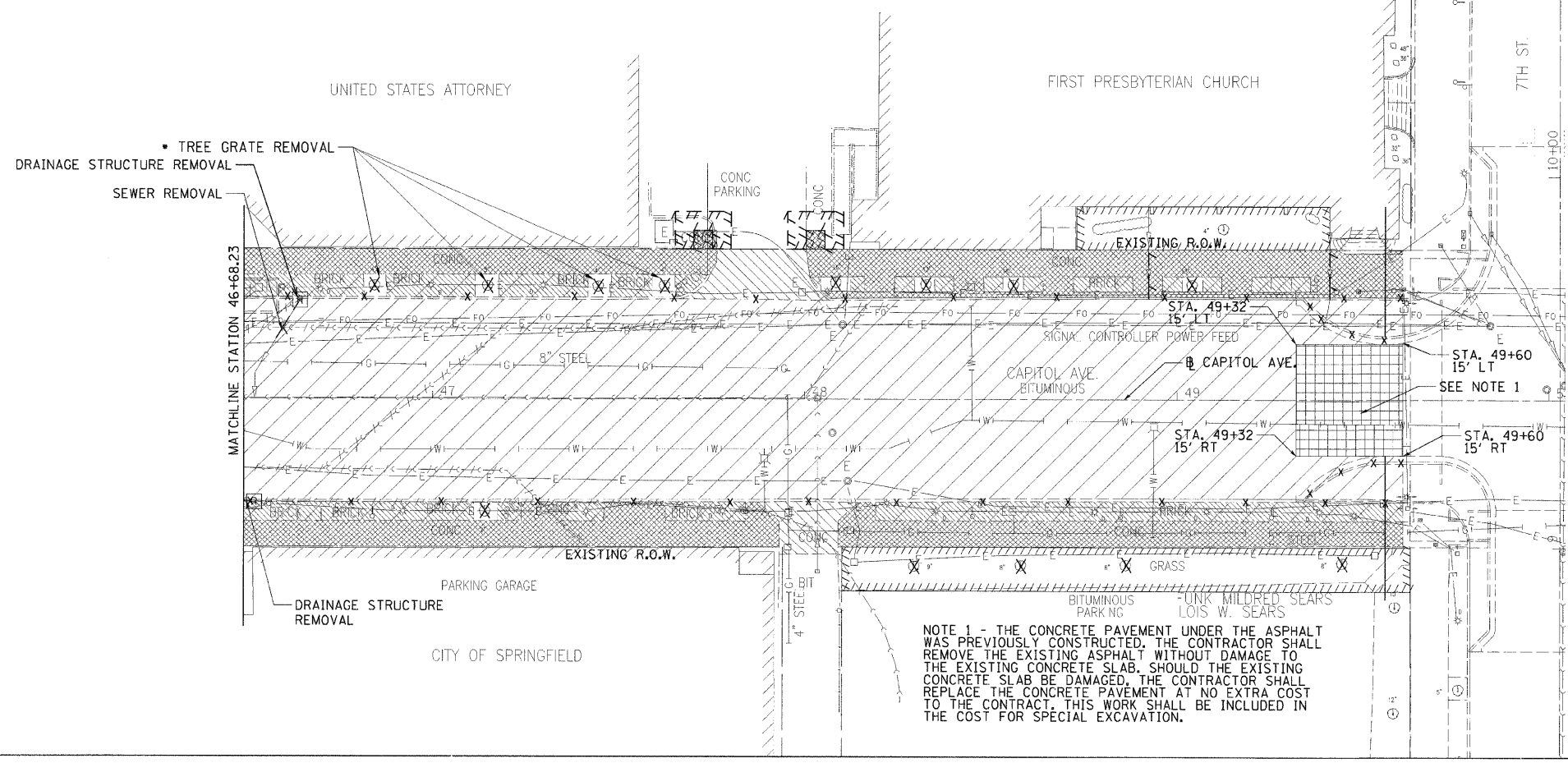
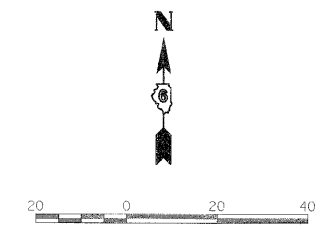

- LEGEND**
- CONCRETE SIDEWALK REMOVAL [diagonal hatching]
  - CURB & GUTTER REMOVAL [X X X X X X]
  - PAVEMENT REMOVAL [diagonal hatching]
  - BRICK SIDEWALK REMOVAL [diagonal hatching]
  - BITUMINOUS REMOVAL [diagonal hatching]
  - DRIVEWAY PAVEMENT REMOVAL [diagonal hatching]
  - BITUMINOUS MILLING [diagonal hatching]
  - TREE REMOVAL [X with slash]
  - TRAFFIC SIGNAL POST REMOVAL [star symbol]
  - SEWER REMOVAL [dashed line]
  - DRAINAGE STRUCTURE REMOVAL [R in box]
- \* NOTE: THESE ITEMS TO BE PAID FOR AS SPECIAL EXCAVATION (CU. YD.)

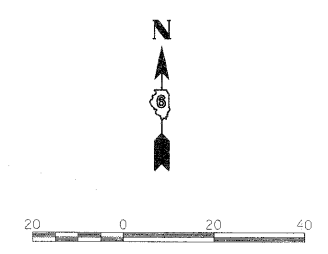

**NOTE 1** - THE CONCRETE PAVEMENT UNDER THE ASPHALT WAS PREVIOUSLY CONSTRUCTED. THE CONTRACTOR SHALL REMOVE THE EXISTING ASPHALT WITHOUT DAMAGE TO THE EXISTING CONCRETE SLAB. SHOULD THE EXISTING CONCRETE SLAB BE DAMAGED, THE CONTRACTOR SHALL REPLACE THE CONCRETE PAVEMENT AT NO EXTRA COST TO THE CONTRACT. THIS WORK SHALL BE INCLUDED IN THE COST FOR SPECIAL EXCAVATION.



PLDT DATE : 11/23/2009  
 FILE NAME : I:\02\Job\A2558114\CADD\Road\Microsoft\Sheet\Section\2.5th-7th-304-REF1.57.dgn  
 PLOT SCALE : 20' = 1" (AS SHOWN)  
 USER NAME : rhynd08151

LA OUT	J.L.A.	01/02/05
DRAWN	J.L.A.	01/02/05
REVIEWED	M.H.	09/19/07