

F.A.U. RTE.	SECTION	COUNTY	TOTAL SHEETS	SHEET NO.
7982	*	SANGAMON	68	33
STA.		TO STA.		
FED. ROAD DIST. NO.	ILLINOIS	FED. AID PROJECT		
* 09-00447-03-PV		CITY OF SPRINGFIELD		

THIS SHEET LEFT INTENTIONALLY BLANK

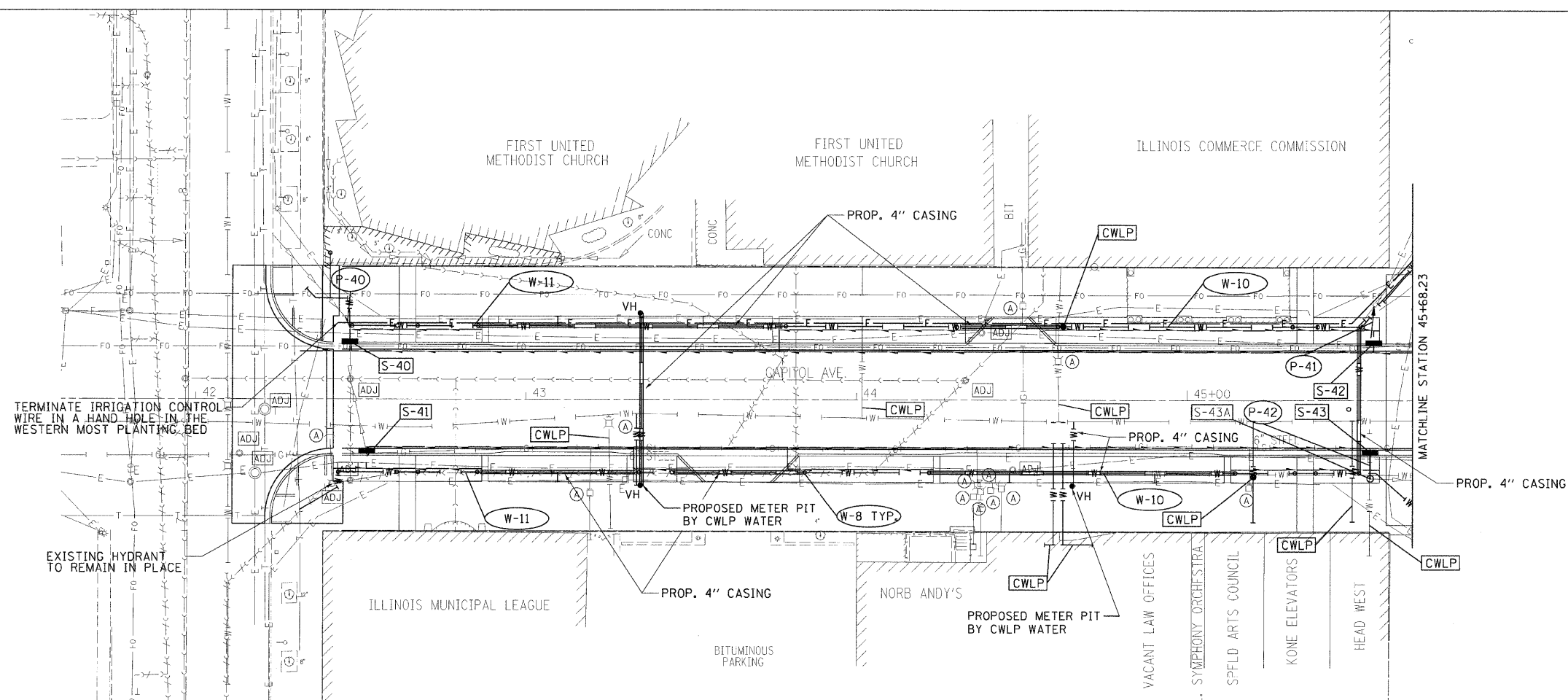

LAYOUT: R/A 03/14/01
 DRAWN: R/A 03/14/01
 REVIEWED: WH 09/19/01
 PLOT DATE: 11/23/2009
 FILE NAME: I:\02\p09\0252641\A\CADD\Road\Utility\station\Sheet\Spec\plan_2_5.sh-7.dwg-583.dwg_5-6.dwg
 PLOT SCALE: 25.0000 / 1"
 USER NAME: Hagan@SPC1



LEGEND

- PROPOSED STORM SEWER
- PROPOSED PIPE UNDERDRAIN
- PROPOSED INLET/CATCH BASIN
- PROPOSED MANHOLE
- PROPOSED PIPE CALLOUT
- PROPOSED STRUCTURE CALLOUT
- STRUCTURE TO BE ADJUSTED
- VALVE TO BE ADJUSTED
- JUNCTION BOX TO BE ADJUSTED
- PROPOSED IRRIGATION CALLOUT
- PROPOSED IRRIGATION LINE
- PROPOSED ELECTRICAL DUCT AND CABLE
- PROPOSED UTILITY WORK BY CWLP WATER DEPARTMENT
- PROPOSED VENDOR HYDRANT

