

F.A.U. RTE.	SECTION	COUNTY	TOTAL SHEETS	SHEET NO.
7982	*	SANGAMON	68	34
STA. TO STA.		ILLINOIS FED. AID PROJECT		
FED. ROAD DIST. NO.		* 09-00447-03-PV CITY OF SPRINGFIELD		

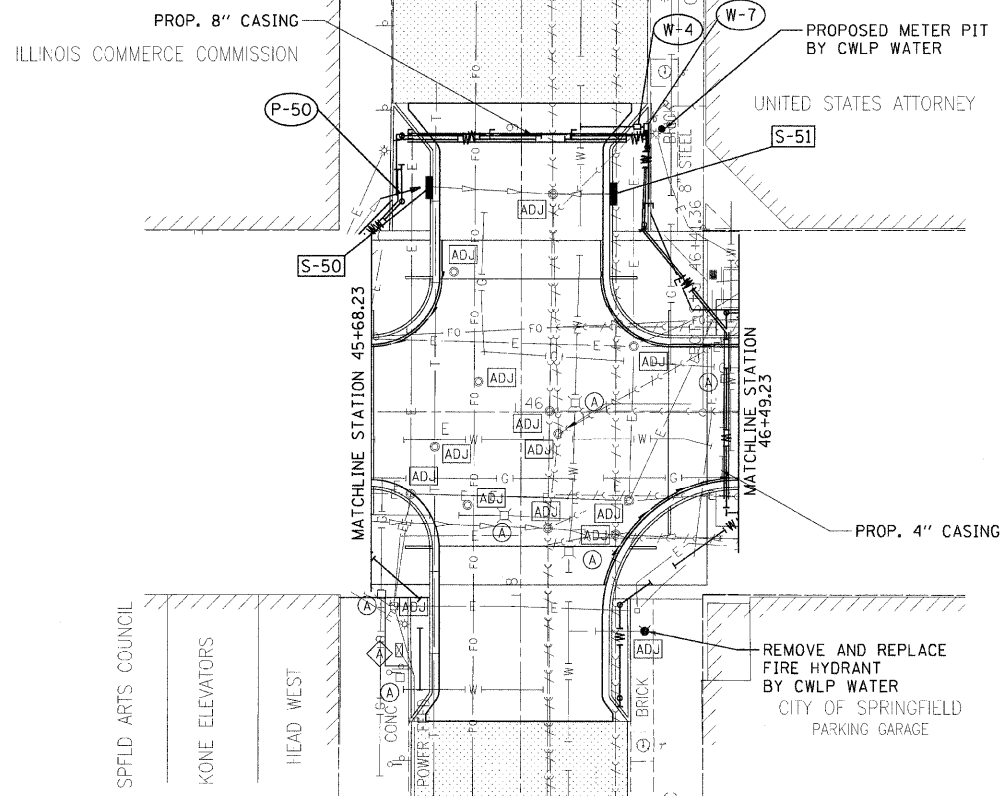

- LEGEND**
- PROPOSED STORM SEWER
  - PROPOSED PIPE UNDERDRAIN
  - PROPOSED INLET/CATCH BASIN
  - PROPOSED MANHOLE
  - PROPOSED PIPE CALLOUT (P-1)
  - PROPOSED STRUCTURE CALLOUT (S-1)
  - STRUCTURE TO BE ADJUSTED (ADJ)
  - VALVE TO BE ADJUSTED (A)
  - JUNCTION BOX TO BE ADJUSTED (A)
  - PROPOSED IRRIGATION CALLOUT (W-1)
  - PROPOSED IRRIGATION LINE
  - PROPOSED ELECTRICAL DUCT AND CABLE (E)
  - PROPOSED UTILITY WORK BY CWLP WATER DEPARTMENT (CWLP)
  - PROPOSED VENDOR HYDRANT (VH)

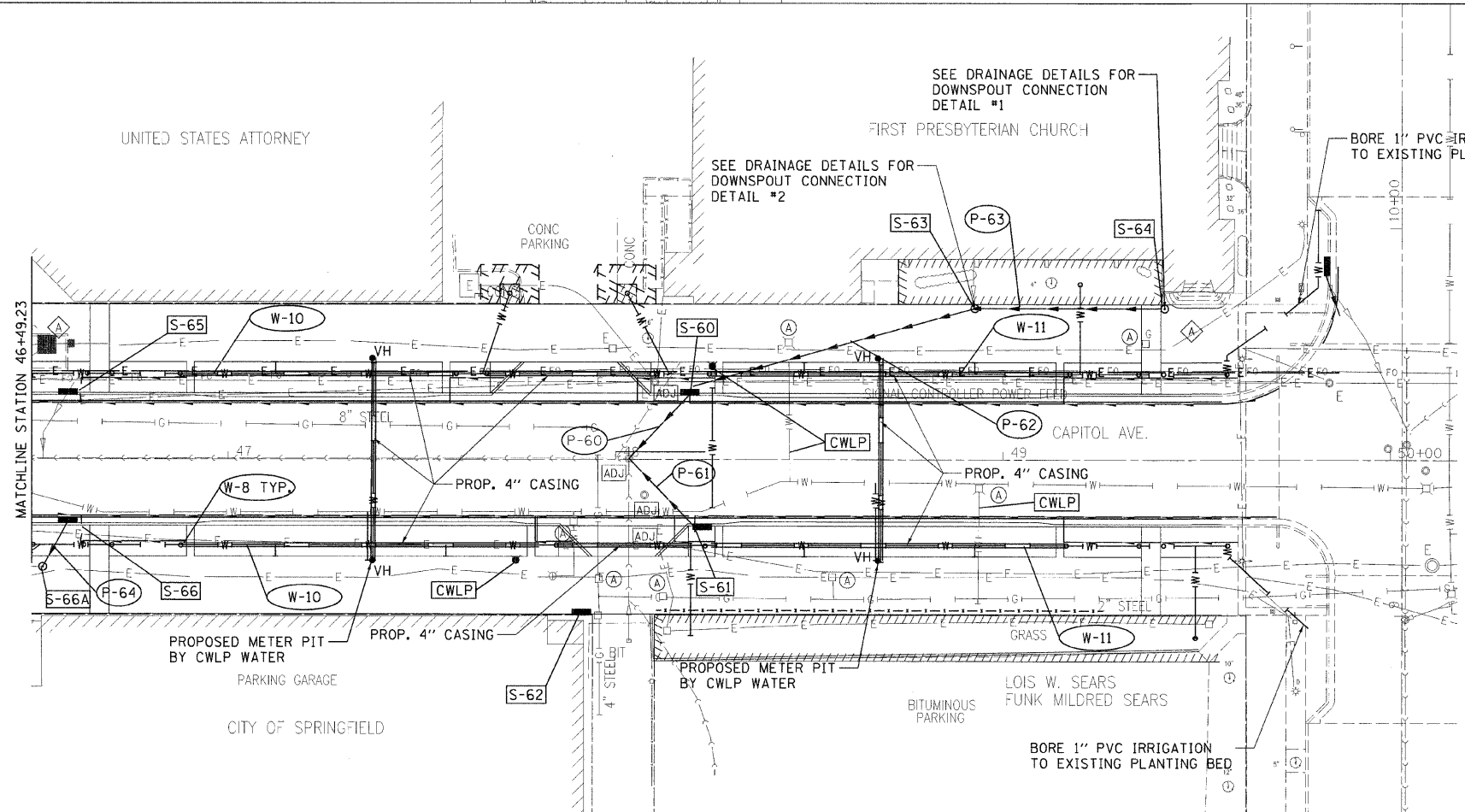

- LEGEND**
- PROPOSED STORM SEWER
  - PROPOSED PIPE UNDERDRAIN
  - PROPOSED INLET/CATCH BASIN
  - PROPOSED MANHOLE
  - PROPOSED PIPE CALLOUT (P-1)
  - PROPOSED STRUCTURE CALLOUT (S-1)
  - STRUCTURE TO BE ADJUSTED (ADJ)
  - VALVE TO BE ADJUSTED (A)
  - JUNCTION BOX TO BE ADJUSTED (A)
  - PROPOSED IRRIGATION CALLOUT (W-1)
  - PROPOSED IRRIGATION LINE
  - PROPOSED ELECTRICAL DUCT AND CABLE (E)
  - PROPOSED UTILITY WORK BY CWLP WATER DEPARTMENT (CWLP)
  - PROPOSED VENDOR HYDRANT (VH)



LAYOUT DATE: 11/23/2009  
 DRAWN DATE: 03/14/07  
 REVIEWED DATE: 09/19/07  
 FILE NAME: I:\02\jobs\02262841\ADD\Drawings\Utility\Sheet\Section\_2\_5.shp-7.dwg  
 PLOT SCALE: 26.26000 / in.  
 USER NAME: hanson