

ROUTE NO.	SECTION	COUNTY	TOTAL SHEETS	SHEET NO.
FAS 549	*	MACON	52	44
STA. 28+97.84		TO STA. 29+27.98		
FED. RD. DIST. NO. 7	ILLINOIS	PROJECT		

\*03-00184-00-BR

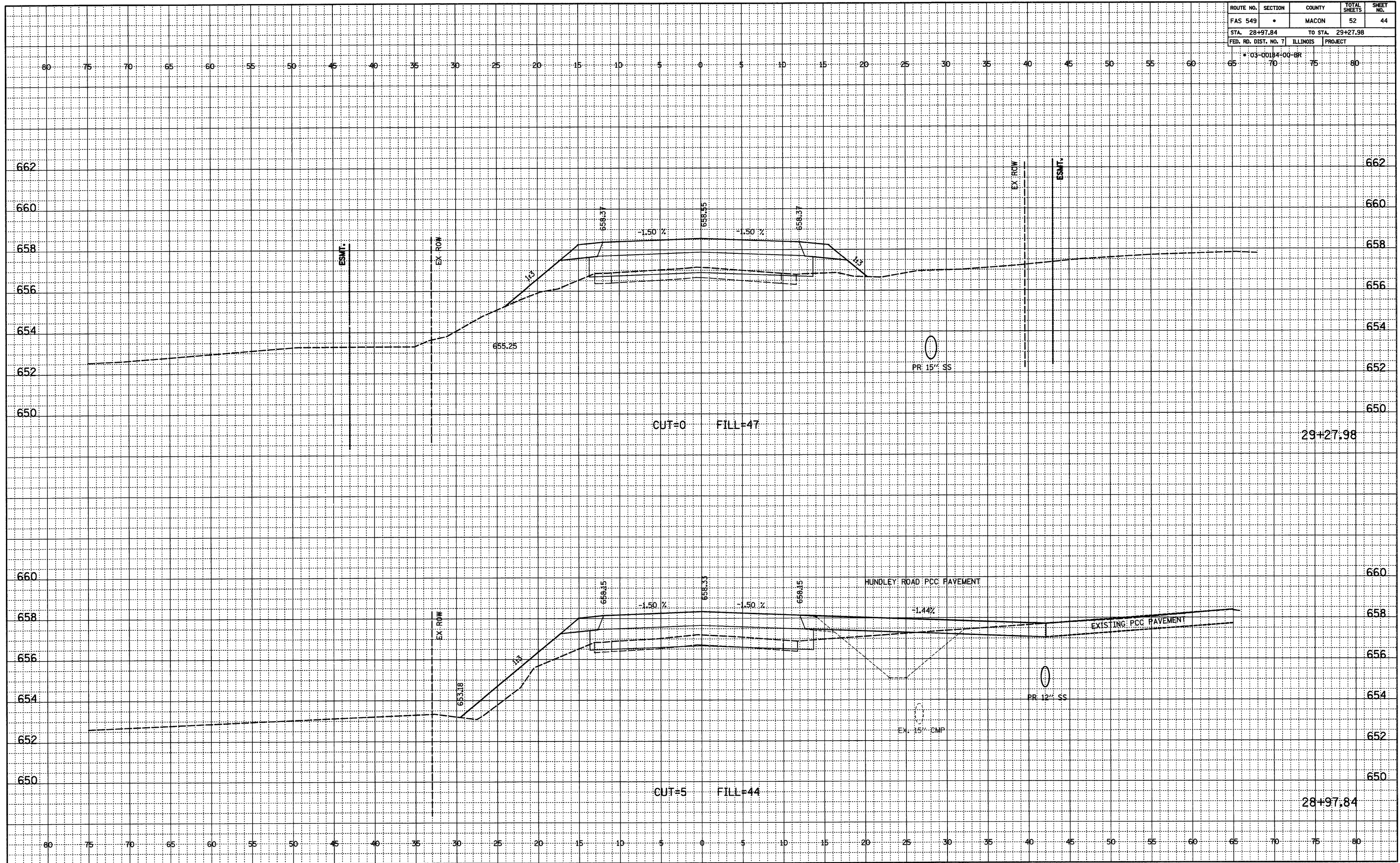

FINAL

NO.	DATE

SURVEYED  
 PLOTTED  
 ALIGNED CHECKED  
 RT. OF WAY CHECKED

ORIGINAL

NO.	DATE

SURVEYED  
 PLOTTED  
 GRADES CHECKED  
 SWS NOTED  
 STRUCTURE NOTATIONS OK'D