

BENCH MARKS

TRM5 - EL. 450.98
 Spike nail in PP, 3 trans on S. Side
 Division St., 150' W. of C.L. DuQuoin St.
 See Pg. 51 Bk. 581

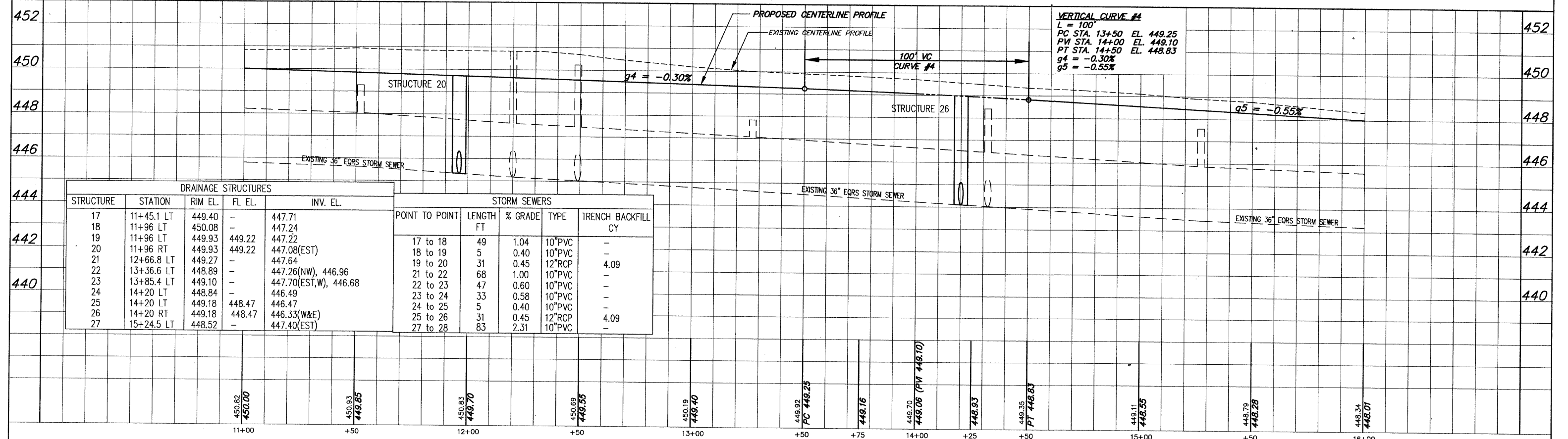

DRAINAGE STRUCTURES					STORM SEWERS			
STRUCTURE	STATION	RIM EL.	FL EL.	INV. EL.	POINT TO POINT	LENGTH FT	% GRADE	TRENCH BACKFILL CY
17	11+45.1 LT	449.40	-	447.71	17 to 18	49	1.04	10" PVC
18	11+96 LT	450.08	-	447.24	18 to 19	5	0.40	10" PVC
19	11+96 LT	449.93	449.22	447.22	19 to 20	31	0.45	12" RCP
20	11+96 RT	449.93	449.22	447.08(EST)	20 to 21	68	1.00	10" PVC
21	12+66.8 LT	449.27	-	447.64	21 to 22	47	0.60	10" PVC
22	13+36.6 LT	448.89	-	447.26(NW), 446.96	22 to 23	33	0.58	10" PVC
23	13+85.4 LT	449.10	-	447.70(EST,W), 446.68	23 to 24	5	0.40	10" PVC
24	14+20 LT	448.84	-	446.49	24 to 25	31	0.45	12" RCP
25	14+20 LT	449.18	448.47	446.47	25 to 26	83	2.31	10" PVC
26	14+20 RT	449.18	448.47	446.33(W&E)				
27	15+24.5 LT	448.52	-	447.40(EST)				