

ROUTE	SECTION	COUNTY	TOTAL SHEETS	SHEET NO.
F.A.U. 9452	08-00059-00-RP	FRANKLIN	39	15
NORTH DuQUOIN ST.			CONTRACT NO. 99396	

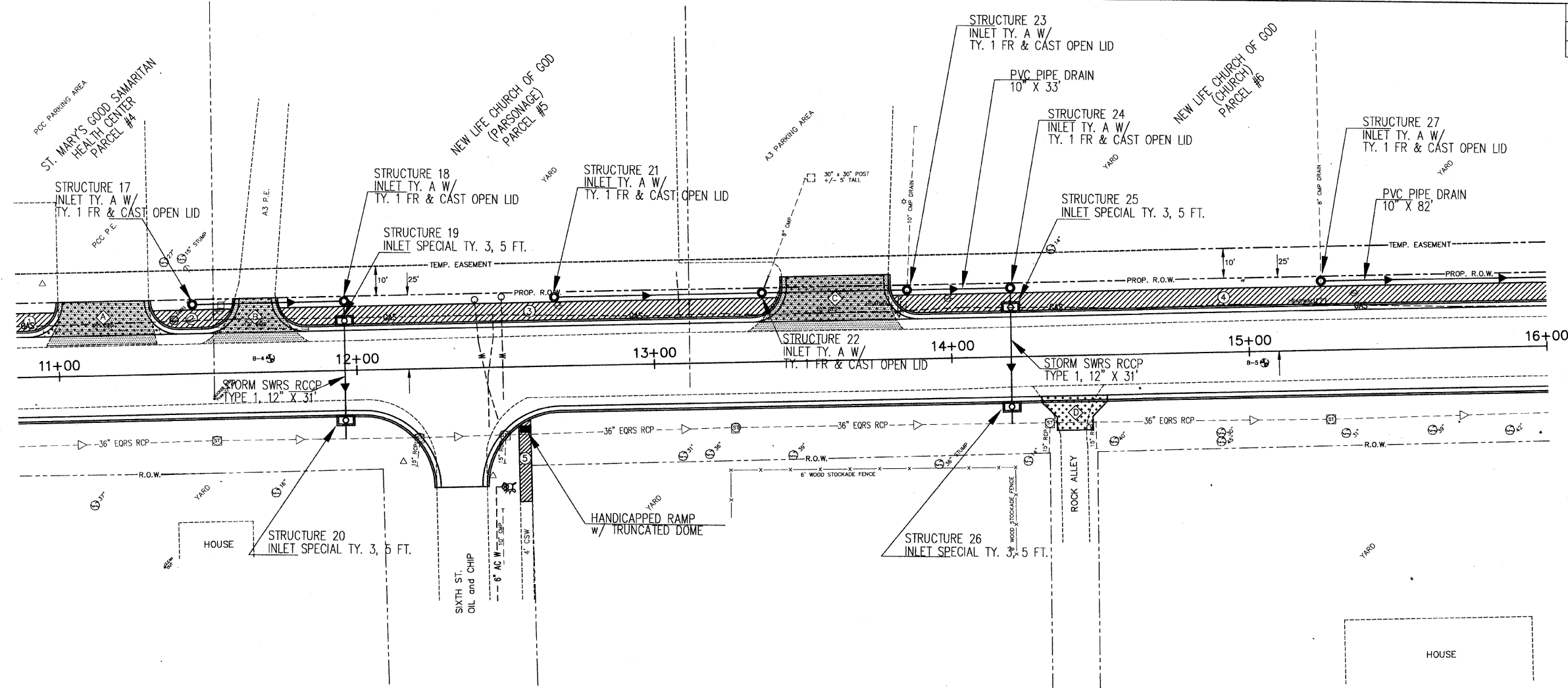

BLR 10-6 P.C.C. PAVEMENT SPECIAL, 8"		SUB-BASE --- GRANULAR MATERIAL, TYPE A, 4"		LOCATION	P.C. CONCRETE SIDEWALK 4"	LOCATION	DRIVEWAY PAVEMENT TO BE REMOVED	P.C. CONCRETE DRIVEWAY PAVEMENT, 6"
STATION TO STATION	SQ. YDS.	STATION TO STATION	SQ. YDS.		SQ. FT.		SQ. YDS.	SQ. YDS.
10+85 - 16+00	1,619.62	10+85 - 16+00	1,871.50	①	62.20	Ⓐ	54.47	41.45
SHEET TOTAL	1,619.62	SHEET TOTAL	1,871.50	②	129.97	Ⓑ	35.76	20.09
PAVEMENT REMOVAL		COMB. CONCRETE CURB & GUTTER TYPE B6.18		③	959.86	Ⓒ	83.44	61.53
STATION TO STATION	SQ. YDS.	STATION TO STATION	FT.	④	1285.64	Ⓓ	25.02	20.42
10+85 - 16+00	1,246.68	10+85 - 16+00	1,046.27	⑤	106.11			
SHEET TOTAL	1,246.68	SHEET TOTAL	1,046.27	TOTAL	2,543.78	SHT. TOTAL	198.69	143.49

TREE REMOVAL 6 INCH TO 15 INCH	
STATION	IN. DIA.
11+38.92, 18.1'LT	9" TWIN
SHEET TOTAL	18"

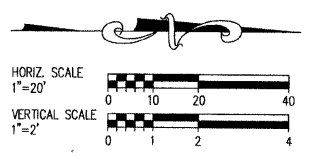