

STATE OF ILLINOIS
DEPARTMENT OF TRANSPORTATION

FAS/P. RTE.	SECTION	COUNTY	TOTAL SHEETS	SHEET NO.
169/603	{121,122,123}RS-2&1	LASALLE	27*	1
ILLINOIS			CONTRACT NO. 66B07	

* 27 + 1 = 28 TOTAL SHEETS (012A-a)

D-93-055-011

INDEX OF SHEETS

- 1 COVER SHEET
- 2 GENERAL NOTES
- 3-8 SUMMARY OF QUANTITIES
- 9-10 TYPICAL SECTIONS
- 11 PERMANENT SURVEY MARKERS TABLE
- 12-15 SCHEDULE OF QUANTITIES
- 16 LINE DIAGRAM
- 17-24 DETAILS
- 25-27 CULVERT DETAILS

LIST OF ILLINOIS DOT HIGHWAY STANDARDS

- 000001-0B STANDARD SYMBOLS, ABBREVIATIONS AND PATTERNS
- 001006 DECIMAL OF AN INCH AND OF A FOOT
- 406201-01 MAILBOX TURNOUT
- 442201-03 CLASS C AND D PATCHES
- 542011-02 CONCRETE END SECTIONS FOR ELLIPTICAL PIPE CULVERTS 15" (375mm) THRU 72" (1800 mm) EQUIVALENT DIAMETER
- 542301-03 PRECAST REINFORCED CONCRETE FLARED END SECTION
- 630001-12 STEEL PLATE BEAM GUARDRAIL
- 630106-02 LONG-SPAN GUARDRAIL OVER CULVERT
- 630201-07 PCC/HMA STABILIZATION AT STEEL PLATE BEAM GUARDRAIL
- 630301-09 SHOULDER WIDENING FOR TYPE 1 (SPECIAL) GUARDRAIL TERMINALS
- 631006-08 TRAFFIC BARRIER TERMINAL, TYPE 1B
- 667101-02 PERMANENT SURVEY MARKERS
- 701011-04 OFF-ROAD MOVING OPERATIONS 2L, 2W, DAY ONLY
- 701201-05 LANE CLOSURE, 2L, 2W, DAY ONLY, FOR SPEEDS ≥ 45 MPH
- 701306-04 LANE CLOSURE, 2L, 2W, SLOW MOVING OPERATIONS DAY ONLY, FOR SPEEDS ≥ 45 MPH
- 701311-03 LANE CLOSURE, 2L, 2W, MOVING OPERATIONS - DAY ONLY
- 701901-08 TRAFFIC CONTROL DEVICES
- 725001-01 OBJECT AND TERMINAL MARKERS
- 780001-05 TYPICAL PAVEMENT MARKINGS
- 781001-04 TYPICAL APPLICATIONS RAISED REFLECTIVE PAVEMENT MARKERS
- 782006-01 GUARDRAIL AND BARRIER WALL REFLECTOR MOUNTING DETAILS

PROPOSED HIGHWAY PLANS

FAS ROUTE 169 (US 52) & FAP ROUTE 603 (IL 23) SECTION (121,122,123)RS-2&1 PROJECT STP-R9MH(237) 3P MILLING & RESURFACING (DESIGNED OVERLAY) LASALLE COUNTY

C-93-063-11

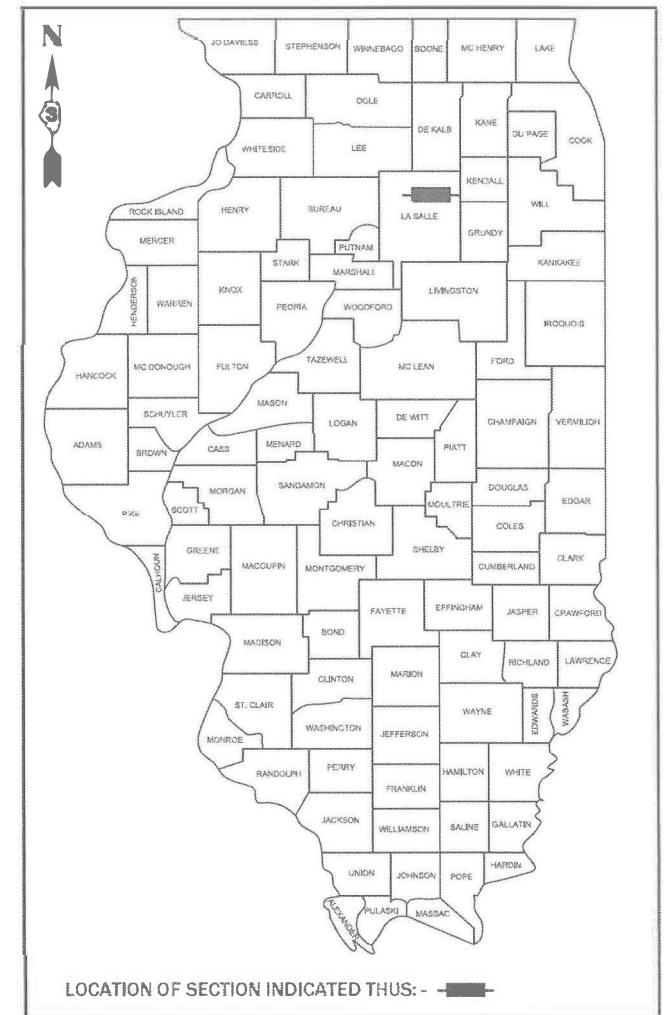

OMISSION
SN 050-0171
STA 226+32.21
TO 228+91.21

PROJECT BEGINS
STA 225+32

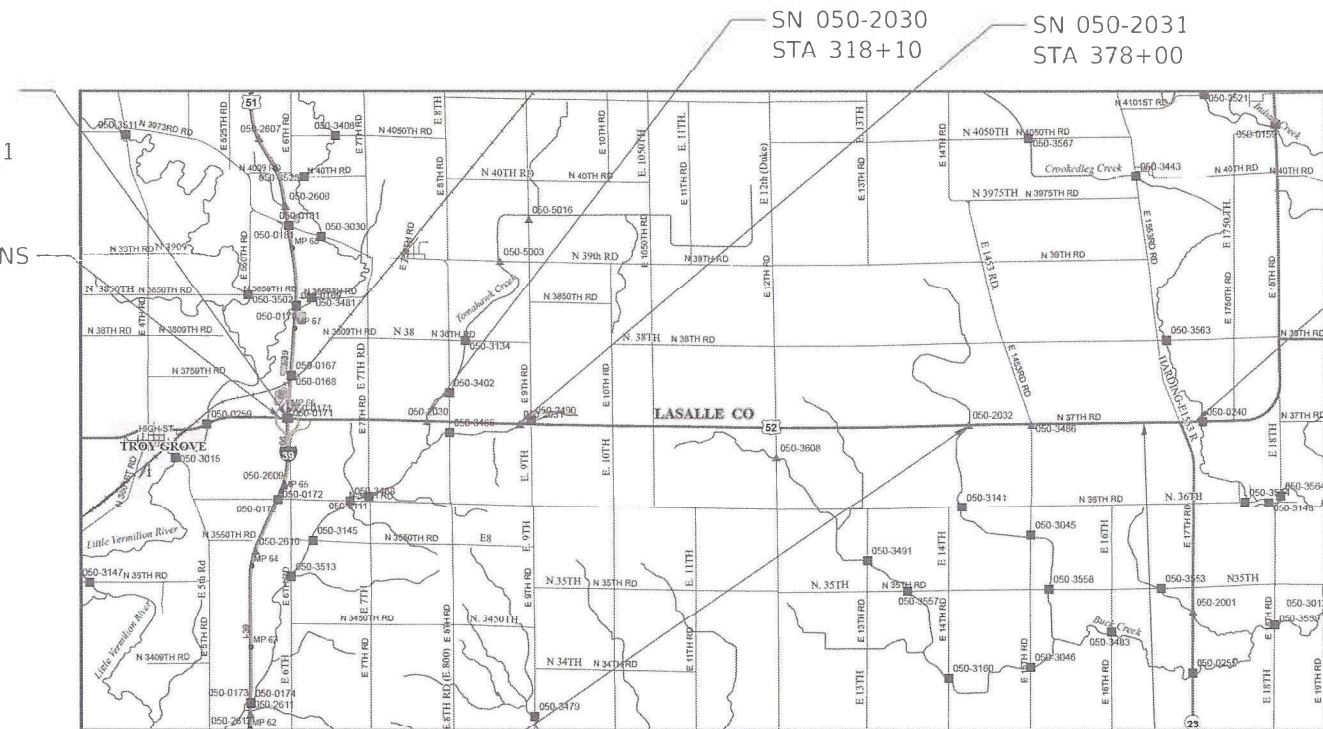

PROJECT ENDS
STA 415+50

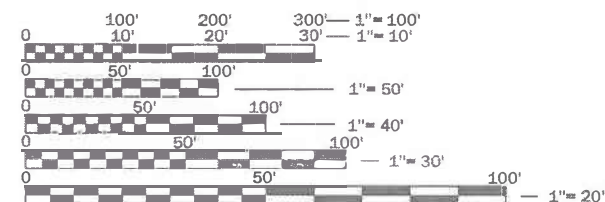

FULL SIZE PLANS HAVE BEEN PREPARED USING STANDARD ENGINEERING SCALES. REDUCED SIZED PLANS WILL NOT CONFORM TO STANDARD SCALES. IN MAKING MEASUREMENTS ON REDUCED PLANS, THE ABOVE SCALES MAY BE USED.

J.U.L.I.E.
JOINT UTILITY LOCATION INFORMATION FOR EXCAVATION
1-800-892-0123
OR 811

SN 050-2032
STA 669+40

STATION EQUATION:
795+36=394+00

GROSS LENGTH = 59,387 FT. = 11.25 MILE
NET LENGTH = 59,387 FT. = 11.25 MILE

PROJECT ENGINEER JACOB OYIER, PE
UNIT CHIEF STEPHENIE CARMIN
DISTRICT 3 NO. (815) 434-6131
CONTRACT NO. 66B07

FUNCTIONAL CLASSIFICATION
RURAL MINOR ARTERIAL
2019 ADT = 1200
P.V. = 73% S.U. = 4% M.U. = 23%

STATE OF ILLINOIS
DEPARTMENT OF TRANSPORTATION

SUBMITTED December 11, 2020

[Signature]
REGIONAL ENGINEER

January 29, 2021

[Signature]
ENGINEER OF DESIGN AND ENVIRONMENT

January 29, 2021

[Signature]
DIRECTOR OF HIGHWAYS PROJECT IMPLEMENTATION

**PRINTED BY THE AUTHORITY
OF THE STATE OF ILLINOIS**

CODE NO.	ITEM	UNIT	URBAN		CONSTR. CODE
			TOTAL QUANTITY	FUND TYPE	
				FEDERAL	
				ROADWAY	
		0005			
		RURAL			
20200100	EARTH EXCAVATION	CU YD	600	600	
20300100	CHANNEL EXCAVATION	CU YD	92.2	92.2	
20400800	FURNISHED EXCAVATION	CU YD	19.5	19.5	①
20800150	TRENCH BACKFILL	CU YD	42.5	42.5	
21400100	GRADING AND SHAPING DITCHES	FOOT	2000	2000	
28100707	STONE DUMPED RIPRAP, CLASS A4	SQ YD	106	106	①
40600290	BITUMINOUS MATERIALS (TACK COAT)	POUND	137,186	137,186	
40600400	MIXTURE FOR CRACKS, JOINTS, AND FLANGEWAYS	TON	60	60	
40600900	HOT-MIX ASPHALT BINDER COURSE (HAND METHOD), N50	TON	100	100	
40600990	TEMPORARY RAMP	SQ YD	918	918	①
40602978	HOT-MIX ASPHALT BINDER COURSE, IL- 9.5, N50	TON	22,505	22,505	
40604050	HOT-MIX ASPHALT SURFACE COURSE, IL-9.5, MIX "C", N50	TON	19,693	19,693	
40800050	INCIDENTAL HOT-MIX ASPHALT SURFACING	TON	523	523	
44000164	HOT-MIX ASPHALT SURFACE REMOVAL, 3 3/4"	SQ YD	200,949	200,949	

MODEL: Default
 FILE NAME: P:\p120121\Documents\DOT Office\District 3\Project\0366B07\CADD\0366B07-INC-500.dgn

USER NAME = NOLASCOCJ	DESIGNED -	REVISED -
	DRAWN -	REVISED -
PLOT SCALE = 100.0000' / in.	CHECKED -	REVISED -
PLOT DATE = 12/11/2020	DATE -	REVISED -

**STATE OF ILLINOIS
DEPARTMENT OF TRANSPORTATION**

SUMMARY OF QUANTITIES

SCALE: SHEET OF SHEETS STA. TO STA.

F.A.P. RTE.	SECTION	COUNTY	TOTAL SHEETS	SHEET NO.
603	(120,121,122)RS-2	LASALLE	27	3
ILLINOIS FED. AID PROJECT			CONTRACT NO. 66B07	

MODEL: Default
 FILE NAME: P:\p12\com.dct.illinois.gov-PWD\DOT\Documents\DOT_Offices\District_3\Project\0366807\CADD\0366807-INC-500.dgn

CODE NO.	ITEM	UNIT	TOTAL QUANTITY	CONSTR. CODE	
				URBAN	
				FUND TYPE	FEDERAL
				ROADWAY	0005
				RURAL	
44201819	CLASS D PATCHES, TYPE III, 14 INCH	SQ YD	18	18	
44201821	CLASS D PATCHES, TYPE IV, 14 INCH	SQ YD	71	71	
48102100	AGGREGATE WEDGE SHOULDER, TYPE B	TON	2183	2183	①
50105220	PIPE CULVERT REMOVAL	FOOT	80	80	
542A5473	PIPE CULVERTS, CLASS A, TYPE 1 EQUIVALENT ROUND-SIZE 18"	FOOT	40	40	①
542A5479	PIPE CULVERTS, CLASS A, TYPE 1 EQUIVALENT ROUND-SIZE 24"	FOOT	40	40	
542A5485	PIPE CULVERTS, CLASS A, TYPE 1 EQUIVALENT ROUND-SIZE 30"	FOOT	80	80	①
54213663	PRECAST REINFORCED CONCRETE FLARED END SECTIONS 18"	EACH	2	2	
54262718	METAL FLARED END SECTIONS 18"	EACH	2	2	
54262730	METAL FLARED END SECTIONS 30"	EACH	1	1	
54263330	CONCRETE END SECTION, STANDARD 542011, 30", 1:3	EACH	6	6	
60103700	PIPE DRAINS, CORRUGATED STEEL 18"	FOOT	50	50	
* 63000001	STEEL PLATE BEAM GUARDRAIL, TYPE A, 6 FOOT POSTS	FOOT	125	125	
* 63000350	LONG-SPAN GUARDRAIL OVER CULVERT, 12 FT 6 IN SPAN	FOOT	75	75	

* = SPECIALTY ITEM

USER NAME = NOLASCOCJ	DESIGNED -	REVISED -
	DRAWN -	REVISED -
PLOT SCALE = 100.0000' / in.	CHECKED -	REVISED -
PLOT DATE = 12/11/2020	DATE -	REVISED -

**STATE OF ILLINOIS
 DEPARTMENT OF TRANSPORTATION**

SUMMARY OF QUANTITIES

SCALE: SHEET OF SHEETS STA. TO STA.

F.A.P. RTE.	SECTION	COUNTY	TOTAL SHEETS	SHEET NO.
603	(120,121,122)RS-2	LASALLE	27	4
ILLINOIS FED. AID PROJECT			CONTRACT NO. 66B07	

CODE NO.	ITEM	UNIT	TOTAL QUANTITY	URBAN	
				CONSTR. CODE	
				FUND TYPE	FEDERAL
				ROADWAY	0005
					RURAL
* 63100167	TRAFFIC BARRIER TERMINAL, TYPE 1 (SPECIAL) TANGENT	EACH	4		4
63200310	GUARDRAIL REMOVAL	FOOT	375		375
63500105	DELINEATORS	EACH	10		10
64200108	SHOULDER RUMBLE STRIPS, 8 INCH	FOOT	59768		59768
* 66700205	PERMANENT SURVEY MARKERS, TYPE I	EACH	10		10
67000400	ENGINEER'S FIELD OFFICE, TYPE A	CAL MO	5		5
67100100	MOBILIZATION	L SUM	1		1
70100450	TRAFFIC CONTROL AND PROTECTION, STANDARD 701201	L SUM	1		1
70100460	TRAFFIC CONTROL AND PROTECTION, STANDARD 701306	L SUM	1		1
70300100	SHORT TERM PAVEMENT MARKING	FOOT	8281		8281
70300150	SHORT TERM PAVEMENT MARKING REMOVAL	SQ FT	2760		2760
* 72501000	TERMINAL MARKER - DIRECT APPLIED	EACH	4		4
* 78000100	THERMOPLASTIC PAVEMENT MARKING - LETTERS AND SYMBOLS	SQ FT	228		228

*= SPECIALTY ITEM

MODEL: Default
FILE NAME: p:\gis\com.dct\illinois.gov\p\w\DOT\Documents\DOT_Offices\District_3\Project\0366807\CADD\0366807-4nc-500.dgn

USER NAME = NOLASCOCJ	DESIGNED -	REVISED -
	DRAWN -	REVISED -
PLOT SCALE = 100.0000' / in.	CHECKED -	REVISED -
PLOT DATE = 12/11/2020	DATE -	REVISED -

**STATE OF ILLINOIS
DEPARTMENT OF TRANSPORTATION**

SUMMARY OF QUANTITIES

SCALE: SHEET OF SHEETS STA. TO STA.

F.A.P. RTE.	SECTION	COUNTY	TOTAL SHEETS	SHEET NO.
603	(120,121,122)RS-2	LASALLE	27	5
ILLINOIS FED. AID PROJECT			CONTRACT NO. 66B07	

MODEL: Default
 FILE NAME: P:\p121122\Documents\DOT - Offices\District 3\Project\0366B07\CADD\DATA\0366B07-INC-500.dgn

CODE NO.	ITEM	UNIT	TOTAL QUANTITY	URBAN	
				CONSTR. CODE	
				FUND TYPE	
				ROADWAY	FEDERAL
				0005	RURAL
* 78000200	THERMOPLASTIC PAVEMENT MARKING - LINE 4"	FOOT	14450	14450	
* 78000400	THERMOPLASTIC PAVEMENT MARKING - LINE 6"	FOOT	10	10	
* 78000500	THERMOPLASTIC PAVEMENT MARKING - LINE 8"	FOOT	849	849	
* 78000600	THERMOPLASTIC PAVEMENT MARKING - LINE 12"	FOOT	1261	1261	
* 78001110	PAINT PAVEMENT MARKING - LINE 4"	FOOT	226,840	226,840	
* 78001130	PAINT PAVEMENT MARKING - LINE 6"	FOOT	27,466	27,466	
* 78003180	PREFORMED PLASTIC PAVEMENT MARKING, TYPE B - LINE 24"	FOOT	140	140	
* 78008210	POLYUREA PAVEMENT MARKING TYPE I - LINE 4"	FOOT	800	800	
* 78008240	POLYUREA PAVEMENT MARKING TYPE I - LINE 8"	FOOT	50	50	
* 78100100	RAISED REFLECTIVE PAVEMENT MARKER	EACH	716	716	
* 78200005	GUARDRAIL REFLECTORS, TYPE A	EACH	6	6	
* 78200020	CURB REFLECTORS	EACH	10	10	
78300200	RAISED REFLECTIVE PAVEMENT MARKER REMOVAL	EACH	716	716	
X0326341	REATTACH END SECTION	EACH	4	4	

*= SPECIALTY ITEM

USER NAME = NOLASCOCJ	DESIGNED -	REVISED -
	DRAWN -	REVISED -
PLOT SCALE = 100.0000' / in.	CHECKED -	REVISED -
PLOT DATE = 12/11/2020	DATE -	REVISED -

**STATE OF ILLINOIS
 DEPARTMENT OF TRANSPORTATION**

SUMMARY OF QUANTITIES

SCALE: SHEET OF SHEETS STA. TO STA.

F.A.P. RTE.	SECTION	COUNTY	TOTAL SHEETS	SHEET NO.
603	(120,121,122)RS-2	LASALLE	27	6
ILLINOIS FED. AID PROJECT			CONTRACT NO. 66B07	

MODEL: Default
 FILE NAME: P:\p16161616\p16161616\Documents\DOT_Offices\District 3\Project\0366807\CADD\0366807-41c-500.dgn

CODE NO.	ITEM	UNIT	TOTAL QUANTITY	URBAN	
				CONSTR. CODE	
				FUND TYPE	
				ROADWAY	0005
				RURAL	
X0327783	REMOVAL OF TEMPORARY BERM	CU YD	33		33
X0327809	LINEAR DELINEATOR PANELS, 4 INCH	EACH	10		10
X1200050	BOX CULVERT REMOVAL	FOOT	30		30
X4401198	HOT-MIX ASPHALT SURFACE REMOVAL, VARIABLE DEPTH	SQ YD	3400	3400	
X4810200	AGGREGATE SHOULDER REMOVAL	CU YD	158		158
* X7830070	GROOVING FOR RECESSED PAVEMENT MARKING 5"	FOOT	7050	7050	
* X7830074	GROOVING FOR RECESSED PAVEMENT MARKING 7"	FOOT	10		10
* X7830076	GROOVING FOR RECESSED PAVEMENT MARKING 9"	FOOT	899	899	
* X7830090	GROOVING FOR RECESSED PAVEMENT MARKING 25"	FOOT	140		140
Z0000100	ABANDON EXISTING CULVERT	EACH	3		3
Z0005216	HOT-MIX ASPHALT STABILIZATION 6" AT STEEL PLATE BEAM GUARD RAIL	SQ YD	942		942
Z0005300	BOX CULVERTS TO BE CLEANED	EACH	2		2
Z0015500	DEBRIS REMOVAL	L SUM	1		1
Z0030850	TEMPORARY INFORMATION SIGNING	SQ FT	42		42

*= SPECIALTY ITEM

USER NAME = NOLASCOCJ	DESIGNED -	REVISED -
	DRAWN -	REVISED -
PLOT SCALE = 100.0000' / in.	CHECKED -	REVISED -
PLOT DATE = 12/11/2020	DATE -	REVISED -

**STATE OF ILLINOIS
 DEPARTMENT OF TRANSPORTATION**

SUMMARY OF QUANTITIES

SCALE: SHEET OF SHEETS STA. TO STA.

F.A.P. RTE.	SECTION	COUNTY	TOTAL SHEETS	SHEET NO.
603	(120,121,122)RS-2	LASALLE	27	7
ILLINOIS FED. AID PROJECT			CONTRACT NO. 66B07	

MODEL: Default
 FILE NAME: p:\p121212\Documents\DOT_Offices\District_3\project\0366B07\CADD\plan\0366B07-shc-500.dgn

CODE NO.	ITEM	UNIT	TOTAL QUANTITY	CONSTR. CODE	
				FUND TYPE	ROADWAY
				URBAN	0005
				FEDERAL	RURAL
Z0033700	LONGITUDINAL JOINT SEALANT	FOOT	57,476	57,476	
∅ Z0076600	TRAINEES	HOUR	1,000	1,000	
Z0034105	MATERIAL TRANSFER DEVICE	TON	42,198	42,198	
∅ Z0076604	TRAINEES - TRAINING PROGRAM GRADUATE	HOUR	1,000	1,000	
Z0058668	GRADING AND SHAPING FORESLOPES	SQ YD	332	332	

∅ 0042

USER NAME = NOLASCOCJ	DESIGNED -	REVISED -
	DRAWN -	REVISED -
PLOT SCALE = 100.0000' / in.	CHECKED -	REVISED -
PLOT DATE = 12/11/2020	DATE -	REVISED -

**STATE OF ILLINOIS
 DEPARTMENT OF TRANSPORTATION**

SUMMARY OF QUANTITIES

SCALE: SHEET OF SHEETS STA. TO STA.

F.A.P. RTE.	SECTION	COUNTY	TOTAL SHEETS	SHEET NO.
603	(120,121,122)RS-2	LASALLE	27	8
ILLINOIS FED. AID PROJECT			CONTRACT NO. 66B07	

REV. 2/17/21 REV. 1/20/21 REV. 1/19/21

MAINLINE SCHEDULE															
LOCATION	LENGTH	WIDTH	RESURF AREA	HMA SURF REM 3.75"	HMA SURF CSE IL 9.5 MIX C, N50 1.75"	HMA BIND CSE IL-9.5, N50 2"	MATL TRANS DEVICE	BIT MATL (TACK COAT)	MIX CRACKS JTS & FLANGEWAYS	HMA BINDER CSE (HM) N50	LONG JOINT SEAL	TEMP RAMP	AGG WEDGE SHLD TY B	SHOULDER RUMBLE STRIPS 8"	
STATION	FOOT	FOOT	SQ FT	SQ YD	TON	TON	TON	POUND	TON	TON	FOOT	SQ YD	TON	FOOT	
US 52															
STA 225+33 TO STA 226+33	100	48	4800	533	52	60	112	360	0.2	0.3	100	67			
BRIDGE OMISSION SN 050-0171															
STA 228+91 TO STA 229+91	100	48	4800	533	52	60	112	360	0.2	0.3	100	67			
CONCRETE OMISSION															
STA 229+91 TO STA 246+43															
STA 246+43 TO STA 545+27	29884	32	956288	105254	10413	11900	22313	71722	31.9	53.1	29884	44	1130	59768	
STA 545+27 TO STA 584+21	3894	27	105138	11682	1145	1308	2453	7885	3.5	5.8	3894		147		
STA 584+21 TO STA 586+76	255	30	7650	850	83	95	178	574	0.3	0.4	255		10		
STA 586+76 TO STA 667+60	8084	27	218268	24252	2377	2716	5093	16370	7.3	12.1	8084		306		
STA 667+60 TO STA 670+65	305	30	9150	1017	100	114	214	686	0.3	0.5	305		12		
STA 670+65 TO STA 794+83	12418	27	335286	37254	3651	4172	7823	25146	11.2	18.6	12418		470		
STA 794+83 TO STA 795+36 BK	53	52	2756	306	30	34	64	207	0.1	0.2	53		2		
STA 394+00 AH TO STA 397+74	374	52	19448	2161	212	242	454	1459	0.6	1.1	374		14		
STA 397+74 TO STA 404+31	657	66	43362	4318	472	540	1012	3252	1.4	2.4	657		25		
STA 404+31 TO STA 406+75	244	69	16836	1371	183	210	393	1263	0.6	0.9	244		9		
STA 406+75 TO STA 414+29	754	65	49010	5446	534	610	1144	3676	1.6	2.7	754		29		
STA 414+29 TO STA 415+50	121	50	6050	672	66	75	141	454	0.2	0.3	121	69	5		
IL 1 (STA 405+37)															
STA 30+38 TO STA 30+00	38	58	2204	245	24	27	51	165	0.1	0.1	38	81	1		
IL 23 (STA 405+37)															
STA 29+35 TO STA 27+40	195	141	27495	3055	299	342	641	2062	0.9	1.5	195	196	7		
TOTALS		57476	822	1808541	200949	19693	22505	42198	135641	60	100	57476	524	2167	59768

MODEL: Default
FILE: h:\mhc\proj\uploadroom\data\illinois.gov\PWIDOT\Documents\DOT_Offices\Dir\dtc_3\Project\0366B07\CaddData\0366B07-2-hk-sched.xls.dgn

USER NAME = NOLASCOCJ	DESIGNED -	REVISED -
	DRAWN -	REVISED -
PLOT SCALE = 100.0000' / in.	CHECKED -	REVISED -
PLOT DATE = 2/13/2021	DATE -	REVISED -

**STATE OF ILLINOIS
DEPARTMENT OF TRANSPORTATION**

SCHEDULE OF QUANTITIES

SCALE: SHEET OF SHEETS STA. TO STA.

F.A.P. RTE.	SECTION	COUNTY	TOTAL SHEETS	SHEET NO.
603	(121,122,123)RS-2	LASALLE	27	12 A
CONTRACT NO. 66B07				
ILLINOIS FED. AID PROJECT				

CULVERT SCHEDULE															
STATION	TYPE/SIZE	STRUCTURE NUMER	LOCATION DESCRIPTION	PIPE CULV REM	BOX CULV REM	PIPE CULVERTS, CLASS A, TYPE 1, EQUIVALENT ROUND-SIZE 18"	PIPE CULVERTS, CLASS A, TYPE 1, EQUIVALENT ROUND-SIZE 24"	(TWIN) PIPE CULVERTS, CLASS A, TYPE 1, EQUIVALENT ROUND-SIZE 30"	CONC END SEC STANDARD 542011 30", 1:3	PRECAST REINFORCED CONC FLARED END SEC 30"	PIPE DRAINS, CORRUGATED STEEL 18"	METAL FLARED END SEC 18"	METAL FLARED END SEC 30"	TRENCH BACKFILL	DELINEATORS
				FOOT	FOOT	FOOT	FOOT	FOOT	EACH	EACH	FOOT	EACH	EACH	CU YD	EACH
293+00	18" CLAY	2742	.25 MILES EAST OF 7TH RD	40			40		2					11.1	2
385+90	30" CMP	UN-NAMED	SOUTH LEG OF 9TH RD, UPSTREAM (EAST)										1		2
400+42	3X2 BOX CULVERT	958	.28 MILES EAST OF 9TH RD		30			80	4					19.8	2
438+75	18" CMP	NEW	SOUTH LEG OF 10TH RD								50	2			2
731+45	18" CLAY	965	.4 MILE EA OF 12TH RD	40		40		80	6	2				11.6	2
TOTAL				80	30	40	40	80	6	2	50	2	1	42.5	10

CULVERT MAINTENANCE SCHEDULE												
STATION	TYPE/SIZE	STRUCTURE NUMBER	LOCATION DESCRIPTION	BOX CULV TO BE CLEANED	CHANNEL EXCAVATION	STONE DUMPED RIPRAP, CLASS A4	REM OF TEMP BERM	ABANDON EXISTING CULVERT	GRADING AND SHAPING FORESLOPES	DEBRIS REM	REATTACH END SECTION	EARTH EXCAVATION
				EACH	CU YD	SQ YD	CU YD	EACH	SQ YD	LUMP SUM	EACH	CU YD
212+00	TWIN 18" RCP	2746	.3 MILES WEST OF I-39								4	600
258+17	18" CLAY	2744	.3 MILES EAST OF 6TH RD					1	166			
275+99	18" CLAY	2743	431' WEST OF 7TH RD					1	166			
310+07	3X2 BOX CULVERT	677	.43 MILES WEST OF 8TH RD			8						
318+10	8X9 BOX CULVERT	050-2030	.28 MILES WEST OF 8TH RD	1	46.2					1		
439+16	18" CLAY	2741	50' EAST OF 10TH RD					1				
527+98	4X3 BOX CULVERT	953	.3 MILES WEST OF 12TH RD		9.3		33					
585+31	12X8 BOX CULVERT	050-2659	.77 MILES EAST OF 12TH RD			48						
620+07	10X4 BOX CULVERT	050-2658	1.4 MILES EAST OF 12TH RD	1	36.7							
731+45	18" CLAY	965	.4 MILE EAST OF 12TH RD			50						
TOTAL				2	92.2	106	33	3	332	1	4	600

DITCH CLEANING SCHEDULE					
LOCATION	SIDE	LENGTH	FLOW DIRECTION	GRADING & SHAPING DITCH	
		FOOT		FOOT	
STA 215+00 TO STA 219+00	NORTH	400	EAST	400	
STA 243+00 TO STA 244+00	SOUTH	100	WEST	100	
STA 261+50 TO STA 263+00	NORTH	150	EAST	150	
STA 261+50 TO STA 263+00	SOUTH	150	EAST	150	
STA 410+00 TO STA 411+00	SOUTH	100	EAST	100	
STA 437+00 TO STA 438+50	NORTH	150	EAST	150	
STA 437+00 TO STA 438+50	SOUTH	150	EAST	150	
STA 464+00 TO STA 465+00	SOUTH	100	WEST	100	
STA 524+50 TO STA 526+00	NORTH	150	EAST	150	
STA 605+00 TO STA 607+50	SOUTH	250	EAST	250	
STA 709+00 TO STA 710+50	SOUTH	150	EAST	150	
STA 403+50 TO STA 405+00	NORTH	150	EAST	150	
TOTAL				2000	

PATCHING SCHEDULE				
LOCATION	PATCH LENGTH	PATCH WIDTH	CLASS D PATCH TYPE III	CLASS D PATCH TYPE IV
			14"	14"
STA	FOOT	FOOT	SQ YD	SQ YD
293+00	7	32		25
400+42	13	32		46
731+45	6	27	18	
TOTAL			18	71

MODEL: Default
 FILE: \\miller-pw\p1\amson\dot\illinois.gov\PIWDOT\Documents\DOT_Offices\District_3\project\12366807_CAD\data\12366807_sbs-schedule.dgn

USER NAME = NOLASCOCJ	DESIGNED -	REVISED -
	DRAWN -	REVISED -
PLOT SCALE = 100.0000' / in.	CHECKED -	REVISED -
PLOT DATE = 12/11/2020	DATE -	REVISED -

**STATE OF ILLINOIS
DEPARTMENT OF TRANSPORTATION**

SCHEDULE OF QUANTITIES

SCALE: SHEET OF SHEETS STA. TO STA.

F.A.P. RTE.	SECTION	COUNTY	TOTAL SHEETS	SHEET NO.
603	(121,122,123)RS-2	LASALLE	27	15
ILLINOIS FED. AID PROJECT			CONTRACT NO. 66B07	