

**PROPOSED RESURFACING NOTES:**  
 HMA SURFACE REMOVAL, 2 1/4"  
 POLYMERIZED LEVELING BINDER  
 (MACHINE METHOD) IL-4.75, N50, 3/4"  
 HOT-MIX ASPHALT SURFACE COURSE,  
 MIX D, N70, 1 1/2"

- LEGEND**
- ① THERMOPLASTIC PAVEMENT MARKING, WHITE EDGE LINE, 4" (TYP.)
  - ② THERMOPLASTIC PAVEMENT MARKING, DOUBLE YELLOW CENTERLINE 4", 11" C-C (TYP.)
  - ③ THERMOPLASTIC PAVEMENT MARKING, SOLID WHITE 6", (TYP.)
  - ④ THERMOPLASTIC PAVEMENT MARKING, 2'-6" SKIP DASH WHITE 6", (TYP.)
  - ⑤ THERMOPLASTIC PAVEMENT MARKING, SOLID WHITE STOP BAR 24", (TYP.)
  - ⑥ THERMOPLASTIC PAVEMENT MARKING, SOLID YELLOW LINE 12", 15' SPACING OR 5 DIAGNALS MINIMUM, (TYP.)
  - ⑦ THERMOPLASTIC PAVEMENT MARKING, 10'-30' SKIP DASH YELLOW 4", (TYP.)
  - ⑧ THERMOPLASTIC PAVEMENT MARKING, LETTERS & SYMBOLS, (TYP.)
  - ⑨ THERMOPLASTIC PAVEMENT MARKING, SOLID YELLOW 4", (TYP.)

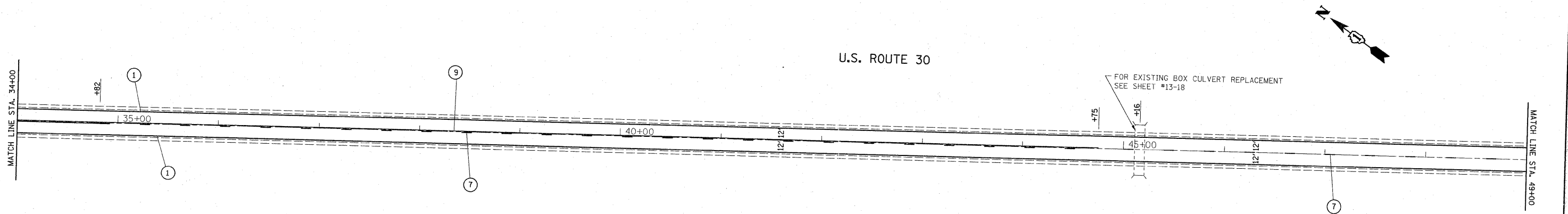

**PROPOSED RESURFACING NOTES:**  
 HMA SURFACE REMOVAL, 2 1/4"  
 POLYMERIZED LEVELING BINDER  
 (MACHINE METHOD) IL-4.75, N50, 3/4"  
 HOT-MIX ASPHALT SURFACE COURSE,  
 MIX D, N70, 1 1/2"

FILE NAME =	USER NAME = ulrichkd	DESIGNED -	REVISED -	<b>STATE OF ILLINOIS DEPARTMENT OF TRANSPORTATION</b>	<b>U.S. RTE. 30 (U.S. RTE. 34 TO 0.30 MILE NORTH OF 111TH STREET) ROADWAY AND PAVEMENT MARKING PLAN</b>	F.A.P. RTE.	SECTION	COUNTY	TOTAL SHEETS	SHEET NO.	
g:\pwwork\p\WIDOT\ULRICHK\dm90446\012206-shr-plan.dgn	PLOT SCALE = 50.0000' / IN.	DRAWN -	REVISED -			349	16RS-6	WILL/KENDALL	30	9	
PLOT DATE = 12/23/2008	DATE -	CHECKED -	REVISED -			SCALE: 1"= 50'		SHEET NO. 9 OF 31 SHEETS		STA. 19+00.00 TO STA. 49+00.00	
						CONTRACT NO. 60A98		FED. ROAD DIST. NO. 1 ILLINOIS FED. AID PROJECT			