

TRAFFIC SIGNAL LEGEND

	PROPOSED	EXISTING
CONTROLLER		
RAILROAD CONTROL CABINET		
SERVICE INSTALLATION, (P) POLE OR (G) GROUND MOUNTED		
SIGNAL HEAD		
SIGNAL HEAD WITH BACKPLATE		
SIGNAL HEAD, PEDESTRIAN		
SIGNAL POST		
MAST ARM ASSEMBLY AND POLE, STEEL		
MAST ARM ASSEMBLY AND POLE, ALUMINIUM		
COMMON TRENCH		
UNIT DUCT		
HANDHOLE		
HEAVY DUTY HANDHOLE		
DOUBLE HANDHOLE		
G.S.CONDUIT IN TRENCH OR PUSHED		
CAST IRON JUNCTION BOX		
SIGNAL HEAD OPTICALLY PROGRAMMED		
CONDUIT SPLICE		
WOOD POLE		
RACEWAY FOR MAGNETIC DETECTOR, TYPE I OR TYPE II		
VEHICLE DETECTOR, NON COMPENSATED MAGNETIC TYPE		
RAILROAD CONTROL CABINET		
ILLUMINATED SIGN, FIBER OPTIC "NO LEFT TURN"		
ILLUMINATED SIGN, FIBER OPTIC "NO RIGHT TURN"		
TELEPHONE CONNECTION		
PEDESTRIAN PUSHBUTTON DETECTOR		
DETECTOR LOOP, TYPE I		
PERFORMED DETECTOR LOOP		
VIDEO DETECTOR		
CLOSED CIRCUIT TV		
EMERGENCY VEHICLE SYSTEM DETECTOR		
CONFIRMATION BEACON		
UNINTERRUPTABLE POWER SUPPLY		
WIRELESS INTERCONNECT (ANTENNA)		

CONSTRUCTION NOTES:

- REMOVE EXISTING CONTROLLER AND REPLACE WITH NEW CONTROLLER WITH UPS USING EXISTING FOUNDATION. RELOCATION OF EXISTING EVP PHASING UNIT SHALL BE INCLUDED IN THE UNIT COST OF NEW CONTROLLER AND CABINET PAY ITEM.
- REMOVE EXISTING SIGNAL HEAD, 1-FACE, 3-SECTION, MAST ARM MOUNTED. INSTALL NEW SIGNAL HEAD, 12" L.E.D., 1-FACE, 3-SECTION, MAST ARM MOUNTED. RE-USE EXISTING CABLE.
- REMOVE EXISTING SIGNAL HEAD, 1-FACE, 3-SECTION, BRACKET MOUNTED. INSTALL NEW SIGNAL HEAD, 12" L.E.D., 1-FACE, 3-SECTION, BRACKET MOUNTED. RE-USE EXISTING CABLE.
- REMOVE EXISTING SIGNAL HEAD, 1-FACE, 5-SECTION, MAST ARM MOUNTED. INSTALL NEW SIGNAL HEAD, 12" L.E.D., 1-FACE, 5-SECTION, MAST ARM MOUNTED. RE-USE EXISTING CABLE.
- REMOVE EXISTING SIGNAL HEAD, 2-FACE, 1-3 SECTION, 1-5 SECTION, BRACKET MOUNTED. INSTALL NEW SIGNAL HEAD, 12" L.E.D., 1-FACE, 5-SECTION, BRACKET MOUNTED. REMOVE EXISTING 6C CABLE AND RE-USE EXISTING 7C CABLE.
- INSTALL NEW PEDESTRIAN SIGNAL HEAD, 12" L.E.D., 1-FACE, BRACKET MOUNTED. INSTALL NEW ELECTRIC CABLE IN CONDUIT, SIGNAL NO. 14 3C.
- INSTALL NEW PEDESTRIAN PUSH-BUTTON. INSTALL NEW ELECTRIC CABLE IN CONDUIT, SIGNAL NO. 14 2C.

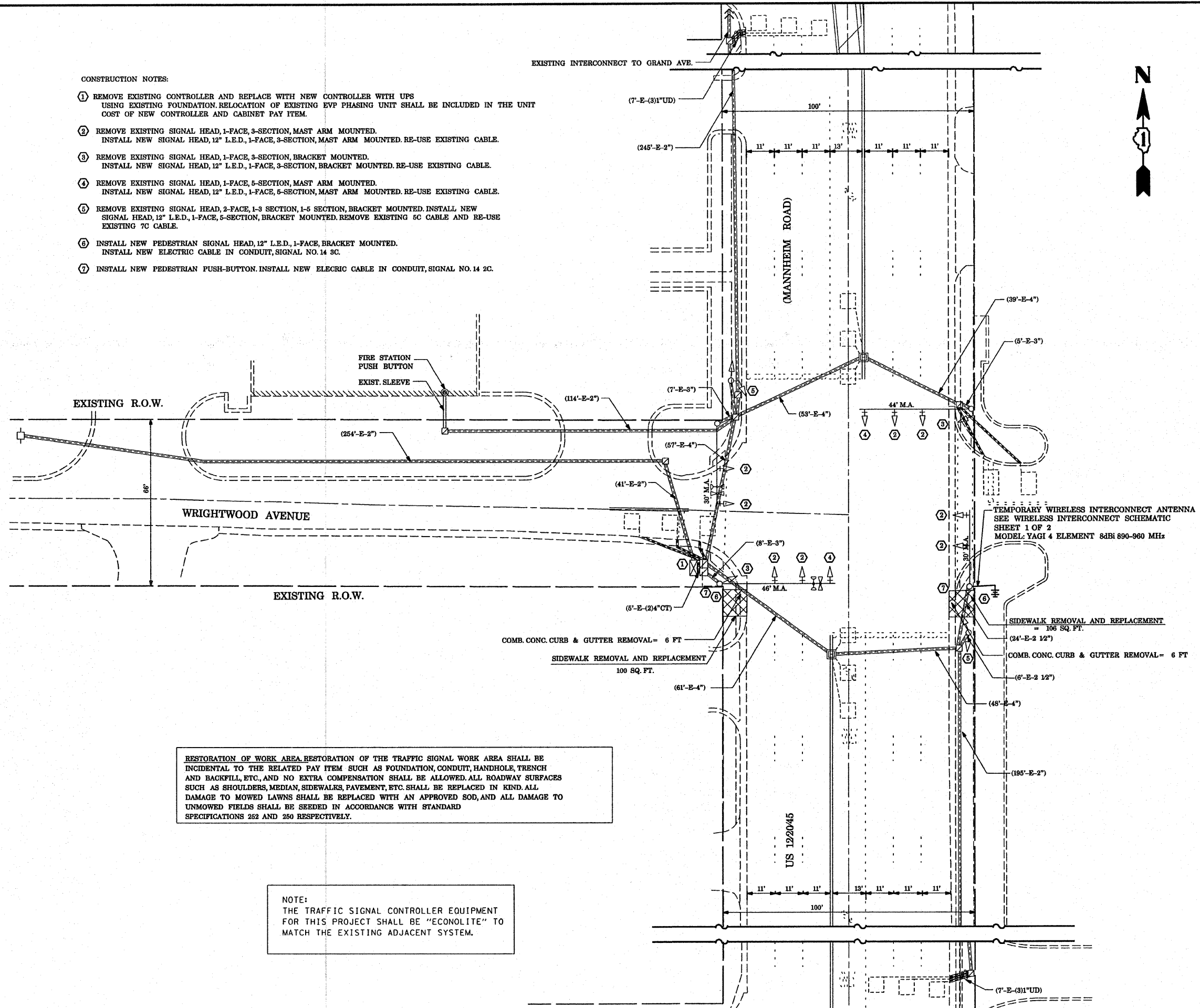

THE FOLLOWING EXISTING TRAFFIC SIGNAL EQUIPMENT SHALL BE REMOVED BY THE CONTRACTOR, SHALL REMAIN THE PROPERTY OF THE STATE AND SHALL BE DELIVERED BY THE CONTRACTOR TO THE STATE'S TRAFFIC SIGNAL MAINTENANCE CONTRACTOR'S MAIN FACILITY AS PER THE TRAFFIC SIGNAL SPECIFICATIONS.

- 1 EACH FULL-ACTUATED CONTROLLER AND TYPE IV CABINET
- 10 EACH TRAFFIC SIGNAL BACKPLATE
- 8 EACH SIGNAL HEAD, L.E.D., 1-FACE, 3-SECTION, MAST ARM MOUNTED.
- 2 EACH SIGNAL HEAD, L.E.D., 1-FACE, 3-SECTION, BRACKET MOUNTED.
- 2 EACH SIGNAL HEAD, L.E.D., 1-FACE, 5-SECTION, MAST ARM MOUNTED.
- 2 EACH SIGNAL HEAD, L.E.D., 2-FACE, 1-3 SECTION AND 1-5 SECTION, BRACKET MOUNTED.

RESTORATION OF WORK AREA RESTORATION OF THE TRAFFIC SIGNAL WORK AREA SHALL BE INCIDENTAL TO THE RELATED PAY ITEM SUCH AS FOUNDATION, CONDUIT, HANDHOLE, TRENCH AND BACKFILL, ETC., AND NO EXTRA COMPENSATION SHALL BE ALLOWED. ALL ROADWAY SURFACES SUCH AS SHOULDERS, MEDIAN, SIDEWALKS, PAVEMENT, ETC. SHALL BE REPLACED IN KIND. ALL DAMAGE TO MOWED LAWNS SHALL BE REPLACED WITH AN APPROVED SOD, AND ALL DAMAGE TO UNMOWED FIELDS SHALL BE SEEDED IN ACCORDANCE WITH STANDARD SPECIFICATIONS 252 AND 250 RESPECTIVELY.

NOTE: THE TRAFFIC SIGNAL CONTROLLER EQUIPMENT FOR THIS PROJECT SHALL BE "ECONOLITE" TO MATCH THE EXISTING ADJACENT SYSTEM.

FILE NAME = c:\projects\traffic\070027\us12_20_45.dgn	USER NAME = kenthphxjbc	DESIGNED - N.B.	REVISED -	STATE OF ILLINOIS DEPARTMENT OF TRANSPORTATION	EXISTING AND REMOVAL PLAN US 12/2045 (MANNHEIM RD) AT WRIGHTWOOD AVE			F.A.P. RTE. 330	SECTION 2008-006 TS	COUNTY COOK	TOTAL SHEETS 104	SHEET NO. 18
PLOT SCALE = 48,0000' / IN.	CHECKED - D.B.	REVISED -	REVISED -		SCALE: 1"=20'	SHEET NO.	OF SHEETS	STA.	TO STA.	FED. ROAD DIST. NO.	ILLINOIS FED. AID PROJECT	CONTRACT NO. 60E31
PLOT DATE = 10/10/2008	DATE - 09/04/2008	REVISED -	REVISED -									