

RESTORATION OF WORK AREA RESTORATION OF THE TRAFFIC SIGNAL WORK AREA SHALL BE INCIDENTAL TO THE RELATED PAY ITEM SUCH AS FOUNDATION, CONDUIT, HANDHOLE, TRENCH AND BACKFILL, ETC., AND NO EXTRA COMPENSATION SHALL BE ALLOWED. ALL ROADWAY SURFACES SUCH AS SHOULDERS, MEDIAN, SIDEWALKS, PAVEMENT, ETC. SHALL BE REPLACED IN KIND. ALL DAMAGE TO MOWED LAWNS SHALL BE REPLACED WITH AN APPROVED SOB, AND ALL DAMAGE TO UNMOWED FIELDS SHALL BE SEEDED IN ACCORDANCE WITH STANDARD SPECIFICATIONS 252 AND 250 RESPECTIVELY.

CONSTRUCTION NOTES:

- ① REMOVE EXISTING CONTROLLER AND REPLACE WITH NEW CONTROLLER WITH UPS USING EXISTING FOUNDATION. RELOCATION OF EXISTING EVP PHASING UNIT SHALL BE INCLUDED IN THE UNIT COST OF NEW CONTROLLER AND CABINET PAY ITEM.
- ② REMOVE EXISTING SIGNAL HEAD, 1-FACE, 3-SECTION, MAST ARM MOUNTED. INSTALL NEW SIGNAL HEAD, L.E.D. 1-FACE, 3-SECTION, MAST ARM MOUNTED. REUSE EXISTING CABLE.
- ③ REMOVE EXISTING SIGNAL HEAD, 1-FACE, 5-SECTION, BRACKET MOUNTED. INSTALL NEW SIGNAL HEAD, L.E.D. 1-FACE, 5-SECTION, BRACKET MOUNTED. REUSE EXISTING CABLE.
- ④ REMOVE EXISTING SIGNAL HEAD, 2-FACE, 1-3 SECTION, 1-5 SECTION, BRACKET MOUNTED. INSTALL NEW SIGNAL HEAD, L.E.D. 2-FACE, 1-3 SECTION, 1-5 SECTION, BRACKET MOUNTED. REUSE EXISTING CABLE.
- ⑤ REMOVE EXISTING SIGNAL HEAD, 3-FACE, 1-3 SECTION, 2-5 SECTION, BRACKET MOUNTED. INSTALL NEW SIGNAL HEAD, L.E.D. 3-FACE, 1-3 SECTION, 2-5 SECTION, BRACKET MOUNTED. REUSE EXISTING CABLE.
- ⑥ REMOVE AND REPLACE EXISTING PUSH-BUTTON. REUSE EXISTING CABLE.
- ⑦ REMOVE EXISTING PEDESTRIAN SIGNAL HEAD, 1-FACE, BRACKET MOUNTED. REUSE EXISTING CABLE.
- ⑧ REMOVE EXISTING PEDESTRIAN SIGNAL HEAD, 3-FACE, BRACKET MOUNTED. INSTALL NEW PEDESTRIAN SIGNAL HEAD, L.E.D., 3-FACE, BRACKET MOUNTED. REUSE EXISTING CABLE.
- ⑨ REMOVE EXISTING PEDESTRIAN SIGNAL HEAD AND PUSH-BUTTON. REMOVE EXISTING CABLE.

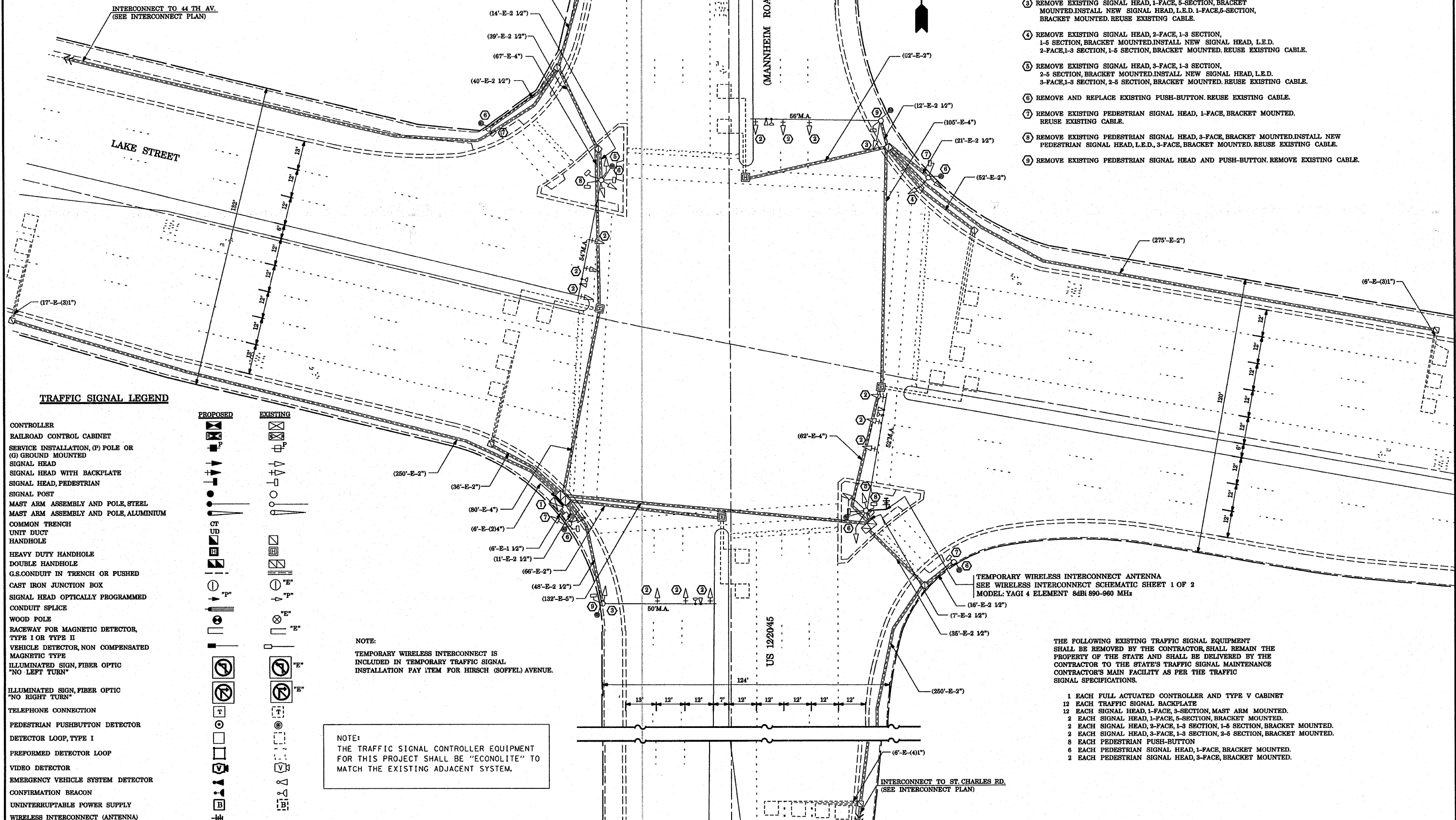

TRAFFIC SIGNAL LEGEND

- | | | | |
|--|--|----------|--|
| CONTROLLER | | EXISTING | |
| RAILROAD CONTROL CABINET | | EXISTING | |
| SERVICE INSTALLATION, (P) POLE OR (G) GROUND MOUNTED | | EXISTING | |
| SIGNAL HEAD | | EXISTING | |
| SIGNAL HEAD WITH BACKPLATE | | EXISTING | |
| SIGNAL HEAD, PEDESTRIAN | | EXISTING | |
| SIGNAL POST | | EXISTING | |
| MAST ARM ASSEMBLY AND POLE, STEEL | | EXISTING | |
| MAST ARM ASSEMBLY AND POLE, ALUMINIUM | | EXISTING | |
| COMMON TRENCH | | EXISTING | |
| UNIT DUCT | | EXISTING | |
| HANDHOLE | | EXISTING | |
| HEAVY DUTY HANDHOLE | | EXISTING | |
| DOUBLE HANDHOLE | | EXISTING | |
| G.S. CONDUIT IN TRENCH OR PUSHED | | EXISTING | |
| CAST IRON JUNCTION BOX | | EXISTING | |
| SIGNAL HEAD OPTICALLY PROGRAMMED | | EXISTING | |
| CONDUIT SPLICE | | EXISTING | |
| WOOD POLE | | EXISTING | |
| RACEWAY FOR MAGNETIC DETECTOR, TYPE I OR TYPE II | | EXISTING | |
| VEHICLE DETECTOR, NON COMPENSATED MAGNETIC TYPE | | EXISTING | |
| ILLUMINATED SIGN, FIBER OPTIC "NO LEFT TURN" | | EXISTING | |
| ILLUMINATED SIGN, FIBER OPTIC "NO RIGHT TURN" | | EXISTING | |
| TELEPHONE CONNECTION | | EXISTING | |
| PEDESTRIAN PUSHBUTTON DETECTOR | | EXISTING | |
| DETECTOR LOOP, TYPE I | | EXISTING | |
| PREFORMED DETECTOR LOOP | | EXISTING | |
| VIDEO DETECTOR | | EXISTING | |
| EMERGENCY VEHICLE SYSTEM DETECTOR | | EXISTING | |
| CONFIRMATION BEACON | | EXISTING | |
| UNINTERRUPTIBLE POWER SUPPLY | | EXISTING | |
| WIRELESS INTERCONNECT (ANTENNA) | | EXISTING | |

NOTE:
TEMPORARY WIRELESS INTERCONNECT IS INCLUDED IN TEMPORARY TRAFFIC SIGNAL INSTALLATION PAY ITEM FOR HIRSCH (SOFFEL) AVENUE.

NOTE:
THE TRAFFIC SIGNAL CONTROLLER EQUIPMENT FOR THIS PROJECT SHALL BE "ECONOLITE" TO MATCH THE EXISTING ADJACENT SYSTEM.

TEMPORARY WIRELESS INTERCONNECT ANTENNA
SEE WIRELESS INTERCONNECT SCHEMATIC SHEET 1 OF 2
MODEL: YAGI 4 ELEMENT 8dBi 890-960 MHz

THE FOLLOWING EXISTING TRAFFIC SIGNAL EQUIPMENT SHALL BE REMOVED BY THE CONTRACTOR, SHALL REMAIN THE PROPERTY OF THE STATE AND SHALL BE DELIVERED BY THE CONTRACTOR TO THE STATE'S TRAFFIC SIGNAL MAINTENANCE CONTRACTOR'S MAIN FACILITY AS PER THE TRAFFIC SIGNAL SPECIFICATIONS.

- 1 EACH FULL ACTUATED CONTROLLER AND TYPE V CABINET
- 12 EACH TRAFFIC SIGNAL BACKPLATE
- 12 EACH SIGNAL HEAD, 1-FACE, 3-SECTION, MAST ARM MOUNTED.
- 2 EACH SIGNAL HEAD, 1-FACE, 5-SECTION, BRACKET MOUNTED.
- 2 EACH SIGNAL HEAD, 2-FACE, 1-3 SECTION, 1-5 SECTION, BRACKET MOUNTED.
- 2 EACH SIGNAL HEAD, 3-FACE, 1-3 SECTION, 2-5 SECTION, BRACKET MOUNTED.
- 8 EACH PEDESTRIAN PUSH-BUTTON
- 6 EACH PEDESTRIAN SIGNAL HEAD, 1-FACE, BRACKET MOUNTED.
- 2 EACH PEDESTRIAN SIGNAL HEAD, 3-FACE, BRACKET MOUNTED.

FILE NAME =	USER NAME = kanthaphaybc	DESIGNED - N.B.	REVISED -	STATE OF ILLINOIS DEPARTMENT OF TRANSPORTATION	EXISTING AND REMOVAL PLAN US 12/2045 (MANNHEIM ROAD) AT LAKE AVENUE	F.A.P. RTE.	SECTION	COUNTY	TOTAL SHEETS	SHEET NO.	
PROJECTS\traffic\070202\us12.20.45.dgn	PLLOT SCALE = 48.0000' / IN.	DRAWN - N.B.	REVISED -			330	2008-006 TS	COOK	104	49	
DATE = 18/10/2008	DATE = 09/04/2008	CHECKED - D.B.	REVISED -			CONTRACT NO. 60E31					
		DATE = 09/04/2008	REVISED -			SCALE: 1"=20' SHEET NO. OF SHEETS STA. TO STA.					