

CONSTRUCTION NOTES:

- 1 REMOVE EXISTING CONTROLLER AND CABINET. INSTALL NEW FULL-ACTUATED CONTROLLER AND TYPE IV CABINET ON EXISTING FOUNDATION. INSTALL UPS.
- 2 REMOVE EXISTING SIGNAL HEAD, 1-FACE 3-SECTION, MAST ARM MOUNTED.
- 3 INSTALL NEW SIGNAL HEAD, LED, 1-FACE 3-SECTION, MAST ARM MOUNTED.
- 4 REMOVE EXISTING SIGNAL HEAD, 1-FACE 3-SECTION, BRACKET MOUNTED. INSTALL NEW SIGNAL HEAD, LED, 1-FACE 3 SECTION, BRACKET MOUNTED.
- 5 REMOVE EXISTING SIGNAL HEAD, 2-FACE 3-SECTION, BRACKET MOUNTED. REMOVE EXISTING TRAFFIC SIGNAL POST, 14 FT AND INSTALL NEW GALVANIZED STEEL TRAFFIC SIGNAL POST, 14 FT ON EXISTING FOUNDATION. INSTALL NEW SIGNAL HEAD, LED, 2-FACE 3-SECTION, BRACKET MOUNTED.
- 6 REMOVE EXISTING SIGNAL HEAD, 1-FACE 5-SECTION, MAST ARM MOUNTED.
- 7 REMOVE EXISTING SIGNAL HEAD, 1-FACE 5-SECTION, BRACKET MOUNTED. REMOVE EXISTING TRAFFIC SIGNAL POST, 16 FT AND INSTALL NEW GALVANIZED STEEL TRAFFIC SIGNAL POST, 14 FT ON EXISTING FOUNDATION. INSTALL NEW SIGNAL HEAD LED, 1-FACE 3-SECTION, BRACKET MOUNTED.
- 8 REMOVE EXISTING MAST ARM ASSEMBLY AND POLE. REMOVE EXISTING CONCRETE FOUNDATION. INSTALL NEW MAST ARM ASSEMBLY AND POLE, 44 FT ON NEW FOUNDATION AT PROPOSED LOCATION, AS SHOWN IN PLAN.
- 9 DISCONNECT FORWARD LOOP (INCIDENTAL TO CONTRACT)
- 10 REMOVE EXISTING, EMERGENCY VEHICLE PREEMPTION LIGHT DETECTOR AND CONFIRMATION BEACON.

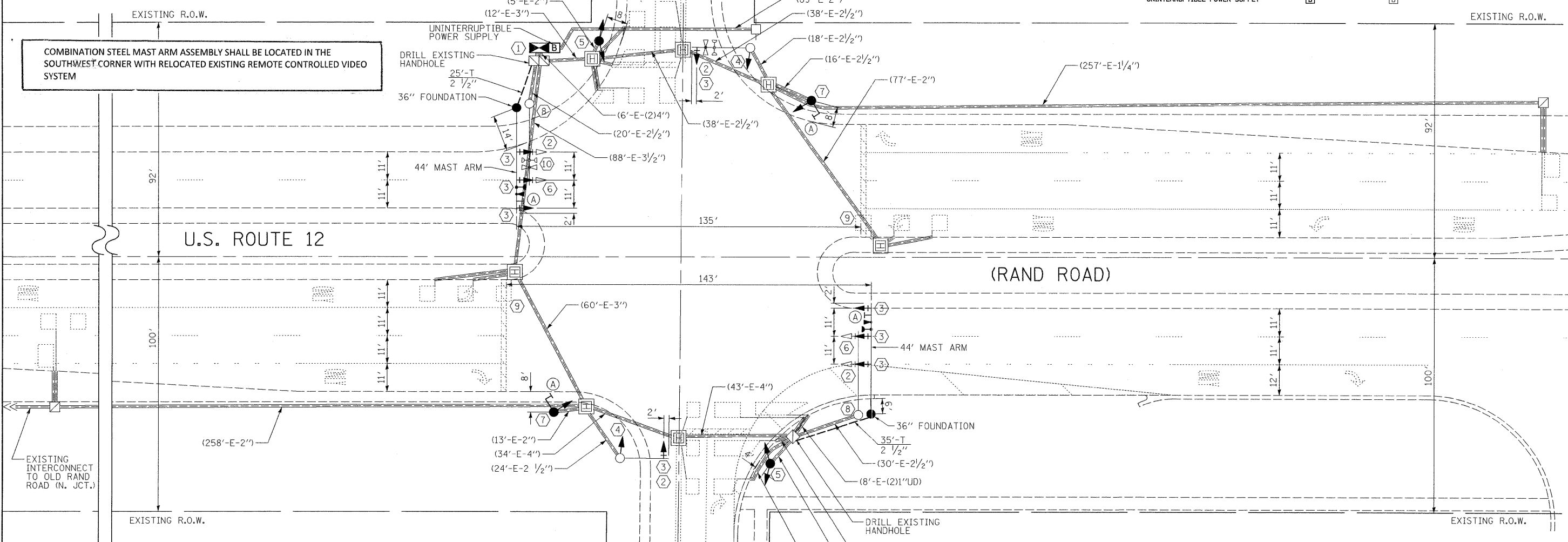
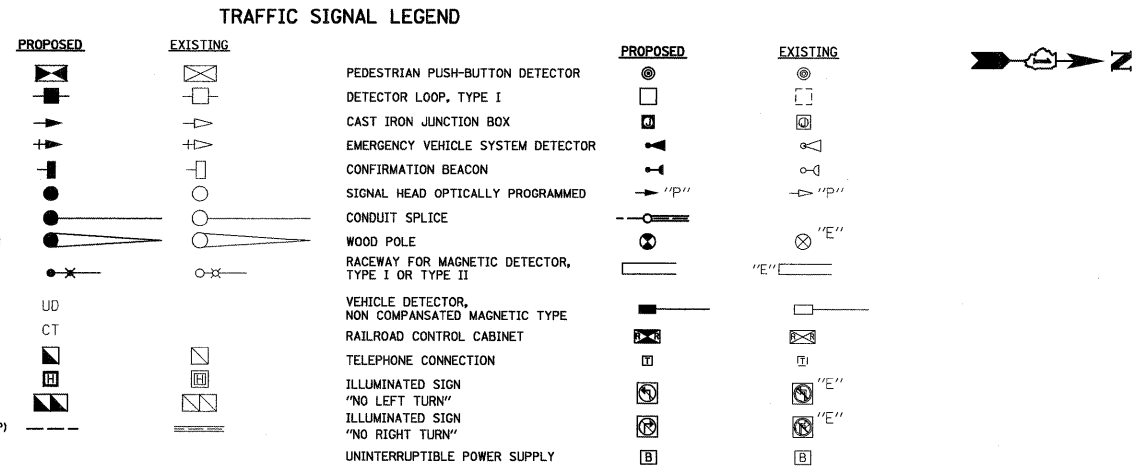

- NOTES:**
1. THE TRAFFIC SIGNAL CONTROL EQUIPMENT FOR THIS PROJECT SHALL BE "ECONOLITE".
 2. ALL TRAFFIC SIGNAL HEADS SHALL BE L.E.D. (LIGHT EMITTING DIODE).
 3. RELOCATE EXISTING MAST ARM MOUNTED STREET NAME SIGNS TO NEW LOCATIONS.
 4. THE CONTRACTOR SHALL BE REQUIRED TO MAINTAIN THE OPERATION OF THE TRAFFIC SIGNALS DURING THE ENTIRE PROJECT.

RESTORATION OF WORK AREA

RESTORATION OF TRAFFIC SIGNAL WORK AREA SHALL BE INCIDENTAL TO THE RELATED PAY ITEM SUCH AS FOUNDATION, CONDUIT, HANDHOLE, TRENCH AND BACKFILL, ETC., AND NO EXTRA COMPENSATION SHALL BE ALLOWED. ALL ROADWAY SURFACES SUCH AS SHOULDERS, MEDIANS, SIDEWALKS, PAVEMENT, ETC. SHALL BE REPLACED IN KIND. ALL DAMAGE TO MOWED LAWNS SHALL BE REPLACED WITH AN APPROVED SOD, AND ALL DAMAGE TO UNMOWED FIELDS SHALL BE SEEDING IN ACCORDANCE WITH STANDARD SPECIFICATIONS 252 AND 250 RESPECTIVELY.

- THE FOLLOWING ITEMS SHALL BE REMOVED BY THE CONTRACTOR AND SHALL BE DISPOSED OF BY THEM OUTSIDE THE RIGHT-OF-WAY AT THEIR EXPENSE. THE SALVAGE VALUE OF THE REMOVED EQUIPMENT SHALL BE REFLECTED IN THE CONTRACT BID PRICE.
- | | | |
|---|------|-----------------------------------|
| 1 | EACH | CONTROLLER AND CABINET (COMPLETE) |
| 6 | EACH | SIGNAL HEAD, 3-SECTION |
| 4 | EACH | SIGNAL HEAD, 5-SECTION |
| 2 | EACH | SIGNAL HEAD, 2-FACE, 3-SECTION |
| 2 | EACH | TRAFFIC SIGNAL BACKPLATE |
| 2 | EACH | TRAFFIC SIGNAL ASSEMBLY AND POLE |
| 2 | EACH | TRAFFIC SIGNAL POST |
| 2 | EACH | LIGHT DETECTOR |
| 1 | EACH | LIGHT DETECTOR AMPLIFIER |



FILE NAME =	USER NAME = JLA	DESIGNED - KK	REVISED -
\MICROST\352056\08-MILLER SIG.DGN		DRAWN - JLA	REVISED -
	PLOT SCALE = 1"=20'	CHECKED - BPT	REVISED -
	PLOT DATE = 12-01-08	DATE - 12-01-08	REVISED -

**STATE OF ILLINOIS
DEPARTMENT OF TRANSPORTATION**

**TRAFFIC SIGNAL MODIFICATION PLAN
U.S. ROUTE 12 (RAND ROAD) AT MILLER ROAD**

SCALE: 1"=20' SHEET NO. OF SHEETS STA. TO STA.

PREPARED BY:

CEMCON, Ltd.
Consulting Engineers, Land Surveyors & Planners
2280 White Oak Circle, Suite 100
Aurora, Illinois 60504-9675
Ph: 630.862.2100 Fax: 630.862.2199
E-Mail: cadd@cemcon.com Website: www.cemcon.com

F.A.P. RTE.	SECTION	COUNTY	TOTAL SHEETS	SHEET NO.
334	2008-069 TS	LAKE	26	8
CONTRACT NO. 60F62				
FED. ROAD DIST. NO. ILLINOIS FED. AID PROJECT				