

PROFILE SURVEYED _____ DATE _____
 GRADES CHECKED _____
 B.M. NOTED _____
 STRUCTURE NOTATIONS CHNG
 NO. _____
 PLAN SURVEYED _____ DATE _____
 NOTE BOOK _____
 NO. _____
 SURVEYED _____
 ALIGNMENT CHECKED _____
 RT. OF WAY CHECKED _____
 PAID FILE NAME _____

CHRISTOPHER B. BURKE ENGINEERING LTD.
 9575 West Higgins Road, Suite 600
 Rosemont, Illinois 60018
 (847) 823-0500

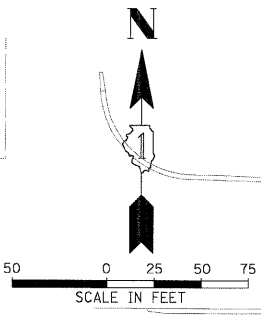
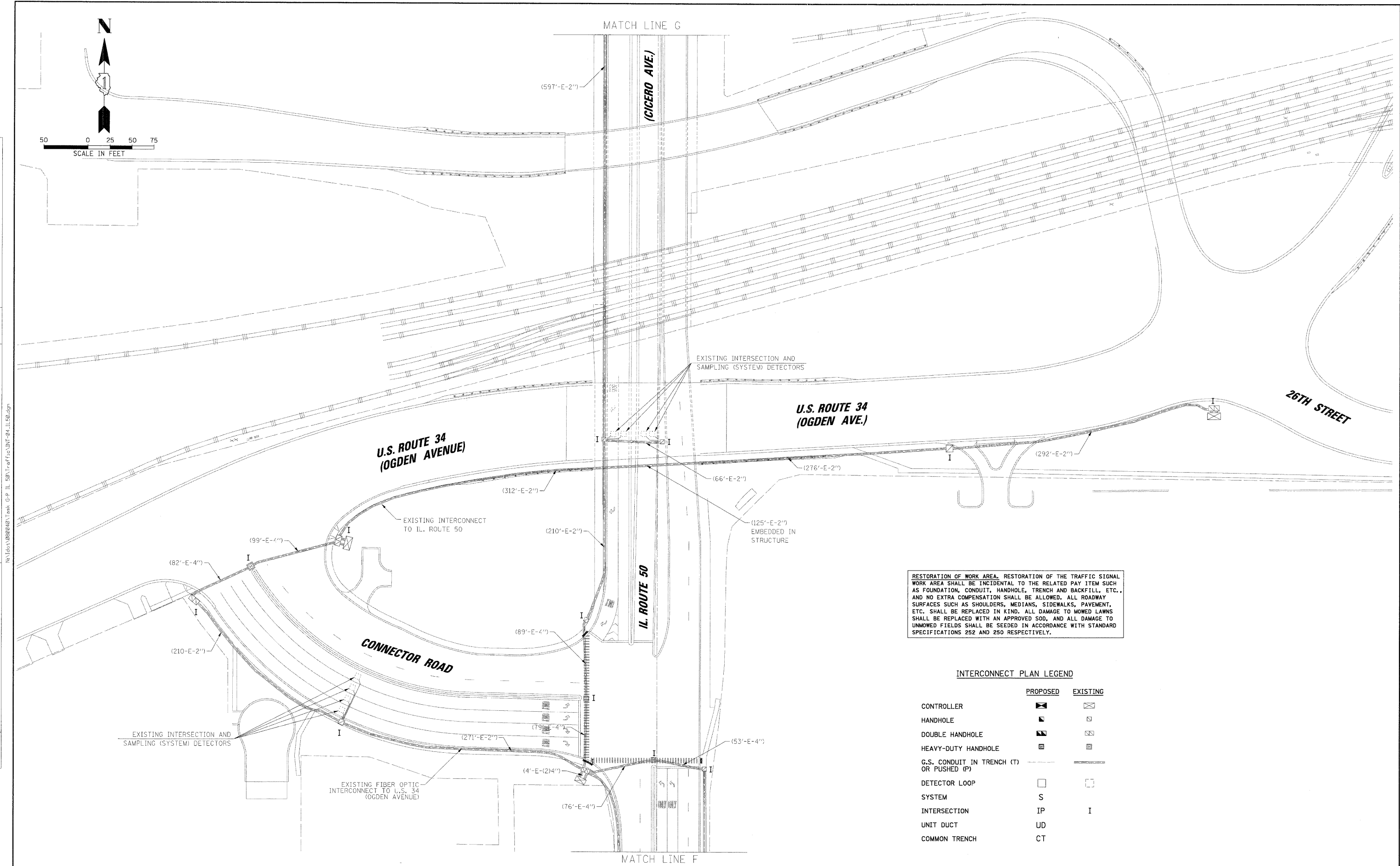

RESTORATION OF WORK AREA. RESTORATION OF THE TRAFFIC SIGNAL WORK AREA SHALL BE INCIDENTAL TO THE RELATED PAY ITEM SUCH AS FOUNDATION, CONDUIT, HANDHOLE, TRENCH AND BACKFILL, ETC., AND NO EXTRA COMPENSATION SHALL BE ALLOWED. ALL ROADWAY SURFACES SUCH AS SHOULDERS, MEDIANS, SIDEWALKS, PAVEMENT, ETC. SHALL BE REPLACED IN KIND. ALL DAMAGE TO MOWED LAWNS SHALL BE REPLACED WITH AN APPROVED SOIL, AND ALL DAMAGE TO UNMOWED FIELDS SHALL BE SEEDING IN ACCORDANCE WITH STANDARD SPECIFICATIONS 252 AND 250 RESPECTIVELY.

INTERCONNECT PLAN LEGEND

	PROPOSED	EXISTING
CONTROLLER		
HANDHOLE		
DOUBLE HANDHOLE		
HEAVY-DUTY HANDHOLE		
G.S. CONDUIT IN TRENCH (T) OR PUSHED (P)		
DETECTOR LOOP		
SYSTEM	S	I
INTERSECTION	IP	I
UNIT DUCT	UD	
COMMON TRENCH	CT	

FILE NAME = N:\dct\080040\Task G-P IL 50\Traffic\INT-04_IL50.dgn	USER NAME = FPACIONE	DESIGNED - ABR	REVISED -	STATE OF ILLINOIS DEPARTMENT OF TRANSPORTATION	INTERCONNECT PLAN		F.A.P. RTE. 350	SECTION 2008-080-1	COUNTY COOK	TOTAL SHEETS 76	SHEET NO. 63
PLOT SCALE = 50'	CHECKED - MJT	REVISED -			IL. ROUTE 50 (CICERO AVE.) FROM 39th ST. (PERSHING RD.) TO ROOSEVELT RD. CICERO, ILLINOIS		SCALE: 1"=50'		SHEET NO. OF SHEETS STA. TO STA.	CONTRACT NO. 60F82	
PLOT DATE = 12/10/2008	DATE -	REVISED -			RESTORATION OF WORK AREA. RESTORATION OF THE TRAFFIC SIGNAL WORK AREA SHALL BE INCIDENTAL TO THE RELATED PAY ITEM SUCH AS FOUNDATION, CONDUIT, HANDHOLE, TRENCH AND BACKFILL, ETC., AND NO EXTRA COMPENSATION SHALL BE ALLOWED. ALL ROADWAY SURFACES SUCH AS SHOULDERS, MEDIANS, SIDEWALKS, PAVEMENT, ETC. SHALL BE REPLACED IN KIND. ALL DAMAGE TO MOWED LAWNS SHALL BE REPLACED WITH AN APPROVED SOIL, AND ALL DAMAGE TO UNMOWED FIELDS SHALL BE SEEDING IN ACCORDANCE WITH STANDARD SPECIFICATIONS 252 AND 250 RESPECTIVELY.		FED. ROAD DIST. NO. ILLINOIS FED. AID PROJECT				
					INTERCONNECT PLAN LEGEND						