

PROFILE SURVEYED BY DATE  
 NOTE BOOK NO. 10/10/2008  
 STRUCTURE NOTATION CHKO  
 PLAN SURVEYED BY DATE  
 NOTE BOOK NO. 10/10/2008  
 ALIGNMENT CHECKED  
 FT. OF WAY CHECKED  
 ADD FILE NAME

**CHRISTOPHER B. BURKE ENGINEERING LTD.**  
 9575 West Higgins Road, Suite 600  
 Rosemont, Illinois 60018  
 (847) 823-0300

N:\dot\080840\Task G-P IL 50\Fra\Fra\INT-05\_IL50.dgn

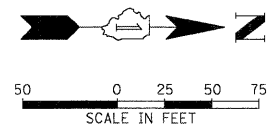
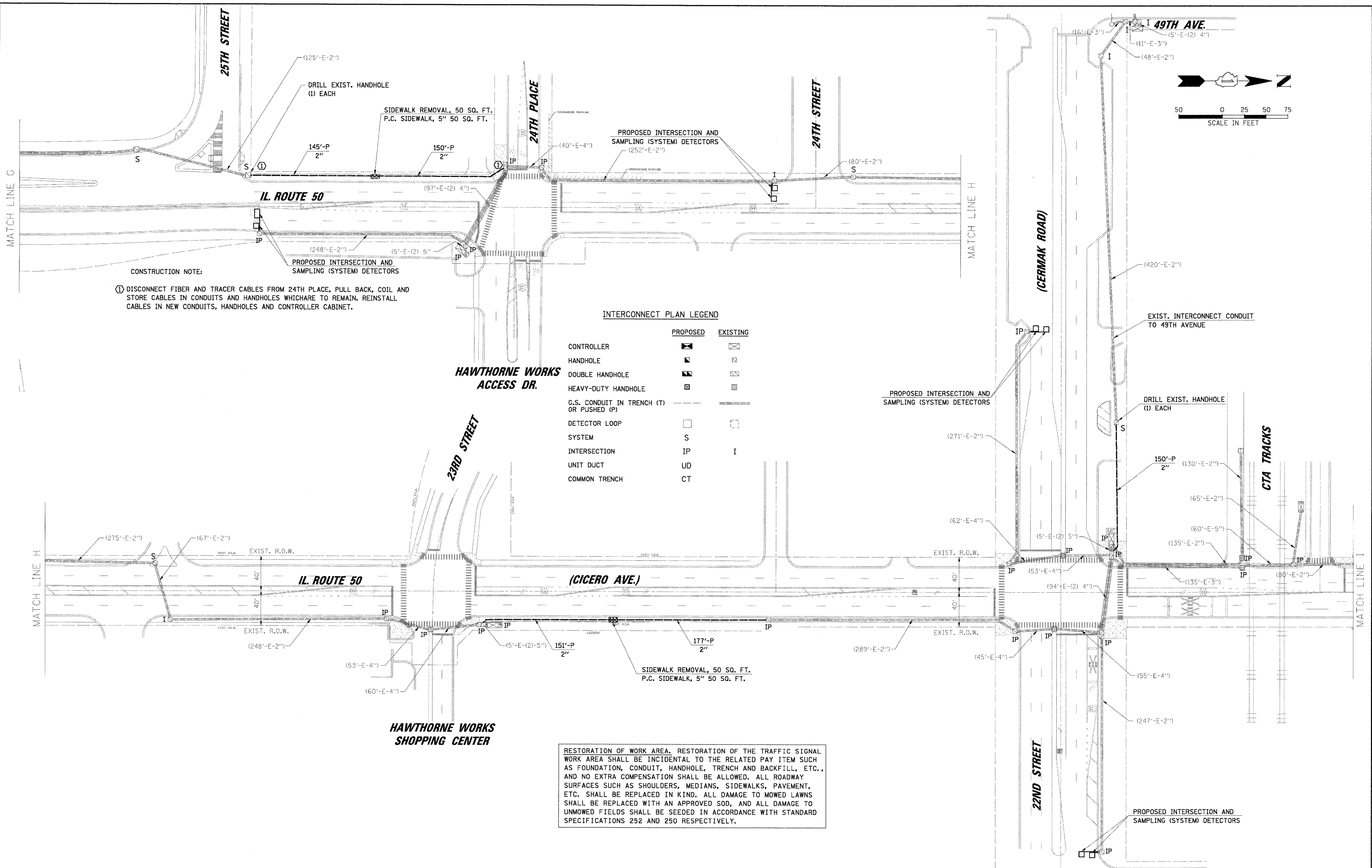

**CONSTRUCTION NOTE:**  
 ① DISCONNECT FIBER AND TRACER CABLES FROM 24TH PLACE, PULL BACK, COIL AND STORE CABLES IN CONDUITS AND HANDHOLES WHICH ARE TO REMAIN. REINSTALL CABLES IN NEW CONDUITS, HANDHOLES AND CONTROLLER CABINET.

**INTERCONNECT PLAN LEGEND**

	PROPOSED	EXISTING
CONTROLLER	⊠	⊠
HANDHOLE	⊠	⊠
DOUBLE HANDHOLE	⊠	⊠
HEAVY-DUTY HANDHOLE	⊠	⊠
G.S. CONDUIT IN TRENCH (T) OR PUSHED (P)	---	---
DETECTOR LOOP	□	□
SYSTEM	S	S
INTERSECTION	IP	I
UNIT DUCT	UD	UD
COMMON TRENCH	CT	CT

RESTORATION OF WORK AREA. RESTORATION OF THE TRAFFIC SIGNAL WORK AREA SHALL BE INCIDENTAL TO THE RELATED PAY ITEM SUCH AS FOUNDATION, CONDUIT, HANDHOLE, TRENCH AND BACKFILL, ETC., AND NO EXTRA COMPENSATION SHALL BE ALLOWED. ALL ROADWAY SURFACES SUCH AS SHOULDERS, MEDIANS, SIDEWALKS, PAVEMENT, ETC. SHALL BE REPLACED IN KIND. ALL DAMAGE TO MOWED LAWNS SHALL BE REPLACED WITH AN APPROVED SOD, AND ALL DAMAGE TO UNMOWED FIELDS SHALL BE SEEDED IN ACCORDANCE WITH STANDARD SPECIFICATIONS 252 AND 250 RESPECTIVELY.

FILE NAME =	USER NAME = FPACIONE	DESIGNED - ABR	REVISED -	<b>STATE OF ILLINOIS DEPARTMENT OF TRANSPORTATION</b>	<b>INTERCONNECT PLAN</b>				F.A.P. RTE. 350	SECTION 2008-080-1	COUNTY COOK	TOTAL SHEETS 76	SHEET NO. 64
N:\dot\080840\Task G-P IL 50\Fra\Fra\INT-05_IL50.dgn	PLOT SCALE = 50'	DRAWN - FPB	REVISED -		IL. ROUTE 50 (CICERO AVE.) FROM 39th ST. (PERSHING RD.) TO ROOSEVELT RD. CICERO, ILLINOIS				CONTRACT NO. 60F82				
	PLOT DATE = 12/10/2008	CHECKED - MJT	REVISED -		SCALE: 1"=50'	SHEET NO.	OF SHEETS	STA.	TO STA.	FED. ROAD DIST. NO.	ILLINOIS FED. AID PROJECT		
		DATE -	REVISED -										