

PLAN	SURVEYED	DATE
	PLOTTED	BY
	CHECKED	
	REVISIONS	
	NO. OF MAY CHECKED	
	CADD FILE NAME	

PROFILE	SURVEYED	DATE
	PLOTTED	BY
	CHECKED	
	REVISIONS	
	NO. OF MAY CHECKED	
	STRUCTURE NOTATION'S CIPND	

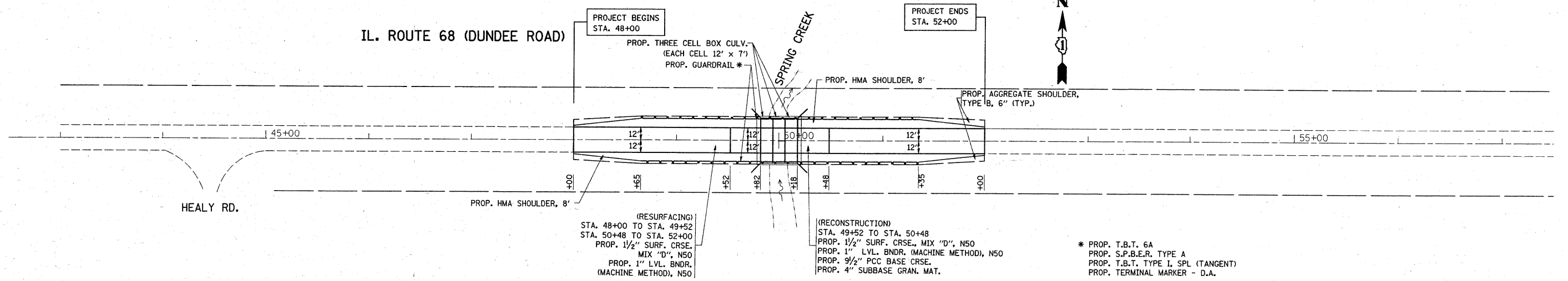
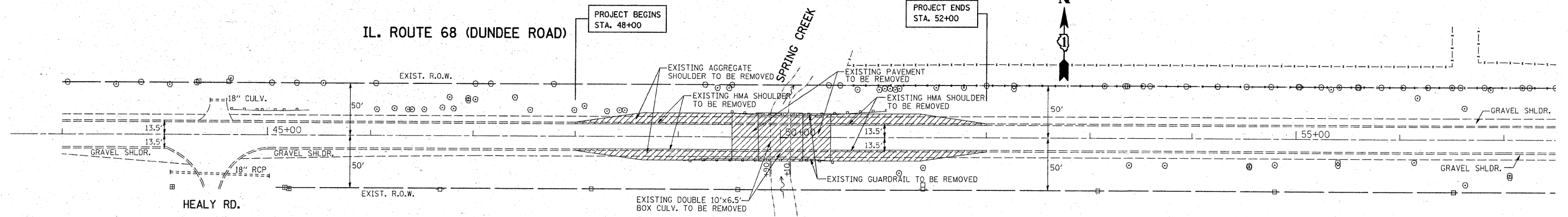

(RESURFACING)  
 STA. 48+00 TO STA. 49+52  
 STA. 50+48 TO STA. 52+00  
 PROP. 1 1/2" SURF. CRSE., MIX "D", N50  
 PROP. MIX "D", N50  
 PROP. 1" LVL. BNDR. (MACHINE METHOD), N50

(RECONSTRUCTION)  
 STA. 49+52 TO STA. 50+48  
 PROP. 1 1/2" SURF. CRSE., MIX "D", N50  
 PROP. 1" LVL. BNDR. (MACHINE METHOD), N50  
 PROP. 9/2" PCC BASE CRSE.  
 PROP. 4" SUBBASE GRAN. MAT.

\* PROP. T.B.T. 6A  
 PROP. S.P.B.E.R. TYPE A  
 PROP. T.B.T. TYPE I, SPL (TANGENT)  
 PROP. TERMINAL MARKER - D.A.

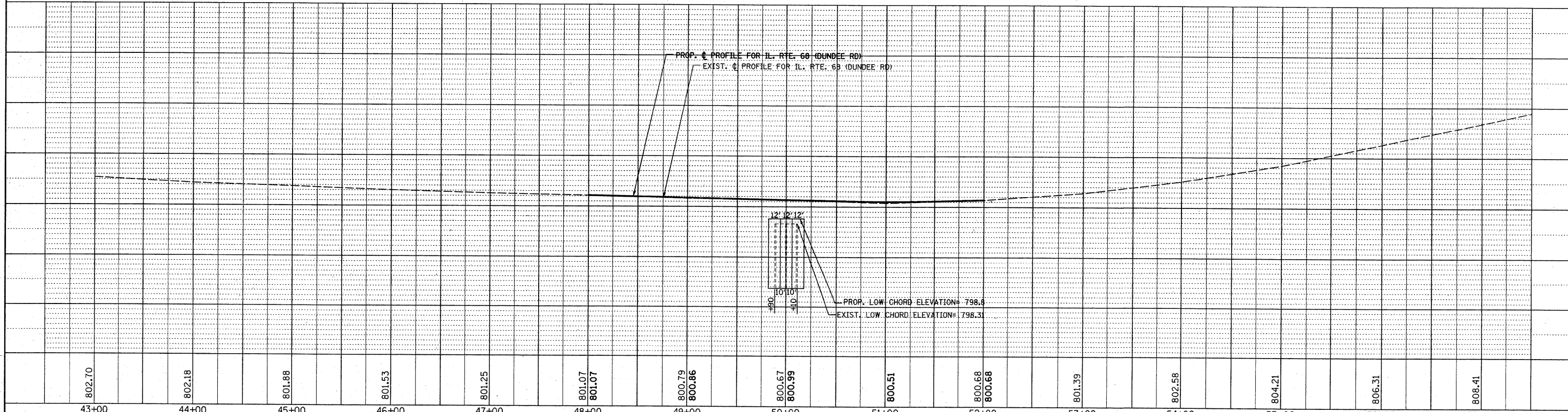

FILE NAME =	USER NAME = ulrichkd	DESIGNED -	REVISED -	<b>STATE OF ILLINOIS DEPARTMENT OF TRANSPORTATION</b>	<b>EXISTING AND PROPOSED ROADWAY PLAN AND PROFILE</b>				F.A.P. RTE. 343	SECTION 63IT	COUNTY COOK	TOTAL SHEETS 33	SHEET NO. 8
CONTRACT NO. 62710	PLOT SCALE = 50.0000' / IN.	DRAWN -	REVISED -		SCALE:	SHEET NO. OF SHEETS	STA. TO STA.	FED. ROAD DIST. NO.	ILLINOIS FED. AID PROJECT				
	PLOT DATE = 12/29/2008	CHECKED -	REVISED -										
		DATE -	REVISED -										