

Bench Mark: Cook County Hwy disk in 43' headwall north side of IL 68 over Spring Creek, Elev. 800.46

Existing Structure: S.N. 016-1035 built in 1928 as double 10'x6.5' R.C. box culvert, with a 45'-8" out-to-out length. Traffic to be maintained utilizing stage construction.

Temporary Support System to be salvaged. See General Notes.

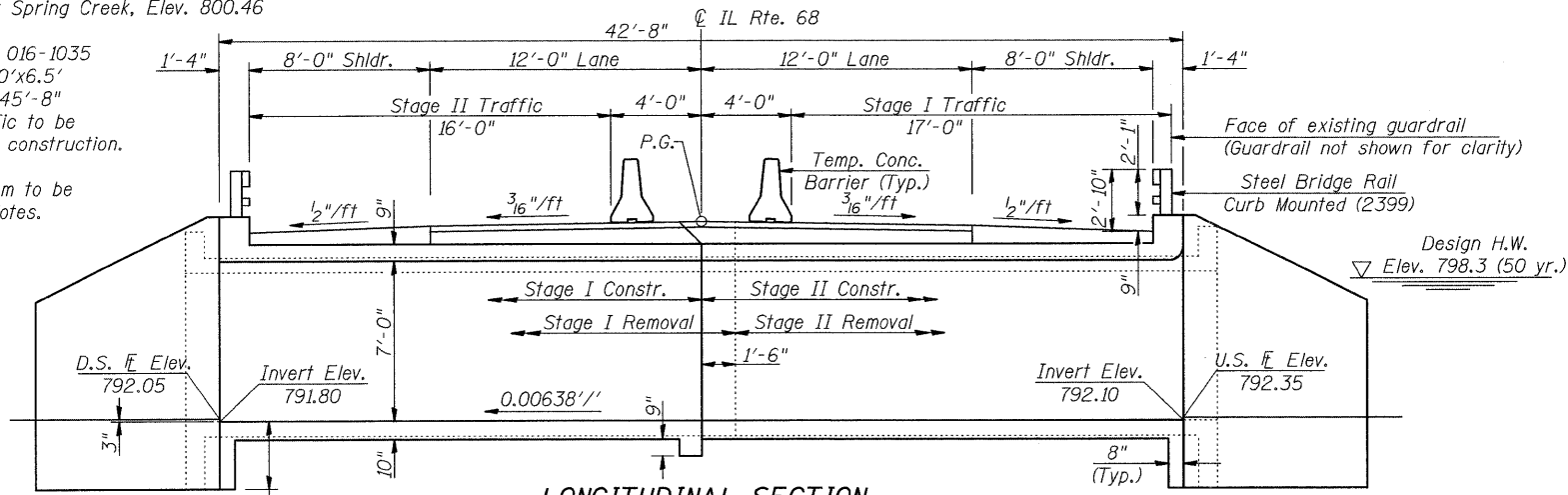

LONGITUDINAL SECTION

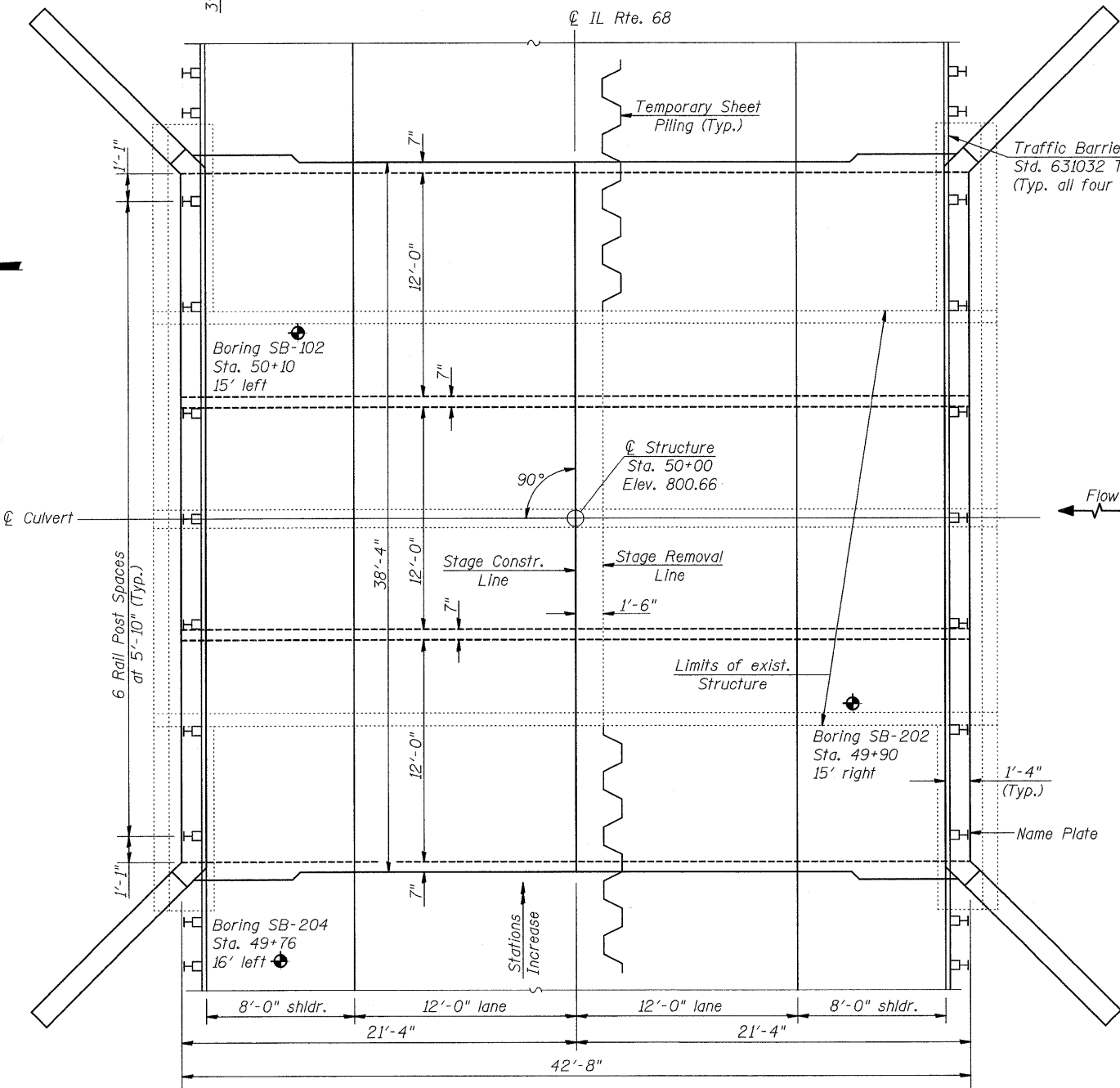

PLAN

**GENERAL NOTES**

The Contractor is advised that the existing box culvert is in deteriorated condition with reduced load carrying capacity. It is the Contractor's responsibility to account for the condition of the existing box culvert when developing construction procedures for removal and replacement of the existing box culvert.

Reinforcement bars shall conform to the requirements of ASTM A 706 Grade 60. See Special Provisions.

Precast Alternate is not allowed.

Prior to Stage II Removal, the Contractor shall remove all salvageable components of the Temporary Support System and deliver them to the IDOT Maintenance yard at 1101 Biesterfeld Road, Elk Grove Village, 60007.

F.A.P.	SECTION	COUNTY	TOTAL SHEETS	SHEET NO.
343	631-A	COOK	33	18

SHEET NO. 1 of 10

Contract No.: 62710

Notch formed by rough finished board attached to and removed with formwork, each interior wall. (Do not chamfer).

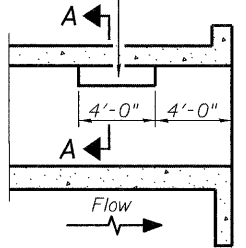

LONGITUDINAL SECTION

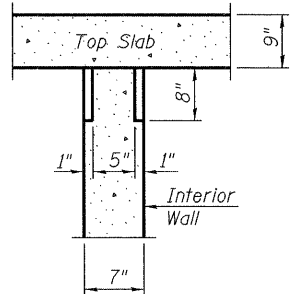

SECTION A-A

PHOEBE NESTING SITE DETAILS (Downstream End Only)

**INDEX OF SHEETS**

Sheet No.	Description
1	General Plan
2	Stage Construction Details
3	Temporary Support Details for Stage I Traffic
4	Culvert Details - I
5	Culvert Details - II
6	Bar Splicer Assembly Details
7	Steel Railing, Type 2399
8	Temporary Concrete Barrier for Stage Construction
9	Borings - I
10	Borings - II

**SEQUENCE OF CONSTRUCTION**

Construct temporary support system in the portion of the culvert to remain during Stage I.

Install Traffic Control for Stage I traffic.

Perform Stage I Removal and Construction.

Move traffic into position for Stage II.

Remove the temporary support system, and return all salvageable components to IDOT.

Perform Stage II Removal and Construction.

Remove traffic control.

**LOADING HS20-44**

Allow 50#/sq. ft. for future wearing surface.

**DESIGN SPECIFICATIONS**

AASHTO 17th Ed. - 2002

**DESIGN STRESSES**

**FIELD UNITS**

$f'_c = 3,500$  psi  
 $f_y = 60,000$  psi (reinforcement)

STATION 50+00  
BUILT BY  
STATE OF ILLINOIS  
F.A.P. RT. 343 SEC. 631-A  
LOADING HS20  
STR. NO. 016-2811

**NAME PLATE**

See Std. 515001

APPROVED FOR STRUCTURAL ADEQUACY ONLY

Ralph E. Anderson  
ENGINEER OF BRIDGES AND STRUCTURES

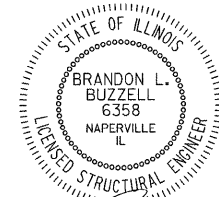

Expires 11-30-10

**TOTAL BILL OF MATERIAL**

ITEM	UNIT	TOTAL
Removal of Existing Structures	Each	1
Concrete Box Culverts	Cu. Yd.	160.8
Reinforcement Bars	Pound	37,710
Steel Railing, Type 2399	Foot	76
Temporary Sheet Piling	Sq. Ft.	956
Name Plates	Each	1
Bar Splicers	Each	232
Furnishing and Erecting Structural Steel	Pound	8,921

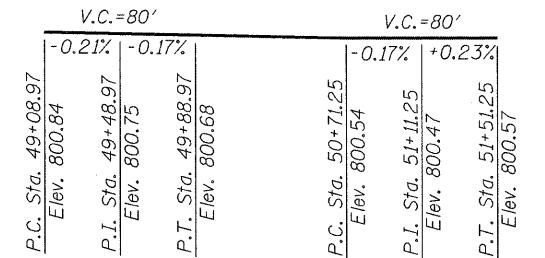

PROFILE GRADE (Along Center Roadway)

**WATERWAY INFORMATION**

Drainage Area = 7.85 sq. mi. Low Grade Elev. 800.38 @ Sta. 51+00

Flood	Freq. Yr.	Q C.F.S.	Opening Sq. Ft.		*Nat. H.W.E.		Head - Ft.		Headwater El.	
			Exist.	Prop.	Exist.	Prop.	Exist.	Prop.	Exist.	Prop.
Design	10	326	90.0	162.0	796.5	0.0	0.0	796.4	796.3	
Base	50	884	126.0	226.8	798.3	0.8	0.0	799.1	798.3	
Overtopping	100	1208	130.0	237.6	798.6	1.8	0.5	800.4	799.1	
Max. Calc.	500	2054	130.0	252.0	799.3	2.0	1.3	801.3	800.6	

\* Elevations taken 50 ft. upstream

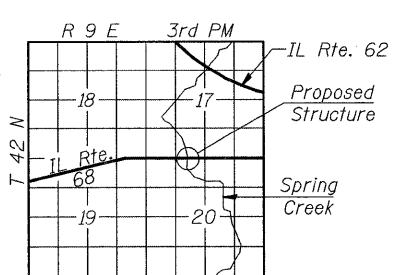

LOCATION SKETCH



REVISIONS	
NAME	DATE

ILLINOIS DEPARTMENT OF TRANSPORTATION  
GENERAL PLAN  
IL RTE. 68 OVER SPRING CREEK  
FAP RTE 343 - SECTION 631-A  
COOK COUNTY  
STATION 50+00  
STRUCTURE NO. 016-2811  
DRAWN BY WJV  
CHECKED BY BLB  
DATE 12/11/08