

F.A.U. RTE.	SECTION	COUNTY	TOTAL SHEETS	SHEET NO.
	08-00152-00-SW	COOK	9	1
FED. ROAD DIST. NO.		ILLINOIS	FED. AID PROJECT	

CONTRACT NO: 63090

STATE OF ILLINOIS DEPARTMENT OF TRANSPORTATION DIVISION OF HIGHWAYS PLANS FOR PROPOSED FEDERAL-AID HIGHWAY PROJECT SIDEWALK IMPROVEMENTS

VARIOUS LOCATIONS
SECTION NO. : 08-00152-00-SW
PROJECT NO. : SRTS-4008(019)
JOB NO. : C-40-006-08

VILLAGE OF MOUNT PROSPECT, COOK COUNTY

INDEX OF SHEETS

- 1 COVER SHEET
- 2 GENERAL NOTES, LEGEND AND SUMMARY OF QUANTITIES
- 3-5 TYPICAL SECTIONS
- 6-8 PLAN SHEETS
- 9 DETAIL

HIGHWAY STANDARDS

- 424001 CURB RAMP FOR SIDEWALK
- 606001 CONCRETE CURB TYPE B AND COMBINATION CONCRETE CURB AND GUTTER
- 701501 URBAN LANE CLOSURE, 2L, 2W, UNDIVIDED
- 701606 URBAN LANE CLOSURE, MULTILANE, 2W WITH MOUNTABLE MEDIAN
- 701801 LANE CLOSURE MULTILANE 1W OR 2W CROSSWALK OR SIDEWALK CLOSURE
- 701901 TRAFFIC CONTROL DEVICES

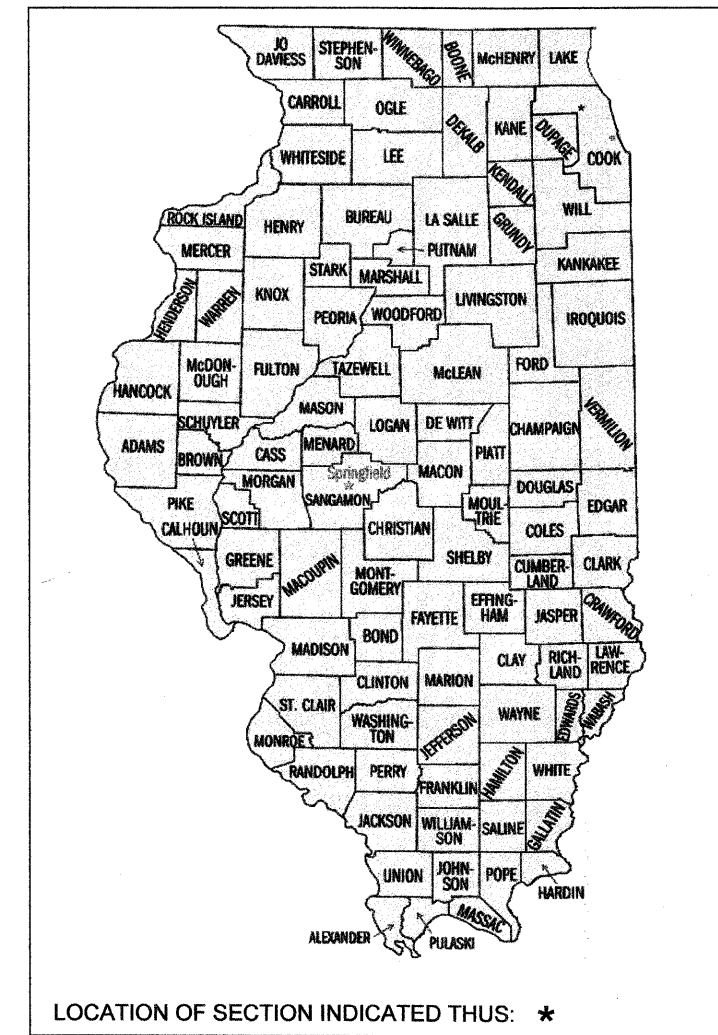

IDOT ENGINEER: KEVIN STALLWORTH (847)705-4169

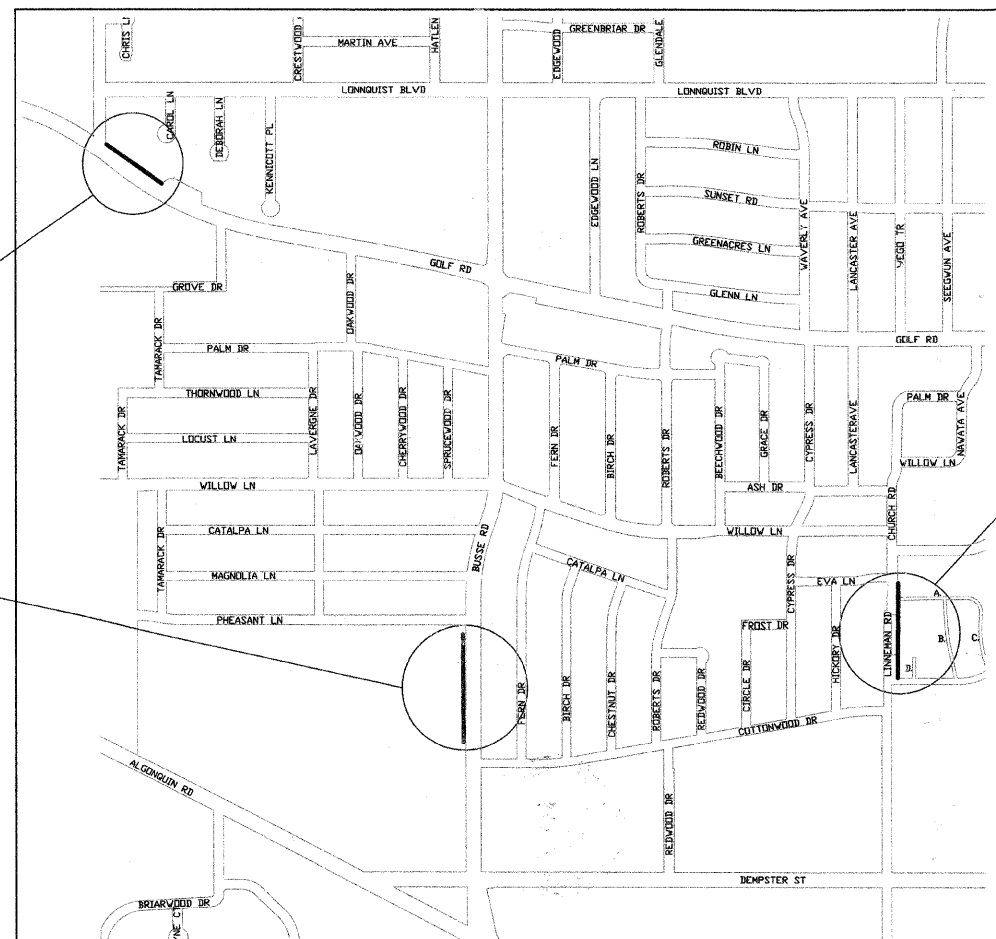

GOLF RD SIDEWALK PROJECT
STA 0+00 TO STA 4+45

BUSSE RD SIDEWALK PROJECT
STA 0+00 TO STA 7+30

LINNEMAN RD SIDEWALK PROJECT
STA 0+80 TO STA 7+00



SCALE: NONE

PROJECT LENGTH: 1,795 FT

FOR JOINT UTILITY INFORMATION

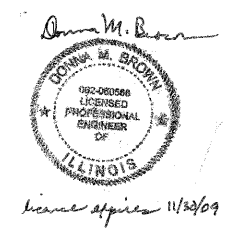

STATE OF ILLINOIS DEPARTMENT OF TRANSPORTATION	
APPROVED	<i>December 16, 2008</i> <i>Alfred...</i> DIRECTOR OF PUBLIC WORKS
PASSED	<i>December 19, 2008</i> <i>Christina...</i> DISTRICT #1 ENGINEER OF LOCAL ROADS & STREETS
Releasing for Bid Based on Limited Review <i>December 22, 2008</i>	
	<i>Diana M. O'Keefe</i> DEPUTY DIRECTOR OF HIGHWAYS, REGION 1 ENGINEER

CONTRACT NO: 63090

GENERAL NOTES

- STANDARD SPECIFICATIONS: ALL ITEMS OF WORK SHALL BE PERFORMED IN ACCORDANCE WITH APPLICABLE ARTICLES OF THE STANDARD SPECIFICATIONS FOR ROAD AND BRIDGE CONSTRUCTION, ADOPTED JANUARY 1, 2007 BY THE ILLINOIS DEPARTMENT OF TRANSPORTATION.
- MATERIAL CERTIFICATION: THE CONTRACTOR IS REMINDED THAT ALL MATERIALS USED IN THE PROJECT MUST BE STATE INSPECTED. SUBMIT INSPECTION REPORTS TO THE ENGINEER TO AVOID DELAY IN FINAL INSPECTION OF THE PROJECT.
- PRESERVATION OF TREES AND SHRUBS: EXISTING TREES AND SHRUBS SHALL BE PROTECTED WITH SNOW FENCING AS DIRECTED BY THE ENGINEER DURING THE CONSTRUCTION OF THE IMPROVEMENT. THIS WORK SHALL BE CONSIDERED INCIDENTAL TO THE COST OF THE PROJECT.
- EXISTING PAVEMENT: EXISTING PAVEMENT, DRIVEWAY PAVEMENT, SIDEWALK AND CURB AND GUTTER THAT IS TO REMAIN IN PLACE SHALL BE SAW-CUT TO PROVIDE A NEAT VERTICAL FACE BETWEEN THE PROPOSED AND EXISTING SURFACES.
- SIGNS: THE CONTRACTOR SHALL NOT REMOVE OR RELOCATE ANY PARKWAY SIGNS. HE SHALL NOTIFY THE ENGINEER WITHIN 24 HOURS TO HAVE THE PARKWAY SIGN REMOVED BY THE VILLAGE. THE CONTRACTOR SHALL BE RESPONSIBLE FOR ANY DAMAGE THAT MAY OCCUR TO THE SIGNS UNTIL THEY ARE REMOVED BY THE VILLAGE.

LEGEND

SYMBOL	DESCRIPTION
⊙	EXISTING MANHOLE
○	EXISTING INLET
□	UTILITY BOX
⊕	EXISTING STREETLIGHT/UTILITY POLE
⊗	FIRE HYDRANT
☼	EXISTING TREE
▤	DETECTABLE WARNING
▨	CURB REMOVAL & REPLACEMENT
▩	SIDEWALK REMOVAL (NO REPLACEMENT)

SUMMARY OF QUANTITIES

CODE NO.	PAY ITEM	UNIT	TOTAL QUANTITY	CONSTRUCTION CODE SFTY-1B		
				BUSSE RD	GOLF RD	LINNEMAN RD
20200100	EARTH EXCAVATION	CU YD	315	125	80	110
21101615	TOPSOIL FURNISH AND PLACE, 4"	SQ YD	1165	425	370	370
25200100	SODDING	SQ YD	1165	425	370	370
35101600	AGGREGATE BASE COURSE, TYPE B, 4"	SQ YD	1010	410	245	355
42400200	PORTLAND CEMENT CONCRETE SIDEWALK 5 INCH	SQ FT	8120	3170	2075	2875
42400300	PORTLAND CEMENT CONCRETE SIDEWALK 6 INCH	SQ FT	300	0	150	150
42400410	PORTLAND CEMENT CONCRETE SIDEWALK 8 INCH	SQ FT	645	495	0	150
42400800	DETECTABLE WARNINGS	SQ FT	96	64	0	32
44000200	DRIVEWAY PAVEMENT REMOVAL	SQ YD	105	55	15	35
44000600	SIDEWALK REMOVAL	SQ FT	600	600	0	0
44001700	COMBINATION CONCRETE CURB AND GUTTER REMOVAL AND REPLACEMENT	FOOT	120	80	0	40
44004400	PAVEMENT REMOVAL (SPECIAL)	SQ YD	65	35	10	20
48301000	PROTECTIVE COAT	SQ YD	1010	410	245	355
60300305	FRAMES AND LIDS TO BE ADJUSTED	EACH	2	2	0	0
67100100	MOBILIZATION	L SUM	1	0.33	0.33	0.33
70101700	TRAFFIC CONTROL AND PROTECTION	L SUM	1	0.33	0.33	0.33

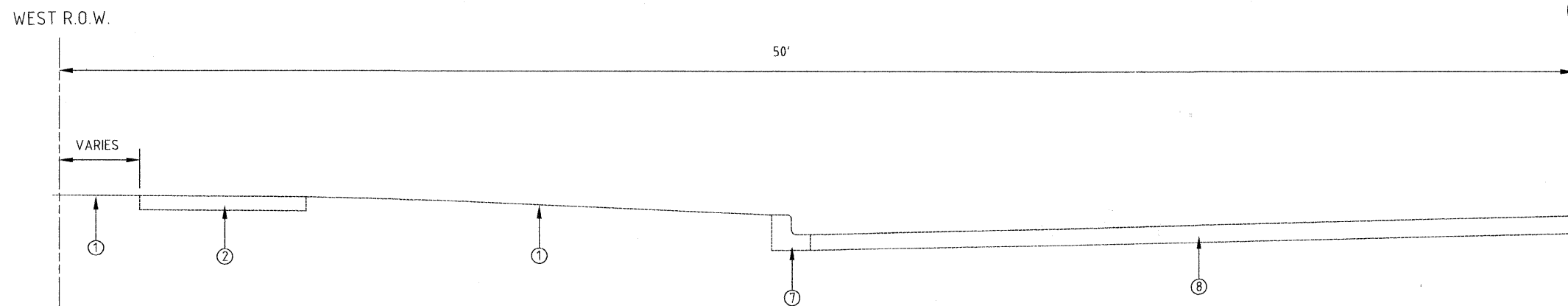

EXISTING TYPICAL CROSS-SECTION BUSSE RD

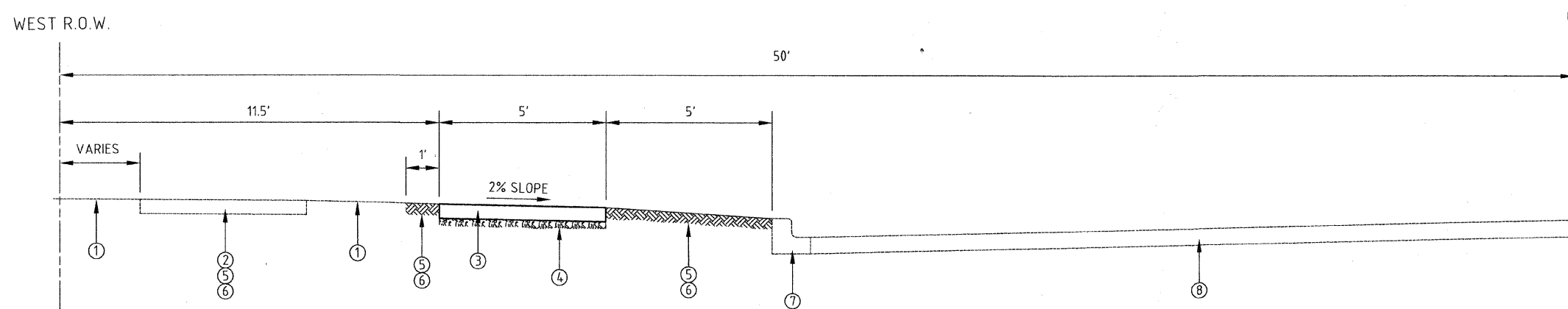

PROPOSED TYPICAL CROSS-SECTION BUSSE RD

NOTE:

1. SEE DETAIL FOR DRIVEWAYS WITH CURB, SHEET NO. 9
2. EXACT LOCATION FOR SIDEWALK AND CURB AND GUTTER REMOVAL AND REPLACEMENT WILL BE DETERMINED BY THE ENGINEER IN THE FIELD.

LEGEND:

- ① EXISTING PARKWAY
- ② EXISTING SIDEWALK TO BE REMOVED
- ③ PROPOSED PORTLAND CEMENT CONCRETE SIDEWALK, 5"
- ④ PROPOSED AGGREGATE BASE COURSE TYPE B, 4"
- ⑤ PROPOSED TOP SOIL, 4"
- ⑥ PROPOSED SODDING
- ⑦ EXISTING COMBINATION CONCRETE CURB AND GUTTER, B6.24
- ⑧ EXISTING PAVEMENT

F.A.U. RTE.	SECTION	COUNTY	TOTAL SHEETS	SHEET NO.
	08-00152-00-SW	COOK	9	4
FED. ROAD DIST. NO.		ILLINOIS	FED. AID PROJECT	

CONTRACT NO: 63090

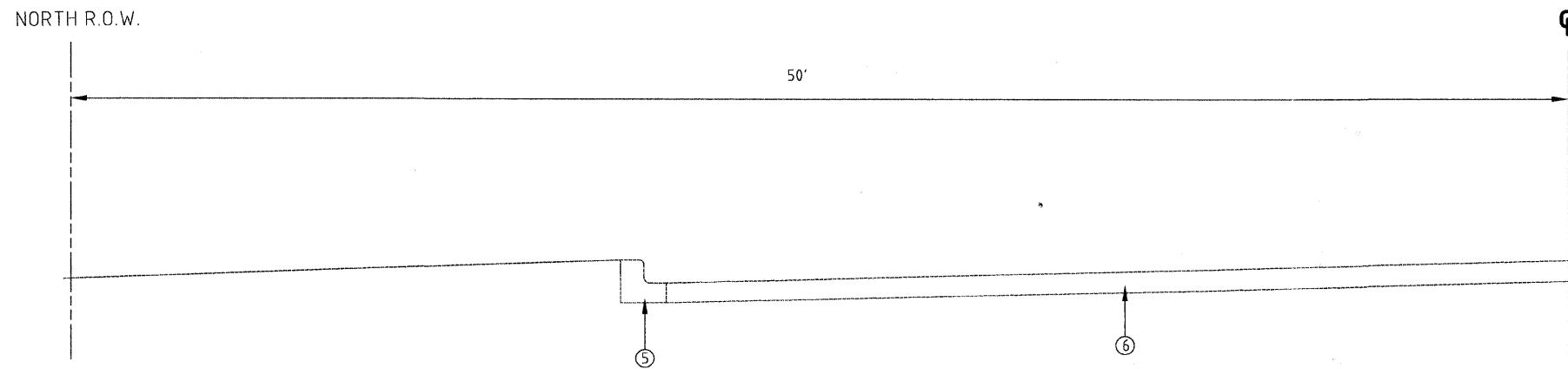

EXISTING TYPICAL CROSS-SECTION GOLF RD

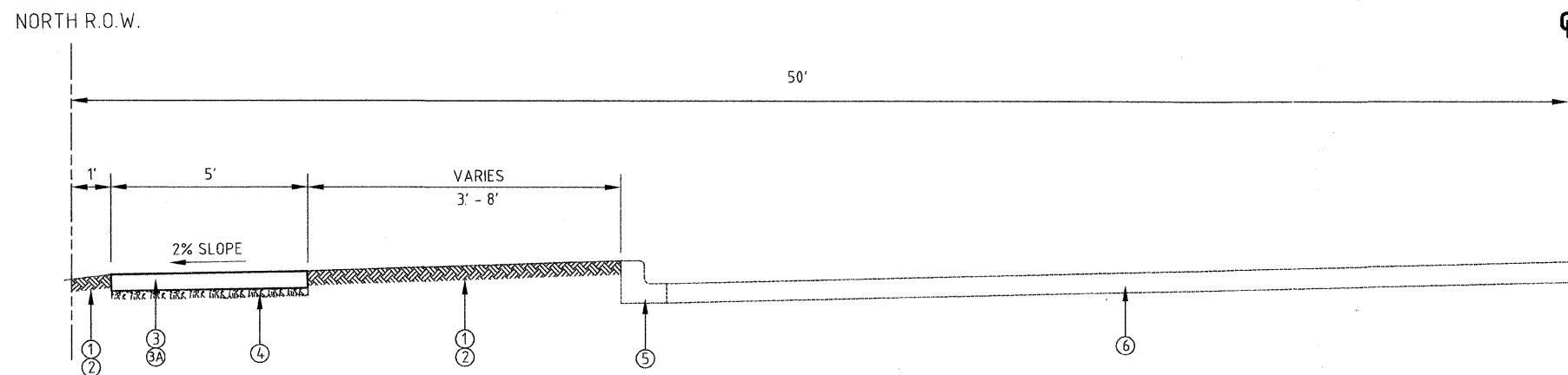

PROPOSED TYPICAL CROSS-SECTION GOLF RD

NOTE:

EXACT LOCATION FOR SIDEWALK AND CURB AND GUTTER REMOVAL AND REPLACEMENT WILL BE DETERMINED BY THE ENGINEER IN THE FIELD.

LEGEND:

- ① PROPOSED TOPSOIL, 4"
- ② PROPOSED SODDING
- ③ PROPOSED PORTLAND CEMENT CONCRETE SIDEWALK, 5"
- ③A PROPOSED PORTLAND CEMENT CONCRETE SIDEWALK, 6" THROUGH DRIVEWAYS WITHOUT CURB
- ④ PROPOSED AGGREGATE BASE COURSE TYPE B, 4"
- ⑤ EXISTING COMBINATION CONCRETE CURB AND GUTTER, B6.24
- ⑥ EXISTING PAVEMENT

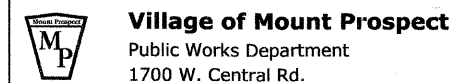

EXISTING AND PROPOSED TYPICAL SECTION
GOLF RD SIDEWALK

STA 0+00 TO STA 4+45
SCALE: NONE

F.A.U. RTE.	SECTION	COUNTY	TOTAL SHEETS	SHEET NO.
	08-00152-00-SW	COOK	9	5
FED. ROAD DIST. NO.		ILLINOIS	FED. AID PROJECT	

CONTRACT NO: 63090

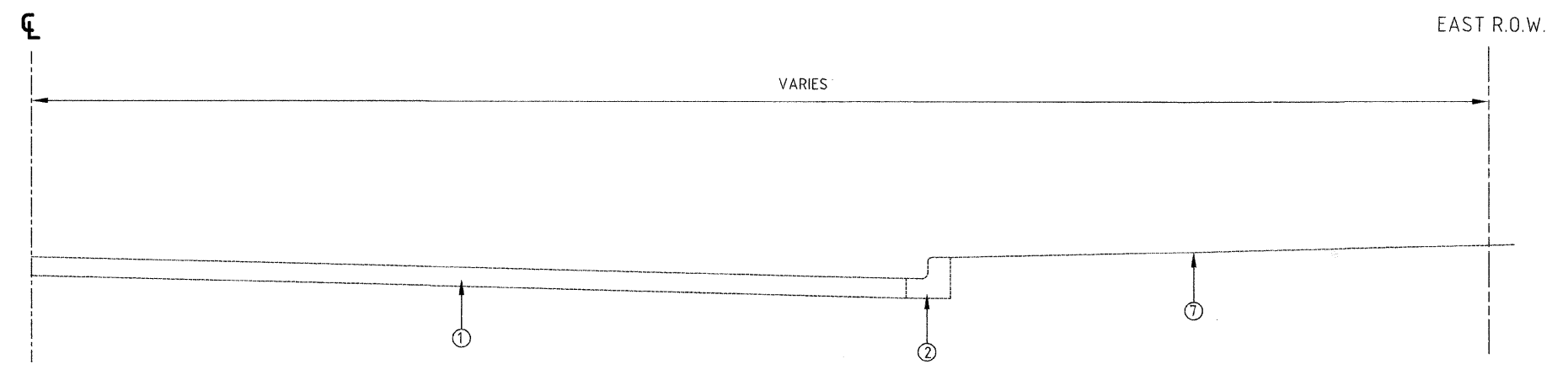

EXISTING TYPICAL CROSS-SECTION LINNEMAN RD

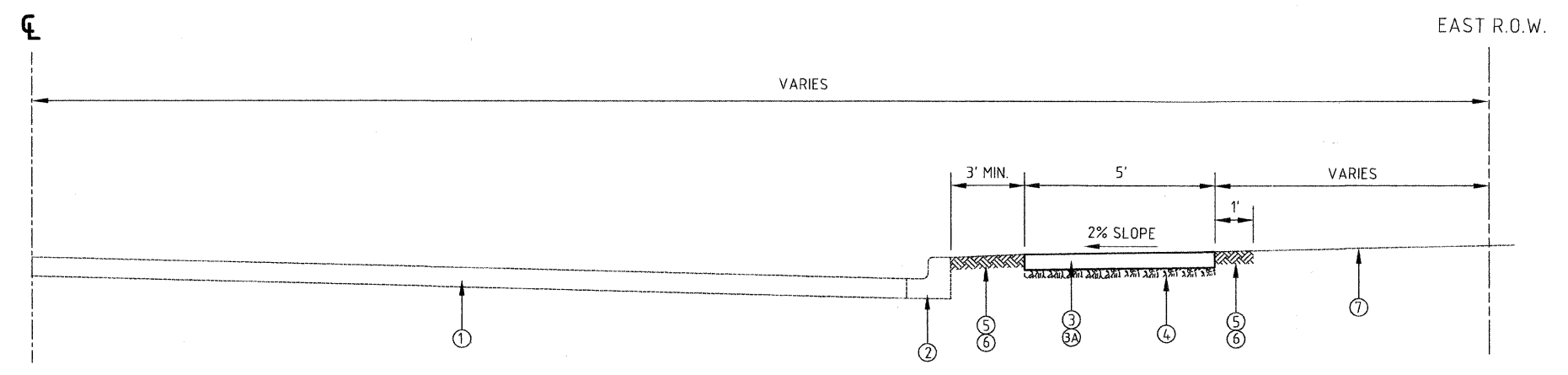

PROPOSED TYPICAL CROSS-SECTION LINNEMAN RD

NOTE:

1. SEE DETAIL FOR DRIVEWAYS WITH CURB, SHEET NO. 9
2. EXACT LOCATION FOR SIDEWALK AND CURB AND GUTTER REMOVAL AND REPLACEMENT WILL BE DETERMINED BY THE ENGINEER IN THE FIELD.

LEGEND:

- ① EXISTING PAVEMENT
- ② EXISTING COMBINATION CONCRETE CURB AND GUTTER, B6.12
- ③ PROPOSED PORTLAND CEMENT CONCRETE SIDEWALK, 5"
- ③A PROPOSED PORTLAND CEMENT CONCRETE SIDEWALK, 6" THROUGH DRIVEWAYS WITHOUT CURB
- ④ PROPOSED AGGREGATE BASE COURSE TYPE B, 4"
- ⑤ PROPOSED TOPSOIL, 4"
- ⑥ PROPOSED SODDING
- ⑦ EXISTING PARKWAY

Village of Mount Prospect
Public Works Department
1700 W. Central Rd.

EXISTING AND PROPOSED TYPICAL SECTION
LINNEMAN RD SIDEWALK

STA 0+80 TO STA 7+00
SCALE: NONE

F.A.U. RTE.	SECTION	COUNTY	TOTAL SHEETS	SHEET NO.
	08-00152-00-SW	COOK	9	6
FED. ROAD DIST. NO.		ILLINOIS	FED. AID PROJECT	

CONTRACT NO: 63090

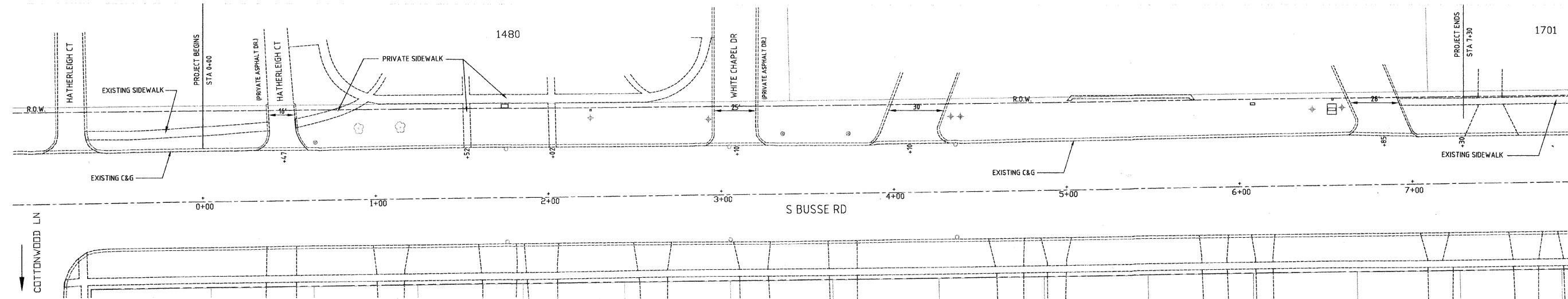

EXISTING SIDEWALK
BUSSE RD

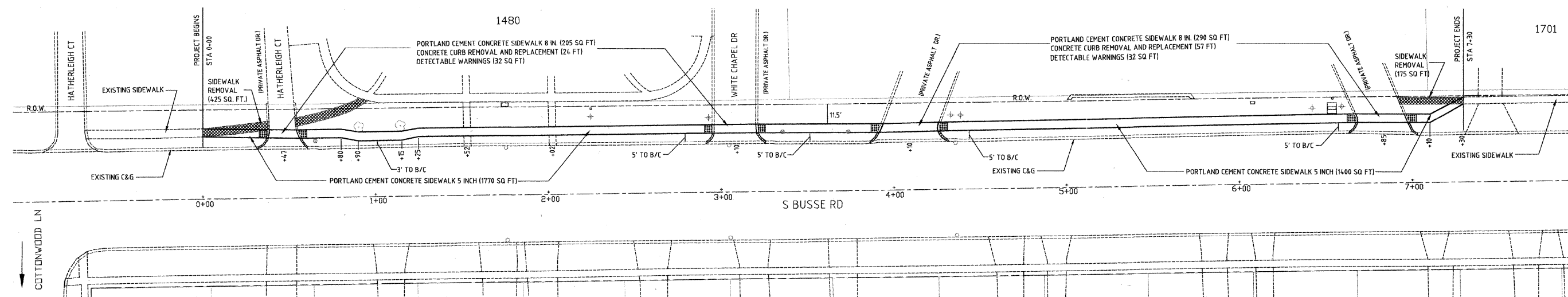

PROPOSED SIDEWALK
BUSSE RD

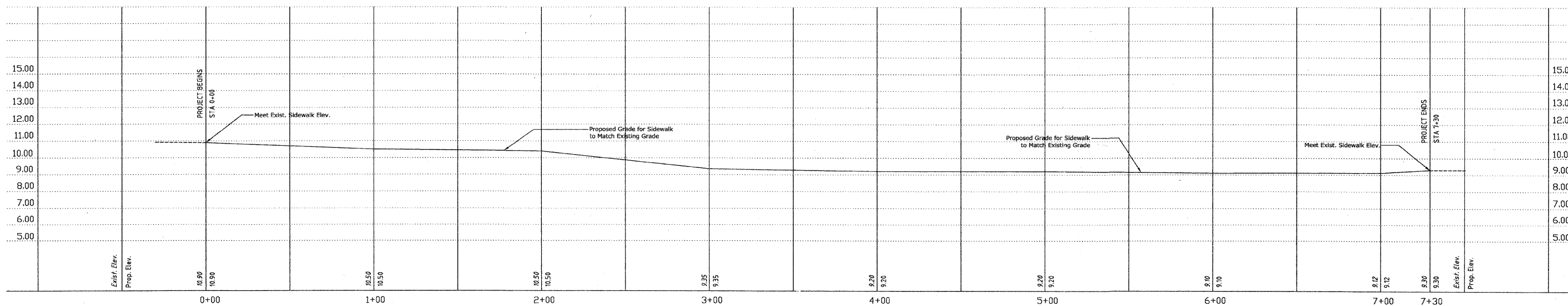

Village of Mount Prospect
Public Works Department
1700 W. Central Rd.

PLAN AND PROFILE
BUSSE RD SIDEWALK

STA 0+00 TO STA 7+30

SCALE: VERTICAL: 1" = 3'
HORIZONTAL: 1" = 30'

F.A.U. RTE.	SECTION	COUNTY	TOTAL SHEETS	SHEET NO.
	08-00152-00-SW	COOK	9	7
FED. ROAD DIST. NO.		ILLINOIS	FED. AID PROJECT	

CONTRACT NO: 63090

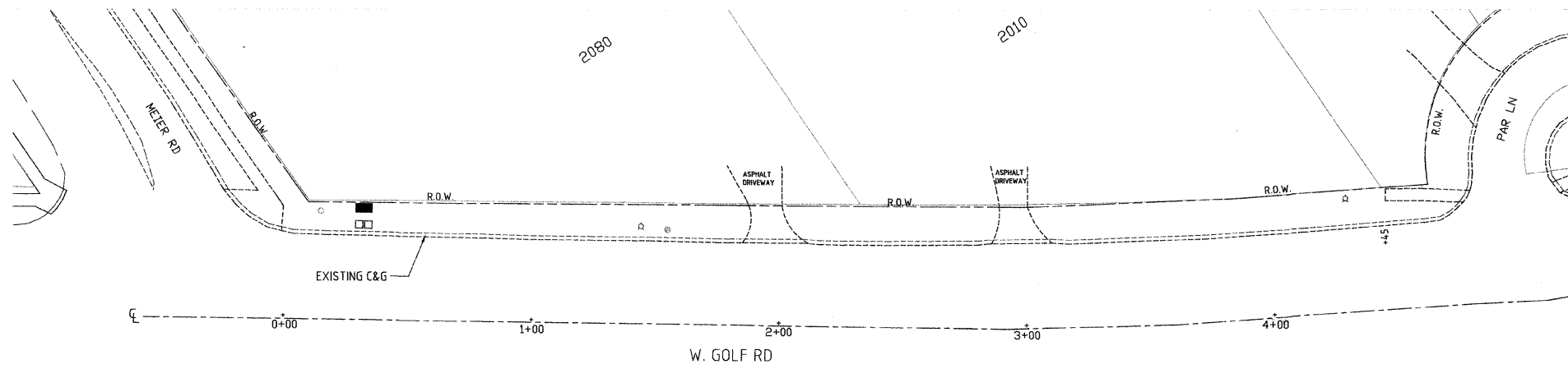

EXISTING GOLF RD SIDEWALK

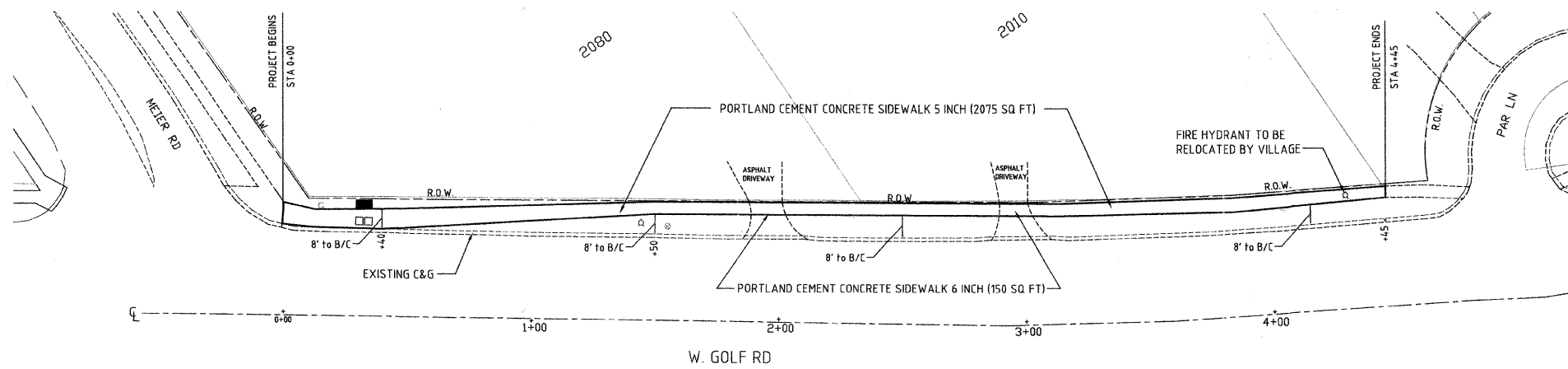

PROPOSED GOLF RD SIDEWALK

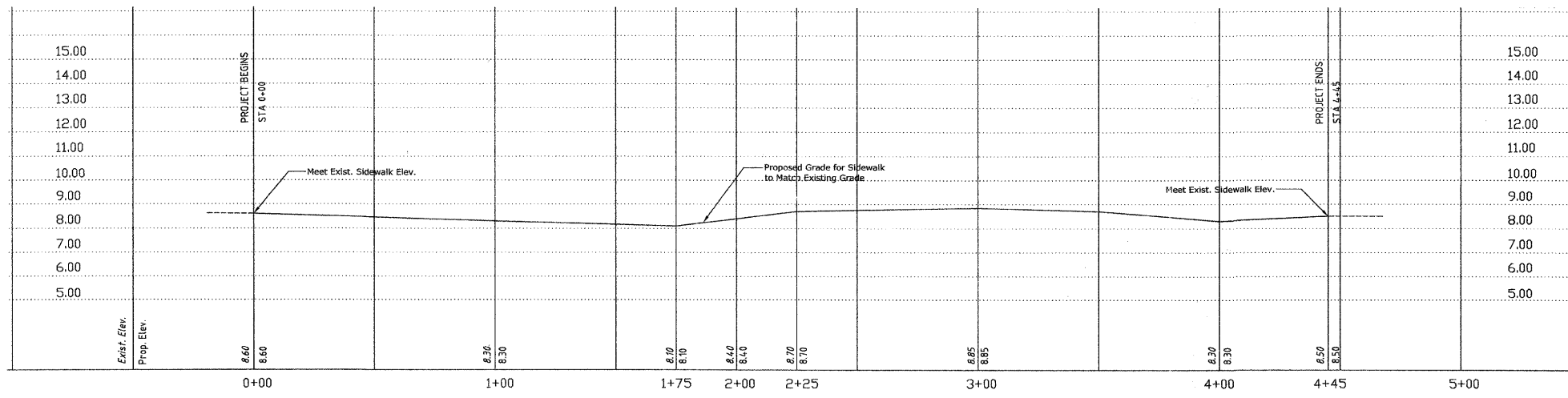

Village of Mount Prospect
Public Works Department
1700 W. Central Rd.

PLAN AND PROFILE
GOLF RD SIDEWALK

STA 0+00 TO STA 4+45
SCALE: VERTICAL: 0' = 1" 3'
HORIZONTAL: 0' = 10" 30'

F.A.U. RTE.	SECTION	COUNTY	TOTAL SHEETS	SHEET NO.
	08-00152-00-SW	COOK	9	8
FED. ROAD DIST. NO.		ILLINOIS	FED. AID PROJECT	

CONTRACT NO: 63090

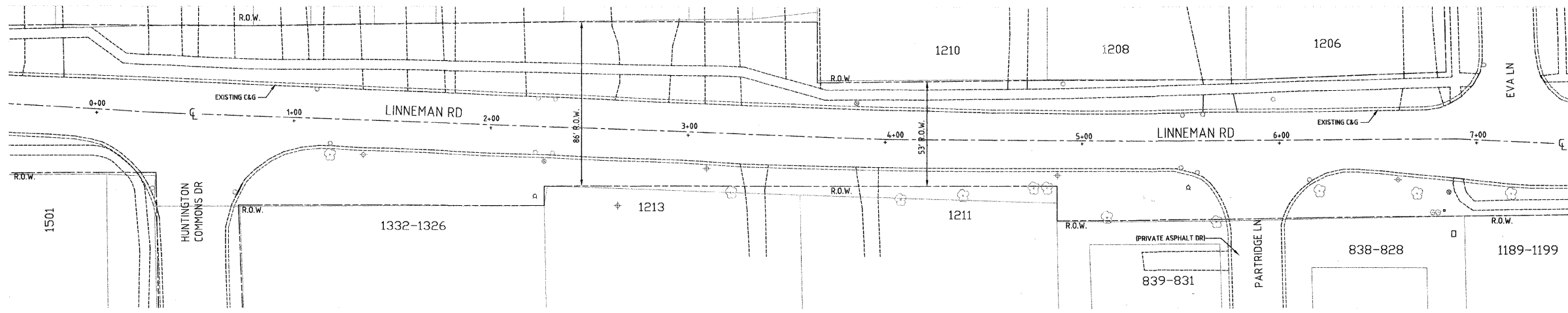

EXISTING LINNEMAN RD SIDEWALK

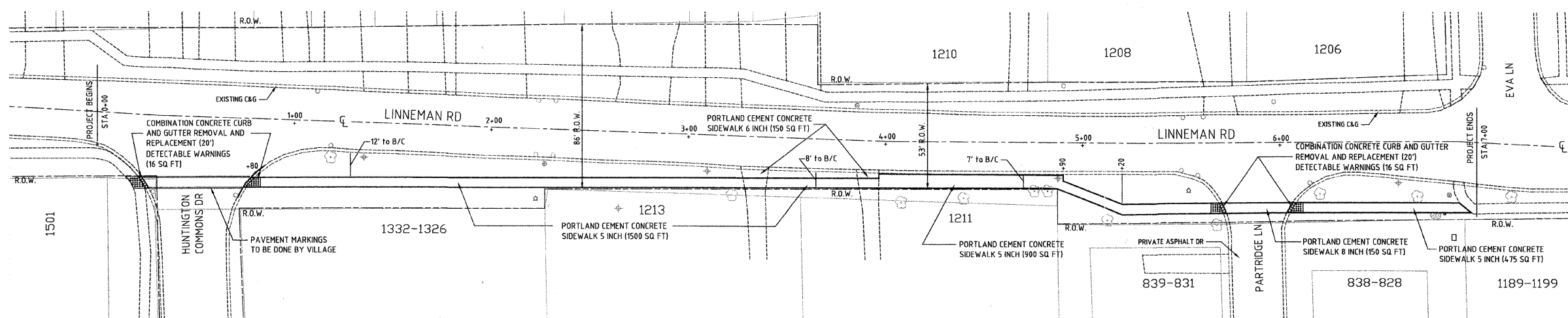

PROPOSED LINNEMAN RD SIDEWALK

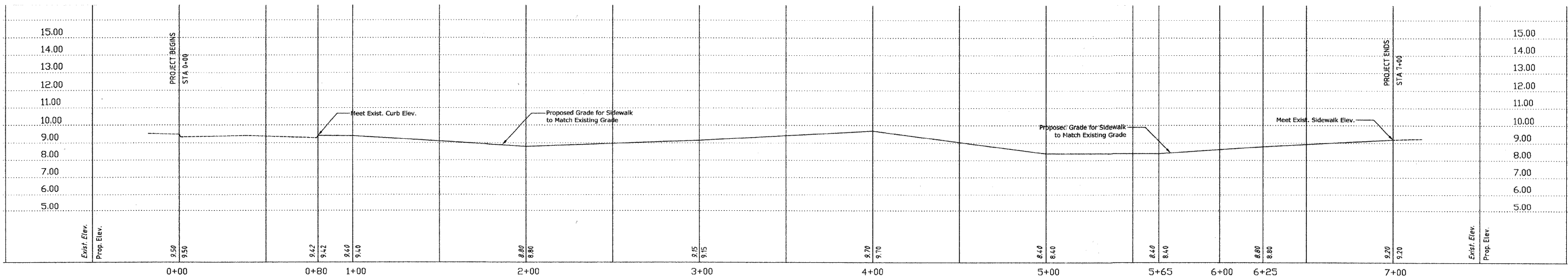

Village of Mount Prospect
Public Works Department
1700 W. Central Rd.

PLAN AND PROFILE
LINNEMAN RD SIDEWALK

STA 0+80 TO STA 7+00

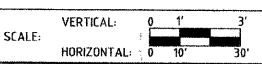

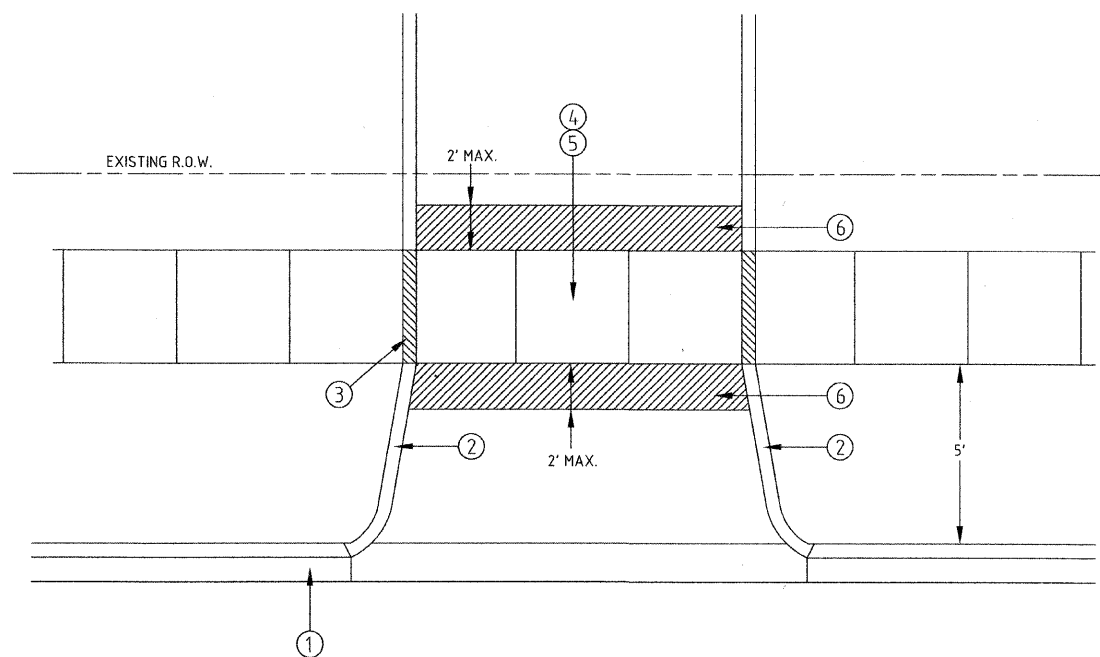

TYPICAL DRIVEWAY WITH CURB DETAIL

LEGEND:

- ① EXISTING COMBINATION CONCRETE CURB AND GUTTER B6.24
- ② EXISTING CONCRETE BARRIER CURB
- ③ PROPOSED CONCRETE BARRIER CURB, DEPRESSED
- ④ PROPOSED PORTLAND CEMENT CONCRETE SIDEWALK, 8"
- ⑤ PROPOSED AGGREGATE BASE COURSE, TYPE B, 4"
- ⑥ HOT-MIX ASPHALT PAVEMENT PATCH TO BE PAID FOR AS PAVEMENT REMOVAL (SPECIAL)

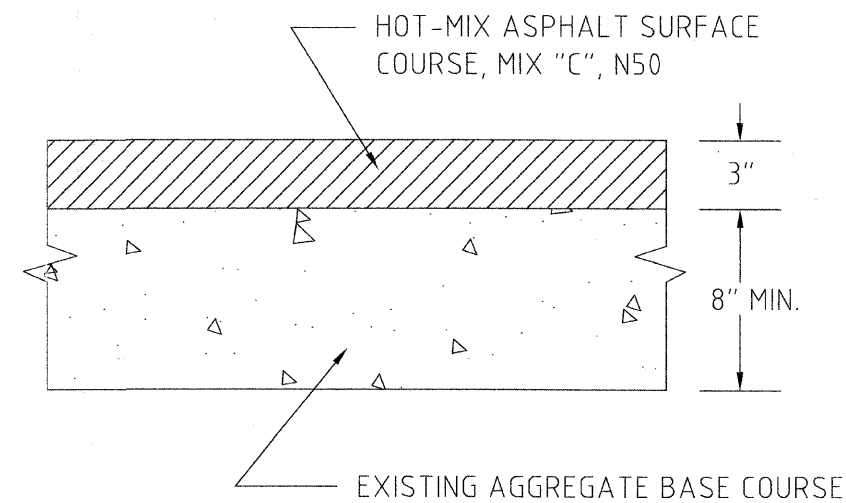

HOT-MIX ASPHALT PAVEMENT PATCH DETAIL