

Prop. Curve PATH-1
 PI Sta. 12+72.15
 $\Delta = 7^\circ 55' 21''$ (RT)
 $D = 25^\circ 27' 53''$
 $T = 15.58'$
 $R = 225.00'$
 $L = 31.11'$
 $E = 0.54'$
 PC Sta. 12+66.57
 PT Sta. 12+87.68

Prop. Curve PATH-2
 PI Sta. 13+41.64
 $\Delta = 5^\circ 18' 55''$ (LT)
 $D = 25^\circ 27' 53''$
 $T = 10.44'$
 $R = 225.00'$
 $L = 20.87'$
 $E = 0.24'$
 PC Sta. 13+31.20
 PT Sta. 13+52.07

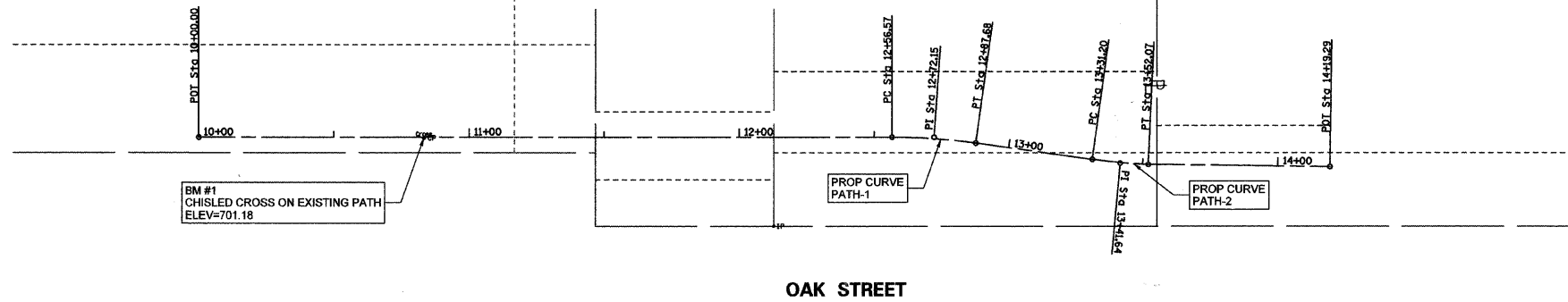

PLAN	SURVEYED	BY	DATE
NOTE BOOK	ALIGNED		
NO.	CHECKED		
	FILE NAME		

PROFILE	SURVEYED	BY	DATE
NOTE BOOK	GRADES		
NO.	CHECKED		
	STRUCTURE		

BENCHMARKS:
 BM #1
 CHISLED CROSS ON EXISTING PATH
 ELEV=701.18

FILE NAME =	USER NAME = _USER_	DESIGNED -	REVISED -
n:\dgn\ne\ne327\sheet\ne327\alignments\benchmarks.dgn		CHECKED -	REVISED -
	PLOT SCALE = 38.00 Ft / IN.	DRAWN -	REVISED -
	PLOT DATE = 11/14/2008	CHECKED -	REVISED -

STATE OF ILLINOIS
 DEPARTMENT OF TRANSPORTATION

ALIGNMENT AND
 BENCHMARK PLAN

SCALE: 1"=30' SHEET NO. OF SHEETS STA. TO STA.

F.A. RTE.	SECTION	COUNTY	TOTAL SHEETS	SHEET NO.
	07-00050-00-BT	KANE	15	5
FED. ROAD DIST. NO. [ILLINOIS] FED. AID PROJECT			CONTRACT NO. 63097	