

F. A. U. REC.	SECTION	COUNTY	TOTAL SHEETS	SHEET NO.
4304	04-00045-00-FP	WILL.	033	006
STA. TO STA.		FED. ROAD DIST. NO.		
		ILLINOIS FED. AID PROJECT		

CONTRACT #63108

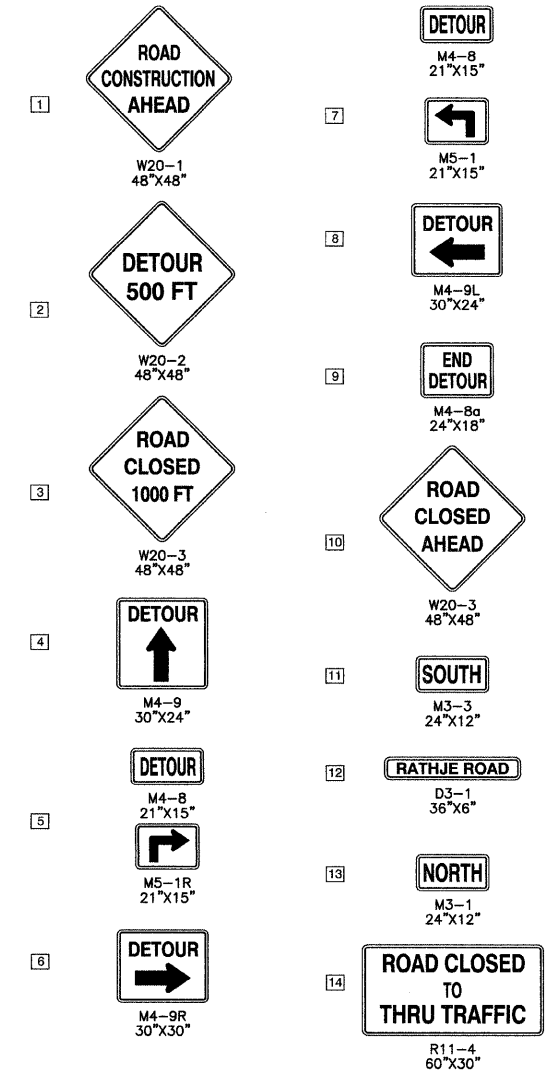
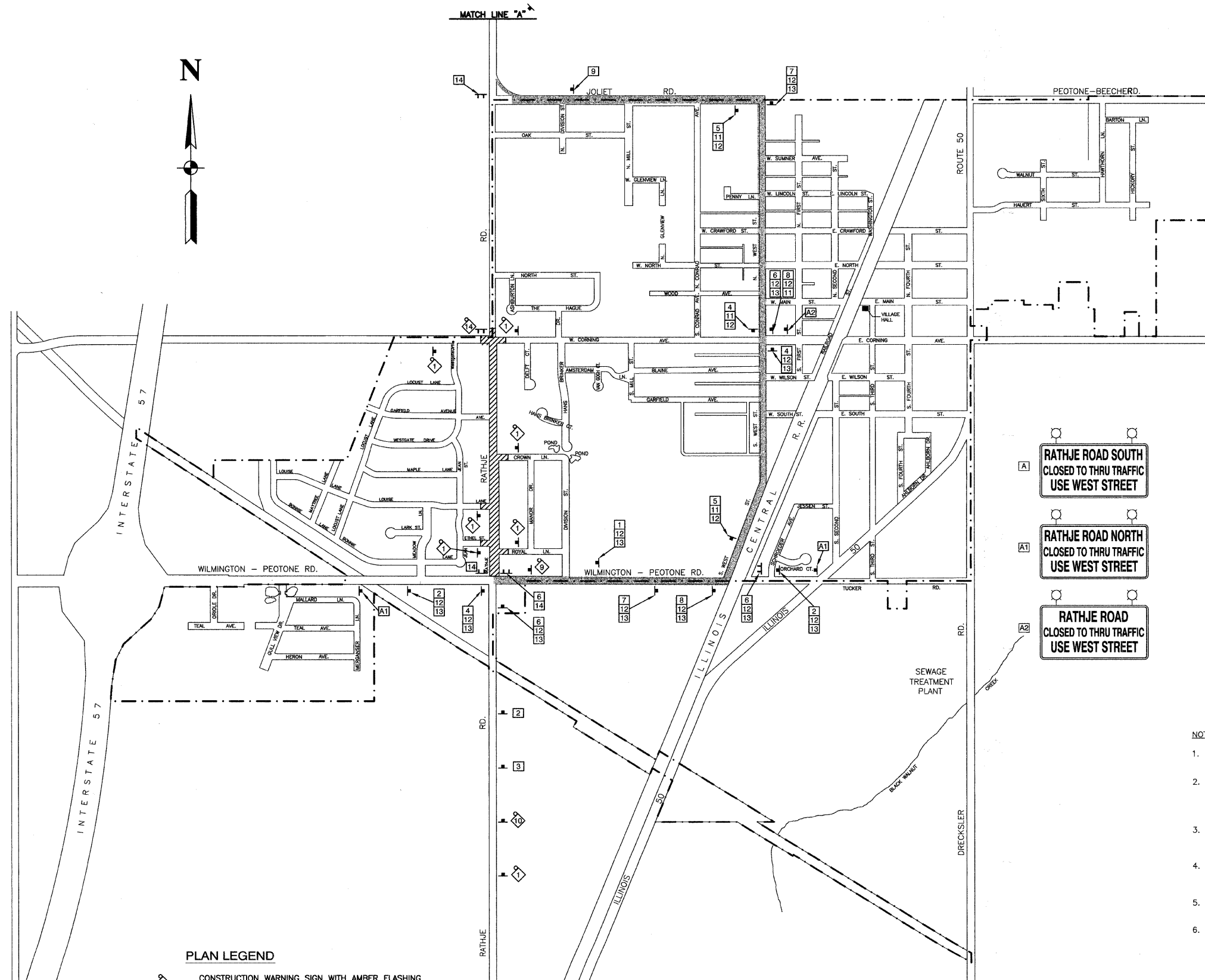

RATHJE ROAD SOUTH
CLOSED TO THRU TRAFFIC
USE WEST STREET

RATHJE ROAD NORTH
CLOSED TO THRU TRAFFIC
USE WEST STREET

RATHJE ROAD
CLOSED TO THRU TRAFFIC
USE WEST STREET

- NOTES:
1. ADVANCED CLOSURE SIGNS (CMS) SHALL BE ERECTED AT LEAST 10 DAYS PRIOR TO THE CLOSURE.
 2. ADDITIONAL CONSTRUCTION WARNING SIGN MAY BE REQUIRED (WHICH ARE NOT SHOWN IN THIS PLAN) AND SHALL BE PROVIDED AS PER THE INSTRUCTION OF THE ENGINEER IN CHARGE. THE COST INCURRED TO COMPLY WILL NOT BE PAID FOR SEPARATELY BUT INCLUDED IN THE ITEM "TRAFFIC PROTECTION."
 3. ALL SIGNS, BARRICADES, SIGN'S LIGHTS AND FLAGS SHALL BE IN ACCORDANCE WITH THOSE INDICATED IN TRAFFIC CONTROL STANDARDS OF MUTCD AND STANDARD SPECIFICATIONS.
 4. THE VILLAGE OF PEOTONE AND THE KANKAKEE COUNTY HIGHWAY DEPARTMENT SHALL BE NOTIFIED (2) WEEKS IN ADVANCE PRIOR TO THE OPERATION OF THIS DETOUR ROUTE FOR THE SUBJECT CONSTRUCTION.
 5. SPACING OF DETOUR SIGNS AND MAINTENANCE OF TRAFFIC STANDARDS SHALL BE PER THE MUTCD, PART 6.
 6. ACCESS THRU CORNING AVENUE SHALL BE MAINTAINED AT ALL TIMES.

PLAN LEGEND

	CONSTRUCTION WARNING SIGN WITH AMBER FLASHING LIGHT & ORANGE WARNING FLAG
	SUGGESTED DETOUR ROUTE
	CONSTRUCTION AREA DURING DETOUR
	TYPE III BARRICADE WITH STEADY BURNING LIGHT
	SIGN

REVISIONS	
NAME	DATE

ILLINOIS DEPARTMENT OF TRANSPORTATION

**RATHJE ROAD
ROAD RECONSTRUCTION
DETOUR PLAN**

SCALE: VERT. NA
HORIZ. NA
DATE 09-18-09

DRAWN BY AG
CHECKED BY HLG