

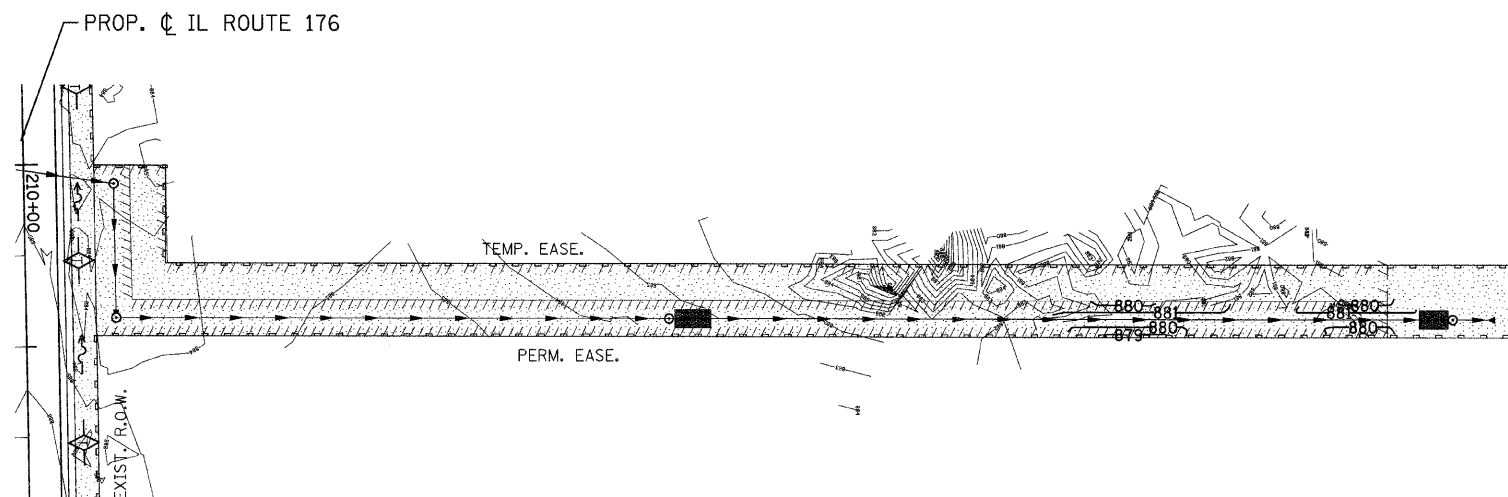



F.A. RTE.	SECTION	COUNTY	TOTAL SHEETS	SHEET NO.
0125	96-00091-00-FP	MCHENRY	73	25
STA.	TO STA.			
FED. ROAD DIST. NO.	ILLINOIS FED. AID PROJECT			
CONTRACT #63123				



OFFSITE STORM SEWER

LEGEND:

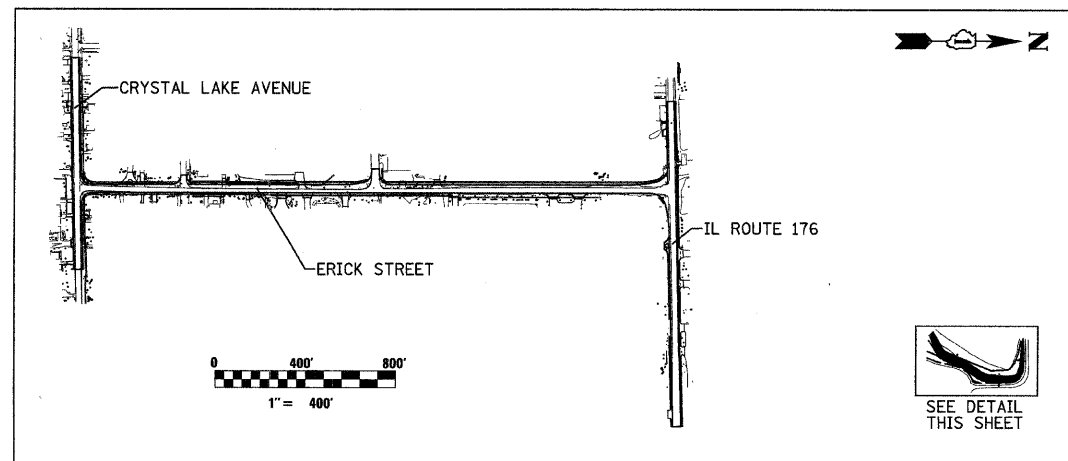

-  TEMPORARY EROSION CONTROL SEEDING
-  SEDIMENT CONTROL, SILT FENCE
-  INLET FILTERS
-  TEMPORARY DITCH CHECK

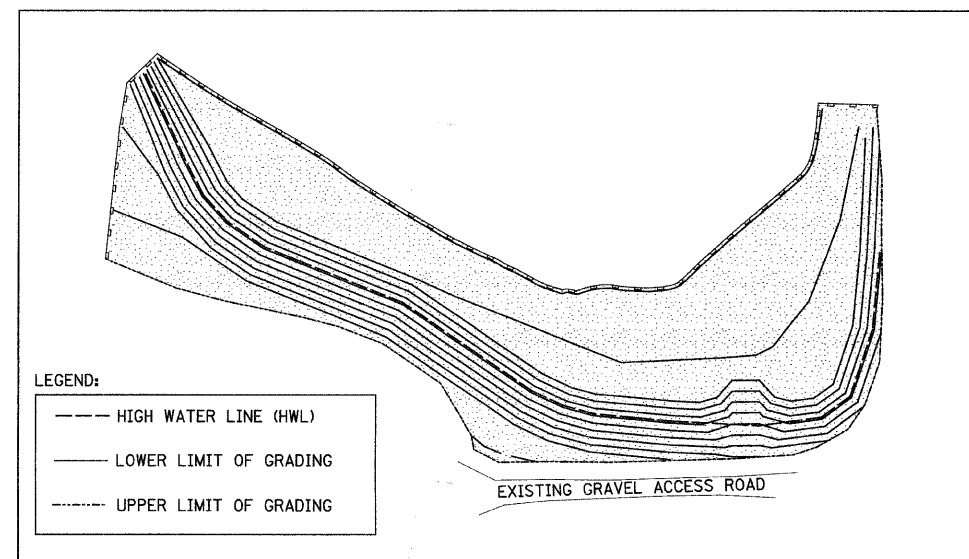

VICINITY MAP

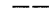
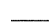

LEGEND:

-  HIGH WATER LINE (HWL)
-  LOWER LIMIT OF GRADING
-  UPPER LIMIT OF GRADING

AREA OF DETENTION POND GRADING

DETENTION POND

REVISIONS	
NAME	DATE

CITY OF CRYSTAL LAKE
ERICK STREET (FAU 0125)

EROSION AND SEDIMENT CONTROL PLAN
OFFSITE STORM SEWER AND DETENTION POND

SCALE: 1" = 50'
DATE: DECEMBER 15, 2008

DRAWN BY: EYC
CHECKED BY: ADJ