

FAU	SECTION	COUNTY	TOTAL SHEETS	SHEET NO.
0125	96-00091-00-FP	MCHENRY	73	61

STA. 18+50.00 TO 20+50.00
HORIZ. 1" = 10' VERT. 1" = 5'

CONTRACT #63123

STATION	SECTION	COUNTY	TOTAL SHEETS	SHEET NO.
915	910	905	900	900

DATE	BY

DATE	BY

DATE	BY

ERICK STREET

PROP PG.

910 905 900 910 905 900 915 910 905 900 915 910 905 900 920 915 910 905 900

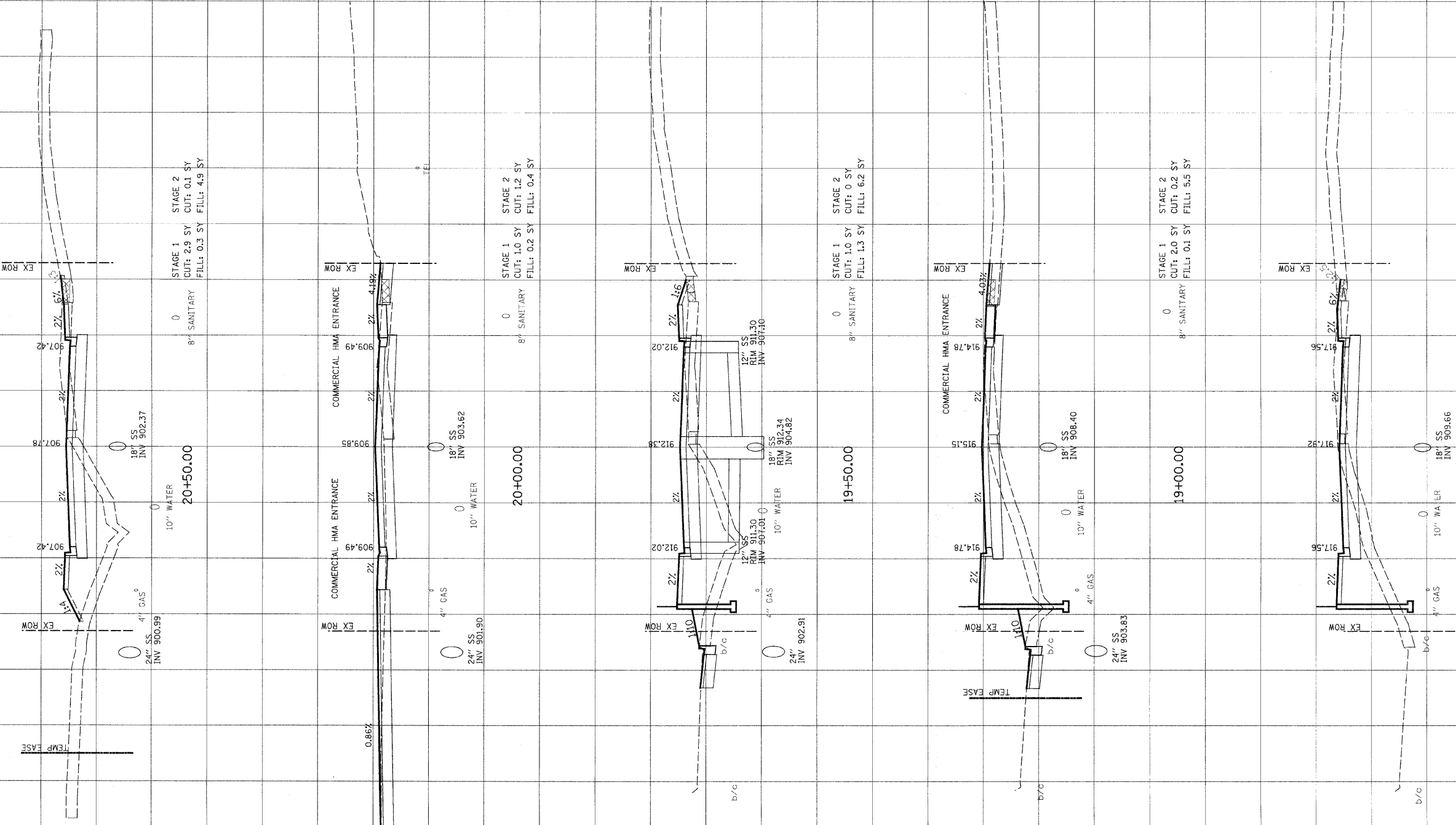

80 70 60 50 40 30 20 10 0 10 20 30 40 50 60 70 80

18+50.00

20+50.00

20+00.00

19+50.00

19+00.00

STAGE 1
CUT: 3.1 SY
FILL: 0.6 SY

STAGE 1
CUT: 0.1 SY
FILL: 0.3 SY

STAGE 1
CUT: 1.0 SY
FILL: 0.2 SY

STAGE 1
CUT: 1.0 SY
FILL: 1.3 SY

STAGE 1
CUT: 2.0 SY
FILL: 0.1 SY

910

900

900

900

900

900

900

900

900

900

910

905

905

905

905

910

905

905

905

905

910

905

905

905

905

910

905

905

905

905

910

905

905

905

905

910

905

905

905

905

910

905

905

905

905

910

905

905

905

905

910

905

905

905

905

910

905

905

905

905

910

905

905

905

905

910

905

905

905

905

910

905

905

905

905

910

905

905

905

905

910

905

905

905

905

910

905

905

905

905

910

905

905

905

905

910

905

905

905

905

910

905

905

905

905

910

905

905

905

905

910

905

905

905

905

910

905

905

905

905

910

905

905

905

905

910

905

905

905

905

910

905

905

905

905

910

905

905

905

905

910

905

905

905

905

910

905

905

905

905

910

905

905

905

905

910

905

905

905

905

910

905

905

905

905

910

905

905

905

905

910

905

905

905

905

910

905

905

905

905

910

905

905

905

905

910

905

905

905

905

910

905

905

905

905

910

905

905

905

905

910

905

905

905

905

910

905

905

905

905

910

905

905

905

905

910

905

905

905

905

910

905

905

905

905

910

905

905

905

905

910

905

905

905

905

910

905

905

905

905

910

905

905

905

905

910

905

905

905

905

910

905

905

905

905

910

905

905

905

905

910

905

905

905

905

910

905

905

905

905

910

905

905

905

905

910

905

905

905

905

910