

DATE	
BY	
SURVEYED	
PLANNED	
NOTED	
FILE NAME	

DATE	
BY	
SURVEYED	
PLANNED	
NOTED	
FILE NAME	

WILLIAM P. GUILFOYLE

CAROLINE M. COSTELLO

MATCHLINE STA. 2519+50

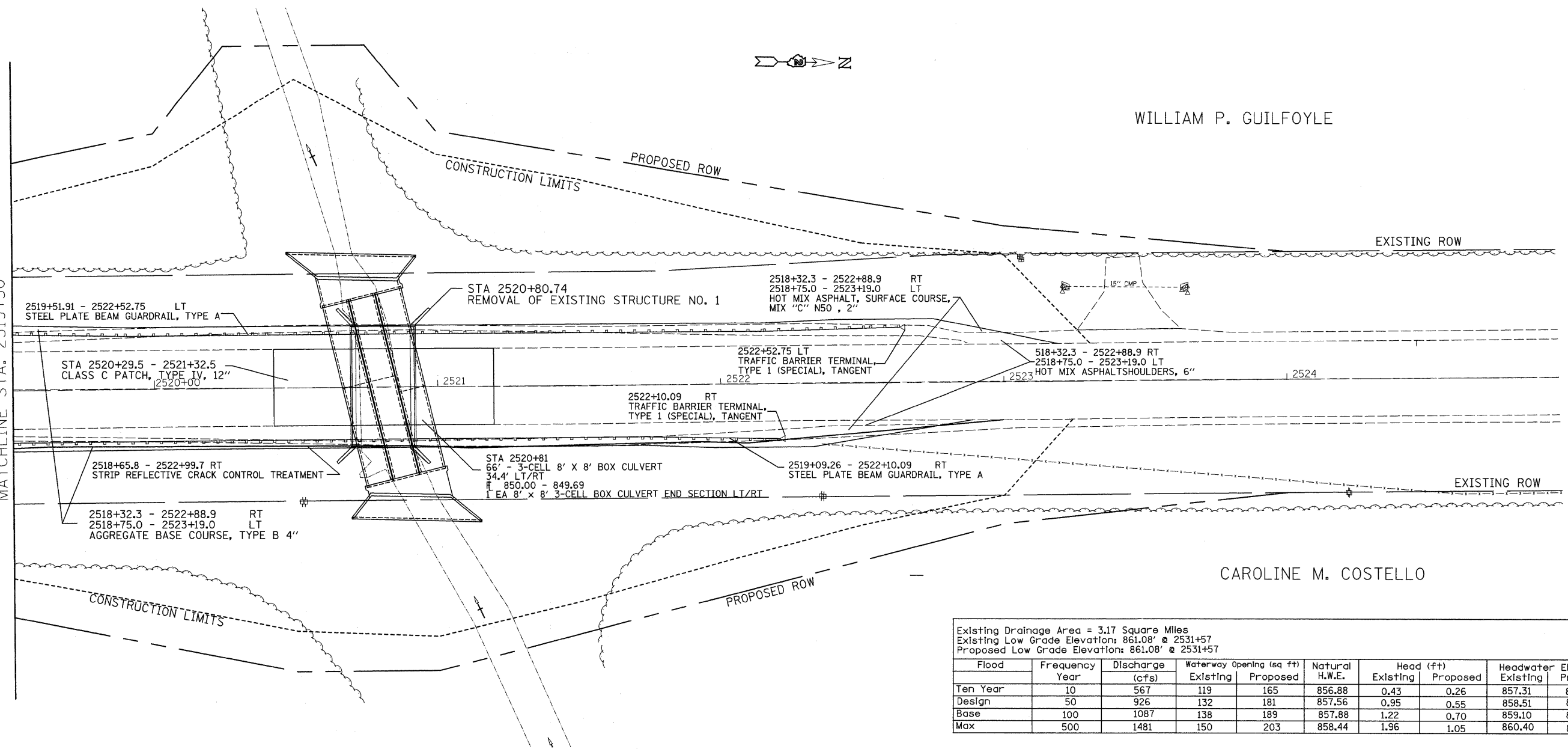

Existing Drainage Area = 3.17 Square Miles
 Existing Low Grade Elevation: 861.08' @ 2531+57
 Proposed Low Grade Elevation: 861.08' @ 2531+57

Flood	Frequency Year	Discharge (cfs)	Waterway Opening (sq ft)		Natural H.W.E.	Head (ft)		Headwater Elev. (ft)	
			Existing	Proposed		Existing	Proposed	Existing	Proposed
Ten Year	10	567	119	165	856.88	0.43	0.26	857.31	857.14
Design	50	926	132	181	857.56	0.95	0.55	858.51	858.11
Base	100	1087	138	189	857.88	1.22	0.70	859.10	858.58
Max	500	1481	150	203	858.44	1.96	1.05	860.40	859.49

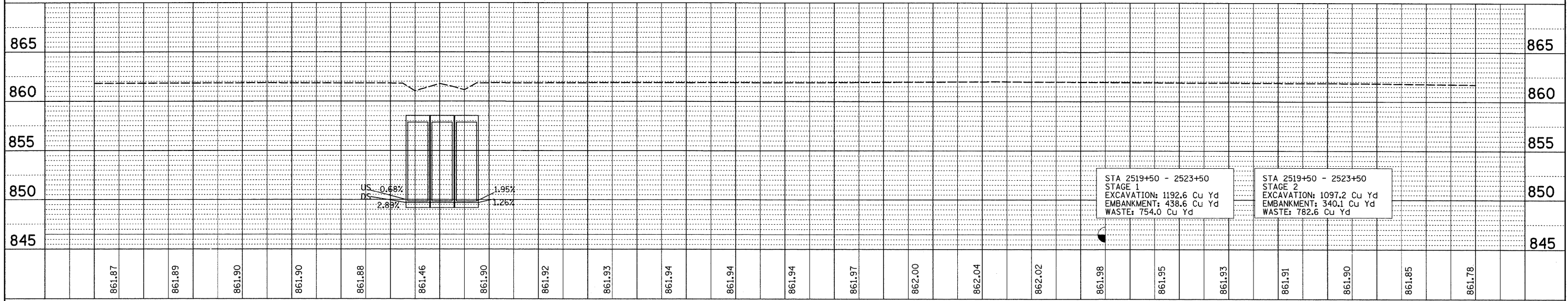

STA 2519+50 - 2523+50
 STAGE 1
 EXCAVATION: 1192.6 Cu Yd
 EMBANKMENT: 438.6 Cu Yd
 WASTE: 754.0 Cu Yd

STA 2519+50 - 2523+50
 STAGE 2
 EXCAVATION: 1097.2 Cu Yd
 EMBANKMENT: 340.1 Cu Yd
 WASTE: 782.6 Cu Yd

FILE NAME =	USER NAME = fordjd	DESIGNED -	REVISED -	STATE OF ILLINOIS DEPARTMENT OF TRANSPORTATION	IL 251	F.A.S. RTE.	SECTION	COUNTY	TOTAL SHEETS	SHEET NO.	
es:\pwork\pwork\fordjd\adms33877\0264A07	-sh-p\p\p\fordjd	DRAWN -	REVISED -			1177	111T	LASALLE	59	27	
PLOT SCALE = 20.000' / IN.	CHECKED -	REVISED -	REVISED -			CONTRACT NO. 64A07					
PLOT DATE = Wed Dec 24 14:10:12 2008	DATE -	REVISED -	REVISED -			FED. ROAD DIST. NO. ILLINOIS FED. AID PROJECT					