

SEQUENCE OF OPERATIONS						
PHASE	A			B		
INTERVAL	1	2	3	4	5	6
NORTHBOUND	G	Y	R	R	R	R
SOUTHBOUND	R	R	R	G	Y	R

STAGE I

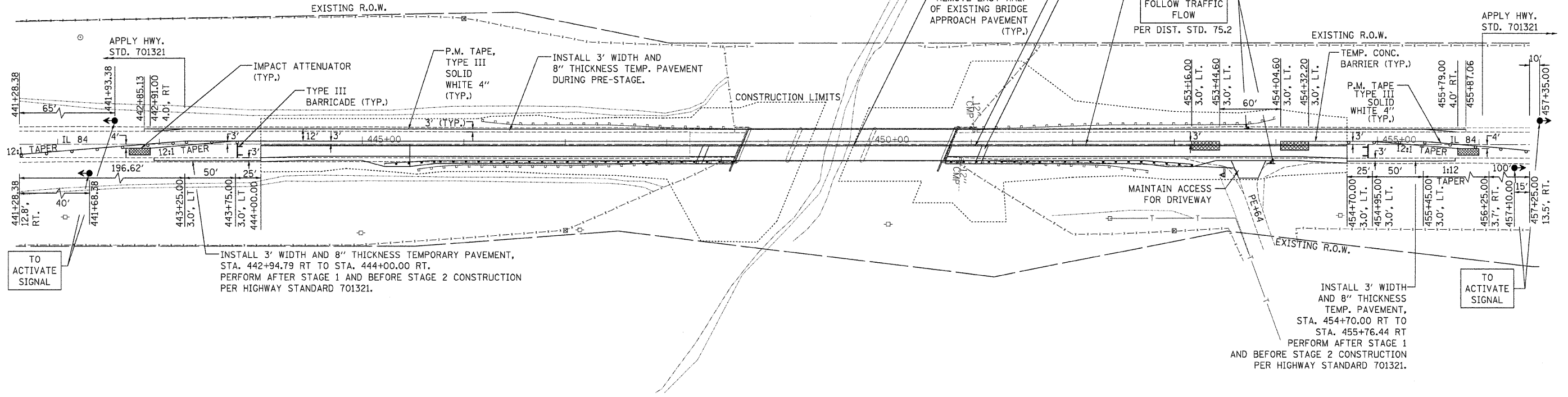

- PRE - STAGE CONSTRUCTION
- CLOSE SOUTHBOUND LANE AND REMOVE WEST SIDE SHOULDER 3' WIDTH AND REPLACE WITH 8" TEMPORARY PAVEMENT BETWEEN STA. 442+85.13 LT TO STA. 455+87.06 LT PER HIGHWAY STANDARD 701201. SEE TYPICAL SECTION ON THIS SHEET FOR DETAILS.
- STAGE I CONSTRUCTION
- REMOVE WEST SIDE EXISTING PAVEMENT MARKING EDGE LINE IMMEDIATELY PRIOR TO BARRIER WALL PLACEMENT IN ACCORDANCE WITH HIGHWAY STANDARD 701201.
 - CLOSE EAST HALF OF IL RTE 84 AS SHOWN IN ACCORDANCE WITH HIGHWAY STANDARD 701321.
 - REMOVE EAST HALF OF EXISTING BRIDGE SUPERSTRUCTURE, BRIDGE APPROACH PAVEMENT, APPROACH PAVEMENT DRAINS, SHOULDER, GUARDRAIL AND PORTIONS OF PAVEMENT AS SHOWN.
 - CONSTRUCT EAST HALF OF PROPOSED BRIDGE SUPERSTRUCTURE, APPROACH PAVEMENT, APPROACH PAVEMENT CONNECTORS, PIPE DRAINS AND INLETS, LEVELING BINDER, ENTRANCE, MAILBOX TURNOUT AND SHOULDER.
 - THE PROPOSED EAST SIDE HOT MIX ASPHALT SHOULDER SHALL BE CONSTRUCTED PER DISTRICT DETAIL 23.4 AND 23.4A.
 - CONSTRUCT EAST SIDE GRADING AND EROSION CONTROL.
 - INSTALL EAST SIDE GUARDRAILS PER PROPOSED PLANS.
 - RELOCATE EXISTING MAILBOX.
 - REMOVE EAST SIDE SHOULDER 3' WIDTH AND REPLACE WITH 8" TEMPORARY PAVEMENT BETWEEN STA. 442+94.79 RT TO STA. 444+00.00 RT, AND STA. 454+70.00 RT TO STA. 455+76.44 RT PER HIGHWAY STANDARD 701321.

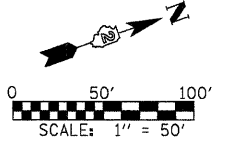
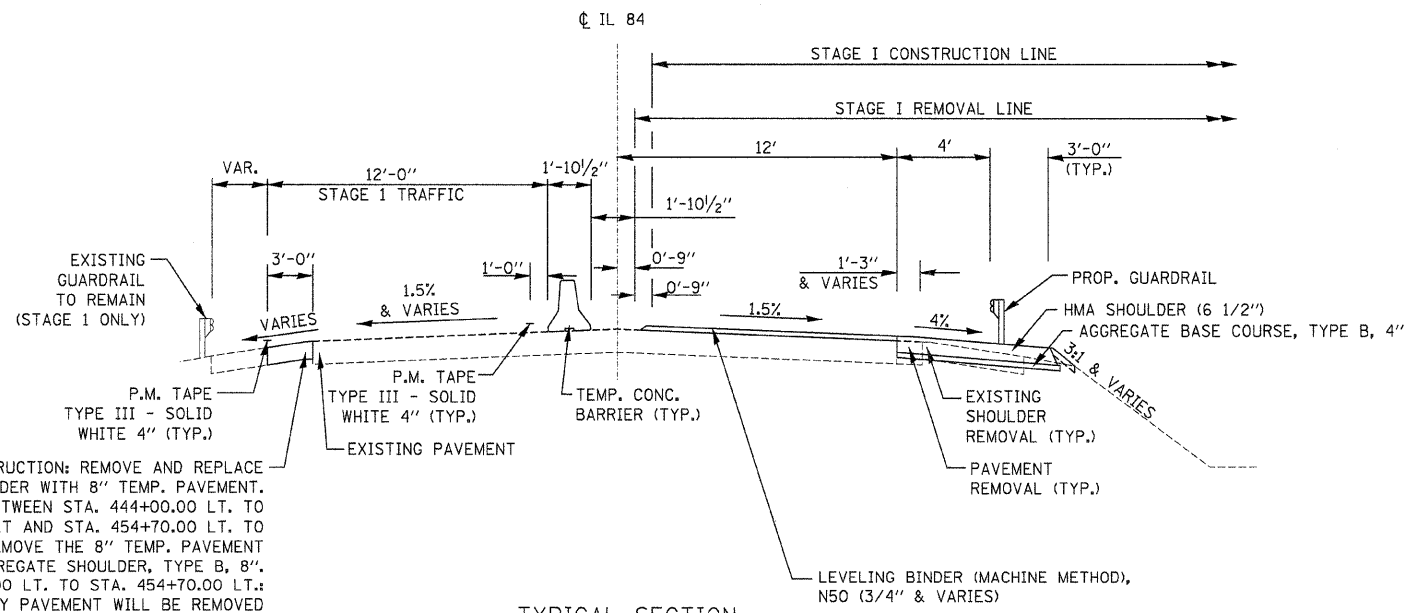

DURING PRE-STAGE CONSTRUCTION: REMOVE AND REPLACE EXISTING SHOULDER WITH 8" TEMP. PAVEMENT. AFTER STAGE I, BETWEEN STA. 444+00.00 LT. TO STA. 442+85.13 LT AND STA. 454+70.00 LT. TO STA. 455+87.06 LT.: REMOVE THE 8" TEMP. PAVEMENT AND REPLACE WITH AGGREGATE SHOULDER, TYPE B, 8". BETWEEN STA. 444+00.00 LT. TO STA. 454+70.00 LT.: THE 8" TEMPORARY PAVEMENT WILL BE REMOVED DURING STAGE II CONSTRUCTION AND REPLACED WITH PROPOSED HMA SHOULDER (6 1/2")

TYPICAL SECTION STAGE I

- GENERAL NOTES:
- MAINTENANCE OF TRAFFIC SHALL BE IN ACCORDANCE WITH HIGHWAY STANDARD 701321, AS SHOWN AND AS DIRECTED BY THE ENGINEER.
 - THE SIGN "TO ACTIVATE SIGNAL" SHOWN IN DISTRICT STANDARD 99.4 SHALL BE INSTALLED AT THE STOP LINE AS DIRECTED BY ENGINEER.
 - TEMPORARY SIGN "CAUTION ONE LANE ROAD FOLLOW TRAFFIC FLOW" TO BE INSTALLED PER DISTRICT STANDARD 75.2.
 - ALL DIMENSIONS ARE IN FEET.

FILE NAME = E:\0804 \ Stage and Traffic - 082606pin_50scale-STAGE I.dgn	USER NAME = DMM	DESIGNED - DMM	REVISED -
		DRAWN - DMM	REVISED -
		CHECKED - FML	REVISED -
		DATE - 05/20/2008	REVISED -

STATE OF ILLINOIS
DEPARTMENT OF TRANSPORTATION

MAINTENANCE OF TRAFFIC PLAN, STAGE I			
IL 84 OVER IRISH HOLLOW CREEK			
SCALE: 1" = 50'	SHEET NO.	OF SHEETS	STA. 444+00.00 TO STA. 454+70.00

F.A.P. RTE.	SECTION	COUNTY	TOTAL SHEETS	SHEET NO.
308	(103C-1BRID)	JO DAVIESS	62	14
CONTRACT NO. 64C03				
FED. ROAD DIST. NO. ILLINOIS FED. AID PROJECT				