

F.A.P. RTE.	SECTION	COUNTY	TOTAL SHEETS	SHEET NO.
301	(21VB)M	Stephenson	5	1
FED. ROAD DIST. NO.	ILLINOIS	CONTRACT NO. 64E66		

D-92-014-09

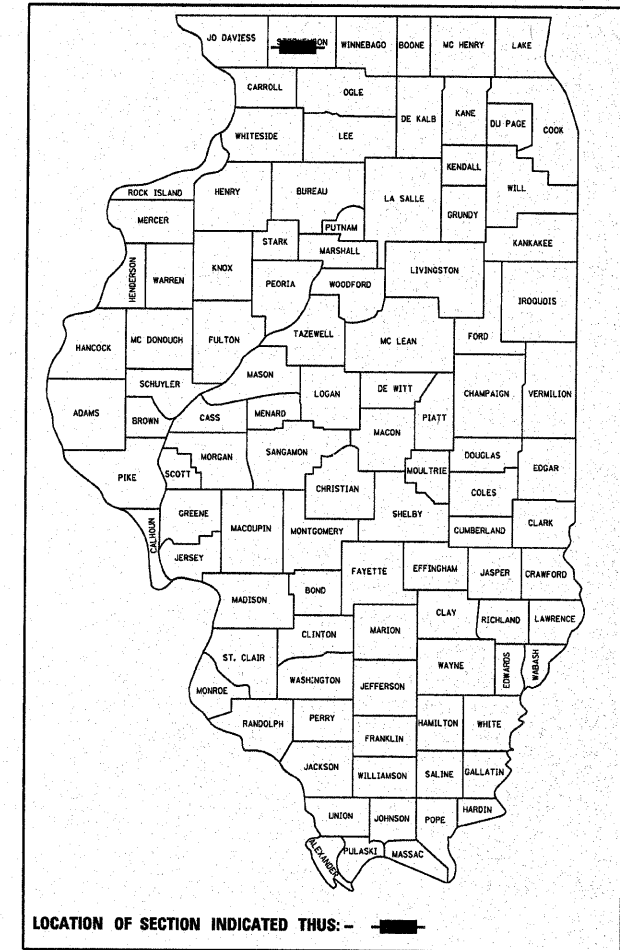

STATE OF ILLINOIS
DEPARTMENT OF TRANSPORTATION
DIVISION OF HIGHWAYS

**PROPOSED
HIGHWAY PLANS**

FAP ROUTE 301 (US 20)
SECTION (21VB)M

BRIDGE REPAIR
STEPHENSON COUNTY

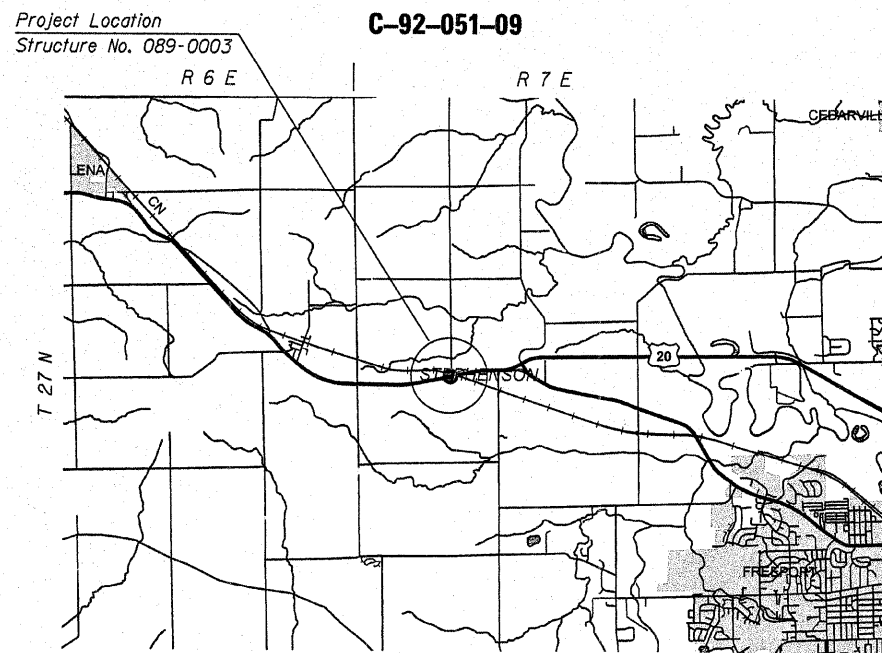

C-92-051-09

INDEX OF SHEETS

1. Cover Sheet, Index of Sheets, Standards
2. Summary of Quantities
3. General Notes
4. Plan & Elevation
5. Repair Details

STANDARDS

- 701001-02
- 701006-03
- 701201-03
- 701301-03
- 701901-01

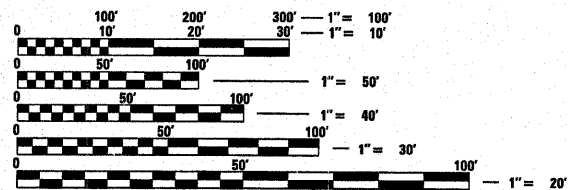

FULL SIZE PLANS HAVE BEEN PREPARED USING STANDARD ENGINEERING SCALES. REDUCED SIZED PLANS WILL NOT CONFORM TO STANDARD SCALES. IN MAKING MEASUREMENTS ON REDUCED PLANS, THE ABOVE SCALES MAY BE USED.

J.U.L.I.E.
JOINT UTILITY LOCATION INFORMATION FOR EXCAVATION
1-800-892-0123
OR 811

PROJECT ENGINEER: Mahmoud Etemadi 815/284-5393

GROSS LENGTH = 264 FT. = 0.05 MILE
NET LENGTH = 264 FT. = 0.05 MILE

CONTRACT NO. 64E66

STATE OF ILLINOIS
DEPARTMENT OF TRANSPORTATION
DIVISION OF HIGHWAYS

SUBMITTED December 5, 2008
George F. Ryan
DEPUTY DIRECTOR OF HIGHWAYS, REGION ENGINEER
January 30, 2009
Charles J. Ingersoll
ENGINEER OF DESIGN AND ENVIRONMENT
January 30, 2009
Christina M. Reed
DIRECTOR OF HIGHWAYS, CHIEF ENGINEER

PRINTED BY THE AUTHORITY
OF THE STATE OF ILLINOIS