

F.A.P. RTE.	SECTION	COUNTY	TOTAL SHEETS	SHEET NO.
840	*	IROQUOIS	16	1

ILLINOIS PROJECT  
\*(123)RS-1 & (135)RS-2

D-93-026-04

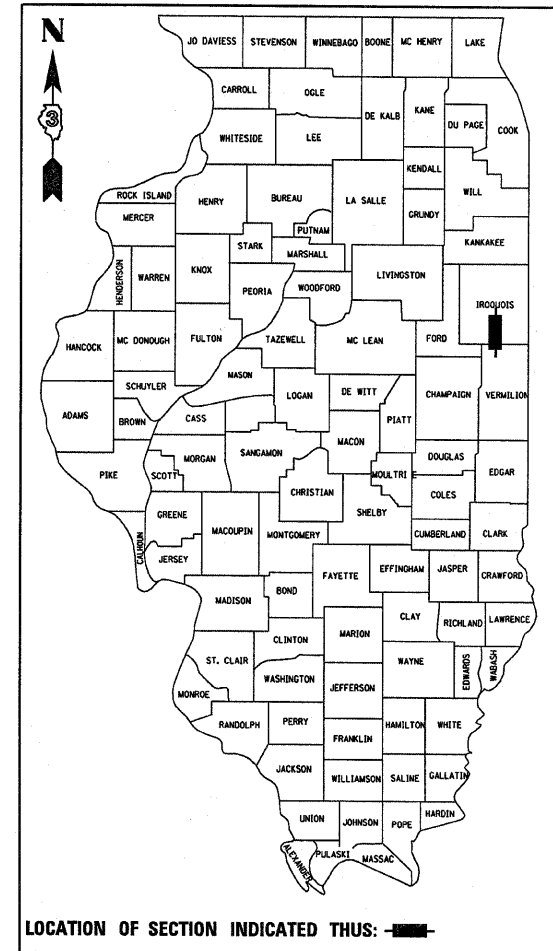

LOCATION OF SECTION INDICATED THUS:

FUNCTION CLASSIFICATION RURAL MINOR ARTERIAL

RURAL 2006 ADT = 1750  
P.V. = 84.3% S.U. = 8.6% M.U. = 7.1%

CITY 2006 ADT = 3200  
P.V. = 88.6% S.U. = 8.6% M.U. = 2.8%

STATE OF ILLINOIS  
DEPARTMENT OF TRANSPORTATION  
DIVISION OF HIGHWAYS

STATE OF ILLINOIS  
DEPARTMENT OF TRANSPORTATION  
DIVISION OF HIGHWAYS

SUBMITTED \_\_\_\_\_ 20\_\_\_\_

*David Bergman*  
DEPUTY DIRECTOR OF HIGHWAYS, REGION ENGINEER

*Charles J. Ingersoll*  
ENGINEER OF DESIGN AND ENVIRONMENT

*Christina M. Reed*  
DIRECTOR OF HIGHWAYS, CHIEF ENGINEER

PRINTED BY THE AUTHORITY  
OF THE STATE OF ILLINOIS

**INDEX OF SHEETS**

- 1 COVER SHEET
- 2 GENERAL NOTES
- 3 SUMMARY OF QUANTITIES
- 4 LOCATION MAP
- 5-6 TYPICAL SECTIONS
- 7 PAVEMENT & BIT SURF REM SCHEDULE
- 8 MISCELLANEOUS SCHEDULES
- 9 ENTRANCE SCHEDULE
- 10 PAVEMENT MARKING SCHEDULE
- 11-16 DETAILS

**HIGHWAY STANDARDS**

- 000001-05 STANDARD SYMBOLS, ABBREVIATIONS AND PATTERNS
- 001001-02 AREAS OF REINFORCEMENT BARS
- 001006 DECIMAL OF AN INCH AND OF A FOOT
- 406201-01 MAILBOX TURNOUT
- 667101-01 PERMANENT SURVEY MARKERS
- 701001-02 OFF-ROAD OPERATIONS 2L, 2W, MORE THAN 15' (4.5 m) AWAY
- 701006-03 OFF-ROAD OPERATIONS 2L, 2W, 15' (4.5 m) TO 24" (600 mm) FROM PAVEMENT EDGE
- 701011-02 OFF-ROAD MOVING OPERATIONS 2L, 2W, DAY ONLY
- 701201-03 LANE CLOSURE, 2L, 2W, DAY ONLY, FOR SPEEDS P 45 MPH
- 701301-03 LANE CLOSURE, 2L, 2W, SHORT TIME OPERATIONS
- 701306-02 LANE CLOSURE, 2L, 2W, SLOW MOVING OPERATIONS DAY ONLY, FOR SPEEDS P 45 MPH
- 701311-03 LANE CLOSURE, 2L, 2W, MOVING OPERATIONS - DAY ONLY
- 701501-05 URBAN LANE CLOSURE, 2L, 2W, UNDIVIDED
- 701901-01 TRAFFIC CONTROL DEVICES
- 780001-02 TYPICAL PAVEMENT MARKINGS
- 781001-03 TYPICAL APPLICATIONS RAISED REFLECTIVE PAVEMENT MARKERS

MICROFILMED \_\_\_\_\_  
REEL NUMBER \_\_\_\_\_  
AWARDED \_\_\_\_\_  
RESIDENT ENGINEER \_\_\_\_\_  
AS BUILT CHANGES WERE MADE  
ON THE FOLLOWING SHEETS \_\_\_\_\_

JULIE 1-800-892-0123

DISTRICT 3 NO. (815) 434-6131

PROJECT ENGINEER: JOE KANNEL  
UNIT CHIEF: PAT BRABOY

TOWNSHIP: ASH GROVE; PIGEON GROVE

CONTRACT NO. 66425

STATE OF ILLINOIS  
DEPARTMENT OF TRANSPORTATION  
DIVISION OF HIGHWAYS  
**PLANS FOR PROPOSED  
FEDERAL AID HIGHWAY**

ROUTE: FAP 840 (IL 49)

SECTION: (123)RS-1 & (135)RS-2

PROJECT **ACF-0840(060)**

COUNTY: IROQUOIS

C - 93 - 027 - 04

IL 49 FROM THE VERMILLION /IROQUOIS COUNTY LINE

TO COUNTY HIGHWAY 9 NORTH OF CISSNA PARK

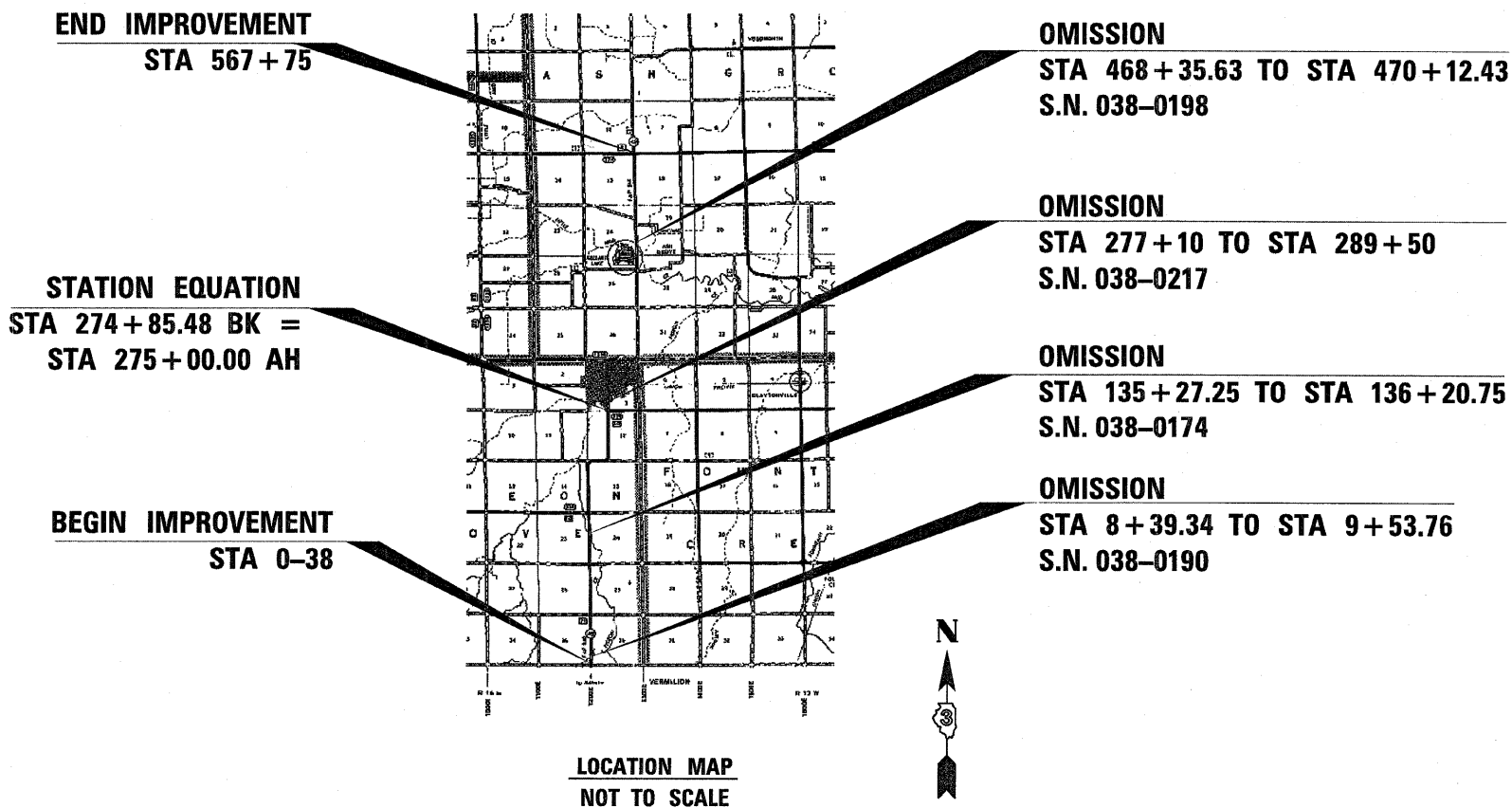

GROSS LENGTH = 56,798 FT. = 10.76 MI.  
NET LENGTH = 55,173.28 FT. = 10.45 MI.