

ILLINOIS DEPARTMENT OF TRANSPORTATION

SUMMARY OF QUANTITIES

FAU ROUTE 6757 (US ROUTE 150)			80% FED.	CONSTRUCTION TYPE CODE		
SUMMARY OF QUANTITIES			20% STATE	RWY	STR	STR
CODE NO.	ITEM	UNIT	URBAN TOTAL	M 1000	BRM X020-2A	M X081-2A
44000600	SIDEWALK REMOVAL	SQ FT	103	103		
44000920	BITUMINOUS CONCRETE SHOULDER REMOVAL	SQ YD	998	998		
44300200	STRIP REFLECTIVE CRACK CONTROL TREATMENT	FOOT	2330	2330		
48101500	AGGREGATE SHOULDERS, TYPE B 6"	SQ YD	786	786		
48203029	HOT-MIX ASPHALT SHOULDERS, 8"	SQ YD	1887	1887		
50100300	REMOVAL OF EXISTING STRUCTURES NO. 1	EACH	1		1	
50100400	REMOVAL OF EXISTING STRUCTURES NO. 2	EACH	1			1
50104400	CONCRETE HEADWALL REMOVAL	EACH	1	1		
50104650	SLOPE WALL REMOVAL	SQ YD	175	175		
50105210	REMOVE EXISTING CULVERTS	FOOT	5	5		
50105220	PIPE CULVERT REMOVAL	FOOT	617.5	617.5		
50200100	STRUCTURE EXCAVATION	CU YD	1160		710	450
50300225	CONCRETE STRUCTURES	CU YD	383.5		322.3	61.2
50300255	CONCRETE SUPERSTRUCTURE	CU YD	524.0		377.4	146.6
50300260	BRIDGE DECK GROOVING	SQ YD	645			645
50300280	CONCRETE ENCASEMENT	CU YD	16.0		16.0	
50300300	PROTECTIVE COAT	SQ YD	794			794
50400905	FURNISHING AND ERECTING PRECAST PRESTRESSED CONCRETE I-BEAMS, 42 IN.	FOOT	558			558
50800205	REINFORCEMENT BARS, EPOXY COATED	POUND	168547	37	134070	34440
50800515	BAR SPLICERS	EACH	543		224	319
50901125	STEEL RAILING (TEMPORARY)	FOOT	102		72	30

2 REVISIED 2/17/09

FAU ROUTE 6757 (US ROUTE 150)			80% FED.	CONSTRUCTION TYPE CODE		
SUMMARY OF QUANTITIES			20% STATE	RWY	STR	STR
CODE NO.	ITEM	UNIT	URBAN TOTAL	M 1000	BRM X020-2A	M X081-2A
50901720	BICYCLE RAILING	FOOT	78			78
51200957	FURNISHING METAL SHELL PILES 12" x 0.250"	FOOT	1159			1159
51201600	FURNISHING STEEL PILES HP 12x53	FOOT	3015		3015	
51202305	DRIVING PILES	FOOT	4174		3015	1159
51203200	TEST PILE METAL SHELLS	EACH	2			2
51203600	TEST PILE STEEL HP 12x53	EACH	1		1	
51205200	TEMPORARY SHEET PILING	SQ FT	1428			1428
51500100	NAME PLATES	EACH	2		1	1
54001000	BOX CULVERT END SECTIONS	EACH	1	1		
54002020	EXPANSION BOLTS 3/4 INCH	EACH	8	8		
54010404	PRECAST CONCRETE BOX CULVERT 4' X 4'	FOOT	10.2	10.2		
542A1075	PIPE CULVERTS, CLASS A, TYPE 2 30"	FOOT	192.5	192.5		
542D0223	PIPE CULVERTS, CLASS D, TYPE 1 18"	FOOT	45	45		
54213675	PRECAST REINFORCED CONCRETE FLARED END SECTIONS 30"	EACH	1	1		
54215547	METAL END SECTIONS 12"	EACH	2	2		
54215553	METAL END SECTIONS 18"	EACH	2	2		
550A0050	STORM SEWERS, CLASS A, TYPE 1 12"	FOOT	5	5		
X0326228	STORM SEWERS, PVC SDR 26, 18"	FOOT	103	103		
550A0380	STORM SEWERS, CLASS A, TYPE 2 18"	FOOT	33	33		
59100100	GEOCOMPOSITE WALL DRAIN	SQ YD	507		383	124
60100945	PIPE DRAINS 12"	FOOT	78	78		
60109580	PIPE UNDERDRAINS FOR STRUCTURES 4"	FOOT	586		432	154

FILE NAME = C:\Documents and Settings\klimankk\Local Settings\Temporary Internet Files\OLK178\au...

USER NAME = brucebm  
DESIGNED - ST  
DRAWN - ST  
PLOT SCALE = 20.0000 "/ IN.  
PLOT DATE = 10/16/2008

CHECKED - FL  
DATE - 12/2007

REVISED - ---  
REVISED - ---  
REVISED - ---  
REVISED - ---

STATE OF ILLINOIS  
DEPARTMENT OF TRANSPORTATION

SUMMARY OF QUANTITIES  
US 150 OVER LITTLE FARM CREEK  
SCALE: N/A SHEET NO. OF SHEETS STA. TO STA.

F.A.U. RTE. 6757 SECTION (105B) BR-2, (105B) BR-3 COUNTY TAZEWELL TOTAL SHEETS 4 SHEET NO. 133 CONTRACT NO. 68086 FED. ROAD DIST. NO. ILLINOIS FED. AID PROJECT

TRAFFIC CONTROL

LOCATION	TEMPORARY CONCRETE BARRIER	RELOCATE TEMPORARY CONCRETE BARRIER	TEMPORARY PAVEMENT MARKING (WHITE)	TEMPORARY PAVEMENT MARKING (YELLOW)	IMPACT ATTENUATOR TEMPORARY (FULLY REDIRECTIVE, NARROW), TL3	IMPACT ATTENUATOR, RELOCATE (FULLY REDIRECTIVE), TL3	TRAFFIC CONTROL & PROTECTION STD. 701306	TRAFFIC CONTROL & PROTECTION STD. 701331 (SPECIAL)	POLYMERIZED HOT-MIX ASPHALT BINDER COURSE, IL-19.0, N50 (TEMP. PAV'T)	POLYMERIZED BITUMINOUS MATERIALS (PRIME COAT 0.00038 TON/SQ. YD)	
	FOOT				EACH		L SUM	EACH	TON		
US 150 S.N. 090-0038							1				
PRESTAGE								192	0.2		
STAGE 1	483		1740	1690	2			1	703	0.6	
STAGE 2	196	483	1840	1790	2	2		1			
US 150 S.N. 090-0040											
PRESTAGE									324	0.3	
STAGE 1	514		1830	1830	2			1	488	0.5	
STAGE 2	492	538	1830	1830	4	2		1			
TOTAL	1685	1021	7240	7140	10	4		1	4	1707	1.6

AGGREGATE SHOULDERS, TYPE B 6"

LOCATION	SQ. YD.
US 150 S.N. 090-0038	
47+35.00 47+59.41 LT	21.7
47+59.41 48+36.93 LT	43.1
49+20.78 50+34.40 LT	63.3
50+34.40 50+80.51 LT	41.0
50+80.51 50+92.14 LT	5.7
47+35.00 47+45.52 RT	5.8
47+82.53 48+11.74 RT	17.1
48+11.74 49+20.12 RT	60.2
50+05.34 50+99.38 RT	54.0
50+99.38 52+05.00 RT	93.8
N EAST LANE	
10+80.00 11+15.24 RT	7.8
11+37.59 11+41.11 RT	0.5
11+41.11 13+25.38 RT	41.0
10+80.00 12+37.13 LT	34.8
12+37.13 12+87.13 LT	27.8
12+87.13 13+29.31 LT	37.4
13+29.31 13+45.11 LT	9.9
CATHERINE STREET	
50+28.91 50+56.68 LT	8.8
US 150 S.N. 090-0040	
88+74.27 89+07.36 LT	12.6
90+07.14 90+44.50 LT	18.9
87+75.49 88+22.38 RT	22.8
88+22.38 89+15.83 RT	51.9
90+55.22 91+13.58 RT	32.4
91+13.58 91+66.45 RT	25.8
WEDGES	
S.N. 090-0038	12.5
N East Ln.	26.3
Catherine St.	2.0
S.N. 090-0040	8.8
TOTAL	786

WORK ZONE

LOCATION	TRAFFIC CONTROL SURVEILLANCE	WORK ZONE PAVEMENT MARKING REMOVAL
	CAL DAY	SQ. FT.
US 150 S.N. 090-0038		
STAGE 1	15	651
STAGE 2		1110
US 150 S.N. 090-0040		
STAGE 1	15	685
STAGE 2		1103
TOTAL	30	3549

TERMINAL MARKER - DIRECT APPLIED BARRIER WALL MARKERS, TYPE B

LOCATION	EACH
STATION TO STATION	
US 150 S.N. 090-0038	
47+59.41 LT	1
48+11.74 RT	1
50+34.41 LT	1
50+99.38 RT	1
US 150 S.N. 090-0040	
88+22.38 RT	1
88+67.50 LT	1
90+60.25 RT	1
TOTAL	7

LOCATION	EACH
S.N. 090-0040	
89+53.50 90+16.50 RT	2
89+44.67 90+07.67 LT	2
TOTAL	4

PIPE DRAINS 12"

LOCATION	FOOT
US 150 S.N. 090-0040	
NW CORNER	40
SW CORNER	38
TOTAL	78

COMBINATION CONCRETE CURB AND GUTTER, TYPE B-6.12

LOCATION	FOOT
S. EAST LN.	187
TOTAL	187

TELESCOPING STEEL SIGN SUPPORT

S.N. 090-0038	FOOT
SIGN / INTERSECTION	
"DEAD END" S EAST LN / SHADOWAY DR	15
"STOP SIGN" N EAST LN / CATHERINE ST	15
"STOP SIGN" US 150 / CATHERINE ST	15
TOTAL	45

PIPE CULVERTS, CLASS A, TYPE 2 30"

LOCATION	FOOT
US 150 S.N. 090-0040	
90+50.0 TO 92+40.6 RT	192.5
TOTAL	192.5

2 REVISED 2/17/09



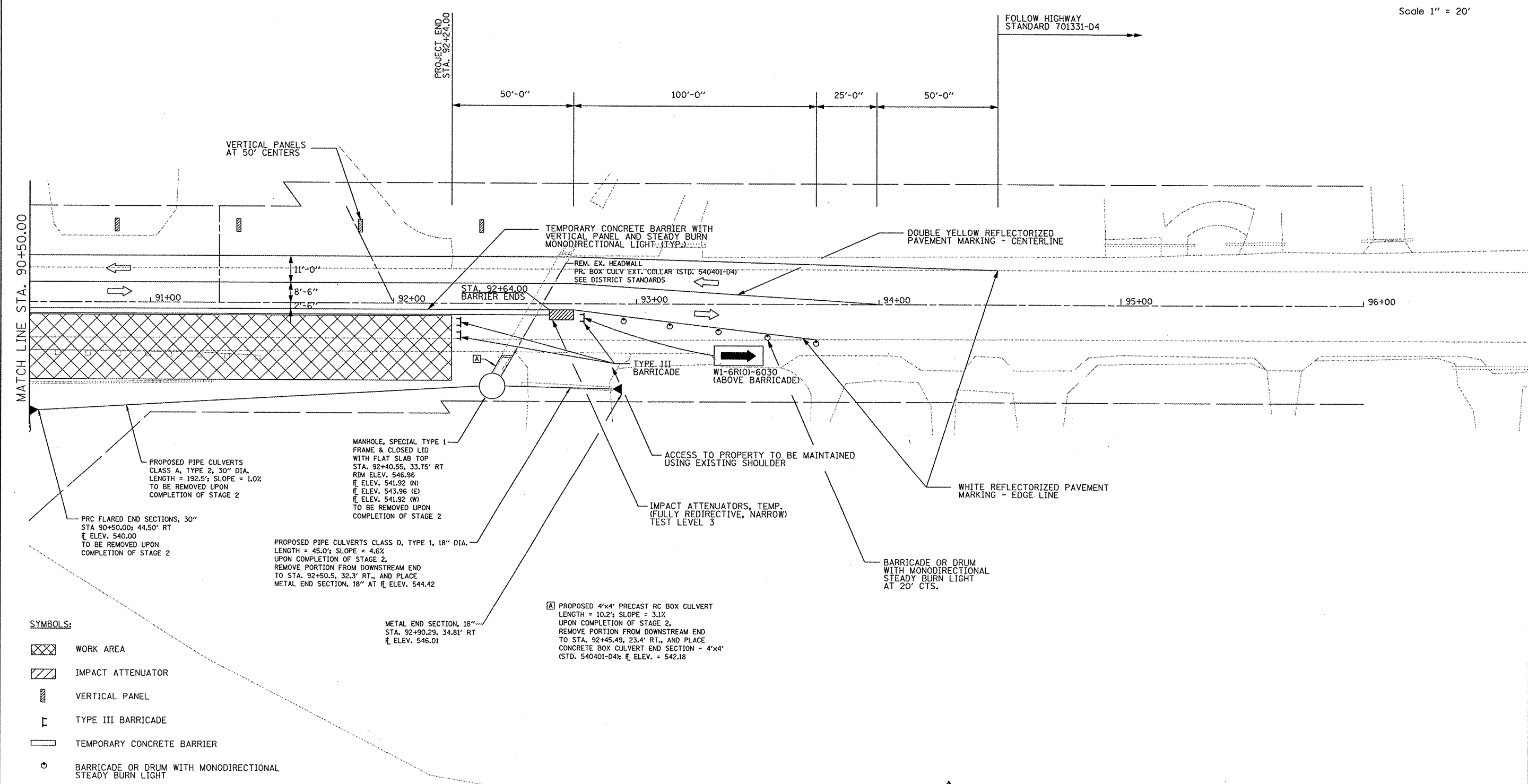
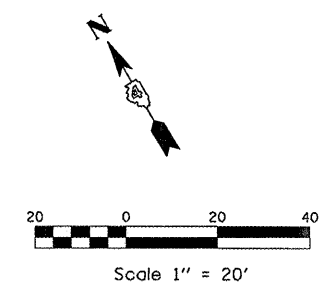

**SYMBOLS:**

- WORK AREA
- IMPACT ATTENUATOR
- VERTICAL PANEL
- TYPE III BARRICADE
- TEMPORARY CONCRETE BARRIER
- BARRICADE OR DRUM WITH MONODIRECTIONAL STEADY BURN LIGHT

2 REVISED 2/17/09

FILE NAME = ...0040MOTSTAGE1SHEET2.dgn	USER NAME = Plotted by Administrator	DESIGNED - ST	REVISED - ---	<b>STATE OF ILLINOIS DEPARTMENT OF TRANSPORTATION</b>	<b>MAINTENANCE OF TRAFFIC PLANS - STAGE I - SHEET II US 150 OVER LITTLE FARM CREEK S.N. 090-0040</b>	F.A.U. RTE.	SECTION	COUNTY	TOTAL SHEETS	SHEET NO.	
	PLOT SCALE = 20.0000' / IN.	DRAWN - ST	REVISED - ---			6757	(105B) BR-3	TAZEWELL	40	133	
	PLOT DATE = 2/3/2009	CHECKED - FL	REVISED - ---			CONTRACT NO. 68086					
		DATE - 12/2007	REVISED - ---			SCALE: 1" = 20'		SHEET NO. OF SHEETS		STA. 90+50.00 TO STA. 96+00.00	
						FED. ROAD DIST. NO. - ILLINOIS FED. AID PROJECT					

DATE	
BY	
SURVEYED	
TEMPLATE	
NOTE BOOK	
AREAS CHECKED	

DATE	
BY	
SURVEYED	
TEMPLATE	
NOTE BOOK	
AREAS CHECKED	

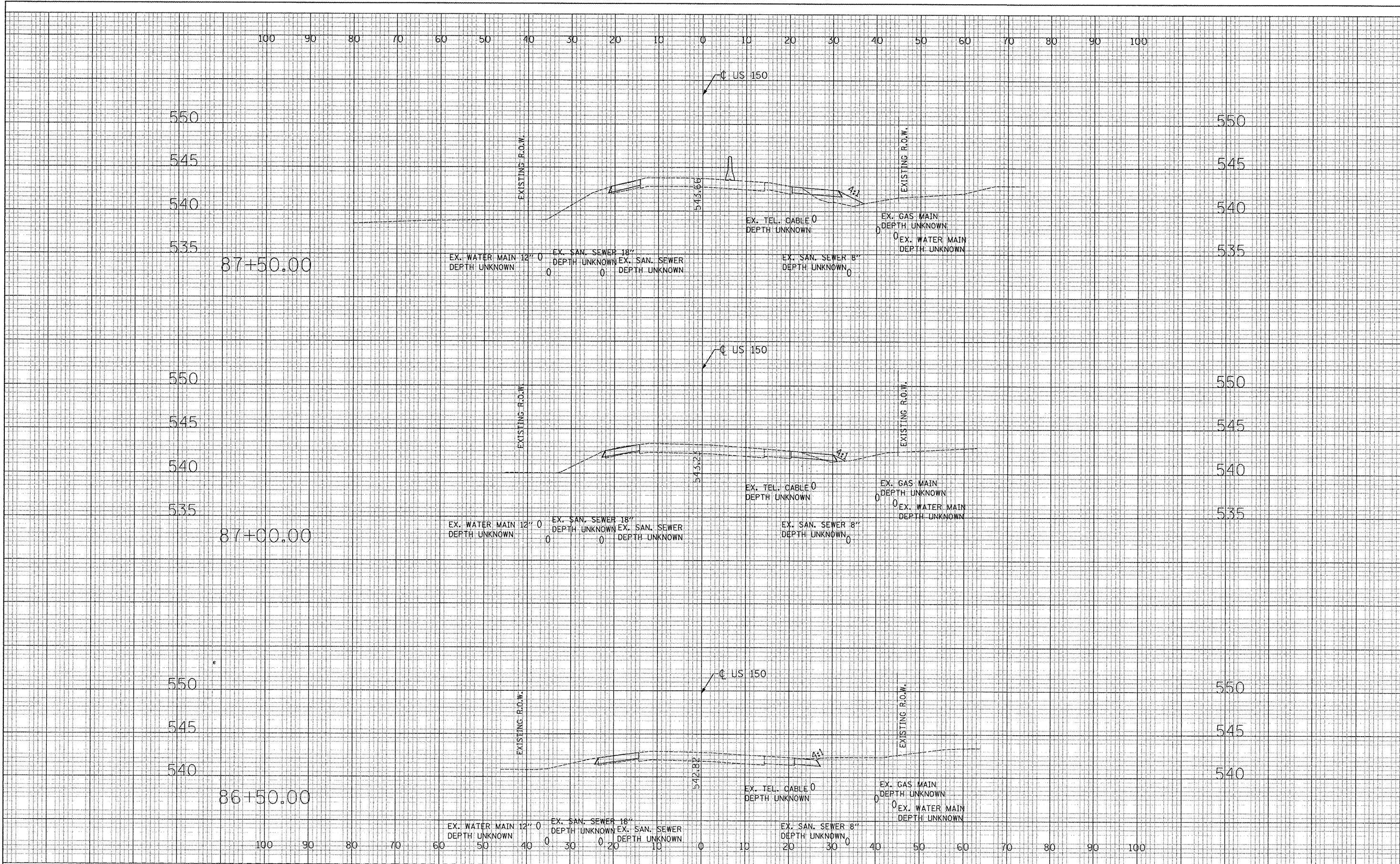

FILE NAME = ...Phase I\090004\0040XSMOT.dgn

USER NAME = Plotted by Administrator	DESIGNED - ST	REVISED - ---
PLOT SCALE = 10.0000' / IN.	DRAWN - ST	REVISED - ---
PLOT DATE = 2/3/2009	CHECKED - FL	REVISED - ---
	DATE - 12/2007	REVISED - ---

**STATE OF ILLINOIS  
DEPARTMENT OF TRANSPORTATION**

**MAINTENANCE OF TRAFFIC RUNAROUND CROSS SECTIONS  
US 150 OVER LITTLE FARM CREEK S.N. 090-0040**

SCALE: 1"=10'H,5'V SHEET NO. OF SHEETS STA. 87+61.06 TO STA. 92+24.00

F.A.U. RTE.	SECTION	COUNTY	TOTAL SHEETS	SHEET NO.
6757	(105B) BR-3	TAZEWELL	43	133
FED. ROAD DIST. NO. - ILLINOIS FED. AID PROJECT			CONTRACT NO. 68086	

2 REVISED 2/17/09

DATE	
BY	
SURVEYED	
PLOTTED	
TEMPLATE	
AREAS	
CHECKED	
FINAL SURVEY NOTE BOOK NO.	

DATE	
BY	
SURVEYED	
PLOTTED	
TEMPLATE	
AREAS	
CHECKED	
ORIGINAL SURVEY NOTE BOOK NO.	

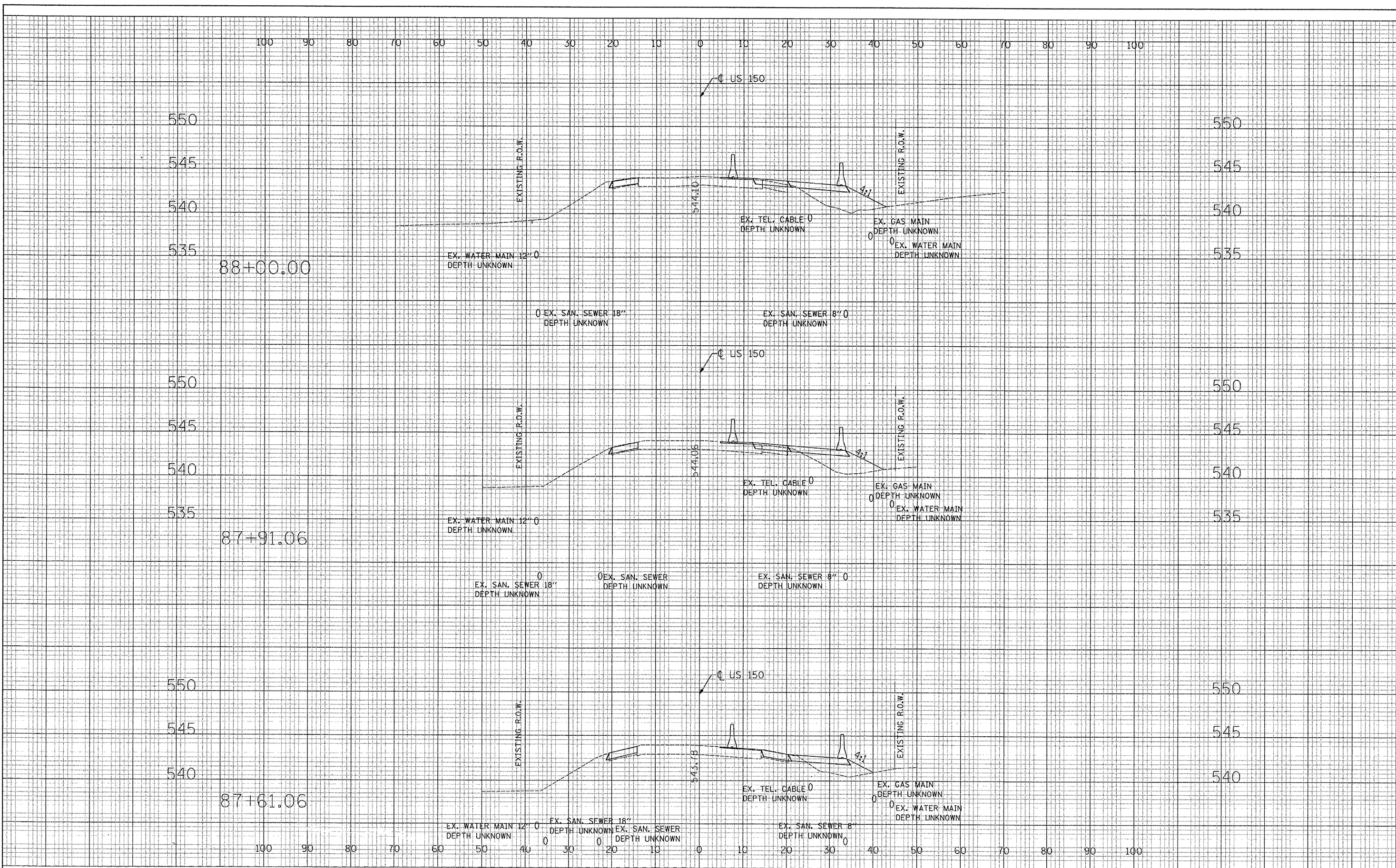

FILE NAME = ...Phase I\0900040\0040XSHOT.dgn

USER NAME = Plotted by Administrator	DESIGNED - ST	REVISED - ---
	DRAWN - ST	REVISED - ---
PLOT SCALE = 10.0000' / 1" IN.	CHECKED - FL	REVISED - ---
PLOT DATE = 2/3/2009	DATE - 12/2007	REVISED - ---

**STATE OF ILLINOIS  
DEPARTMENT OF TRANSPORTATION**

**MAINTENANCE OF TRAFFIC RUNAROUND CROSS SECTIONS  
US 150 OVER LITTLE FARM CREEK S.N. 090-0040**

SCALE: 1"=10'H,5"V SHEET NO. OF SHEETS STA. 87+61.06 TO STA. 92+24.00

F.A.U. RTE. 6757	SECTION (105B) BR-3	COUNTY TAZEWELL	TOTAL SHEETS 44	SHEET NO. 133
FED. ROAD DIST. NO. ILLINOIS FED. AID PROJECT			CONTRACT NO. 68086	

2 REVISED 2/17/09

BY	DATE

BY	DATE

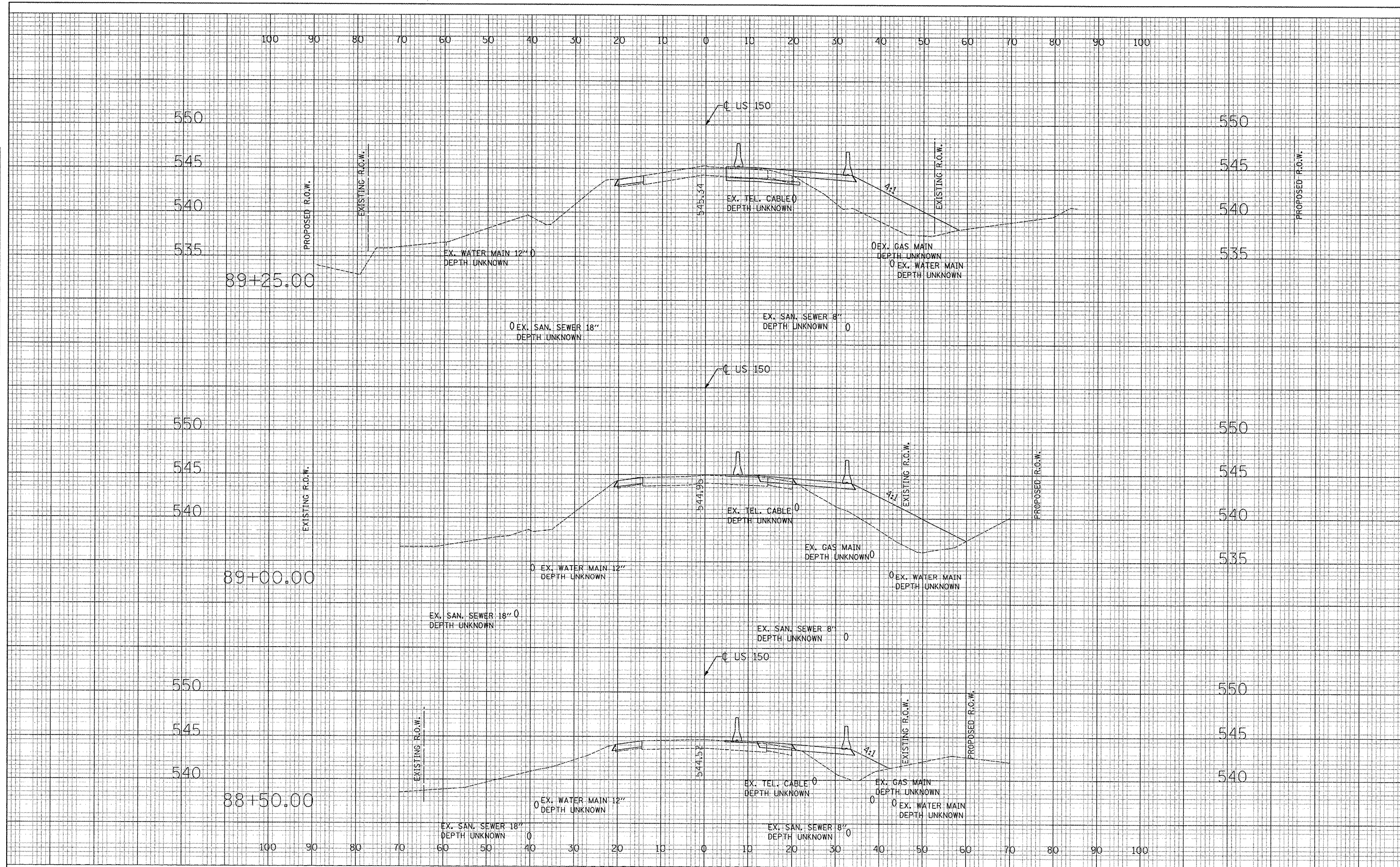

FILE NAME = ...Phase I\0900040\0040XSMDT.dgn

USER NAME = Plotted by Administrator	DESIGNED - ST	REVISED - ---
PLOT SCALE = 10.0000' / IN.	DRAWN - ST	REVISED - ---
PLOT DATE = 2/3/2009	CHECKED - FL	REVISED - ---
DATE - 12/2007	DATE - 12/2007	REVISED - ---

**STATE OF ILLINOIS  
DEPARTMENT OF TRANSPORTATION**

**MAINTENANCE OF TRAFFIC RUNAROUND CROSS SECTIONS  
US 150 OVER LITTLE FARM CREEK S.N. 090-0040**

SCALE: 1"=10'H, 5'V SHEET NO. OF SHEETS STA. 87+61.06 TO STA. 92+24.00

F.A.I. RTE.	SECTION	COUNTY	TOTAL SHEETS	SHEET NO.
6757	(105B) BR-3	TAZEWELL	45	133
FED. ROAD DIST. NO. -		ILLINOIS FED. AID PROJECT		

REVISOR'S MARK: A REVISOR'S MARK: 2/17/09

DATE	
BY	
FINAL SURVEY	
NOTE BOOK	
SURVEYED	
TEMPLATE	
AREAS CHECKED	

DATE	
BY	
ORIGINAL SURVEY	
NOTE BOOK	
SURVEYED	
TEMPLATE	
AREAS CHECKED	

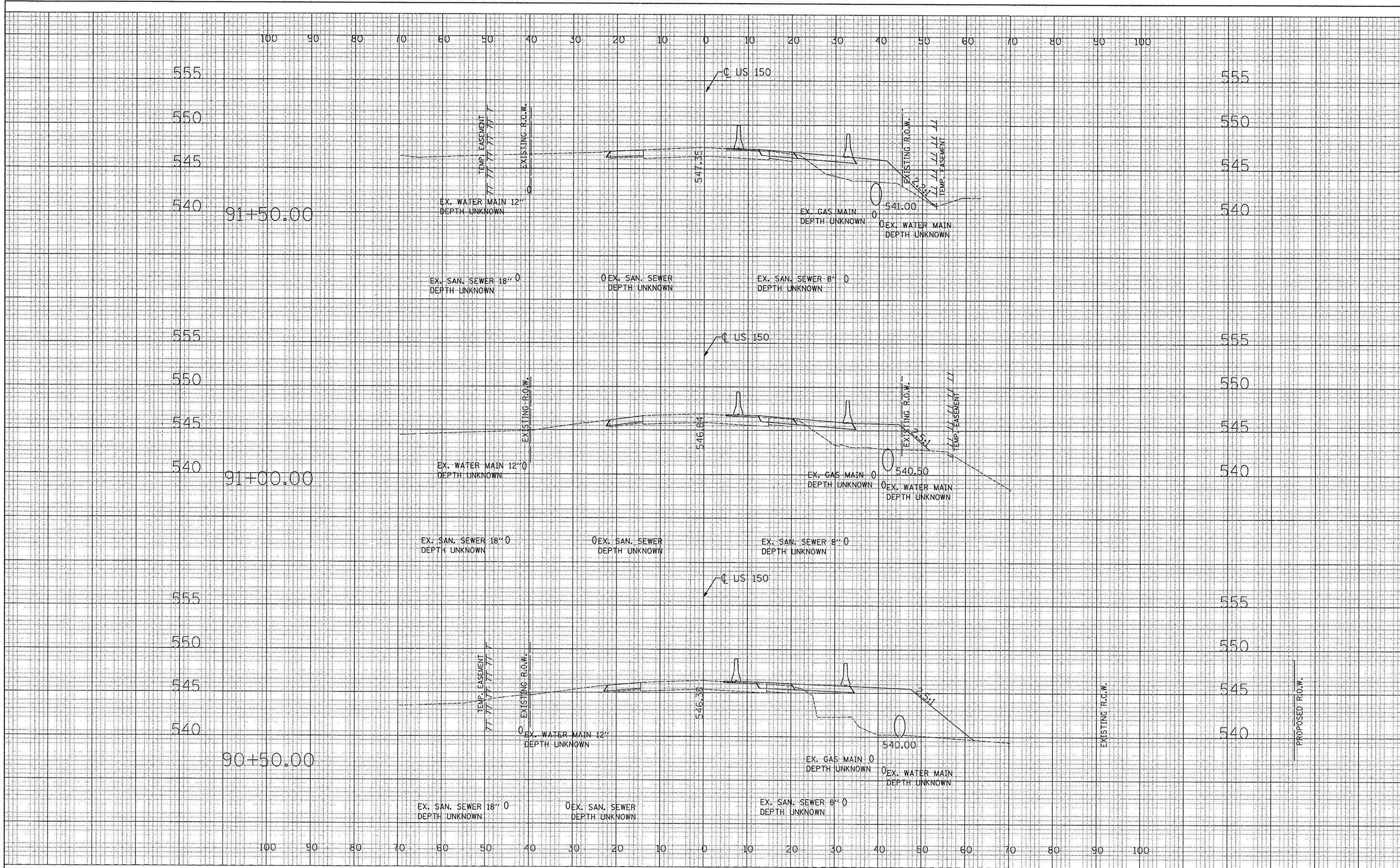

FILE NAME = ...Phase II\090004\090040\SMOT.dgn

USER NAME = Plotted by Administrator  
 PLOT SCALE = 1/8\"/>

DESIGNED - ST  
 DRAWN - ST  
 CHECKED - FL  
 DATE - 12/2007

REVISED - ----  
 REVISED - ----  
 REVISED - ----  
 REVISED - ----

**STATE OF ILLINOIS  
 DEPARTMENT OF TRANSPORTATION**

**MAINTENANCE OF TRAFFIC RUNAROUND CROSS SECTIONS  
 US 150 OVER LITTLE FARM CREEK S.N. 090-0040**

SCALE: 1"=10'H,5'V SHEET NO. OF SHEETS STA. 87+61.06 TO STA. 92+24.00

F.A.U. RTE. 6757	SECTION (105B) BR-3	COUNTY TAZEWELL	TOTAL SHEETS 46	SHEET NO. 133
FED. ROAD DIST. NO. ILLINOIS			CONTRACT NO. 68086	

REVIS 2/17/09



FINAL SURVEY NOTE BOOK NO.	DATE
REVISIONS	BY
PLOTTED	
TEMPLATE	
AREAS CHECKED	

ORIGINAL SURVEY NOTE BOOK NO.	DATE
REVISIONS	BY
PLOTTED	
TEMPLATE	
AREAS CHECKED	

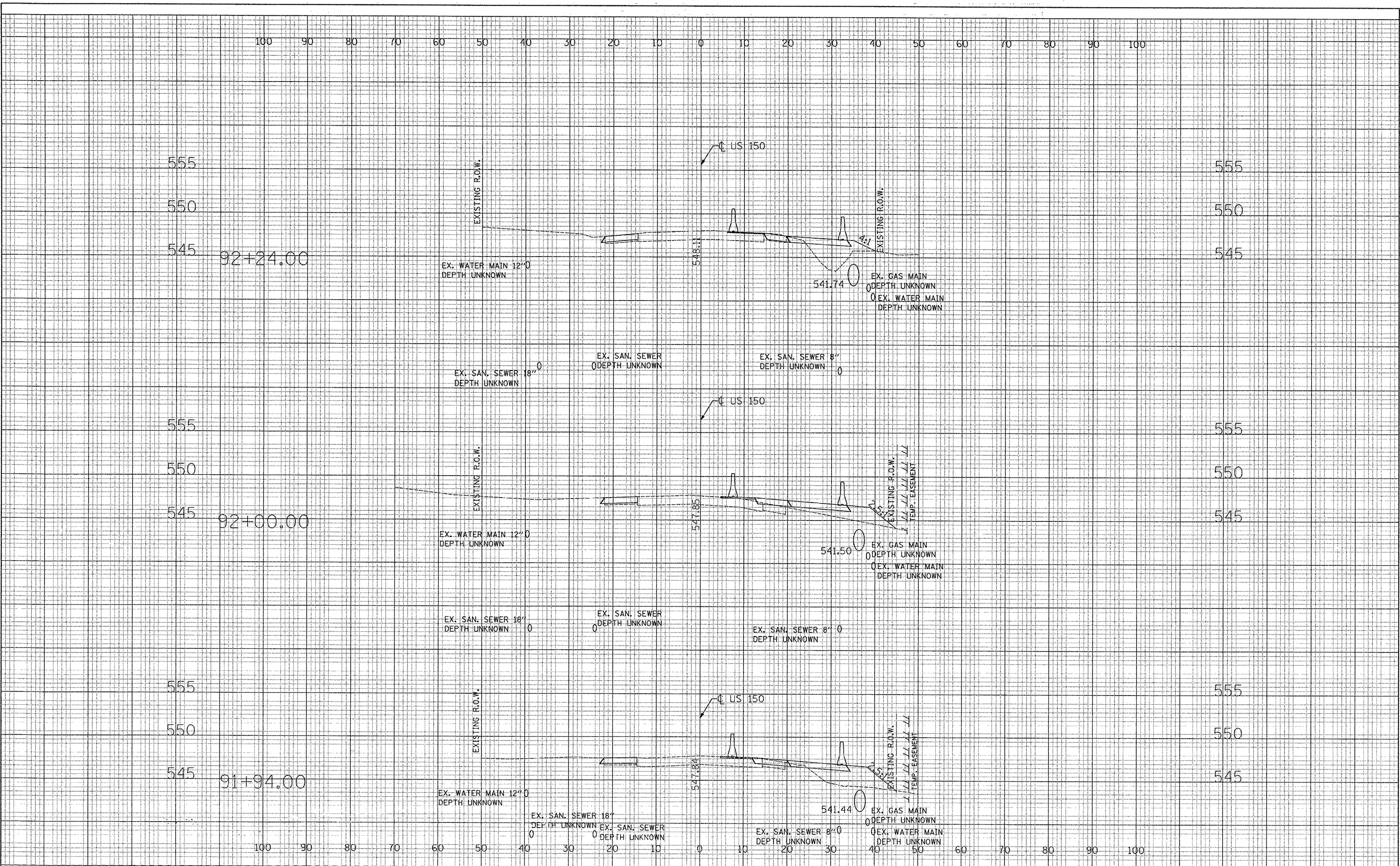

FILE NAME = ...Phase I\10900040\0040XSM01.dgn	USER NAME = Plotted by Administrator	DESIGNED - ST	REVISED - ---	<b>STATE OF ILLINOIS</b> <b>DEPARTMENT OF TRANSPORTATION</b> <b>MAINTENANCE OF TRAFFIC RUNAROUND CROSS SECTIONS</b> <b>US 150 OVER LITTLE FARM CREEK S.N. 090-0040</b>	F.A.U. RTE. 6757	SECTION (105B) BR-3	COUNTY TAZEWELL	TOTAL SHEETS 47	SHEET NO. 133	
PLOT SCALE = 10.0000' / IN.	CHECKED - FL	DATE - 12/2007	REVISED - ---		SCALE: 1"=10'H, 5'V	SHEET NO. OF	SHEETS	STA. 87+61.06 TO STA. 92+24.00	FED. ROAD DIST. NO. - [ILLINOIS] FED. AID PROJECT	CONTRACT NO. 68086
PLOT DATE = 2/3/2009	DATE - 12/2007	REVISED - ---	REVISED - ---							

2 REVISED 2/17/09

DATE	
BY	
FINAL SURVEY	
PLOTTED	
NOTE BOOK	
AREAS CHECKED	
NO.	

DATE	
BY	
ORIGINAL SURVEY	
PLOTTED	
NOTE BOOK	
AREAS CHECKED	
NO.	

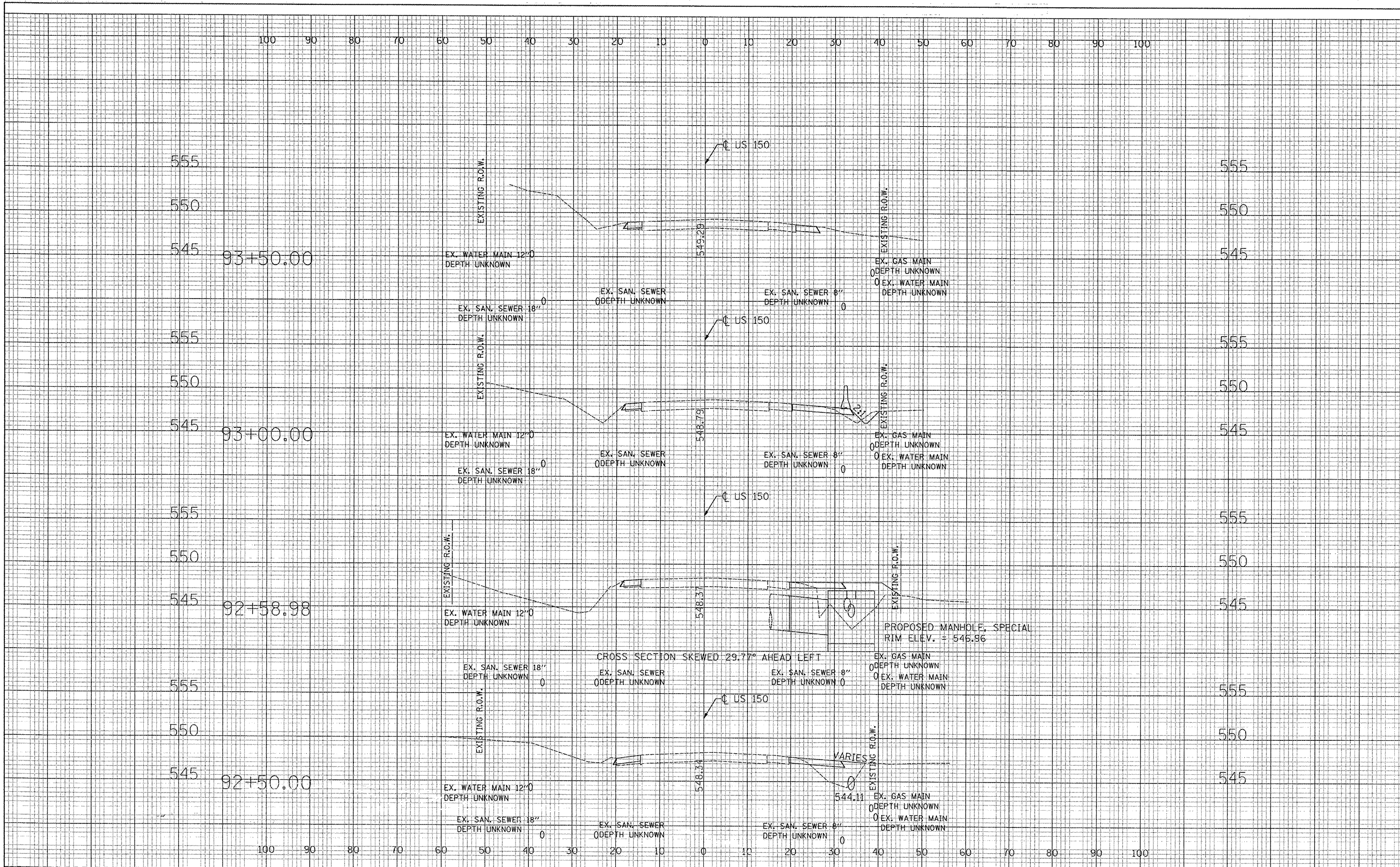

FILE NAME = ...Phase 11\090804\09040XSHOT.dgn

USER NAME = Plotted by Administrator	DESIGNED - ST	REVISED -
PLOT SCALE = 10.0000' / IN.	DRAWN - ST	REVISED -
PLOT DATE = 2/3/2009	CHECKED - FL	REVISED -
	DATE - 12/2007	REVISED -

**STATE OF ILLINOIS  
DEPARTMENT OF TRANSPORTATION**

**MAINTENANCE OF TRAFFIC RUNAROUND CROSS SECTIONS  
US 150 OVER LITTLE FARM CREEK S.N. 090-0040**

SCALE: 1"=10'H,5'V SHEET NO. OF SHEETS STA. 87+61.06 TO STA. 92+24.00

F.A.U. RTE.	SECTION	COUNTY	TOTAL SHEETS	SHEET NO.
6757	(105B) BR-3	TAZEWELL	48	133
FED. ROAD DIST. NO. - ILLINOIS FED. AID PROJECT			CONTRACT NO. 68086	

2 REVISED 2/17/09