

LEGEND:

- Work Area
- Median Removal
- Temporary Pavement
- Pavement Removal
- Drum with steady burning light, 50' c.c.
- Arrow Board
- Sign
- Open Traffic Lane
- Type III Barricade

ROAD CONSTRUCTION AHEAD

WORKERS

7am to 6pm Mon. - Sat.

35 M.P.H.

- NOTES:**
1. Temporary Pavement Markings on existing pavement in Stage 1 shall be paint unless pavement to remain in place then use type III tape.
 2. Adjust Drum locations to avoid conflicts with entrances and side streets.

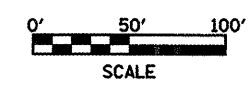
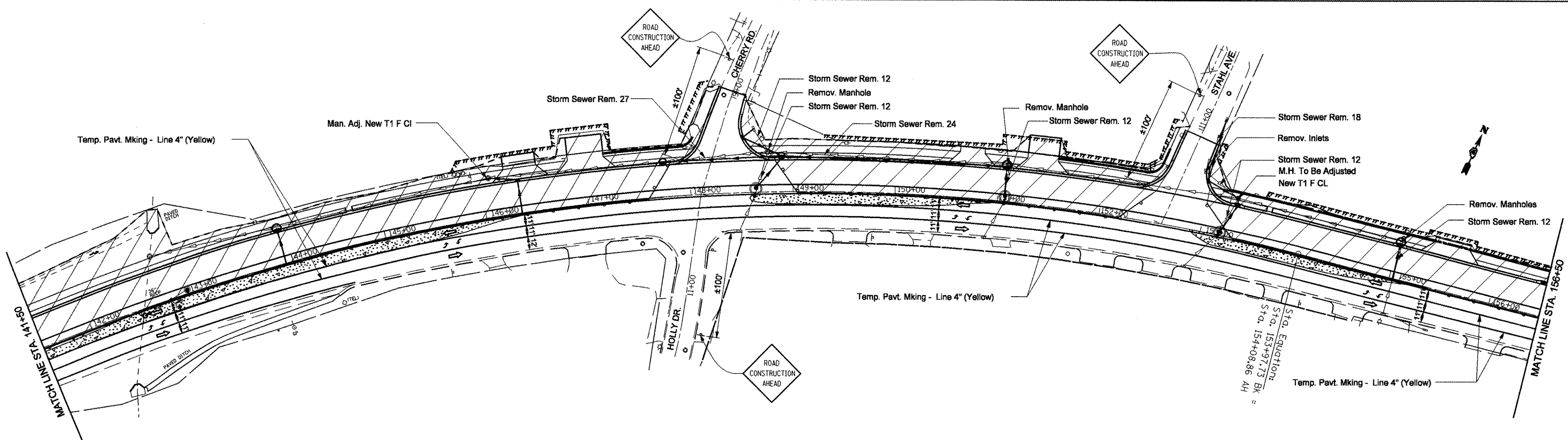

FILE NAME = copy of stagelst.dgn	USER NAME = crespole	DESIGNED -	REVISED -	STATE OF ILLINOIS DEPARTMENT OF TRANSPORTATION	IL RTE 8 - Stage 1			F.A.P. RTE. 399	SECTION 36 R-8	COUNTY TAZEWELL	TOTAL SHEETS 429	SHEET NO. 78
	PLOT SCALE = 1/8" = 100.0000' / IN.	DRAWN -	REVISED -		SCALE:	SHEET NO.	OF SHEETS	STA.	TO STA.	CONTRACT NO. 68258		
	PLOT DATE = 12/11/2008	CHECKED -	REVISED -							FED. ROAD DIST. NO. 4 ILLINOIS FED. AID PROJECT		
		DATE -	REVISED -							FED. ROAD DIST. NO. 4 ILLINOIS FED. AID PROJECT		