





LEGEND:

-  Inlet and Pipe Protection
-  Temporary Ditch Check
-  Perimeter Erosion Barrier
-  Direction of the Flow

NOTES:

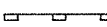
1. Maintain temporary erosion control items from Stage II in place.
2. For final drainage information, see drainage plans.
3. For permanent erosion control information see landscape plans.
4. Place Permanent seeding / sodding during this stage.

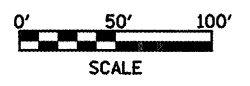
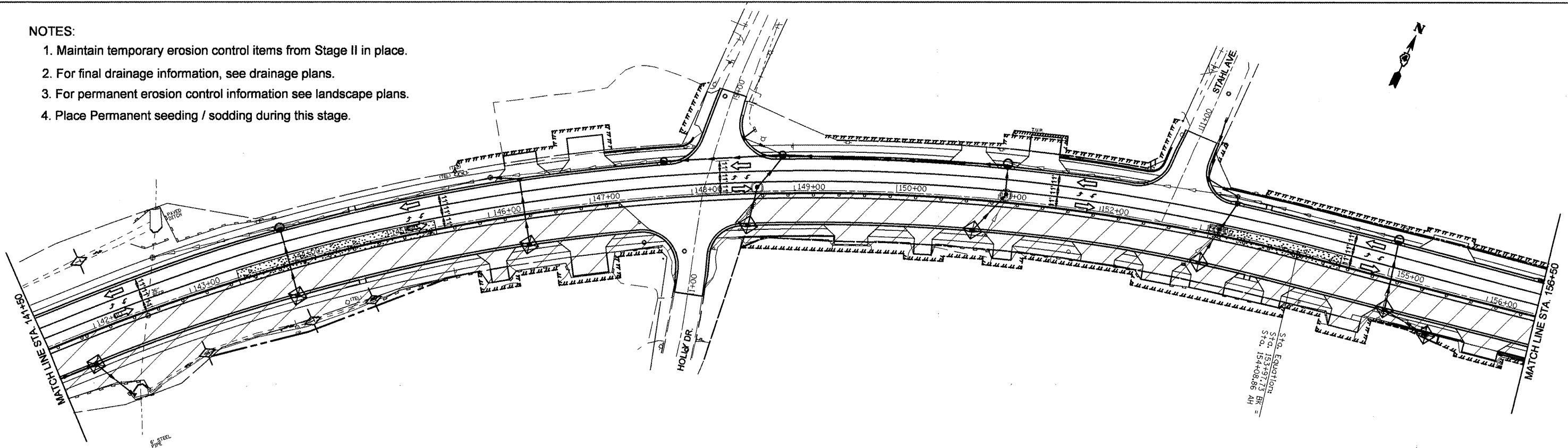

FILE NAME = Stage III erosion sht.dgn	USER NAME = crespole	DESIGNED -	REVISED -	STATE OF ILLINOIS DEPARTMENT OF TRANSPORTATION	IL RTE 8 - Stage 3 Erosion Control Plans			F.A.P. RTE. 399	SECTION 36 R-8	COUNTY TAZEWELL	TOTAL SHEETS 429	SHEET NO. 96
	PLOT SCALE = 100.0000' / IN.	CHECKED -	REVISED -					CONTRACT NO. 68258			FED. ROAD DIST. NO. 4 (ILLINOIS) FED. AID PROJECT	
PLOT DATE = 12/24/2009	DATE -	REVISED -	REVISED -	SCALE: SHEET NO. OF SHEETS STA. TO STA.								