

PLAN	REVISIONS	DATE
NO.		
NOTE BOOK	ALIGNMENT CHECKED	
	GRADES CHECKED	
	STRUCTURE NOTATIONS CHRG	
	FILE NAME	

PROFILE	REVISIONS	DATE
NO.		
NOTE BOOK	GRADES CHECKED	
	STRUCTURE NOTATIONS CHRG	
	FILE NAME	

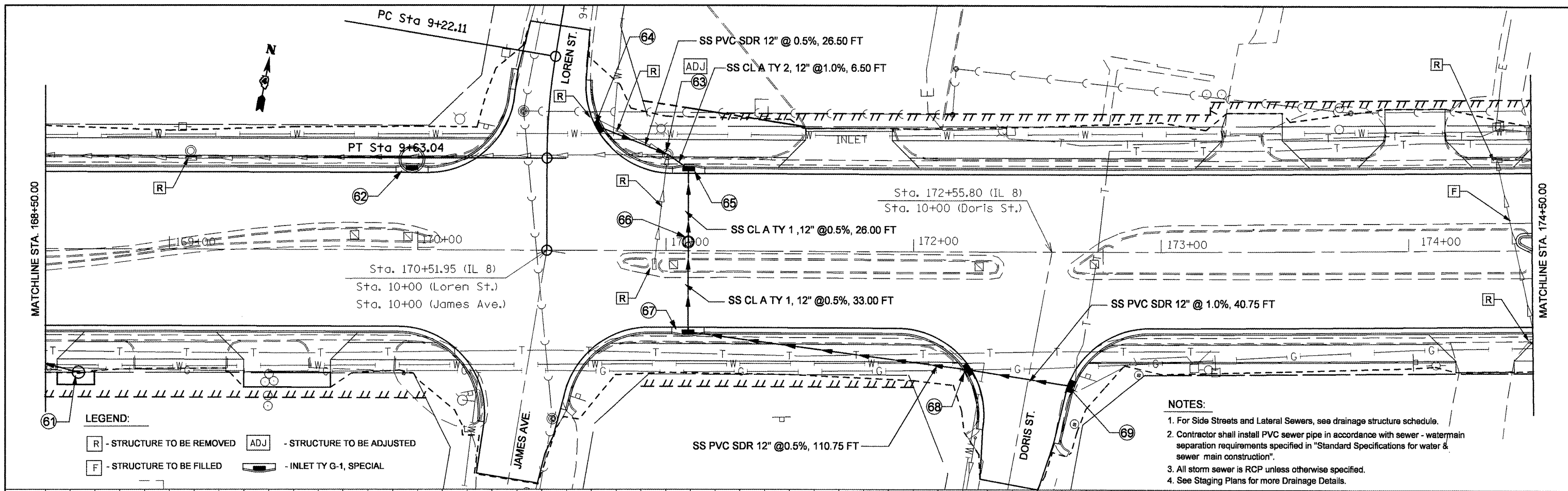

**LEGEND:**

- R - STRUCTURE TO BE REMOVED
- ADJ - STRUCTURE TO BE ADJUSTED
- F - STRUCTURE TO BE FILLED
- INLET TY G-1, SPECIAL

**NOTES:**

1. For Side Streets and Lateral Sewers, see drainage structure schedule.
2. Contractor shall install PVC sewer pipe in accordance with sewer - watermain separation requirements specified in "Standard Specifications for water & sewer main construction".
3. All storm sewer is RCP unless otherwise specified.
4. See Staging Plans for more Drainage Details.

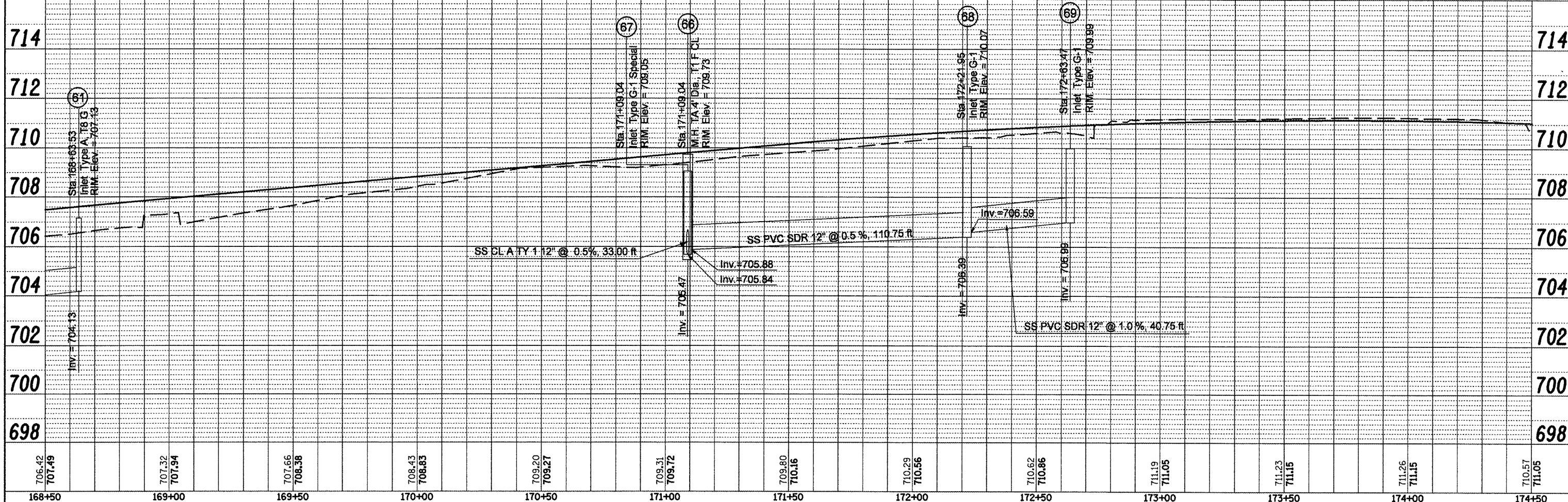

FILE NAME =	USER NAME = swasher-dh	DESIGNED -	REVISED -	<b>STATE OF ILLINOIS</b> <b>DEPARTMENT OF TRANSPORTATION</b>				<b>IL RTE 8 - DRAINAGE PLANS RT SIDE</b>				F.A.P. RTE.	SECTION	COUNTY	TOTAL SHEETS	SHEET NO.					
copy of drainage plan r.t.dgn		DRAWN -	REVISED -														399	36 R-8	TAZEWELL	429	118
		CHECKED -	REVISED -																		
		DATE -	REVISED -																		
				SCALE:	SHEET NO. OF SHEETS	STA. TO STA.	FED. ROAD DIST. NO. 4 [ILLINOIS] FED. AID PROJECT														