

STATE OF ILLINOIS
DEPARTMENT OF TRANSPORTATION
DIVISION OF HIGHWAYS

**PROPOSED
HIGHWAY PLANS**

FAI 55 (I-55) & FAS 1769 (FR I-55)
SECTION 68-4B-1 & 111BR
PROJECT: IM-055-2(121)070
MONTGOMERY COUNTY
C-96-072-08

F.A. RTE.	SECTION	COUNTY	TOTAL SHEETS	SHEET NO.
•	68-4B-1 & 111BR	MONTGOMERY	145	1
FED. ROAD DIST. NO.	ILLINOIS	CONTRACT NO. 72A63		

• FAI 55 & FAS 1769

145+4=149

D-96-545-06

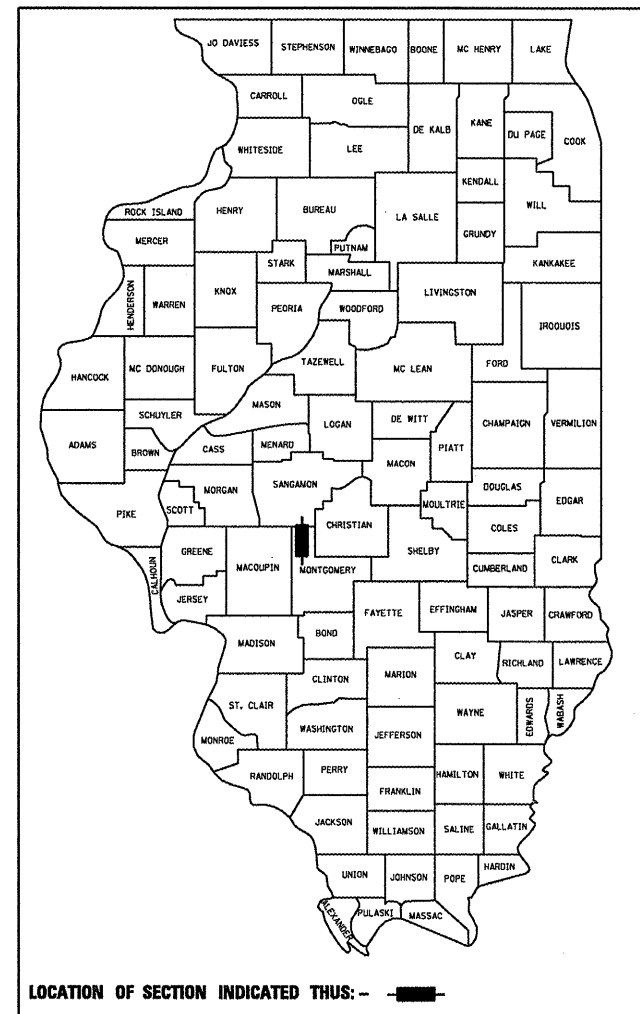

FOR INDEX OF SHEETS, SEE SHEET NO. 2

DESIGN DESIGNATION

FAI 55
INTERSTATE
EXISTING ADT = 24,500 (2005)
PROJECTED ADT = 35,000 (2025)
% PU = 62%
% SU = 6%
% MU = 32%

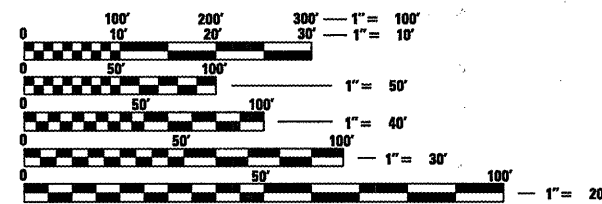

FULL SIZE PLANS HAVE BEEN PREPARED USING STANDARD ENGINEERING SCALES. REDUCED SIZED PLANS WILL NOT CONFORM TO STANDARD SCALES. IN MAKING MEASUREMENTS ON REDUCED PLANS, THE ABOVE SCALES MAY BE USED.

J.U.L.I.E.
JOINT UTILITY LOCATION INFORMATION FOR EXCAVATION
1-800-892-0123
OR 811

PROJECT ENGINEER: SAL MADONIA (217) 782-4761
SQUAD LEADER: JEFF MYERS (217) 524-7940

CONTRACT NO. 72A63

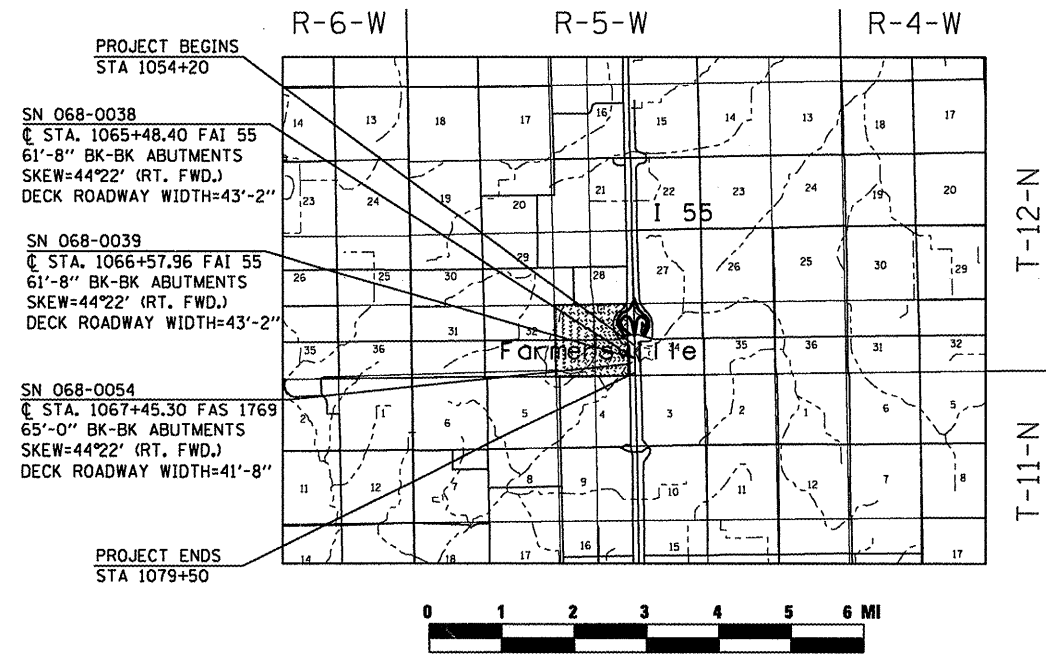

TOTAL LENGTH OF PROJECT = 2530 FEET = 0.479 MILES
NET LENGTH OF PROJECT = 2530 FEET = 0.479 MILES

STATE OF ILLINOIS
DEPARTMENT OF TRANSPORTATION
DIVISION OF HIGHWAYS

SUBMITTED December 8, 20 08
Resen Z Diskel
DEPUTY DIRECTOR OF HIGHWAYS, REGION ENGINEER

January 30, 20 09
Charles W. Guthrie, Jr. / RD
ENGINEER OF DESIGN AND ENVIRONMENT

January 30, 20 09
Christine M. Reed / RD
DIRECTOR OF HIGHWAYS, CHIEF ENGINEER

BLANK, WESSELINK, COOK & ASSOCIATES
ENGINEERS - CONSULTANTS
DECATUR, ILLINOIS

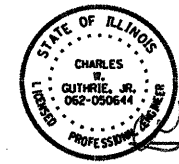

Charles W. Guthrie, Jr.
CHARLES W. GUTHRIE, JR., P.E.
DATE November 25, 20 08
EXPIRES NOVEMBER 30, 2009

PRINTED BY THE AUTHORITY
OF THE STATE OF ILLINOIS