

**LEGEND**

- PAVED SHOULDER REMOVAL
- HMA PAVEMENT (CROSSOVERS)

**PIPE CULVERT, CLASS C, TYPE 1 (TEMPORARY) 24" X 424'**  
 USFL 629.24 STA 1057+42.62 144.25' LT (FRONTAGE RD)  
 DSFL 627.10 STA 1061+66.74 144.39' LT (FRONTAGE RD)

**END SECTIONS (24")**  
 STA. 1057+42.62 - 144.25' LT (FRONTAGE RD)  
 STA. 1061+66.74 - 144.39' LT (FRONTAGE RD)

PLAN	SURVEYED	DATE
	PLOTTED	
	CHECKED	
	NOTED	
	FILE NAME	
	NO.	

PROFILE	SURVEYED	DATE
	PLOTTED	
	CHECKED	
	NOTED	
	STRUCTURE	
	NOTATION	
	CHFD	
	NO.	

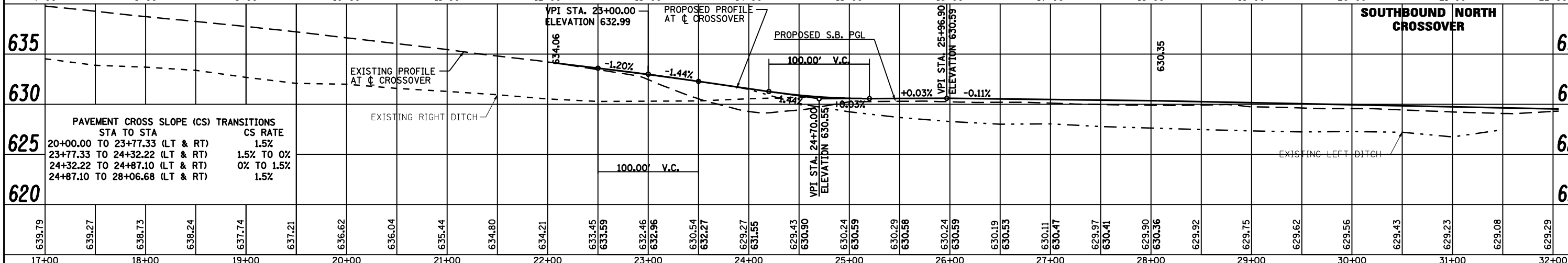
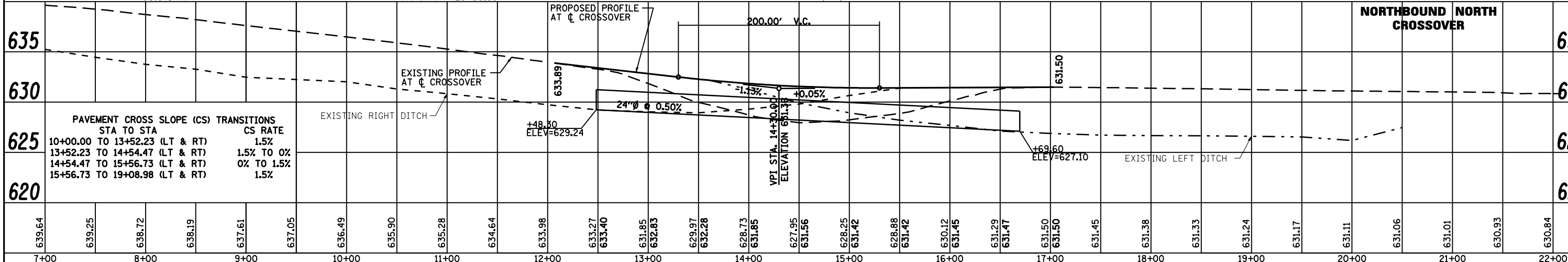
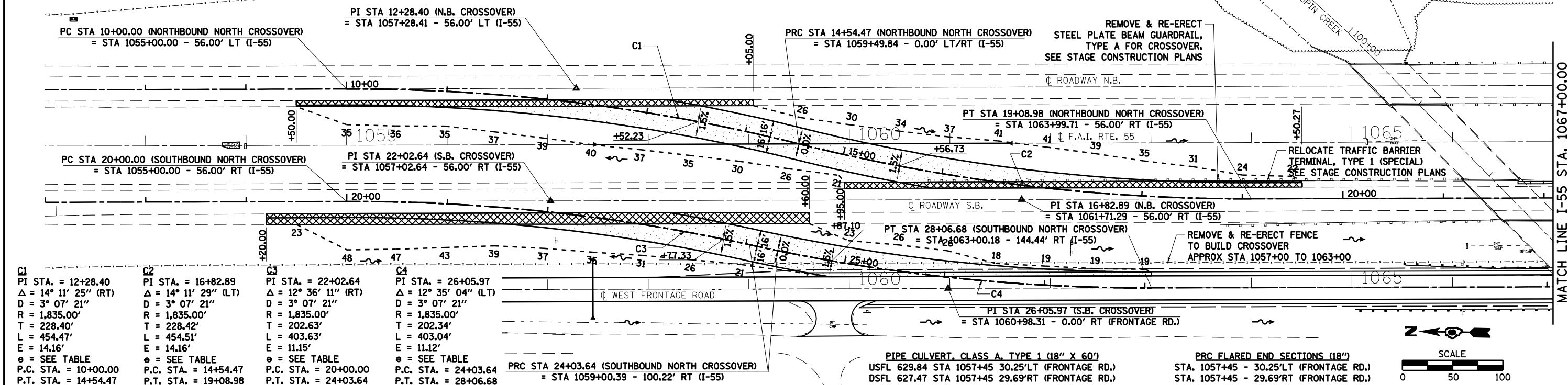

FILE NAME =	USER NAME = laughlinr1	DESIGNED -	REVISED -	<b>STATE OF ILLINOIS DEPARTMENT OF TRANSPORTATION</b>	<b>I-55 CROSSOVERS</b>	F.A. RTE.	SECTION	COUNTY	TOTAL SHEETS	SHEET NO.
ct:\pwork\PWIDOT\LAUGHLINR1\0110282\Crossover.dgn		CHECKED -	REVISED -			68-4B-1 & 111B	MONTGOMERY	145	13	
PLOT SCALE = 100.0000' / IN.		DRAWN -	REVISED -			FAS 55 & FAS 1769			CONTRACT NO. 72A63	
PLOT DATE = Dec-04-2008 08:15:12AM		CHECKED -	REVISED -			FED. ROAD DIST. NO.	ILLINOIS	FED. AID PROJECT		