

**PIPE CULVERT CLASS A, TYPE 1 (24"x16')**

USFL 623.05, STA 1073+10.00  
 DSFL 622.96, STA 1073+02.50  
 USFL 623.05, STA 1073+31.00  
 DSFL 622.96, STA 1073+23.50

**INLET BOX STANDARD 542526**  
 USFL 623.30, STA 1072+84.50  
 DSFL 623.05, STA 1073+10.00

**INLET BOX STANDARD 542526**  
 USFL 623.30, STA 1073+56.50  
 DSFL 623.05, STA 1073+31.00

MATCH LINE STA. 1073+00.00

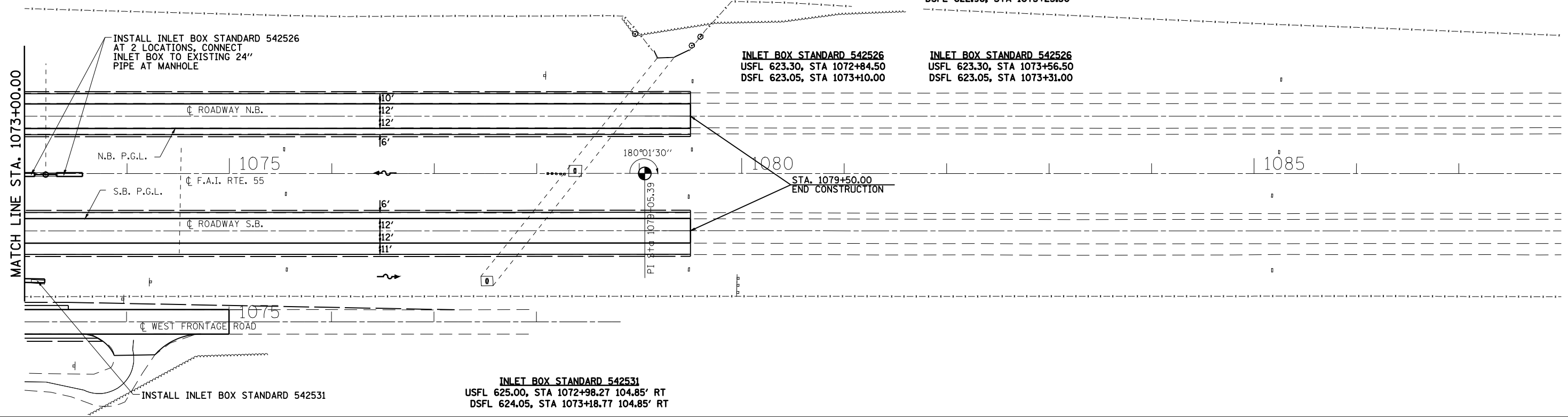

PLAN	SURVEYED	DATE
	PLOTTED	BY
	GRADES CHECKED	
	STRUCTURE NOTATIONS CHECKED	
	NOTE BOOK NO.	
	CHECKED BY	
	DATE	

PROFILE	SURVEYED	DATE
	PLOTTED	BY
	GRADES CHECKED	
	STRUCTURE NOTATIONS CHECKED	
	NOTE BOOK NO.	
	CHECKED BY	
	DATE	

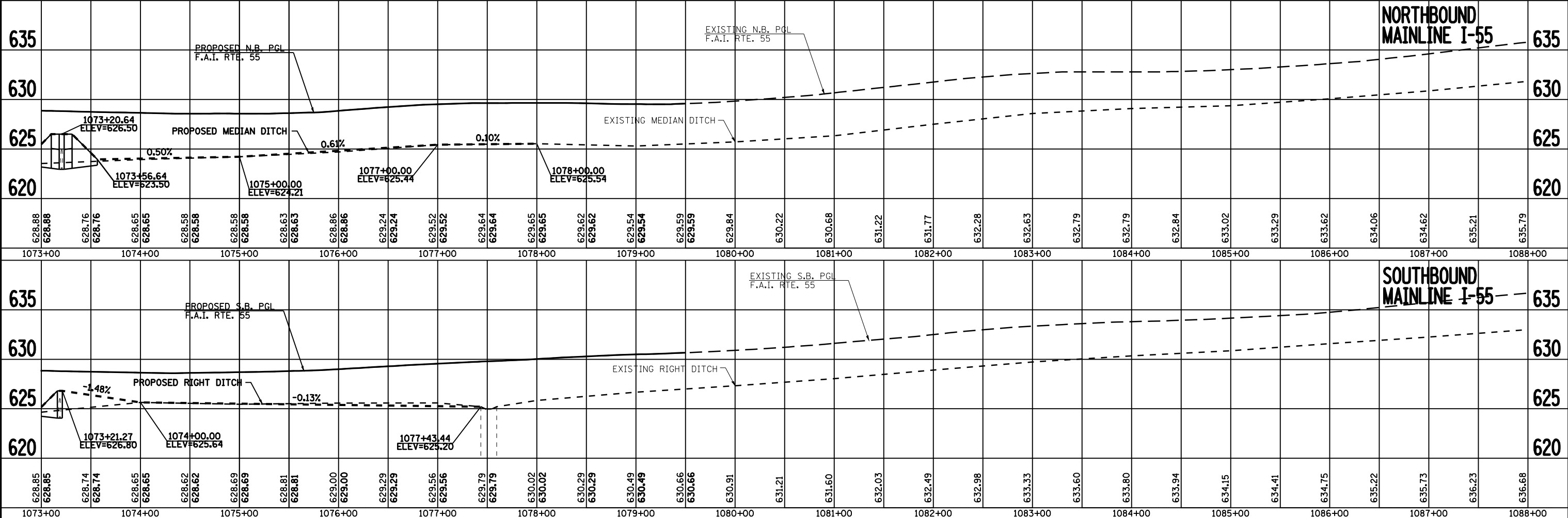

FILE NAME =	USER NAME = laughlinr1	DESIGNED -	REVISED -
c:\pwwork\pwwid\DOT\LAUGHLINR1\d0110282\15584P4.dgn		CHECKED -	REVISED -
		DRAWN -	REVISED -
		CHECKED -	REVISED -

**STATE OF ILLINOIS  
 DEPARTMENT OF TRANSPORTATION**

**I-55 PLAN & PROFILE**

SCALE: SHEET NO. 3 OF 3 SHEETS STA. 1073+00 TO STA. 1088+00

F.A. RTE.	SECTION	COUNTY	TOTAL SHEETS	SHEET NO.
• FAI 55 & FAS 1769	68-4B-1 & 111BR	MONTGOMERY	145	17
FED. ROAD DIST. NO.		ILLINOIS FED. AID PROJECT		
		CONTRACT NO. 72A63		