

F.A.P. RTE.	SECTION	COUNTY	TOTAL SHEETS	SHEET NO.
809	(133,134)RS-4,135RS-5	ST. CLAIR, MONROE	252	36
STA. _____		TO STA. _____		
FED. ROAD DIST. NO. _____		ILLINOIS	FED. AID PROJECT	

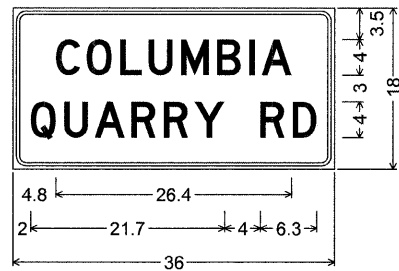

1.5" Radius, 0.4" Border, 0.4" Indent, Black on Orange;  
[COLUMBIA] D; [QUARRY RD] D;

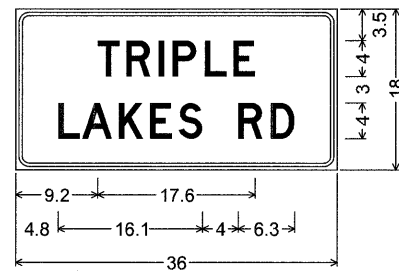

1.5" Radius, 0.4" Border, 0.4" Indent, Black on Orange;  
[TRIPLE] D; [LAKES RD] D;

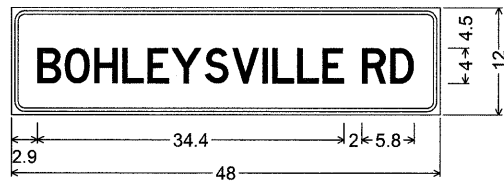

1.5" Radius, 0.4" Border, 0.4" Indent, Black on Orange;  
[BOHLEYSVILLE RD] D 50% spacing;

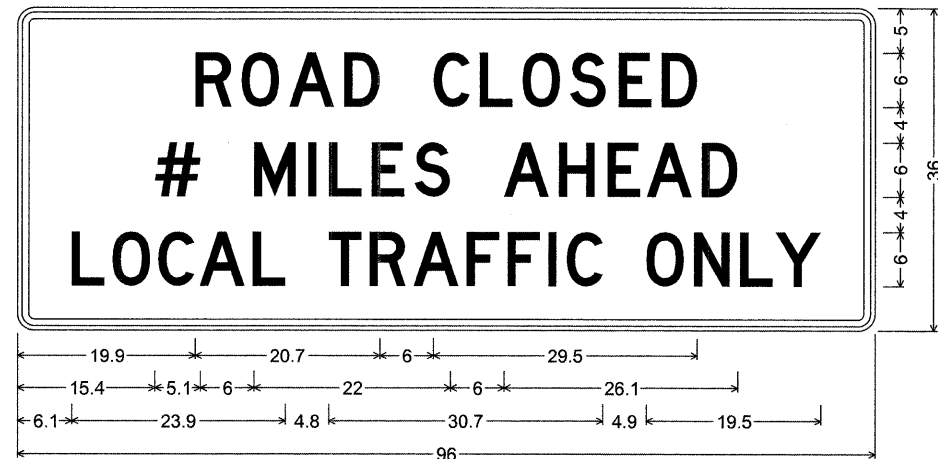

R11-2; 1.9" Radius, 0.8" Border, 0.5" Indent, Black on White;  
[ROAD CLOSED] White D; [# MILES AHEAD] White D;  
[LOCAL TRAFFIC ONLY] White D 81% spacing;

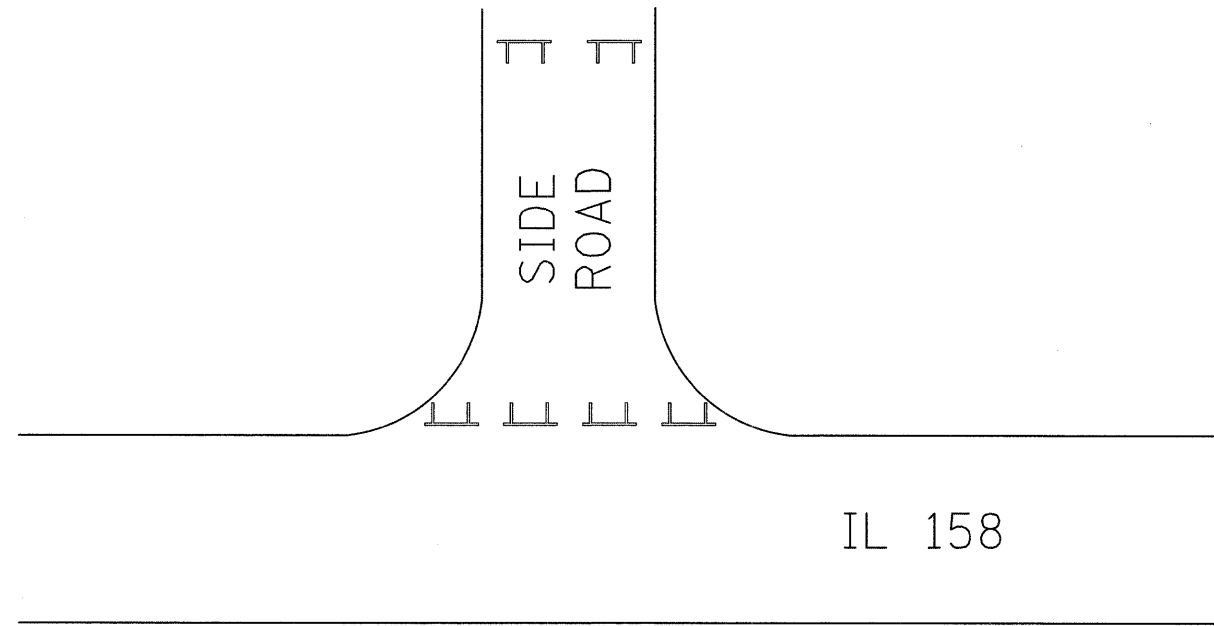

 - TYPE III BARRICADE WITH 48" X 30"  
"ROAD CLOSED" R11-2

REVISIONS	
NAME	DATE

ILLINOIS DEPARTMENT OF TRANSPORTATION  
DETOUR SIGN  
DETAILS  
FAP ROUTE 809 (IL RTE. 158)  
SECTION (133, 134)RS-4, 135RS-5  
ST. CLAIR AND MONROE COUNTY  
SCALE: VERT. \_\_\_\_\_ DATE \_\_\_\_\_  
HORIZ. \_\_\_\_\_ DRAWN BY \_\_\_\_\_  
CHECKED BY \_\_\_\_\_