

F.A.P. RTE.	SECTION	COUNTY	TOTAL SHEETS	SHEET NO.
809	(133,134)RS-4,135RS-5	ST. CLAIR, MONROE	252	37
STA. _____ TO STA. _____				
FED. ROAD DIST. NO. _____ ILLINOIS		FED. AID PROJECT		

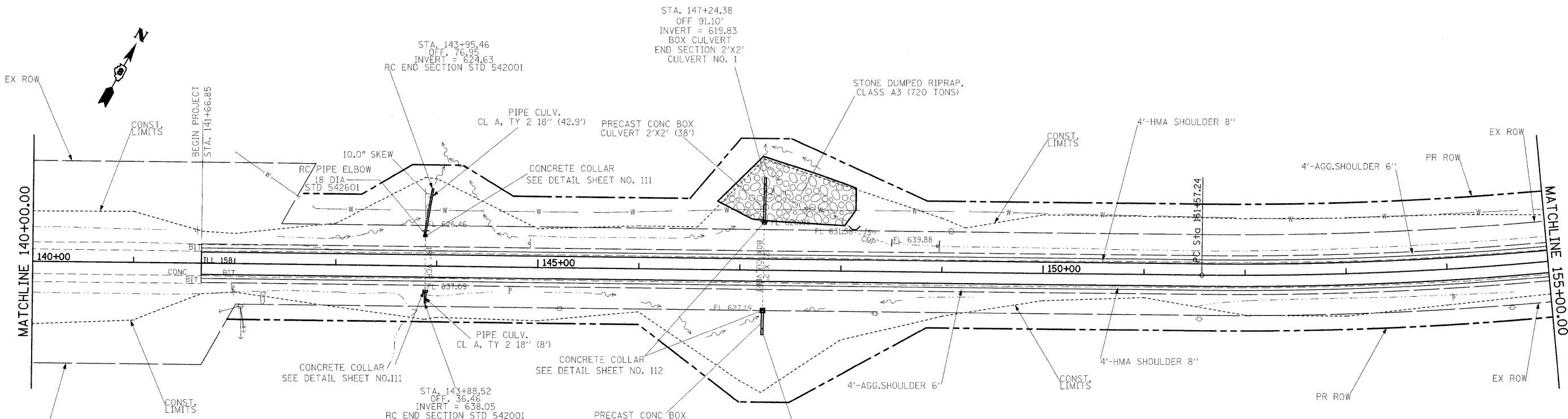

PROP. CURVECS
 PI STA. =156+70.48
 Δ =17° 18' 59" (LT)
 D =1° 42' 00"
 R =3,370.50'
 T =513.24'
 L =1,018.65'
 E =38.85'
 e = _____
 T.R. = _____
 S.E. RUN = _____
 P.C. STA. =151+57.24
 P.T. STA. =161+75.90

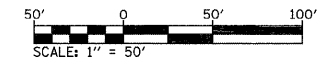

REVISIONS	
NAME	DATE

ILLINOIS DEPARTMENT OF TRANSPORTATION
PLAN VIEW
 FAP ROUTE 809 (IL RTE. 158)
 SECTION (133, 134)RS-4, 135RS-5
 ST. CLAIR AND MONROE COUNTY
 SCALE: VERT. _____
 HORIZ. _____
 DATE _____ DRAWN BY _____
 CHECKED BY _____

PLOT DATE = #DATE#
 FILE NAME = #FILE#
 PLOT SCALE = #SCALE#
 USER NAME = #USER#