

F.A.P. RTE.	SECTION	COUNTY	TOTAL SHEETS	SHEET NO.
809	(133,134)RS-4,135RS-5	ST. CLAIR, MONROE	252	38
STA. _____ TO STA. _____				
FED. ROAD DIST. NO. _____		ILLINOIS FED. AID PROJECT		

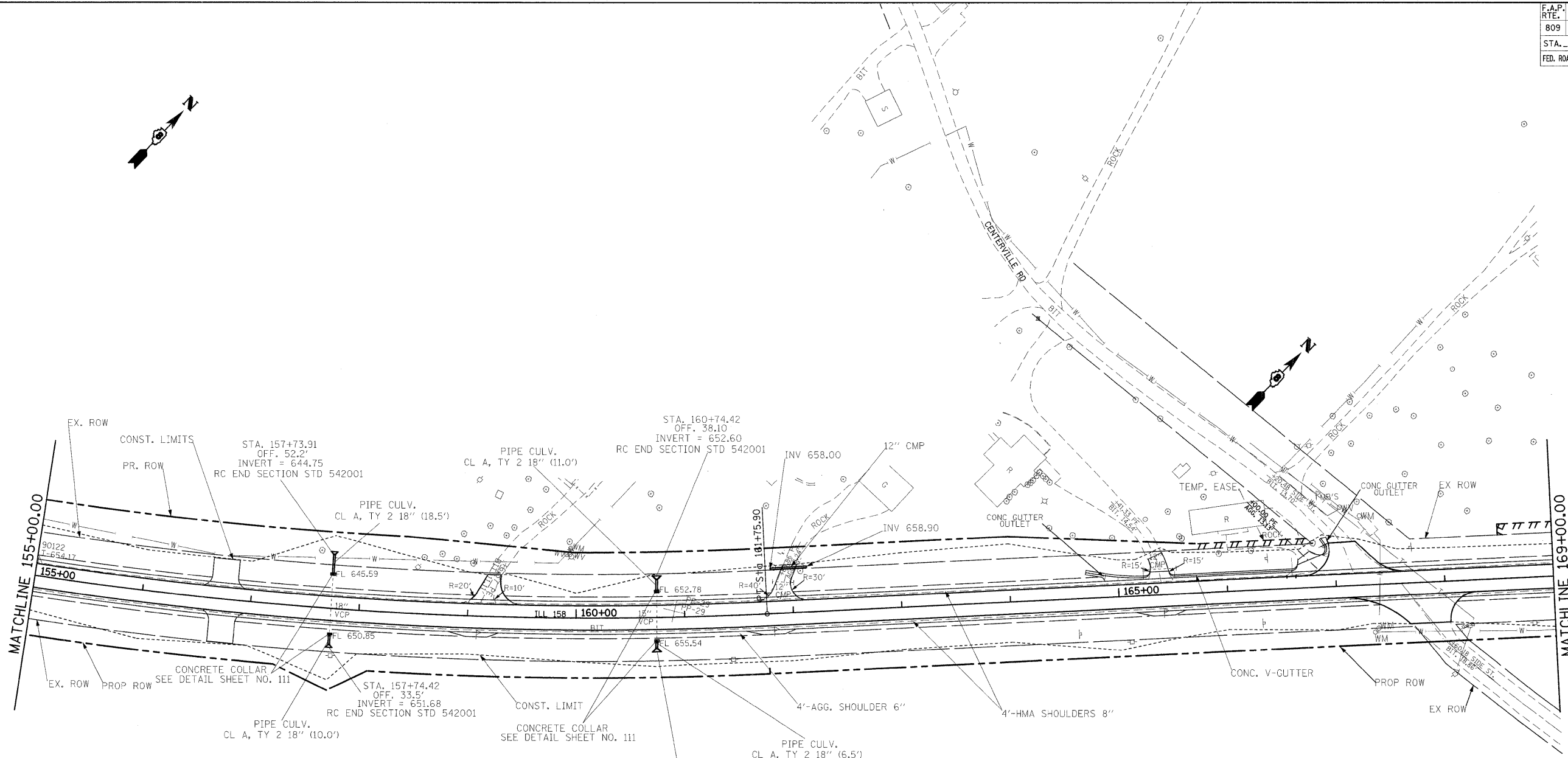

PROP. CURVES
 P.I. STA. = 156+70.48
 $\Delta = 17^\circ 18' 59''$ (LT)
 $D = 1^\circ 42' 00''$
 $R = 3,370.50'$
 $T = 513.24'$
 $L = 1,018.65'$
 $E = 38.85'$
 $\theta =$
 T.R. =
 S.E. RUN =
 P.C. STA. = 151+57.24
 P.T. STA. = 161+75.90

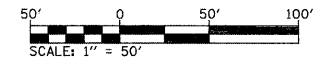

REVISIONS	
NAME	DATE

ILLINOIS DEPARTMENT OF TRANSPORTATION
PLAN VIEW
 FAP ROUTE 809 (IL RTE. 158)
 SECTION (133, 134)RS-4, 135RS-5
 ST. CLAIR AND MONROE COUNTY
 SCALE: VERT. _____
 HORIZ. _____
 DATE _____ DRAWN BY _____
 CHECKED BY _____

PLOT DATE = #DATE#
 FILE NAME = #FILE#
 PLOT SCALE = #SCALE#
 USER NAME = #USER#