

F.A.P. RTE.	SECTION	COUNTY	TOTAL SHEETS	SHEET NO.
809	(133,134)RS-4,135RS-5	ST. CLAIR, MONROE	252	42
STA. _____		TO STA. _____		
FED. ROAD DIST. NO. _____		ILLINOIS FED. AID PROJECT		

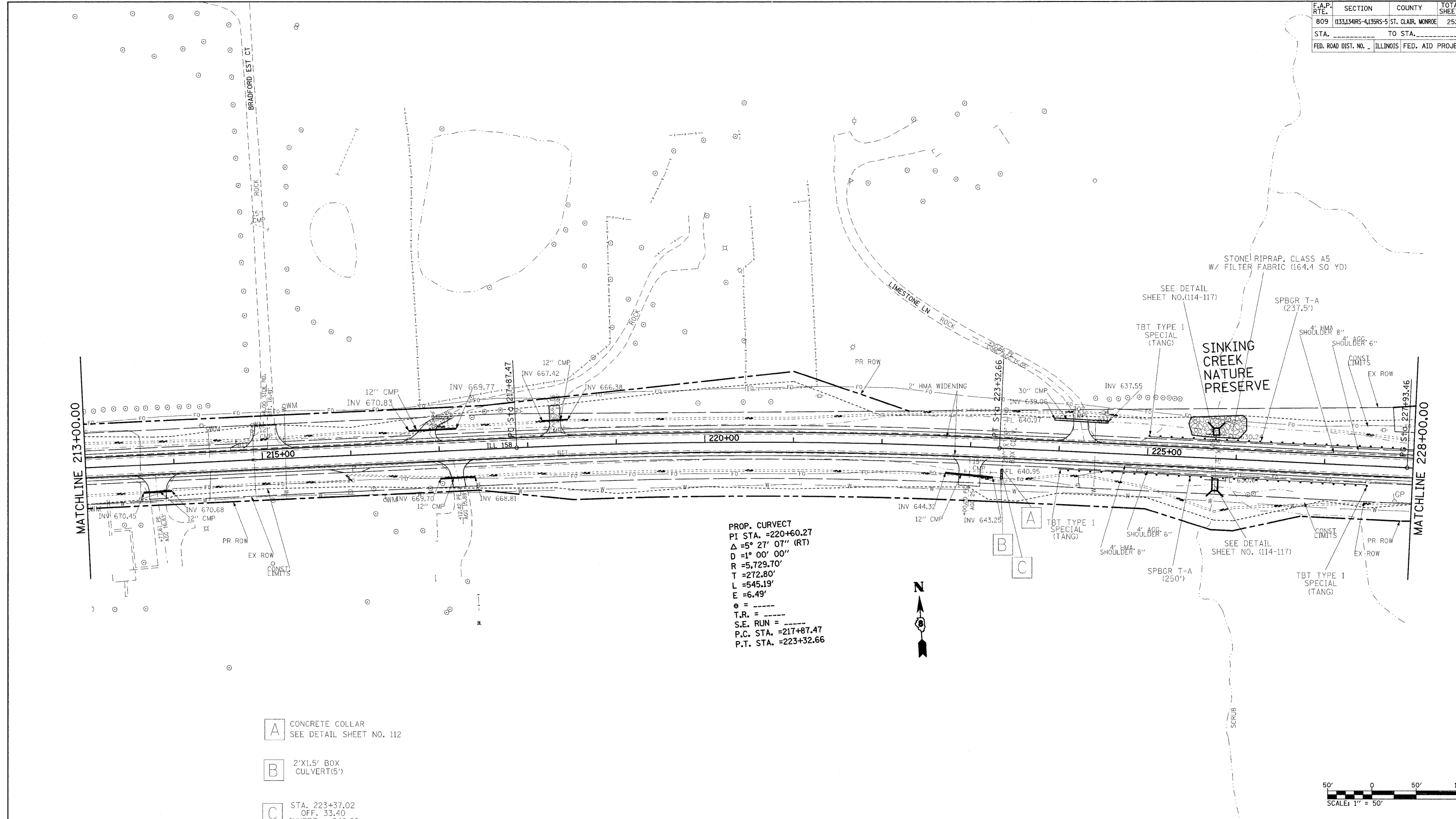

PROP. CURVECT
 PI STA. = 220+60.27
 Δ = 5° 27' 07'' (RT)
 D = 1° 00' 00''
 R = 5,729.70'
 T = 272.80'
 L = 545.19'
 E = 6.49'
 θ = ---
 T.R. = ---
 S.E. RUN = ---
 P.C. STA. = 217+87.47
 P.T. STA. = 223+32.66

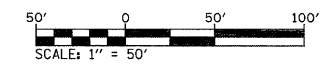

REVISIONS	
NAME	DATE

ILLINOIS DEPARTMENT OF TRANSPORTATION
PLAN VIEW
 FAP ROUTE 809 (IL RTE. 158)
 SECTION (133, 134)RS-4, 135RS-5
 ST. CLAIR AND MONROE COUNTY
 SCALE: VERT. _____
 HORIZ. _____
 DATE _____
 DRAWN BY _____
 CHECKED BY _____

PLOT DATE = #DATE#
 FILE NAME = #FILE#
 PLOT SCALE = #SCALE#
 USER NAME = #USER#