

F.A.P. RTE.	SECTION	COUNTY	TOTAL SHEETS	SHEET NO.
809	(133,134)RS-4,135RS-5	ST. CLAIR, MONROE	252	43
STA. _____		TO STA. _____		
FED. ROAD DIST. NO. _____		ILLINOIS FED. AID PROJECT _____		

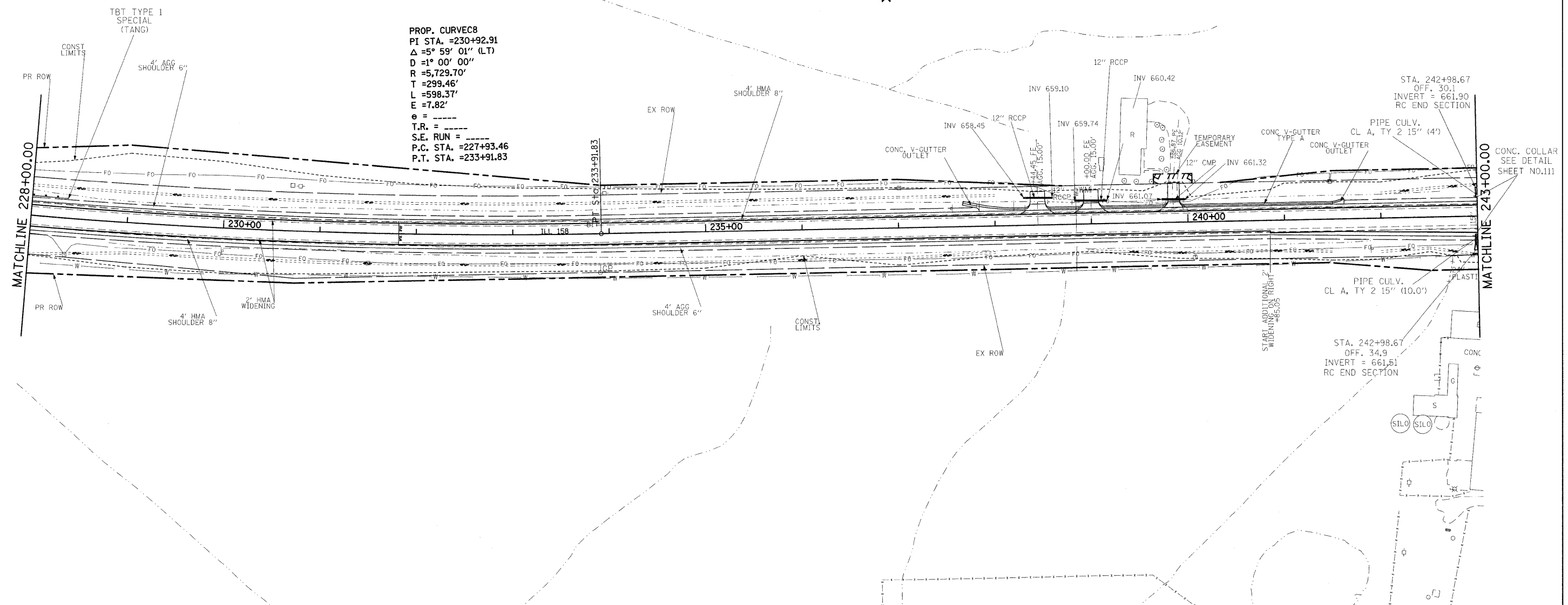

PROP. CURVEC8
 PI STA. =230+92.91
 $\Delta = 5^\circ 59' 01''$ (LT)
 $D = 1^\circ 00' 00''$
 $R = 5,729.70'$
 $T = 299.46'$
 $L = 598.37'$
 $E = 7.82'$
 $e = \text{-----}$
 $T.R. = \text{-----}$
 $S.E. \text{ RUN} = \text{-----}$
 P.C. STA. =227+93.46
 P.T. STA. =233+91.83



MATCHLINE 228+00.00

MATCHLINE 243+00.00

STA. 242+98.67
 OFF. 30.1
 INVERT = 661.90
 RC END SECTION

STA. 242+98.67
 OFF. 34.9
 INVERT = 661.51
 RC END SECTION

CONC. COLLAR
 SEE DETAIL
 SHEET NO.111

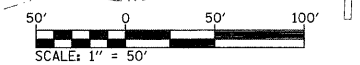

REVISIONS	
NAME	DATE

ILLINOIS DEPARTMENT OF TRANSPORTATION
PLAN VIEW
 FAP ROUTE 809 (IL RTE. 158)
 SECTION (133, 134)RS-4, 135RS-5
 ST. CLAIR AND MONROE COUNTY
 SCALE: VERT. _____
 DATE _____ HORIZ. _____
 DRAWN BY _____
 CHECKED BY _____

PLOT DATE = #DATE#
 FILE NAME = #FILE#
 PLOT SCALE = #SCALE#
 USER NAME = #USER#