

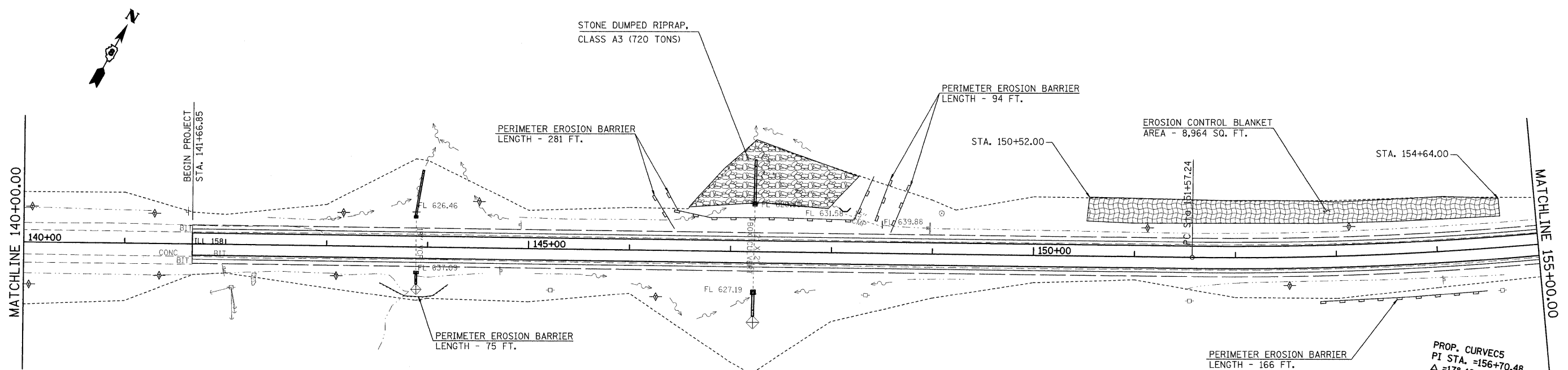

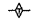

F.A.P. RTE.	SECTION	COUNTY	TOTAL SHEETS	SHEET NO.
809	033,134RS-4,135RS-5	ST. CLAIR, MONROE	252	90
STA. 140+00		TO STA. 155+00		
FED. ROAD DIST. NO. ILLINOIS		FED. AID PROJECT		

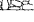
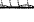
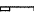

PROP. CURVES
 PI STA. =156+70.48
 Δ =17° 18' 59" (LT)
 D =1° 42' 00"
 R =3,370.50'
 T =513.24'
 L =1,018.65'
 E =38.85'
 θ = ----
 T.R. = ----
 S.E. RUN = ----
 P.C. STA. =151+57.24
 P.T. STA. =161+75.90

LEGEND

-  TEMPORARY DITCH CHECK- ROLLED EXCELSIOR, SILT WEDGES/PANELS
-  TEMPORARY DITCH CHECK- AGGREGATE
-  EROSION CONTROL BLANKET
-  PERIMETER EROSION BARRIER- SILT FILTER FENCE OR OTHER AS APPROVED BY THE ENGINEER
-  INLET AND PIPE PROTECTION
-  STONE DUMPED RIPRAP, CLASS A3
-  STONE RIPRAP, CLASS A5 WITH FILTER FABRIC

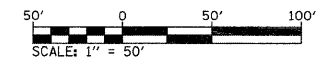

REVISIONS	
NAME	DATE

ILLINOIS DEPARTMENT OF TRANSPORTATION
EROSION CONTROL PLAN
 FAP ROUTE 809 (IL RTE. 158)
 SECTION (133, 134)RS-4, 135RS-5
 ST. CLAIR AND MONROE COUNTY
 SCALE: VERT. _____ DRAWN BY _____
 DATE: _____ CHECKED BY _____

PLOT DATE = #DATE#
 FILE NAME = #FILE#
 PLOT SCALE = #SCALE#
 USER NAME = #USER#