

F.A.P. RTE.	SECTION	COUNTY	TOTAL SHEETS	SHEET NO.
809	(133,134)RS-4,135RS-5	ST. CLAIR, MONROE	252	99
STA. 273+00		TO STA. 287+00		
FED. ROAD DIST. NO. _		ILLINOIS	FED. AID PROJECT	

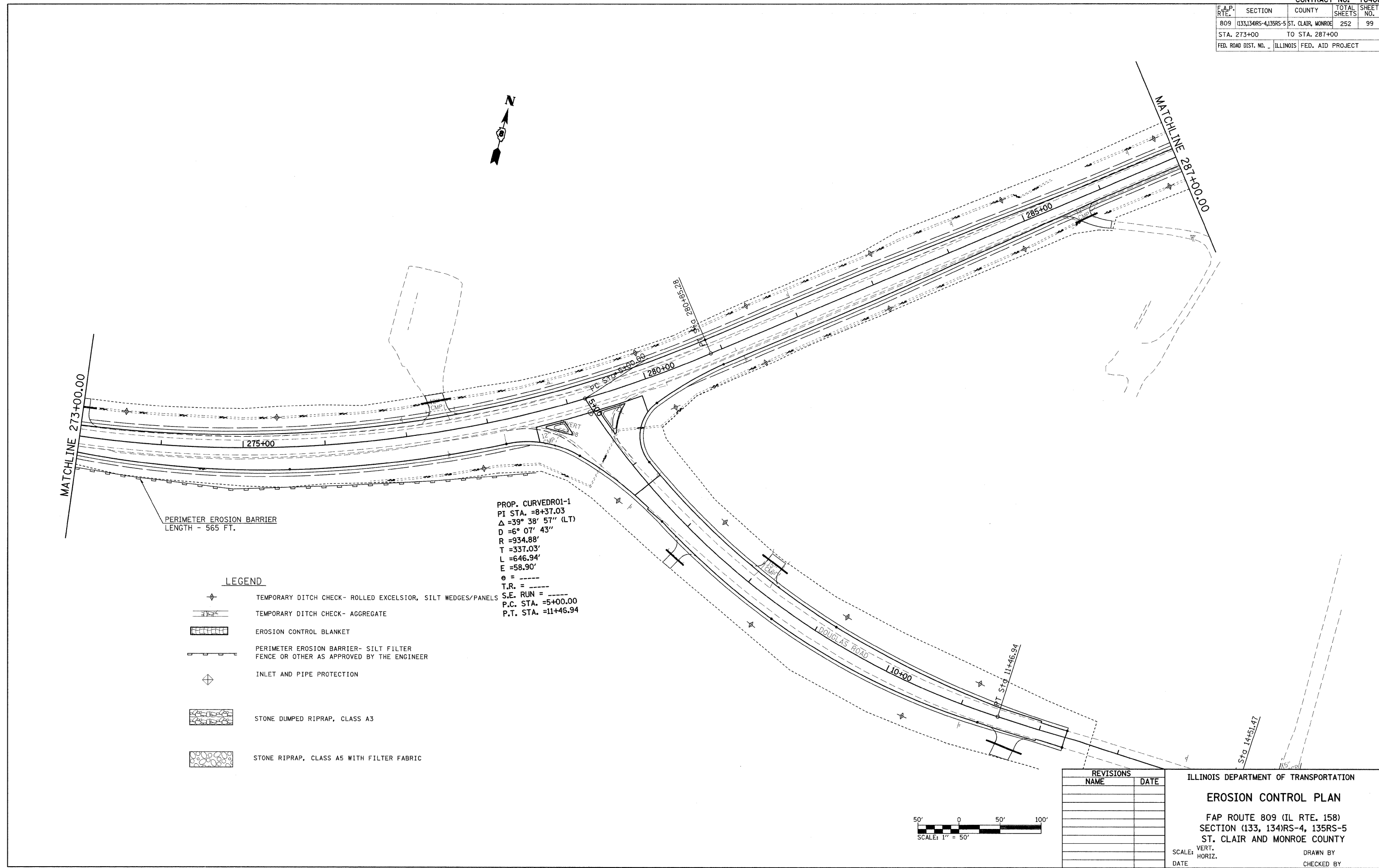

PERIMETER EROSION BARRIER  
LENGTH - 565 FT.

**LEGEND**

- TEMPORARY DITCH CHECK- ROLLED EXCELSIOR, SILT WEDGES/PANELS
- TEMPORARY DITCH CHECK- AGGREGATE
- EROSION CONTROL BLANKET
- PERIMETER EROSION BARRIER- SILT FILTER FENCE OR OTHER AS APPROVED BY THE ENGINEER
- INLET AND PIPE PROTECTION
- STONE DUMPED RIPRAP, CLASS A3
- STONE RIPRAP, CLASS A5 WITH FILTER FABRIC

PROP. CURVEDR01-1  
PI STA. =8+37.03  
Δ =39° 38' 57" (LT)  
D =6° 07' 43"  
R =934.88'  
T =337.03'  
L =646.94'  
E =58.90'  
e = ----  
T.R. = ----  
S.E. RUN = ----  
P.C. STA. =5+00.00  
P.T. STA. =11+46.94

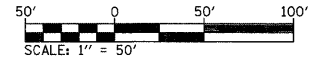

REVISIONS	NAME	DATE

ILLINOIS DEPARTMENT OF TRANSPORTATION  
**EROSION CONTROL PLAN**  
FAP ROUTE 809 (IL RTE. 158)  
SECTION (133, 134)RS-4, 135RS-5  
ST. CLAIR AND MONROE COUNTY  
SCALE: VERT. \_\_\_\_\_  
          HORIZ. \_\_\_\_\_  
DATE \_\_\_\_\_ DRAWN BY \_\_\_\_\_  
                                CHECKED BY \_\_\_\_\_

PLOT DATE = #DATE#  
FILE NAME = #FILE#  
PLOT SCALE = #SCALE#  
USER NAME = #USER#