

F.A.P. RTE.	SECTION	COUNTY	TOTAL SHEETS	SHEET NO.
809	(133,134)RS-4,135RS-5	ST. CLAIR, MONROE	252	105
STA. 358+00		TO STA. 364+25.70		
FED. ROAD DIST. NO. _		ILLINOIS FED. AID PROJECT		

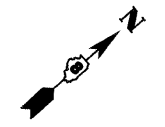

**LEGEND**

- TEMPORARY DITCH CHECK- ROLLED EXCELSIOR, SILT WEDGES/PANELS
- TEMPORARY DITCH CHECK- AGGREGATE
- EROSION CONTROL BLANKET
- PERIMETER EROSION BARRIER- SILT FILTER FENCE OR OTHER AS APPROVED BY THE ENGINEER
- INLET AND PIPE PROTECTION
- STONE DUMPED RIPRAP, CLASS A3
- STONE RIPRAP, CLASS A5 WITH FILTER FABRIC

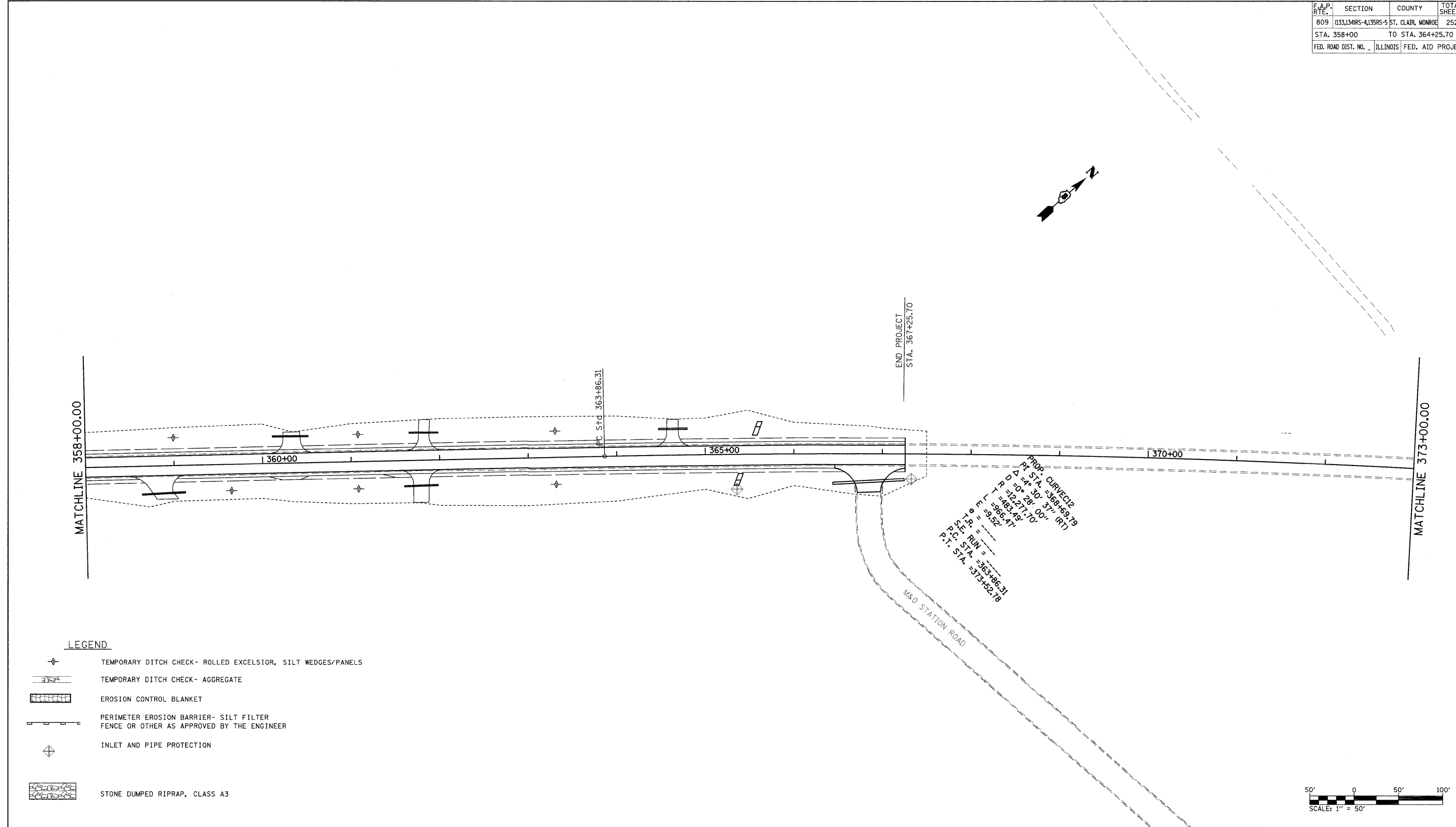
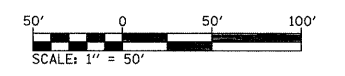

REVISIONS	
NAME	DATE

ILLINOIS DEPARTMENT OF TRANSPORTATION  
**EROSION CONTROL PLAN**  
 FAP ROUTE 809 (IL RTE. 158)  
 SECTION (133, 134)RS-4, 135RS-5  
 ST. CLAIR AND MONROE COUNTY  
 SCALE: VERT. \_\_\_\_\_  
 HORIZ. \_\_\_\_\_  
 DATE \_\_\_\_\_ DRAWN BY \_\_\_\_\_  
 CHECKED BY \_\_\_\_\_

PLOT DATE = #DATE#  
 FILE NAME = #FILE#  
 PLOT SCALE = #SCALE#  
 USER NAME = #USER#