

DATE	
BY	
FINAL SURVEY	SURVEYED
NOTE BOOK	NOTED
NO.	NO.
	AREAS CHECKED

DATE	
BY	
ORIGINAL SURVEY	SURVEYED
NOTE BOOK	NOTED
NO.	NO.
	AREAS CHECKED

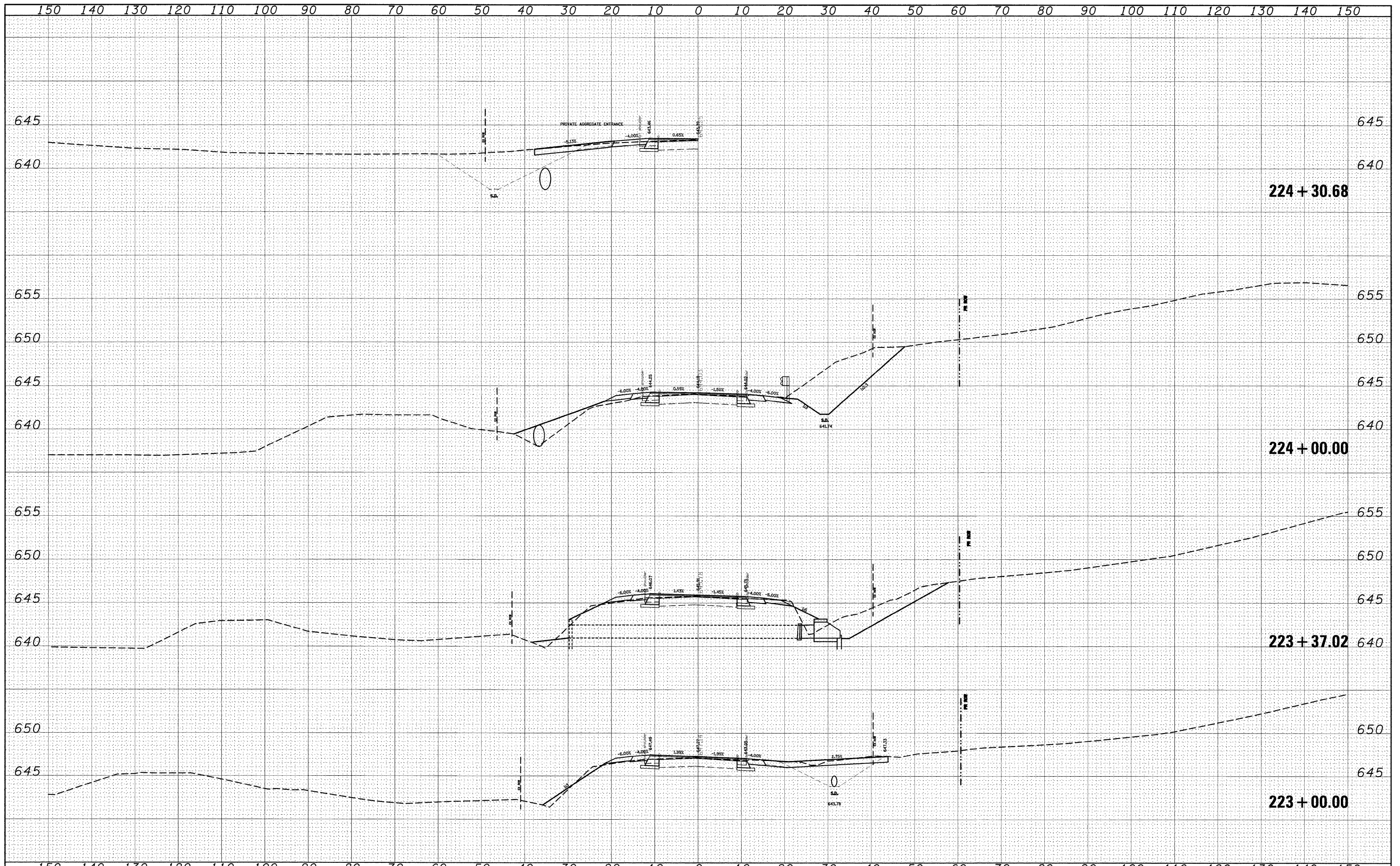

FILE NAME =	USER NAME = dntelmanjn	DESIGNED -	REVISED -	STATE OF ILLINOIS DEPARTMENT OF TRANSPORTATION	CROSS SECTIONS		F.A.P. RTE.	SECTION	COUNTY	TOTAL SHEETS	SHEET NO.
o:\pwwork\pwwid07\DINTELMAN\JN\dms51225\ssht10102e.dgn		DRAWN -	REVISED -		809	(133,134)RS-4,135RS-5	ST. CLAIR, MONROE	252	163		
PLOT SCALE = 10,0005 / IN.		CHECKED -	REVISED -		CONTRACT NO. 76408						
PLOT DATE = 12/16/2008		DATE -	REVISED -		FED. ROAD DIST. NO. - ILLINOIS FED. AID PROJECT						
				SCALE: -----		SHEET NO. -- OF -- SHEETS		STA. 223+00.00 TO STA. 224+30.68			