

PART OF THE NE 1/4 OF SECTION 17, AND NW 1/4 OF SECTION 16, T1S, R9W, OF THE 3RD PM, ST. CLAIR COUNTY, ILLINOIS

BEARINGS SHOWN HEREON ARE BASED ON SURVEY CONTROL DATA AS PROVIDED BY THE ILLINOIS DEPARTMENT OF TRANSPORTATION.

FAP ROUTE	SECTION	COUNTY	TOTAL SHEETS	SHEET NO.
809	133134 RS-4, 135 RS-5	MONROE / ST. CLAIR	PL 28 PL 21	
STA. 339+00	TO STA. 352+00			
CONTRACT NO.: 01902				
R-98-008-03				

LEGEND

- EXISTING CENTERLINE
- EXISTING RIGHT OF WAY LINE
- EXISTING EASEMENT LINE
- PROPOSED CENTERLINE
- PROPOSED RIGHT OF WAY LINE
- PROPOSED TEMPORARY EASEMENT LINE
- PROPOSED PERMANENT EASEMENT LINE
- SECTION LINE
- QUARTER SECTION LINE
- QUARTER QUARTER SECTION LINE
- PROPERTY (DEED) LINE
- APPARENT PROPERTY LINE
- MEASURED DIMENSION (121.45')
- COMPUTED DIMENSION (123.45')
- RECORDED DIMENSION (123.45')
- FOUND IRON PIPE OR IRON ROD AT CORNER UNLESS OTHERWISE NOTED
- SET 5/8 INCH IRON ROD AT CORNER UNLESS OTHERWISE NOTED
- PERMANENT SURVEY MONUMENT, I.D.O.T. STD. 667101 (TO BE SET BY OTHERS)
- CUT CROSS FOUND OR SET
- FOUND RIGHT OF WAY MARKER
- PROPOSED E OF CONSTRUCTION BEARING AND DISTANCE
- SAME OWNERSHIP
- EXISTING BUILDING

STAKING OF PROPOSED RIGHT OF WAY. SET 5/8 INCH METAL ROD WITH DIVISION OF HIGHWAY SURVEY BY INSCRIPTION DATA AND SURVEYORS REGISTRATION NUMBER. (PROPOSED RIGHT OF WAY CORNERS SET IN CULTIVATED AREAS SHALL BE A MINIMUM OF 20 INCHES BELOW THE GROUND SURFACES).

ALL DETAILS SHOWN NOT TO SCALE UNLESS OTHERWISE NOTED

STATE OF MISSOURI)
) SS
CITY OF ST. LOUIS)

I, RONNIE D. LOWE, AN ILLINOIS PROFESSIONAL LAND SURVEYOR, CERTIFY THAT I HAVE SURVEYED THE PLAT OF HIGHWAY SHOWN HEREON AND THAT THIS PROFESSIONAL SERVICE CONFORMS TO THE CURRENT ILLINOIS MINIMUM STANDARDS FOR A BOUNDARY SURVEY FOR THE PROPOSED PARCEL(S) TO BE ACQUIRED BY THE STATE OF ILLINOIS, DEPARTMENT OF TRANSPORTATION, SHOWN HEREON.

DATED _____
RONNIE D. LOWE, PLS NO. 035-003363
LICENSE EXPIRATION DATE: 11/30/2008



Engineering Architecture Surveying
800 South Vandeventer Avenue
St. Louis, MO 63110
(314) 534-1090
ILLINOIS LICENCE NO: 184-003391
Expiration Date: April 30, 2008

ILLINOIS DEPARTMENT OF TRANSPORTATION
PLAT OF HIGHWAYS
FAP ROUTE 809 (IL 158)
SECTION 133,134 RS-4,135 RS-5
MONROE AND ST. CLAIR COUNTY
JOB NO. R-98-008-03

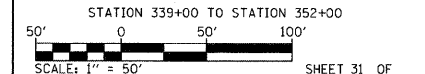

COMPLETION DATE OF FIELD WORK PERFORMED
LAND SURVEY: OCTOBER 06, 2006
RIGHT OF WAY STAKING: XXXXXXXXXXXXX

ILLINOIS DEPARTMENT OF TRANSPORTATION
DIVISION OF HIGHWAYS/DISTRICT 8
1102 EASTPORT PLAZA DRIVE
COLLINGSVILLE, ILLINOIS 62234-6198
SHEET 1 IS A COVER SHEET

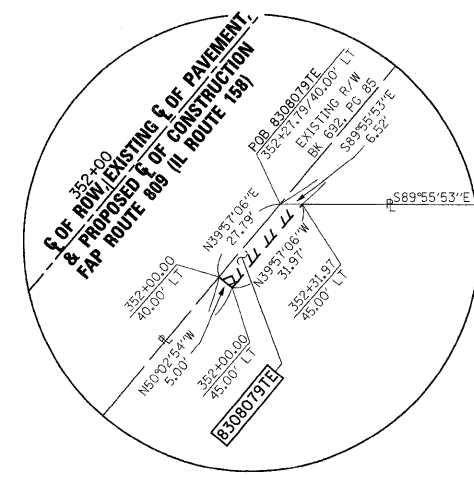

DETAIL B

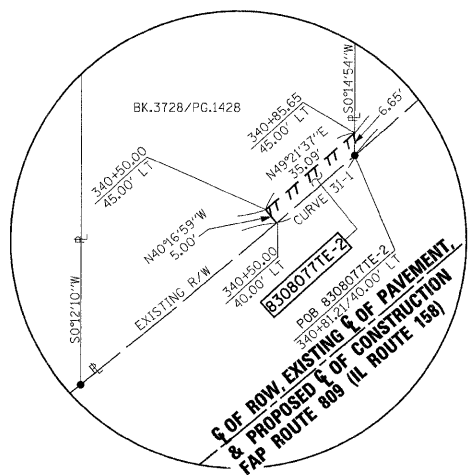

DETAIL A

COORDINATES SHOWN HEREON ARE BASED ON SURVEY CONTROL DATA AS PROVIDED BY THE ILLINOIS DEPARTMENT OF TRANSPORTATION.

STATION	OFFSET	NORTHING	EASTING
341+21.70	40.00' RT	649870.4095	2312972.2015
341+57.88	0	649924.5124	2312972.4360
341+95.53	40.00' LT	649979.2621	2312972.6734
345+38.28	40.00' LT	650227.9670	2313200.8225
PT 345+38.28	0	650195.0706	2313235.3169
345+38.28	40.00' RT	650173.3850	2313265.9823

CURVE TABLE				
Curve	R	L	C	CB
CURVE - 31-1	R = 2,824.90'	L = 30.77'	C = 30.77'	CB = S49°24'17\"/>

PARCEL NO.	OWNER	TOTAL HOLDING ACRES	FEE SIMPLE ACQUISITION				EASEMENTS		PERMANENT TAX NUMBER	PROPERTY ACQUIRED BY			
			GROSS ACRES	SO. FT.	PREVIOUSLY DEDICATED ACRES	NET SQ. FT.	REMAINDER ACRES	PE = PERMANENT TE = TEMPORARY SQ. FT.			EASEMENT PURPOSE		
8308077	SEE SHEET 30												
8308079	David H. Albert and William H. Albert, as Tenants in common Book 3091, Page 1616 Title Report Number SC-4044-2	21.4026						21.4026	0.0034	149	ENTRANCE CONSTRUCTION AND GRADING	12-16-100-011	

PROP. CURVE C11
PI STA. = 340+46.66
Δ = 19° 51' 56\"/>

South Line NW 1/4 NW 1/4 Sec 16, T1S, R9W

NO.	DATE	DESCRIPTION	BY

DATE: 10/06/06
DRAWN: RDL
CHECKED: RDL
DATE: 10/06/06