

EXIST. CURVE
 P.I. STA. = 1124+26.48
 $\Delta = 28^{\circ} 09' 17''$ (L.T.)
 $D = 0^{\circ} 28' 00''$
 $R = 12,277.67'$
 $T = 3,078.78'$
 $L = 6,033.15'$
 $E = 380.14'$
 $S.E. = 0.0156'/'$
 P.C. STA. = 1093+47.70
 P.T. STA. = 1153+80.85

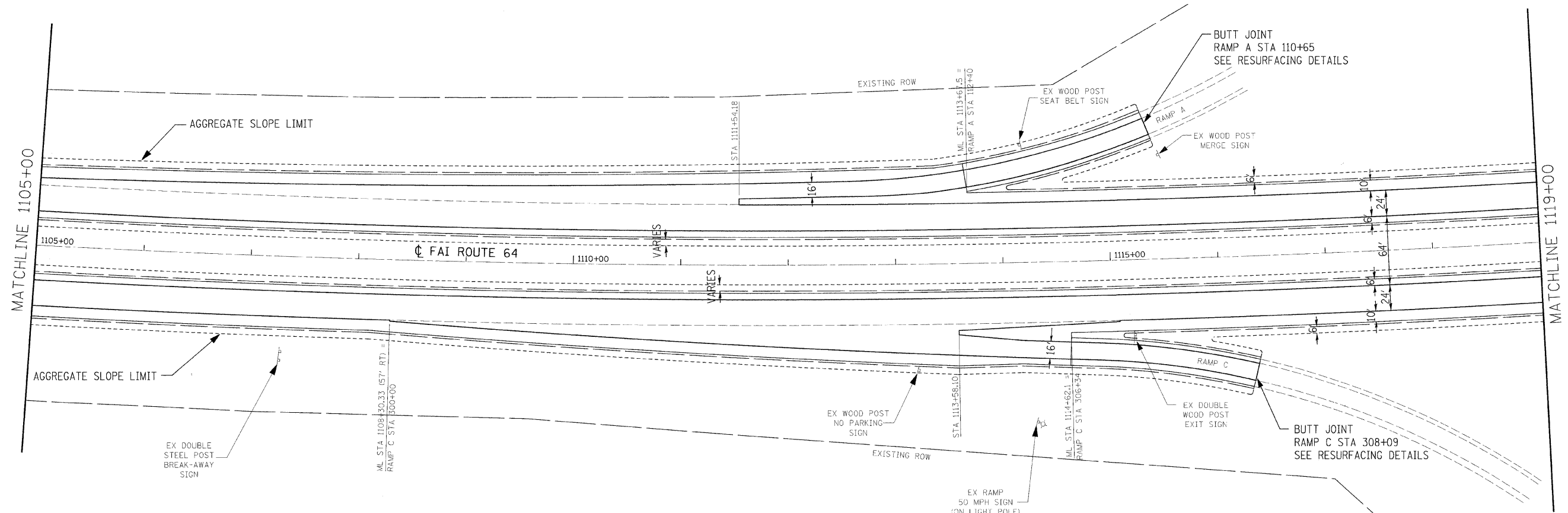

REF: a12kpa080505
 REF: a12of1e080505
 PLOT DRIVER: C:\Program Files\Bentley\MapSystems\temp\lotdrv\inter-full.plt
 PEN TABLE: S:\CADD\Library\lotdrv\inter-full.tbl

FILE NAME = 0876850-sh1-plan.dgn	USER NAME = untitled	DESIGNED - SCF	REVISED - -
PLOT SCALE = 50,0000 ' / IN.	CHECKED - TJO	DRAWN - SCF	REVISED - -
PLOT DATE = 12/18/2008	DATE - 12/12/08	CHECKED - TJO	REVISED - -

**STATE OF ILLINOIS
 DEPARTMENT OF TRANSPORTATION**

PLAN SHEET

SCALE: 1" = 50' SHEET NO. 2 OF 26 SHEETS STA. 1105+00 TO STA. 1119+00

F.A.I. RTE.	SECTION	COUNTY	TOTAL SHEETS	SHEET NO.
64	82-(8,9,10)RS-3	ST. CLAIR-CLINTON	78	15
FED. ROAD DIST. NO.			ILLINOIS FED. AID PROJECT	
			CONTRACT NO. 76855	