

TIE POINT  
PT STA 1107+70.70  
MAG NAIL (SET)

ALL TIES MAG  
NAIL IN EOP

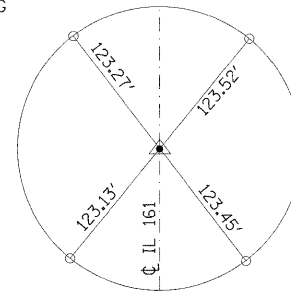

TIE POINT  
PT STA 1119+05.00  
MAG NAIL (SET)

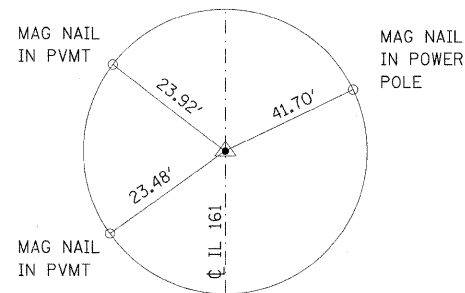
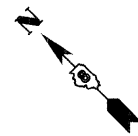

TIE POINT  
PT STA 1130+32.34  
MAG NAIL (SET)

BENCHMARKS

BM #1: CHISELED "+" ON TOP FLANGE BOLT NEXT TO THE "O"  
IN OPEN OF FIRE HYDRANT AT THE N.E. CORNER OF IL  
161 AN P.E. LOCATED WEST OF THE EXISTING STRUCTURE  
STA 1115+17.00 39' RT  
ELEVATION = 430.71

BM #2: CHISELED "+" ON TOP OF WINGWALL AT THE  
S.E. CORNER OF THE EXISTING CORNER  
STA 1120+29.00, 17' RT  
ELEVATION = 426.56

NOTE: ALL TIES PULLED DIRECT

FILE NAME =	USER NAME = gelnh	DESIGNED - HG	REVISED - ---	<b>STATE OF ILLINOIS DEPARTMENT OF TRANSPORTATION</b>	<b>TIE POINTS &amp; BENCHMARKS</b>			F.A.P. RTE.	SECTION	COUNTY	TOTAL SHEETS	SHEET NO.
c:\pw_work\pwtidot\gelnh\dms51845\pin0206e.dgn	PLOT SCALE = 50.0000' / IN.	DRAWN - HG	REVISED - ---					805	126-BR-1	CLINTON	85	8
PLOT DATE = 12/9/2008	DATE - -----	CHECKED - ---	REVISED - ---		SCALE: 1" = 20' SHEET NO. ___ OF ___ SHEETS STA. TO STA.			FED. ROAD DIST. NO. ILLINOIS FED. AID PROJECT				
								<b>CONTRACT NO. 76976</b>				