

PRE-STAGE I CONSTRUCTION:

- PRE-STAGE I CONSTRUCTION SHALL CONSIST OF THE CONSTRUCTION OF THE 3' PAVEMENT WIDENING ON THE NORTHEAST AND NORTHWEST CORNERS OF THE STRUCTURE. TRAFFIC CONTROL SHALL BE IN ACCORDANCE WITH TRAFFIC CONTROL AND PROTECTION, STANDARD 701326.

STAGE I CONSTRUCTION:

- STAGE I CONSTRUCTION SHALL CONSIST OF STAGE I REMOVAL OF THE EXISTING STRUCTURE, AND STAGE I CONSTRUCTION OF THE REPLACEMENT STRUCTURE, PAVEMENT REMOVAL, GRADING, RESURFACING THE RIGHT SIDE PAVEMENT NORTH AND SOUTH OF THE STRUCTURE, GUARDRAIL, RIPRAP, ETC. STAGE I CONSTRUCTION SHALL BE DONE ACCORDING TO STAGE CONSTRUCTION AS DETAILED IN THE BRIDGE PLANS. TRAFFIC CONTROL SHALL BE IN ACCORDANCE WITH THE APPLICABLE PORTIONS OF STANDARD 701321 AND AS DETAILED IN THE STAGE CONSTRUCTION PLANS. THIS TRAFFIC CONTROL SHALL BE PAID FOR AS TRAFFIC CONTROL AND PROTECTION 701321 (SPECIAL).

THE MILLING AND RESURFACING PORTION OF THE PROJECT (STA 1112+75.00 TO STA. 1115+50.00) SHALL BE IN ACCORDANCE WITH THE APPLICABLE PORTIONS OF STANDARD 701306 AND AS DETAILED IN THE STAGE CONSTRUCTION PLANS. THIS TRAFFIC CONTROL SHALL BE PAID FOR AS TRAFFIC CONTROL SPECIAL AND PROTECTION 701306.

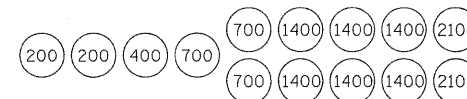

SAND MODULE IMPACT ATTENUATOR LAYOUT (IF OPTION USED)

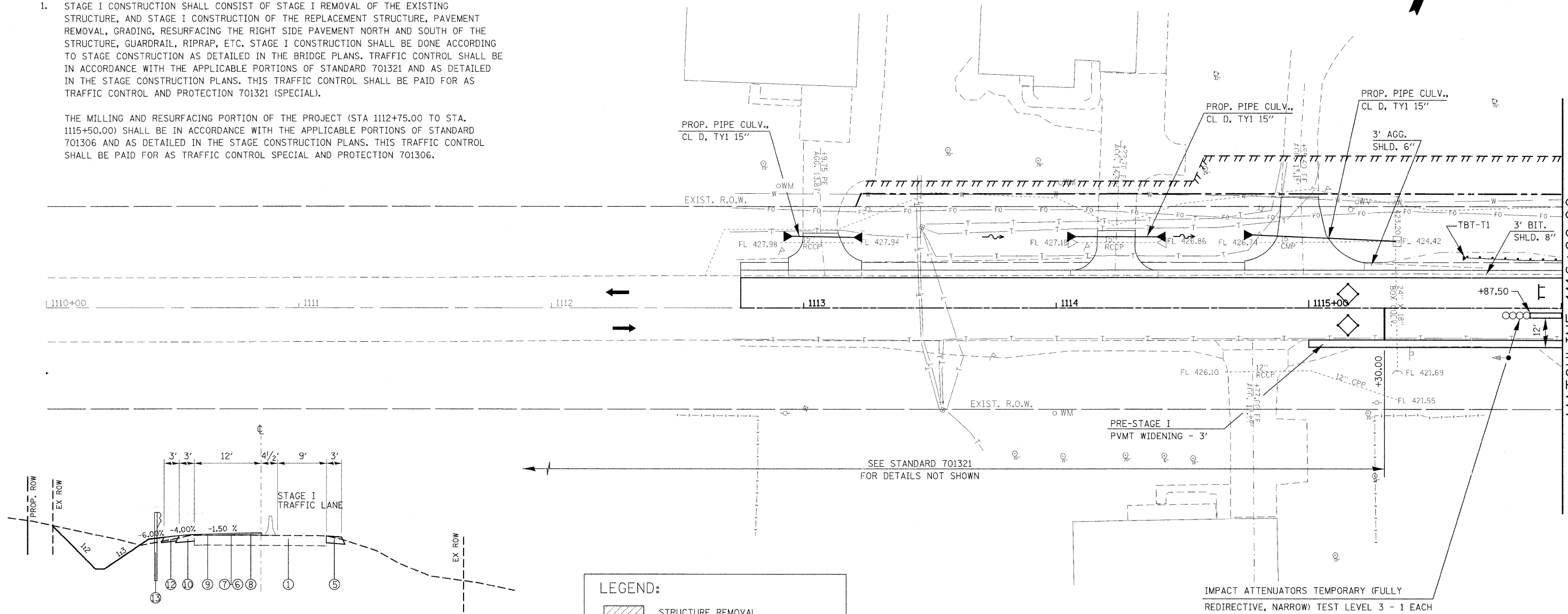

MATCHLINE 1116+00.00

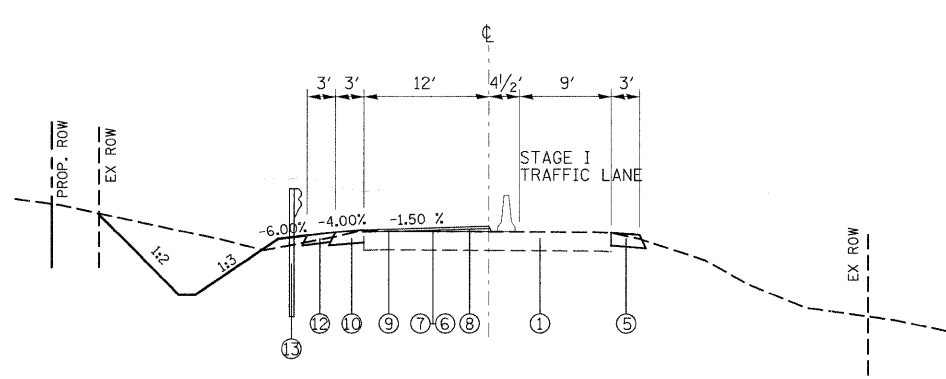

STAGE I TYPICAL SECTION
STA. 1112+25.0 TO STA. 1116+00.0
(NTS)

- LEGEND**
- ① EXISTING PAVEMENT
 - ⑤ PROPOSED HOT-MIX ASPHALT BASE COURSE WIDENING 9"
 - ⑥ PROPOSED BITUMINOUS MATERIALS (PRIME COAT)
 - ⑦ PROPOSED AGGREGATE (PRIME COAT)
 - ⑧ PROPOSED HMA BINDER COURSE (VARIES FROM 3/4" TO 9/2")
 - ⑨ PROPOSED HMA SURFACE COURSE, 1 1/2"
 - ⑩ PROPOSED HMA SHOULDER, 8"
 - ⑫ PROPOSED AGGREGATE SHOULDER, TYPE B 6"
 - ⑬ PROPOSED GUARDRAIL

LEGEND:

- STRUCTURE REMOVAL
- PAVEMENT REMOVAL
- TEMPORARY CONCRETE BARRIER
- IMPACT ATTENUATOR
- INDUCTION LOOP DETECTOR
- DRUM WITH STEADY BURNING LIGHT
- SIGNALIZED TWO-WAY TRAFFIC LANE
- TEMPORARY BRIDGE TRAFFIC SIGNAL
- TYPE III BARRICADE

- NOTES:**
- THE CONTRACTOR SHALL MAINTAIN ACCESS TO PRIVATE AND FIELD ENTRANCES LOCATED WITHIN THE LIMITS OF THE PROJECT.
 - TRAFFIC CONTROL & PROTECTION, STANDARD 701321 (SPECIAL) INCLUDES BOTH STAGE I & II AND ANY ADDITIONAL SIGNING OR TRAFFIC CONTROL DEVICES SHOWN ON THE STAGE CONSTRUCTION PLANS.
 - ALL ADDITIONAL TRAFFIC SIGNAL HEADS, LOOP DETECTORS AND ASSOCIATED EQUIPMENT REQUIRED TO MAINTAIN ACCESS AT THE FIELD AND DRIVEWAY ENTRANCES SHALL BE INCLUDED IN THE COST OF "TEMPORARY BRIDGE TRAFFIC SIGNALS"
 - THE COST OF "BARRICADES, TYPE III" SHALL BE INCLUDED IN THE COST OF "TRAFFIC CONTROL AND PROTECTION, STANDARD 701321 (SPECIAL)".
 - ALL SIDEROADS AND ENTRANCES WITHIN TRAFFIC CONTROL SHALL HAVE "NO RIGHT TURN ON RED" AND "STOP HERE ON RED" SIGNS. THE COST SHALL BE INCLUDED IN THE COST OF "TRAFFIC CONTROL AND PROTECTION, STANDARD 701321 (SPECIAL)".
 - THE LENGTH OF THE TEMPORARY CONCRETE BARRIER FOR STAGE I CONSTRUCTION IS 875 FT.

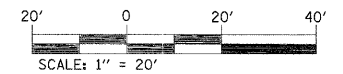

FILE NAME = c:\pw\work\pwidot\gelinh\dms51845\Stage	USER NAME = gelinh	DESIGNED -	REVISED -	STATE OF ILLINOIS DEPARTMENT OF TRANSPORTATION	SUGGESTED STAGE I CONSTRUCTION AND TRAFFIC CONTROL		F.A.P. R.T.E. 805	SECTION 126-BR-1	COUNTY CLINTON	TOTAL SHEETS 85	SHEET NO. 13
	PLOT SCALE = 28.0000' / IN.	DRAWN -	REVISED -				SCALE: 1" = 20'	SHEET NO. ___ OF ___ SHEETS	STA. 1110+00.00 TO STA. 1116+00.00	CONTRACT NO. 76976	
PLOT DATE = 12/9/2008	CHECKED -	REVISED -	REVISED -			FED. ROAD DIST. NO. ILLINOIS FED. AID PROJECT					