

STAGE II CONSTRUCTION:

1. STAGE II CONSTRUCTION SHALL CONSIST OF STAGE II REMOVAL OF THE EXISTING STRUCTURE, AND STAGE II CONSTRUCTION OF THE REPLACEMENT STRUCTURE, REMOVE PRE-STAGE I PAVEMENT WIDENING, PAVEMENT REMOVAL, GRADING, RESURFACING THE LEFT SIDE PAVEMENT EAST AND WEST OF THE STRUCTURE, GUARDRAIL, RIPRAP, ETC. STAGE II CONSTRUCTION SHALL BE DONE ACCORDING TO STAGE CONSTRUCTION AS DETAILED IN THE BRIDGE PLANS. TRAFFIC CONTROL SHALL BE IN ACCORDANCE WITH THE APPLICABLE PORTIONS OF STANDARD 701321 AND AS DETAILED IN THE STAGE CONSTRUCTION PLANS. THIS TRAFFIC CONTROL SHALL BE PAID FOR AS TRAFFIC CONTROL AND PROTECTION 701321 (SPECIAL).

THE MILLING AND RESURFACING PORTION OF THE PROJECT (STA. 1112+75.00 TO STA. 1115+50.00) SHALL BE IN ACCORDANCE WITH THE APPLICABLE PORTIONS OF STANDARD 701306 AND AS DETAILED IN THE STAGE CONSTRUCTION PLANS. THIS TRAFFIC CONTROL SHALL BE PAID FOR AS TRAFFIC CONTROL AND PROTECTION 701306.

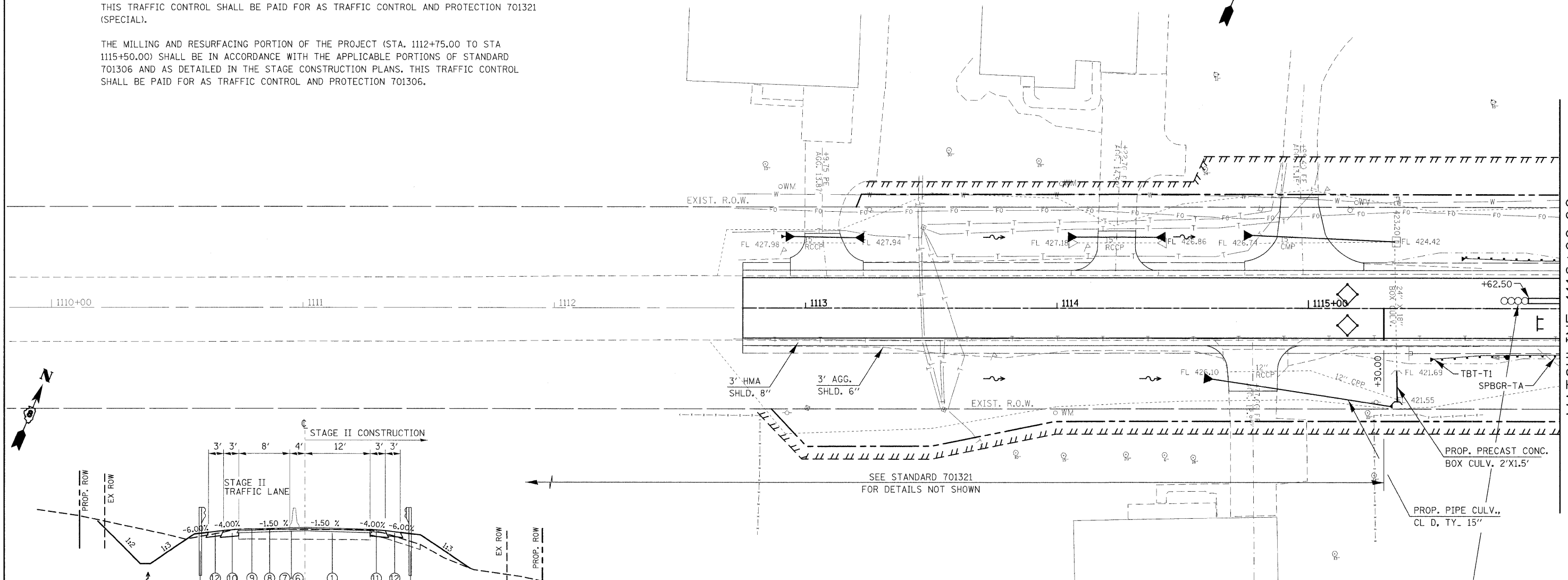
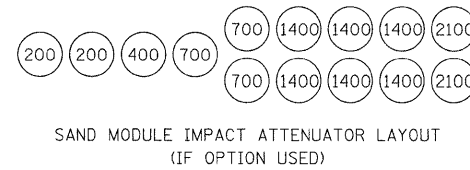

MATCHLINE 1116+00.00

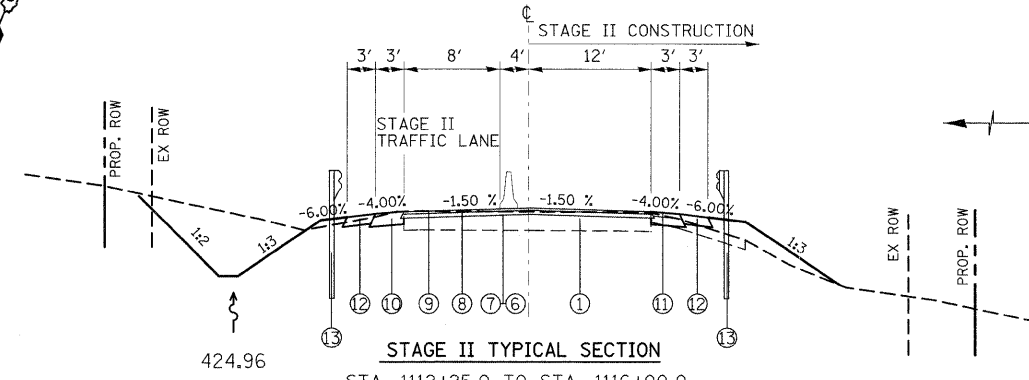

STAGE II TYPICAL SECTION
STA. 1112+25.0 TO STA. 1116+00.0 (NTS)

- LEGEND**
- ① EXISTING PAVEMENT
 - ⑤ PROPOSED HOT-MIX ASPHALT BASE COURSE WIDENING 9"
 - ⑥ PROPOSED BITUMINOUS MATERIALS (PRIME COAT)
 - ⑦ PROPOSED AGGREGATE (PRIME COAT)
 - ⑧ PROPOSED HMA BINDER COURSE (VARIES FROM 3/4" TO 9/2")
 - ⑨ PROPOSED HMA SURFACE COURSE, 1 1/2"
 - ⑩ PROPOSED HMA SHOULDER, 8" (SEE NOTE)
 - ⑪ PROPOSED HMA SHOULDER, 2" (SEE NOTE)
 - ⑫ PROPOSED AGGREGATE SHOULDER, TYPE B 6"
 - ⑬ PROPOSED GUARDRAIL

LEGEND:

- STRUCTURE REMOVAL
- PAVEMENT REMOVAL
- TEMPORARY CONCRETE BARRIER
- IMPACT ATTENUATOR
- INDUCTION LOOP DETECTOR
- DRUM WITH STEADY BURNING LIGHT
- SIGNALIZED TWO-WAY TRAFFIC LANE
- TEMPORARY BRIDGE TRAFFIC SIGNAL
- TYPE III BARRICADE

NOTE:
PROPOSED HMA SHOULDER, 8" RUNS FROM STA 1112+25.0 TO STA 1115+00.0 RT
PROPOSED HMA SHOULDER, 2" RUNS FROM STA 1115+00.0 TO STA 1124+75.0 RT

NOTES:

1. THE CONTRACTOR SHALL MAINTAIN ACCESS TO PRIVATE AND FIELD ENTRANCES LOCATED WITHIN THE LIMITS OF THE PROJECT.
2. TRAFFIC CONTROL & PROTECTION, STANDARD 701321 (SPECIAL) INCLUDES BOTH STAGE I & II AND ANY ADDITIONAL SIGNING OR TRAFFIC CONTROL DEVICES SHOWN ON THE STAGE CONSTRUCTION PLANS.
3. ALL ADDITIONAL TRAFFIC SIGNAL HEADS, LOOP DETECTORS AND ASSOCIATED EQUIPMENT REQUIRED TO MAINTAIN ACCESS AT THE FIELD AND DRIVEWAY ENTRANCES SHALL BE INCLUDED IN THE COST OF "TEMPORARY BRIDGE TRAFFIC SIGNALS"
4. THE COST OF "BARRICADES, TYPE III" SHALL BE INCLUDED IN THE COST OF "TRAFFIC CONTROL AND PROTECTION, STANDARD 701321 (SPECIAL)".
5. ALL SIDEROADS AND ENTRANCES WITHIN TRAFFIC CONTROL SHALL HAVE "NO RIGHT TURN ON RED" AND "STOP HERE ON RED" SIGNS. THE COST SHALL BE INCLUDED IN THE COST OF "TRAFFIC CONTROL AND PROTECTION, STANDARD 701321 (SPECIAL)".
7. THE LENGTH OF THE TEMPORARY CONCRETE BARRIER FOR STAGE II CONSTRUCTION IS 1,012.5 FT.

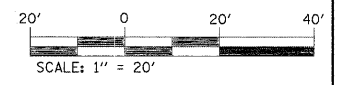

FILE NAME =	USER NAME = gelinh	DESIGNED - ---	REVISED - ---	STATE OF ILLINOIS DEPARTMENT OF TRANSPORTATION	SUGGESTED STAGE II CONSTRUCTION AND TRAFFIC CONTROL	F.A.P. RTE.	SECTION	COUNTY	TOTAL SHEETS	SHEET NO.	
or:\pw_work\pwidot\gelinh\dms51845\Stage	and Pwmt Mkg.dgn	DRAWN - ---	REVISED - ---			805	126-BR-1	CLINTON	85	16	
PLOT SCALE = 20.0000' / IN.	CHECKED - ---	REVISED - ---	SCALE: 1" = 20"			SHEET NO. ___ OF ___ SHEETS	STA. 1110+00.00 TO STA. 1116+00.00	CONTRACT NO. 76976			
PLOT DATE = 12/9/2008	DATE - ---	REVISED - ---	FED. ROAD DIST. NO. _ ILLINOIS FED. AID PROJECT								