

F.A.P. RTE.	SECTION	COUNTY	TOTAL SHEETS	SHEET NO.
761	104-BR-2	GREENE	82	1
FED. ROAD DIST. NO.	ILLINOIS	CONTRACT NO. 76987		

STATE OF ILLINOIS  
DEPARTMENT OF TRANSPORTATION  
DIVISION OF HIGHWAYS

**PROPOSED  
HIGHWAY PLANS**

FAP ROUTE 761 (IL ROUTE 108)  
SECTION 104-BR-2  
PROJECT: *BRF-0761(010)*  
GREENE COUNTY  
STRUCTURE REPLACEMENT  
C-98-092-08

FOR INDEX OF SHEETS, SEE SHEET NO. 2

D-98-015-06

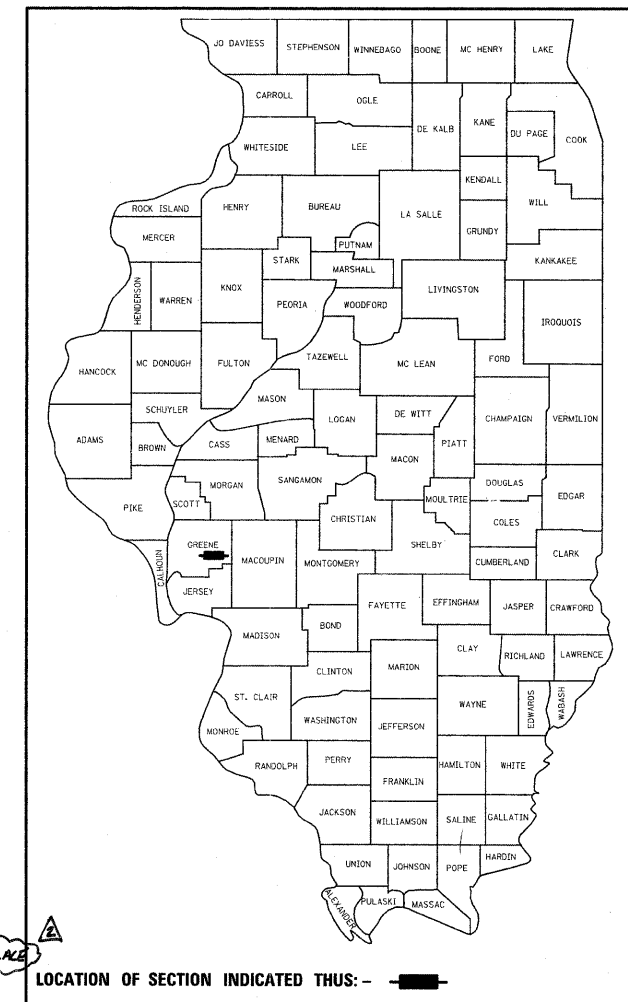

**FAP 761 (IL 108)**  
ADT = 1100 (2005)  
ADT = 1125 (2007)  
ADT = 1350 (2027)  
SU = 4.5%  
MU = 4.5%

**DESIGN DESIGNATION**  
NA

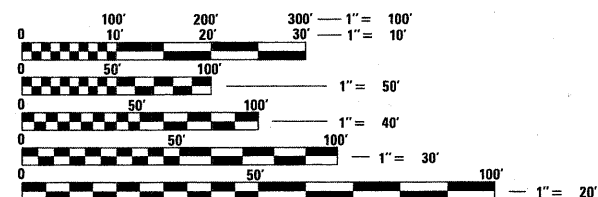

FULL SIZE PLANS HAVE BEEN PREPARED USING STANDARD ENGINEERING SCALES. REDUCED SIZED PLANS WILL NOT CONFORM TO STANDARD SCALES. IN MAKING MEASUREMENTS ON REDUCED PLANS, THE ABOVE SCALES MAY BE USED.

J.U.L.I.E.  
JOINT UTILITY LOCATION INFORMATION FOR EXCAVATION  
1-800-892-0123  
OR 811

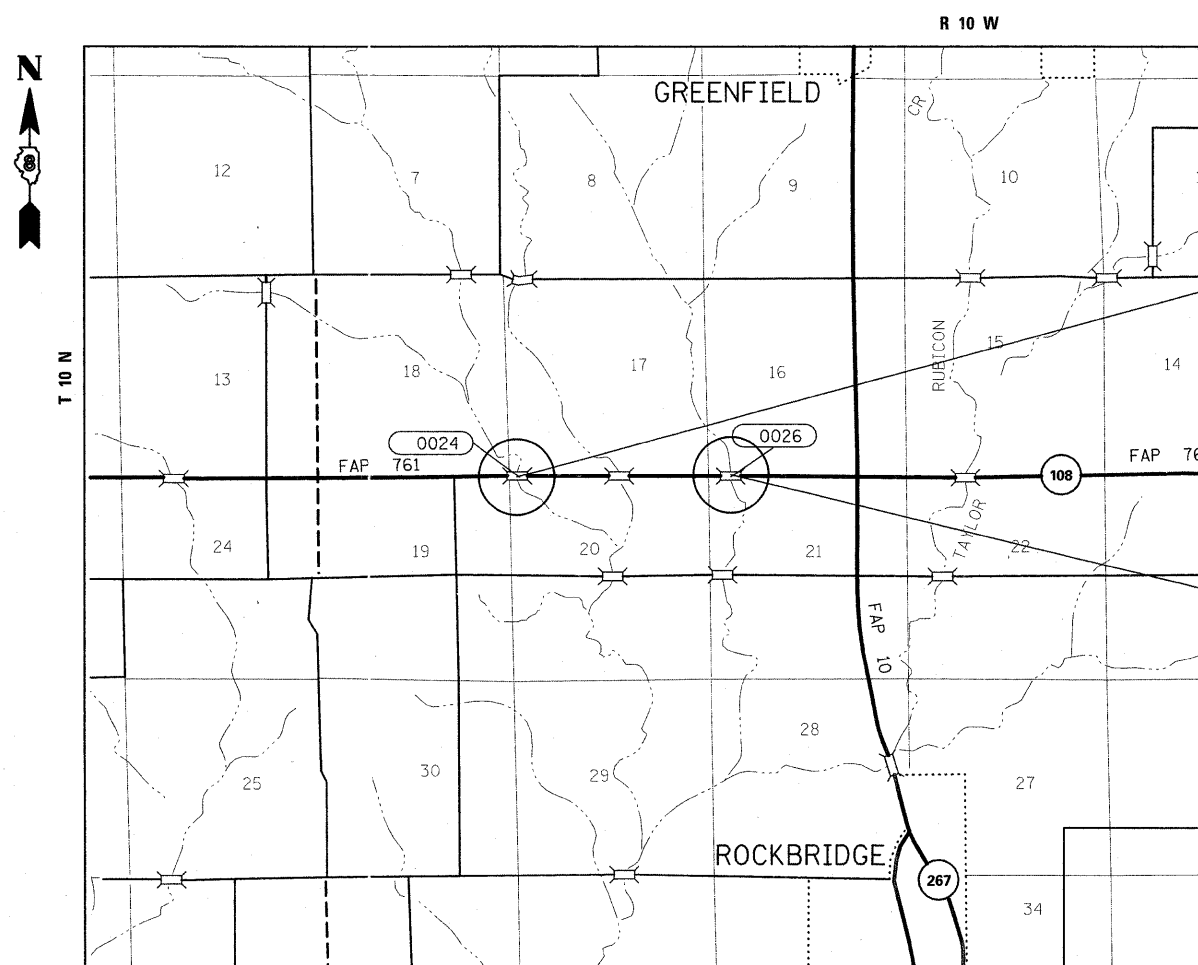

SINGLE SPAN PPC DECK BEAM  
TO BE REPLACED WITH *CAST-IN-PLACE*  
TRIPLE BOX CULVERT  
OVER TAYLOR CREEK  
STA 1068+35  
SN 031-0024 (E)  
SN 031-2012 (P)

LOCATION OF SECTION INDICATED THUS: - -

SINGLE SPAN PPC DECK BEAM  
TO BE REPLACED WITH SINGLE  
SPAN WIDE FLANGE STRUCTURE  
OVER TAYLOR CREEK  
STA 1123+55  
SN 031-0026 (E)  
SN 031-0042 (P)

SN 031-2012  
GROSS LENGTH 0.0104 MI  
NET LENGTH 0.0104 MI

SN 031-0042  
GROSS LENGTH 0.0165 MI  
NET LENGTH 0.0165 MI

TOTAL  
GROSS LENGTH 0.0269 MI  
NET LENGTH 0.0269 MI

STATE OF ILLINOIS  
DEPARTMENT OF TRANSPORTATION  
DIVISION OF HIGHWAYS

SUBMITTED *December 11, 2008*

*Alan C. Jones*  
DEPUTY DIRECTOR OF HIGHWAYS, REGION 5 ENGINEER

*January 30, 2009*  
*Charles A. Ingersoll*  
ENGINEER OF DESIGN AND ENVIRONMENT

*January 30, 2009*  
*Christine M. Reed*  
DIRECTOR OF HIGHWAYS, CHIEF ENGINEER

PROJECT ENGINEER: PATTI LeBEAU (618 346-3179)  
PROJECT MANAGER: ARTHUR MUEHLFELD (618) 346-3209

CONTRACT NO. 76987

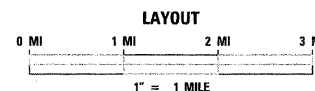

SN 031-0024	SN 031-0026
LATITUDE: 39° 18' 20.06"	LATITUDE: 39° 18' 19.97"
LONGITUDE: 90° 14' 27.24"	LONGITUDE: 90° 13' 16.39"

**PRINTED BY THE AUTHORITY  
OF THE STATE OF ILLINOIS**

INDEX OF SHEETS

- 1 COVER SHEET
- 2 INDEX OF SHEETS, HIGHWAY STANDARDS, GENERAL NOTES AND COMMITMENTS
- 3-4 SUMMARY OF QUANTITIES
- 5-6 TYPICAL SECTIONS
- 7-8 SCHEDULES OF QUANTITY
- 9 TIE POINTS & BENCH MARKS
- 10-11 STORM WATER POLLUTION PREVENTION PLAN
- 12-15 PLAT OF HIGHWAYS
- 16 WIDE LOAD SIGN PLAN
  
- SN 031-0024(E) 2012(P)
- 17-18 PLAN AND PROFILE SHEETS
- 19 STAGE CONSTRUCTION SHEET
- 20-21 EROSION CONTROL SHEETS
- 22-23 PAVEMENT MARKING SHEETS
- 24-37 CULVERT SHEETS (031-2012)
- 38-42 MAINLINE CROSS SECTIONS
  
- SN 031-0026(E) 0042(P)
- 43-44 PLAN AND PROFILE SHEETS
- 45 STAGE CONSTRUCTION SHEET
- 46-47 EROSION CONTROL SHEETS
- 48-49 PAVEMENT MARKING SHEETS
- 50-72 BRIDGE PLANS (031-0042)
- 73-77 DETAIL SHEETS
- 78-82 MAINLINE CROSS SECTIONS

**HIGHWAY STANDARDS**

000001-05	001001-02	701321-10
280001-04	001006	701326-03
515001-03	630301-05	701901-01
	631031-07	704001-05
606201-02	635006-03	780001-02
630001-08	635011-02	781001-03
630101-08	666001-01	
482011-03	701301-03	
515001-03		

GENERAL NOTES:

1. THE STANDARDS AND REVISION NUMBERS SHALL APPLY TO THIS PROJECT.
  2. THE CONTRACTOR SHALL VERIFY ALL DIMENSIONS AND CONDITIONS IN THE FIELD PRIOR TO CONSTRUCTION AND ORDERING OF MATERIALS.
  3. ILLINOIS STATE LAW REQUIRES A 48-HOUR NOTICE BE GIVEN TO ALL UTILITIES WITHIN THE PROJECT AREA BEFORE DIGGING. FIELD MARKING OF FACILITIES MAY BE OBTAINED BY CONTACTING J.U.L.I.E. OR FOR NON-MEMBERS, THE UTILITY COMPANY DIRECTLY. AGENCIES KNOWN TO HAVE FACILITIES WITHIN THE PROJECT AREA ARE AS FOLLOWS:
    - AMERENCIPS (ELECTRIC)
    - FRONTIER COMMUNICATIONS COMPANY (COMMUNICATIONS)
    - GREENE COUNTY RURAL WATER DISTRICT (WATER)
    - CITY OF GREENFIELD (WATER & SANITARY SEWER)
    - VERIZON NORTH, INC. (COMMUNICATIONS)
- MEMBERS OF J.U.L.I.E. (800) 892-0123 ARE INDICATED BY \*.  
NON-MEMBERS MUST BE NOTIFIED INDIVIDUALLY.
4. THE THICKNESS OF THE HOT-MIX ASPHALT MIXTURE SHOWN ON THE PLANS IS THE NOMINAL THICKNESS. DEVIATIONS FROM THE MINIMAL THICKNESS WILL BE PERMITTED WHEN SUCH DEVIATIONS OCCUR DUE TO IRREGULARITIES IN THE EXISTING SURFACE OR BASE ON WHICH THE HMA MIXTURE IS PLACED.
  5. SHORT-TERM PAVEMENT MARKING SHALL BE APPLIED TO THE MILLED SURFACE AND FINAL SURFACE.
  6. NO OPEN TRENCHES SHALL BE PERMITTED DURING WINTER SHUTDOWN OR AS DIRECTED BY THE ENGINEER.
  7. THE CONTRACTOR SHALL SAWCUT ALONG THE EDGE OF THE ROADWAY PRIOR TO PLACING THE 3' WIDENING FOR STAGE CONSTRUCTION AS DETAILED IN THE PLANS. THE COST SHALL BE INCLUDED IN THE COST OF THE REMOVAL ITEM.
  8. RIGHT OF WAY MARKERS SHALL BE SET SO THE BACK OF THE POST IS TWELVE INCHES (12") INSIDE THE RIGHT OF WAY BOUNDARY. RIGHT OF WAY PROPERTY CORNERS ARE MARKED BY A 5/8" IRON ROD WITH ALUMINUM CAP AND SHALL NOT BE REMOVED OR DAMAGED WHEN SETTING THE RIGHT OF WAY MARKERS.
  9. BRIDGE APPROACH PAVEMENT INCLUDED IN PAVEMENT REMOVAL.

TRAFFIC CONTROL NOTES:

1. THE CONTRACTOR SHALL FURNISH AND INSTALL WOOD SIGN SUPPORTS IN ACCORDANCE WITH SECTION 730 OF THE STANDARD SPECIFICATIONS.
2. "ROAD CONSTRUCTION AHEAD" SIGNS SHALL BE PLACED AT THE BEGINNING AND ENDING OF THE PROJECT, AND WILL BE INCLUDED IN THE TRAFFIC CONTROL PAY ITEMS. ALL CONSTRUCTION SIGNS SHALL BE FLOURESCENT ORANGE. (48").
3. ALL EXCAVATION ADJACENT TO THE EDGE OF PAVEMENT SHALL BE PROTECTED WITH EXTENDED LEG BARRICADES AND APPROPRIATE LIGHTS.
4. THE BOTTOM 6" OF TEMPORARY CONCRETE BARRIER SHALL BE PAINTED WHITE. A QUANTITY OF 912.5 FT SHALL BE PAID FOR AS "TEMPORARY PAVEMENT MARKING - LINE 6" "

COMMITMENTS

NONE

MIXTURE USE	SURFACE	BINDER / WIDENING	SHOULDERS	TOP LIFT SHOULDERS
AC/PG	PG 64-22	PG 64-22	PG 64-22	PG 64-22
RAP % (MAX)	10%	15%	30%	30%
DESIGN AIR VOIDS	4.0% @ Ndes=70	4.0% @ Ndes=70	2.0% @ Ndes=30	**2.0% @ Ndes=30
MIX COMPOSITION (GRADATION MIXTURE)				
FRICITION AGG	MIXTURE "C"	MIXTURE "B"	BAM	BAM

\*\* TOP LIFT SHOULDERS - DESIGN THIS MIX AT 2.0% VOIDS AND ADD ASPHALT TO REDUCE VOIDS TO 1.5%.

PLAN QUANTITIES FOR BITUMINOUS CONCRETE SURFACE COURSE ITEMS ARE CALCULATED USING A UNIT WEIGHT OF 112 LB/SQ YD IN (59.8 KG/SQ M/25 MM THICKNESS).

FILE NAME =	USER NAME = harbaughrd	DESIGNED -	REVISED -	<b>STATE OF ILLINOIS DEPARTMENT OF TRANSPORTATION</b>	<b>INDEX OF SHEETS, HIGHWAY STANDARDS, GENERAL NOTES &amp; COMMITMENTS</b>	F.A.P RTE.	SECTION	COUNTY	TOTAL SHEETS	SHEET NO.	
ca:\pwork\PWIDOT\HARBAUGH\RD\dms51889\	in01506s.dgn	DRAWN -	REVISED -			761	104-BR-2	GREENE	82	2	
	PLOT SCALE = 50.0000' / IN.	CHECKED -	REVISED -			CONTRACT NO. 76987					
	PLOT DATE = 12/11/2008	DATE -	REVISED -			FED. ROAD DIST. NO. ILLINOIS FED. AID PROJECT					

Rev. 2-18-09

# SUMMARY OF QUANTITIES

SUMMARY OF QUANTITIES			CONSTRUCTION TYPE CODE			SUMMARY OF QUANTITIES			CONSTRUCTION TYPE CODE		
CODE NO	ITEM	UNIT	80% FED. 20% STATE TOTAL QUANTITIES	X028-2A	X071-2A	CODE NO	ITEM	UNIT	80% FED. 20% STATE TOTAL QUANTITIES	X028-2A	X071-2A
20100500	TREE REMOVAL, ACRES	ACRE	0.25	0.19	0.06	50800515	BAR SPLICERS	EACH	623	268	355
20200100	EARTH EXCAVATION	CU YD	90	58.7	31.3	51201710	FURNISHING STEEL PILES HP12X84	FOOT	780		780
20201200	REMOVAL AND DISPOSAL OF UNSUITABLE MATERIAL	CU YD	692	692		51202305	DRIVING PILES	FOOT	780		780
20400800	FURNISHED EXCAVATION	CU YD	3430	1495	1935	51203710	TEST PILE STEEL HP12X84	EACH	2		2
20700220	POROUS GRANULAR EMBANKMENT	CU YD	692	692		51500100	NAME PLATES	EACH	2	1	1
20700400	POROUS GRANULAR EMBANKMENT, SPECIAL	CU YD	161.2		161.2	52100520	ANCHOR BOLTS, 1"	EACH	24		24
25000200	SEEDING, CLASS 2	ACRE	1.25	0.75	0.5	54003000	CONCRETE BOX CULVERTS	CU YD	308	308	
25000400	NITROGEN FERTILIZER NUTRIENT	POUND	126	72	54	59100100	GEOCOMPOSITE WALL DRAIN	SQ YD	81		81
25000500	PHOSPHORUS FERTILIZER NUTRIENT	POUND	126	72	54	60109580	PIPE UNDERDRAINS FOR STRUCTURES 4"	FOOT	168		168
25000600	POTASSIUM FERTILIZER NUTRIENT	POUND	126	72	54	60600095	CLASS SI CONCRETE (OUTLET)	CU YD	11		11
28000250	TEMPORARY EROSION CONTROL SEEDING	POUND	250	140	110	*63000000	STEEL PLATE BEAM GUARD RAIL, TYPE A	FOOT	1075	625	450
28000400	PERIMETER EROSION BARRIER	FOOT	3178	1573	1605	*63000025	STEEL PLATE BEAM GUARD RAIL, ATTACHED TO STRUCTURES	FOOT	87.5	87.5	
28100105	STONE RIPRAP, CLASS A3	SQ YD	120		120	*63100085	TRAFFIC BARRIER TERMINAL, TYPE 6	EACH	4		4
28100109	STONE RIPRAP, CLASS A5	SQ YD	1417	556	861	*63100169	TRAFFIC BARRIER TERMINAL, TYPE 1 (SPECIAL) FLARED	EACH	1		1
28200200	FILTER FABRIC	SQ YD	1417	556	861	63200310	GUARDRAIL REMOVAL	FOOT	482	230	252
35600712	HOT-MIX ASPHALT BASE COURSE WIDENING, 9"	SQ YD	776	333	413	66600105	FURNISHING AND ERECTING RIGHT-OF-WAY MARKERS	EACH	22	11	11
40600200	BITUMINOUS MATERIALS (PRIME COAT)	TON	0.6	0.1	0.5	66700095	PERMANENT SURVEY MARKERS	EACH	6	3	3
40600300	AGGREGATE (PRIME COAT)	TON	3	0.5	2.5	66700705	FURNISHING AND ERECTING DRAINAGE MARKERS	EACH	2	2	
40600982	HOT-MIX ASPHALT SURFACE REMOVAL - BUTT JOINT	SQ YD	581		581	67000400	ENGINEER'S FIELD OFFICE, TYPE A	CAL MO	7	3	4
40603085	HOT-MIX ASPHALT BINDER COURSE, IL-19.0, N70	TON	835	202	633	67100100	MOBILIZATION	L SUM	1	0.5	0.5
40603315	HOT-MIX ASPHALT SURFACE COURSE, MIX "C", N70	TON	163.1	23.3	139.8	70100405	TRAFFIC CONTROL AND PROTECTION, STANDARD 701321	EACH	2	1	1
42001165	BRIDGE APPROACH PAVEMENT	SQ YD	223		223	70100500	TRAFFIC CONTROL AND PROTECTION, STANDARD 701326	L SUM	1	0.5	0.5
42001430	BRIDGE APPROACH PAVEMENT CONNECTOR (FLEXIBLE)	SQ YD	45		45	70106500	TEMPORARY BRIDGE TRAFFIC SIGNALS	EACH	2	1	1
44000100	PAVEMENT REMOVAL	SQ YD	263	130	133	70106700	TEMPORARY RUMBLE STRIP	EACH	12	6	6
44000400	GUTTER REMOVAL	FOOT	245		245	70300100	SHORT-TERM PAVEMENT MARKING	FOOT	276	128	148
48203033	HOT-MIX ASPHALT SHOULDERS, 9"	SQ YD	384		384	70300240	TEMPORARY PAVEMENT MARKING - LINE 6"	FOOT	912.5	375	537.5
50100100	REMOVAL OF EXISTING STRUCTURES	EACH	2	1	1	70301000	WORK ZONE PAVEMENT MARKING REMOVAL	SQ FT	92	42.7	49.3
50200100	STRUCTURE EXCAVATION	CU YD	72.7		72.7	70400100	TEMPORARY CONCRETE BARRIER	FOOT	912.5	375	537.5
50300225	CONCRETE STRUCTURES	CU YD	44		44	70400200	RELOCATE TEMPORARY CONCRETE BARRIER	FOOT	862.5	350	512.5
50300255	CONCRETE SUPERSTRUCTURE	CU YD	125.7		125.7	*78000200	THERMOPLASTIC PAVEMENT MARKING - LINE 4"	FOOT	3929	1597.5	2331.5
50300260	BRIDGE DECK GROOVING	SQ YD	382		382	*78008210	POLYUREA PAVEMENT MARKING TYPE I - LINE 4"	FOOT	491		491
50300280	CONCRETE ENCASEMENT	CU YD	4.2		4.2	*78100100	RAISED REFLECTIVE PAVEMENT MARKER	EACH	10	1	9
50300300	PROTECTIVE COAT	SQ YD	290		290	*78100105	RAISED REFLECTIVE PAVEMENT MARKER (BRIDGE)	EACH	2		2
50500105	FURNISHING AND ERECTING STRUCTURAL STEEL	L SUM	1		1	*78100300	REPLACEMENT REFLECTOR	EACH	6	6	
50500505	STUD SHEAR CONNECTORS	EACH	1044		1044	*78200410	GUARDRAIL MARKERS, TYPE A	EACH	21	10	11
50800205	REINFORCEMENT BARS, EPOXY COATED	POUND	87250	56190	31060	*78200520	BARRIER WALL MARKERS, TYPE B	EACH	2		2

FILE NAME =	USER NAME = harbaughrd	DESIGNED -	REVISED -	<b>STATE OF ILLINOIS DEPARTMENT OF TRANSPORTATION</b>	<b>SUMMARY OF QUANTITIES</b>	F.A.P. RTE.	SECTION	COUNTY	TOTAL SHEETS	SHEET NO.	
est:\pw\work\pwidot\harbaughrd\dms51889\p01526a.dgn		DRAWN -	REVISED -			761	104-BR-2	GREENE	82	3	
PLOT SCALE = 50.0000' / IN.		CHECKED -	REVISED -			CONTRACT NO. 76987					
PLOT DATE = 12/19/2008		DATE -	REVISED -			FED. ROAD DIST. NO. ILLINOIS FED. AID PROJECT					

Rev. 2-18-09 \*SPECIALTY ITEMS

SHOULDER & PAVEMENT SCHEDULE

LOCATION	PAVEMENT REMOVAL	HOT-MIX ASPHALT SURFACE REMOVAL - BUTT JOINT	GUTTER REMOVAL	HOT-MIX ASPHALT BASE COURSE WIDENING, 9"	BITUMINOUS MATERIALS (PRIME COAT)	AGGREGATE (PRIME COAT)	HOT-MIX ASPHALT BINDER COURSE	HOT-MIX ASPHALT SURFACE COURSE	HOT-MIX ASPHALT SHOULDERS, 9"	CLASS SI CONCRETE (OUTLET)
STATION TO STATION	SQ YD	SQ YD	FOOT	SQ YD	TON	TON	TON	TON	SQ YD	CU YD
SN 031-2012										
STA 1065+00 TO STA 1066+00				61.6						
STA 1066+00 TO STA 1067+00				66.7						
STA 1067+00 TO STA 1068+00	37.6			60.7	0.02	0.08	27.3	3.2		
STA 1068+00 TO STA 1069+00	92.4			13.9	0.08	0.42	174.7	20.1		
STA 1069+00 TO STA 1070+00				66.7						
STA 1070+00 TO STA 1071+00				66.7						
STA 1071+00 TO STA 1072+00				26.7						
SN 031-0042										
STA 1120+00 TO STA 1121+00		288.8		66.8	0.08	0.43		24.3	66.7	
STA 1121+00 TO STA 1122+00		114.1		66.8	0.09	0.43	73.5	24.3	66.7	
STA 1122+00 TO STA 1123+00				81.2	0.07	0.35	96.7	19.1	52.6	
STA 1123+00 TO STA 1124+00	127.2			19.5						
STA 1124+00 TO STA 1125+00	5.8			71.3	0.06	0.28	120.2	14.9	41.3	
STA 1125+00 TO STA 1126+00				74.1	0.09	0.43	193.8	24.3	66.7	
STA 1126+00 TO STA 1127+00		77.0	175	33.3	0.08	0.43	148.8	24.3	66.7	8.2
STA 1127+00 TO STA 1128+00		101.1	70		0.03	0.15		8.5	23.3	2.8
<b>TOTAL</b>	<b>263</b>	<b>581</b>	<b>245</b>	<b>776</b>	<b>0.6</b>	<b>3</b>	<b>835</b>	<b>163</b>	<b>384</b>	<b>11</b>

EARTHWORK SCHEDULE

LOCATION	EARTH EXCAVATION	EARTH EXCAVATION ADJUSTED FOR 25% SHRINKAGE	EMBANKMENT	EARTHWORK BALANCE WASTE (+) OR SHORTAGE (-)
	CU YD		CU YD	CU YD
SN 031-2012				
STA 1064+00 TO STA 1065+00	0.3	0.2	5.1	-4.9
STA 1065+00 TO STA 1066+00	6.5	4.9	224.4	-219.5
STA 1066+00 TO STA 1067+00	7.4	5.6	387.3	-381.7
STA 1067+00 TO STA 1068+00	3.4	2.7	358.2	-355.5
STA 1068+00 TO STA 1069+00	1.1	0.9	117.3	-116.4
STA 1069+00 TO STA 1070+00	5.4	4.0	248.3	-244.3
STA 1070+00 TO STA 1071+00	6.1	4.6	185.8	-181.2
STA 1071+00 TO STA 1072+00	18.7	14.1	12.7	+1.4
STA 1072+00 TO STA 1073+00	9.8	7.4	0.3	+7.1
SN 031-0042				
STA 1119+00 TO STA 1120+00	2.2	1.7	3.1	-1.4
STA 1120+00 TO STA 1121+00	8.1	6.1	81.9	-75.8
STA 1121+00 TO STA 1122+00	3.3	2.5	222.1	-219.6
STA 1122+00 TO STA 1123+00	0.1	0.1	426.7	-426.6
STA 1123+00 TO STA 1124+00	0.0	0.0	96.9	-96.9
STA 1124+00 TO STA 1125+00	0.0	0.0	757.2	-757.2
STA 1125+00 TO STA 1126+00	0.2	0.2	355.2	-355.0
STA 1126+00 TO STA 1127+00	17.4	13.1	15.6	-2.5
<b>TOTAL</b>	<b>90</b>	<b>68.1</b>	<b>3498.1</b>	<b>-3430.0</b>

PAVEMENT MARKING SCHEDULE

LOCATION	PAVEMENT MARKING REMOVAL			SHORT-TERM PAVEMENT MARKING	WORK ZONE PAVEMENT MARKING	THERMOPLASTIC PAVEMENT MARKING -4"			POLYUREA PAVEMENT MARKING TYPE I-LINE 4"			RAISED REFLECTIVE PAVEMENT MARKER REMOVAL	RAISED REFLECTIVE PAVEMENT MARKER	RAISED REFLECTIVE PAVEMENT MARKER (BRIDGE)	REPLACEMENT REFLECTOR
	YELLOW		WHITE			YELLOW		WHITE							
	SKIP-DASH	SOLID	SOLID			SKIP-DASH	SOLID	SOLID	SOLID						
STATION TO STATION	SQ FT	SQ FT	SQ FT	FOOT	SQ FT	FOOT	FOOT	FOOT	FOOT	FOOT	FOOT	EACH	EACH	EACH	EACH
SN 031-2012															
STA 1064+00 TO STA 1065+00	1.9		15.3	12	4.0	5.8		46				1			1
STA 1065+00 TO STA 1066+00	8.3		66.7	16	5.3	25		200				1			1
STA 1066+00 TO STA 1067+00	8.3		66.7	16	5.3	25		200				1			1
STA 1067+00 TO STA 1068+00	8.3		66.7	20	6.7	25		200					1		
STA 1068+00 TO STA 1069+00	8.3		66.7	16	5.3	25		200							
STA 1069+00 TO STA 1070+00	8.3		66.7	16	5.3	25		200				1			1
STA 1070+00 TO STA 1071+00	8.3		66.7	16	5.3	25		200				1			1
STA 1071+00 TO STA 1072+00	7.3		58.1	16	5.3	21.7		174				1			1
SN 031-0042															
STA 1119+00 TO STA 1120+00	5.2	20.8	41.7	12	4.0	15.6	62.5	125				1	1		
STA 1120+00 TO STA 1121+00	8.3	33.3	66.7	16	5.3	25	100	200				1	1		
STA 1121+00 TO STA 1122+00	8.3	33.3	66.7	16	5.3	25	100	200				1	1		
STA 1122+00 TO STA 1123+00	5.7	34.1	56.7	20	6.7	16.9	102	170		30.0	30.0			1	
STA 1123+00 TO STA 1124+00				16	5.3				24.5	102.5	200.0			1	
STA 1124+00 TO STA 1125+00	5.8	22.7	45.3	16	5.3	17	68	136	8.0	32.0	64.0		1		
STA 1125+00 TO STA 1126+00	8.3	33.3	66.7	20	6.7	25	100	200					1		
STA 1126+00 TO STA 1127+00	8.3	33.3	66.7	16	5.3	25	100	200				2	2		
STA 1127+00 TO STA 1128+00	8.2	32.7	65.3	16	5.3	24.5	98	196				1	1		
<b>SUBTOTAL</b>	<b>117.1</b>	<b>243.5</b>	<b>949.4</b>			<b>351.5</b>	<b>730.5</b>	<b>2847</b>	<b>32.5</b>	<b>164.5</b>	<b>294.0</b>				
<b>TOTAL</b>		<b>1310</b>		<b>276</b>	<b>92</b>	<b>3929</b>			<b>491</b>			<b>12</b>	<b>10</b>	<b>2</b>	<b>6</b>

REPLACEMENT REFLECTORS (REMOVED DURING STAGE CONSTRUCTION) ARE FROM STOP BAR TO STOP BAR.  
 RAISED REFLECTIVE PAVEMENT MARKER REMOVAL REQUIRES ONLY THE REFLECTORS TO BE REMOVED.

Rev. 2-18-09



DATE: \_\_\_\_\_ BY: \_\_\_\_\_  
 SURVEYED: \_\_\_\_\_  
 PLOTTED: \_\_\_\_\_  
 CHECKED: \_\_\_\_\_  
 FILE NAME: \_\_\_\_\_

DATE: \_\_\_\_\_ BY: \_\_\_\_\_  
 SURVEYED: \_\_\_\_\_  
 PLOTTED: \_\_\_\_\_  
 CHECKED: \_\_\_\_\_  
 FILE NAME: \_\_\_\_\_

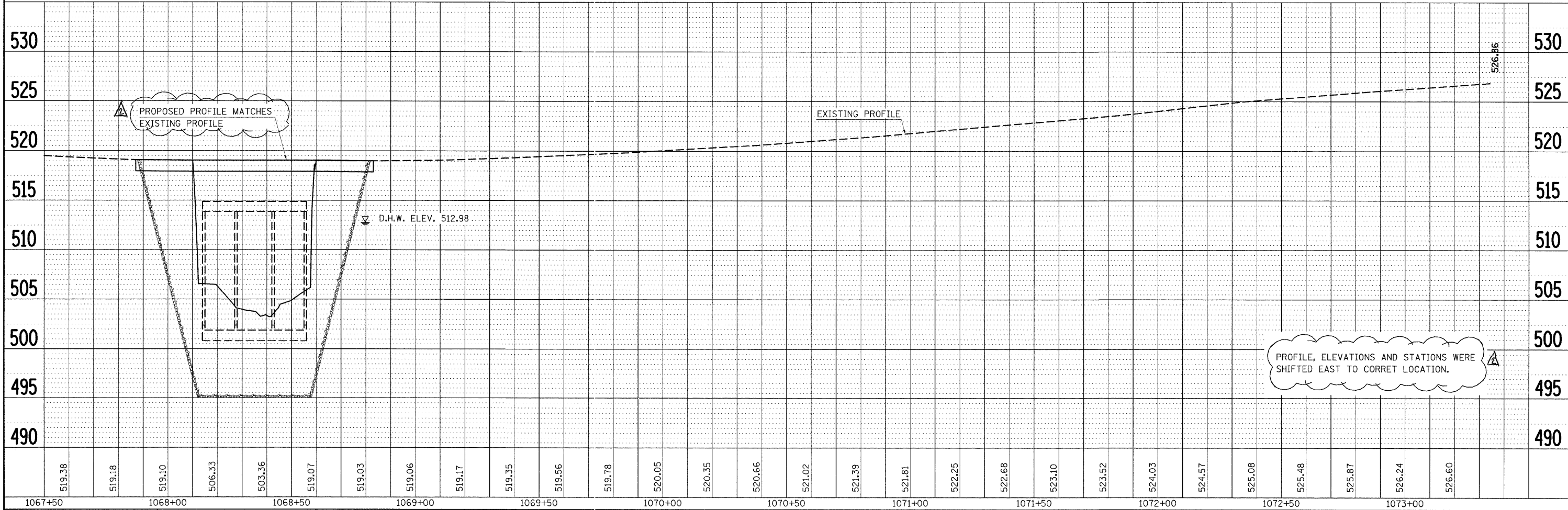
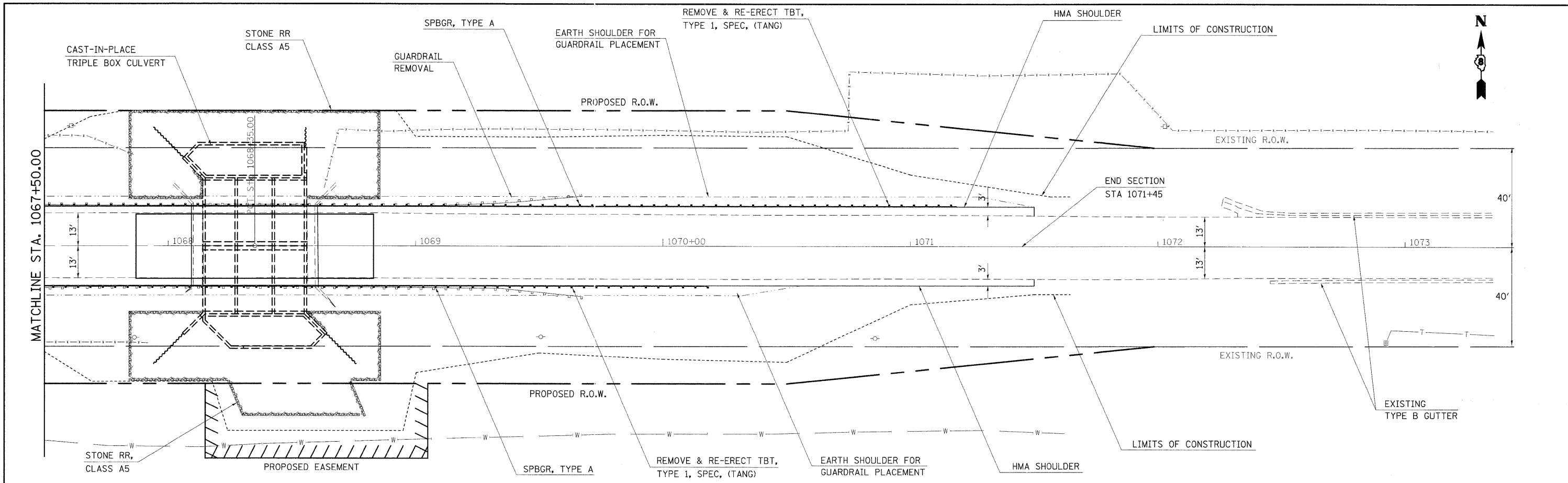

FILE NAME =	USER NAME = harbaughrd	DESIGNED -	REVISED -	<b>STATE OF ILLINOIS DEPARTMENT OF TRANSPORTATION</b>	<b>IL 108 PLANPROFILE (SN 031-2012)</b>			F.A.P. RTE.	SECTION	COUNTY	TOTAL SHEETS	SHEET NO.
et:\pw\work\p\dtd\harbaughrd\dms51889\p\p\01586_0024.dgn		DRAWN -	REVISED -		761	104-BR-2	GREENE	82	18			
PLOT SCALE = 20.0000' / IN.		CHECKED -	REVISED -		SCALE: 20			SHEET NO. 1 OF 2 SHEETS	STA. 1067+50 TO STA. 1073+40	CONTRACT NO. 76987		
PLOT DATE = 2/6/2009		DATE -	REVISED -		SCALE: 20			SHEET NO. 1 OF 2 SHEETS	STA. 1067+50 TO STA. 1073+40	CONTRACT NO. 76987		

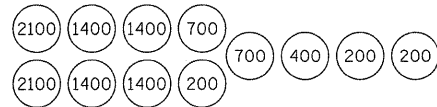

SAND MODULE IMPACT ATTENUATOR LAYOUT  
(IF OPTION USED)

SEQUENCE OF CONSTRUCTION - STAGE I

SEE STANDARD 701321 FOR LAYOUT OF TRAFFIC CONTROL. LAYOUT OF TEMPORARY CONCRETE BARRIER IS DEFINED ON THIS SHEET.  
 PLACE "HMA BASE COURSE WIDENING, 9 INCH" FOR 3 FT WIDENING AS SHOWN ON PLANS.  
 PLACE 350 FT TEMPORARY CONCRETE BARRIER AND 2 EACH IMPACT ATTENUATORS, TEMPORARY.  
 REMOVE SKIP-DASH AND SOLID EDGE PAVEMENT MARKING BETWEEN STOP BARS.

SEQUENCE OF CONSTRUCTION - STAGE II

SEE STANDARD 701321 FOR DETAILS NOT SHOWN ON PLANS.  
 PLACE "HMA BASE COURSE WIDENING, 9 INCH FOR 3 FT WIDENING AS SHOWN ON PLANS.  
 PLACE GUARDRAIL AND TRAFFIC BARRIER TERMINAL, TYPE 1 (SPECIAL) TANGENT ON BOTH ENDS OF STRUCTURE.  
 RELOCATE 375 FT OF TEMPORARY CONCRETE BARRIER AND RELOCATE 2 EACH IMPACT ATTENUATORS, TEMPORARY.

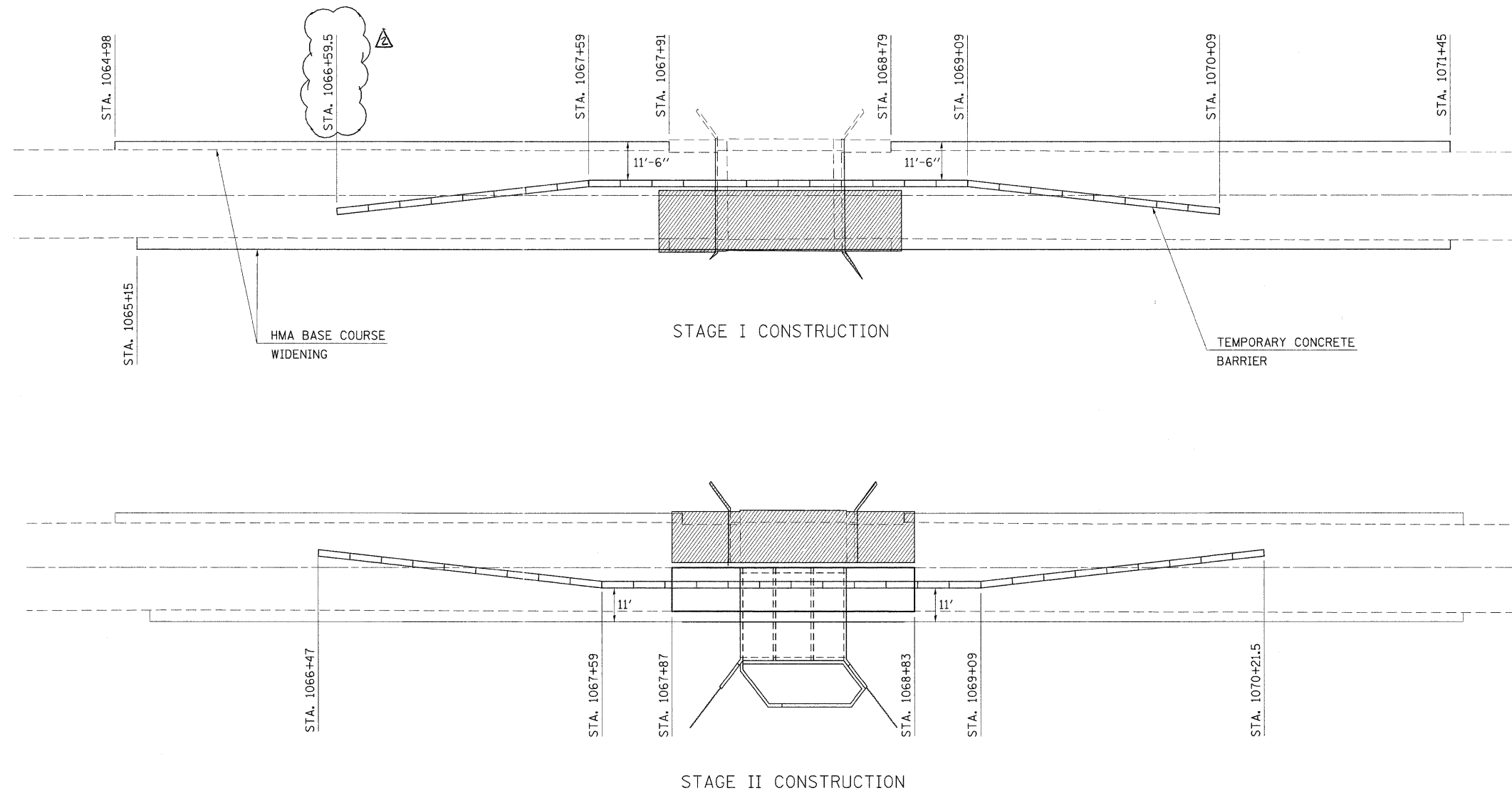

FILE NAME =	USER NAME = herbaughrd	DESIGNED -	REVISED -	<b>STATE OF ILLINOIS DEPARTMENT OF TRANSPORTATION</b>	<b>STAGE CONSTRUCTION DETAILS (SN 031-2012)</b>			F.A.P. RTE.	SECTION	COUNTY	TOTAL SHEETS	SHEET NO.
ct:\pw_work\p\dot\herbaughrd\dms51889\p\01506a.dgn		DRAWN -	REVISED -					761	104-BR-2	GREENE	82	19
PLOT SCALE = 50.0000' / IN.		CHECKED -	REVISED -					CONTRACT NO. 76987				
PLOT DATE = 2/6/2009		DATE -	REVISED -					SCALE: NTS    SHEET NO.    OF    SHEETS    STA.    TO STA.				
								FED. ROAD DIST. NO.    ILLINOIS    FED. AID PROJECT				

Rev. 2-18-09

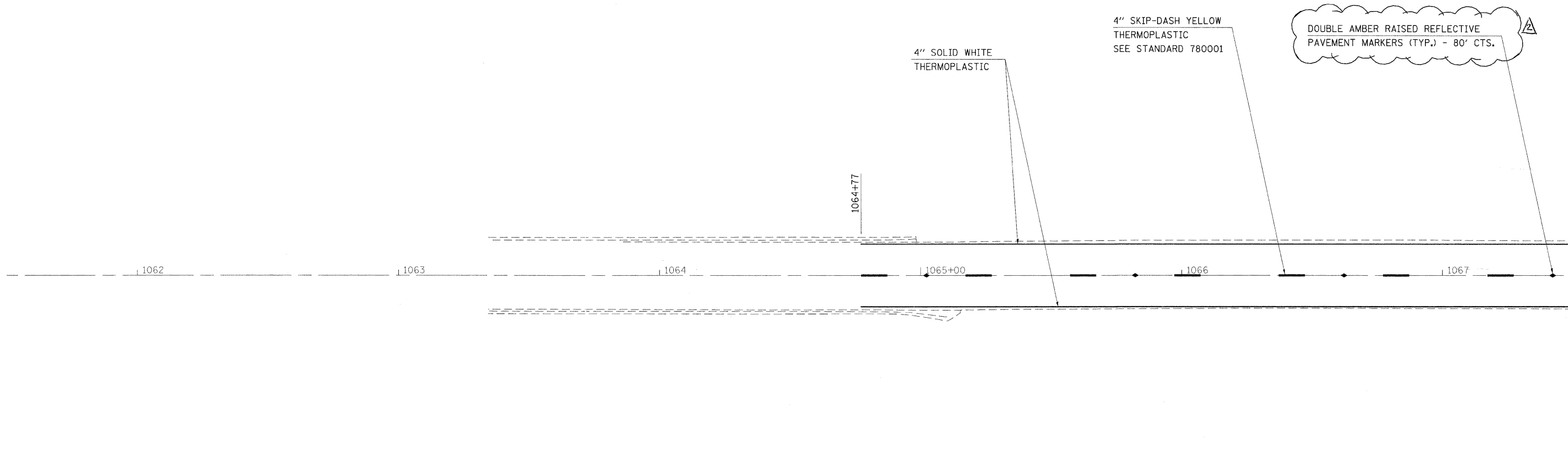

MACHLINE STA. 1067+50.00

FILE NAME = c:\pw\work\PW\DOT\HARBAUGH\RD\dms51889\	USER NAME = harbaughrd	DESIGNED -	REVISED -	<b>STATE OF ILLINOIS DEPARTMENT OF TRANSPORTATION</b>	<b>PAVEMENT MARKING (SN 031-2012)</b>			F.A.P. RTE.	SECTION	COUNTY	TOTAL SHEETS	SHEET NO.
	1061506_0024_13.dgn	DRAWN -	REVISED -					761	104-BR-2	GREENE	82	22
PLOT SCALE = 20.0000' / IN.	CHECKED -	REVISED -	REVISED -		SCALE: 20	SHEET NO. 1 OF 2 SHEETS	STA. 1061+50 TO STA. 1067+50	FED. ROAD DIST. NO. ILLINOIS FED. AID PROJECT				
PLOT DATE = 2/6/2009	DATE -	REVISED -	REVISED -				CONTRACT NO. 76987					





MACHINE STA. 1067+50.00

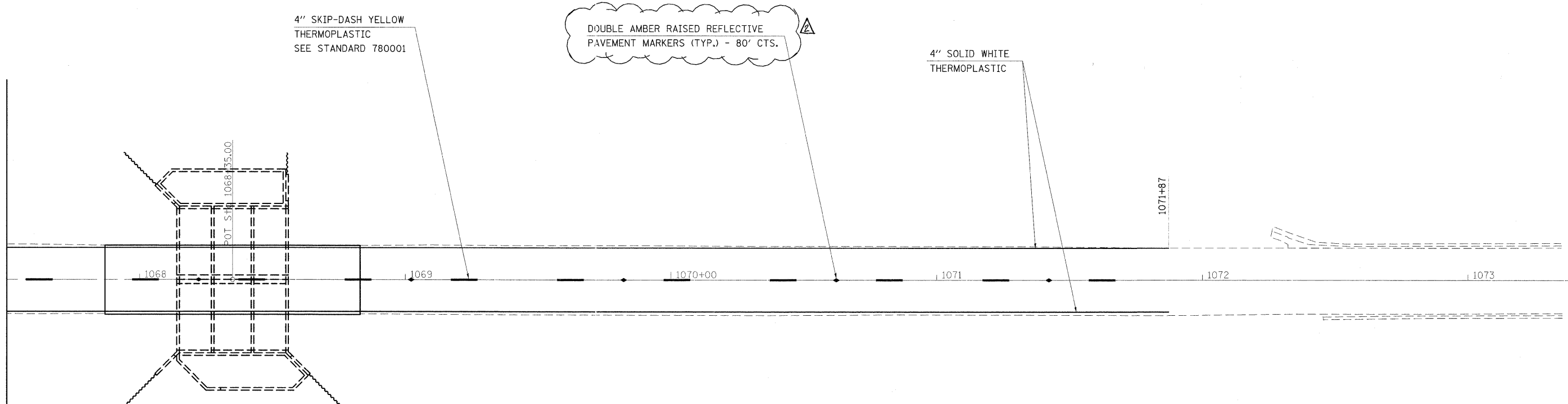

FILE NAME =	USER NAME = herbaughrd	DESIGNED -	REVISED -
c:\px_work\PWIDOT\HARBAUGHRO\dms51689\	tg01506_0024_13.dgn	DRAWN -	REVISED -
	PLOT SCALE = 20,0000' / IN.	CHECKED -	REVISED -
	PLOT DATE = 2/6/2009	DATE -	REVISED -

**STATE OF ILLINOIS  
DEPARTMENT OF TRANSPORTATION**

**PAVEMENT MARKING (SN 031-2012)**

SCALE: 20      SHEET NO. 2 OF 2 SHEETS      STA. 1067+50      TO STA. 1073+50

Rev. 2-18-09		F.A.P. RTE.	SECTION	COUNTY	TOTAL SHEETS	SHEET NO.
		761	104-BR-2	GREENE	82	23
				<b>CONTRACT NO. 76987</b>		
FED. ROAD DIST. NO.		ILLINOIS FED. AID PROJECT				

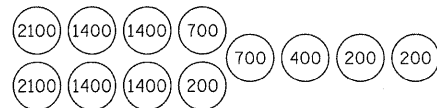

SAND MODULE IMPACT ATTENUATOR LAYOUT  
(IF OPTION USED)

SEQUENCE OF CONSTRUCTION - STAGE I

SEE STANDARD 701321 FOR LAYOUT OF TRAFFIC CONTROL. LAYOUT OF TEMPORARY CONCRETE BARRIER IS DEFINED ON THIS SHEET.

PLACE "HMA BASE COURSE WIDENING, 9 INCH" FOR 3 FT WIDENING AS SHOWN ON PLANS.

PLACE 512.5 FT TEMPORARY CONCRETE BARRIER AND 2 EACH IMPACT ATTENUATORS, TEMPORARY.

REMOVE SKIP-DASH AND SOLID EDGE PAVEMENT MARKING BETWEEN STOP BARS.

SEQUENCE OF CONSTRUCTION - STAGE II

SEE STANDARD 701321 FOR DETAILS NOT SHOWN ON PLANS.

PLACE A 46 FT HOT-MIX ASPHALT RAMP ON THE WEST END OF THE STRUCTURE AND A 77 FT HOT-MIX ASPHALT RAMP ON THE EAST END OF THE STRUCTURE.

PLACE "HMA BASE COURSE WIDENING, 9 INCH FOR 3 FT WIDENING AS SHOWN ON PLANS.

PLACE TRAFFIC BARRIER TERMINAL, TYPE 6 AND TEMPORARY GUARDRAIL ON BOTH ENDS OF STRUCTURE.

RELOCATE 512.5 FT OF TEMPORARY CONCRETE BARRIER AND RELOCATE 2 EACH IMPACT ATTENUATORS, TEMPORARY.

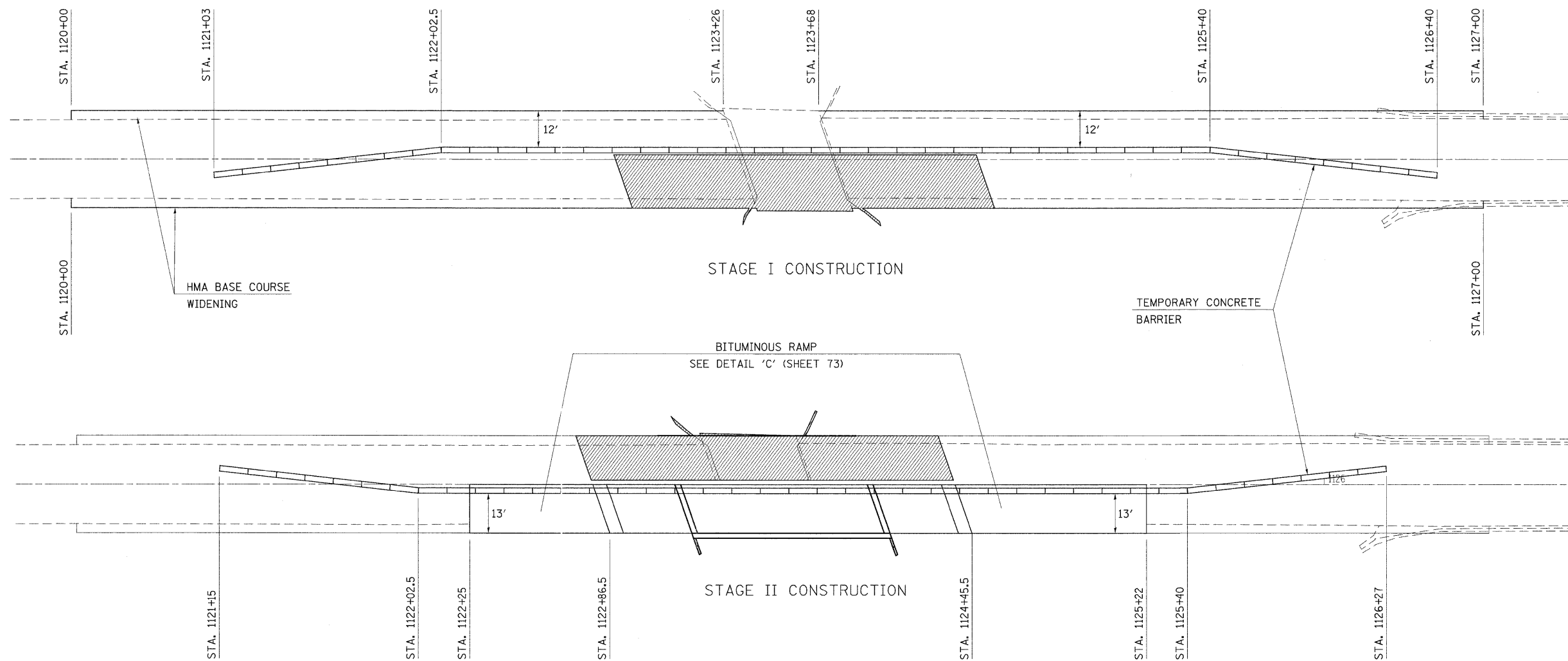

FILE NAME =  
c:\pw\work\p\dot\herbaugh\dms51889\p

USER NAME = herbaughrd  
01506a.dgn  
PLOT SCALE = 50,000 / IN.  
PLOT DATE = 2/6/2009

DESIGNED -  
DRAWN -  
CHECKED -  
DATE -

REVISED -  
REVISED -  
REVISED -  
REVISED -

STATE OF ILLINOIS  
DEPARTMENT OF TRANSPORTATION

STAGE CONSTRUCTION DETAILS (SN 031-0042)

SCALE: NTS SHEET NO. OF SHEETS STA. TO STA.

Rev. 2-18-09

F.A.P. RTE. 761	SECTION 104-BR-2	COUNTY GREENE	TOTAL SHEETS 82	SHEET NO. 45
CONTRACT NO. 76987				
FED. ROAD DIST. NO. ILLINOIS FED. AID PROJECT				

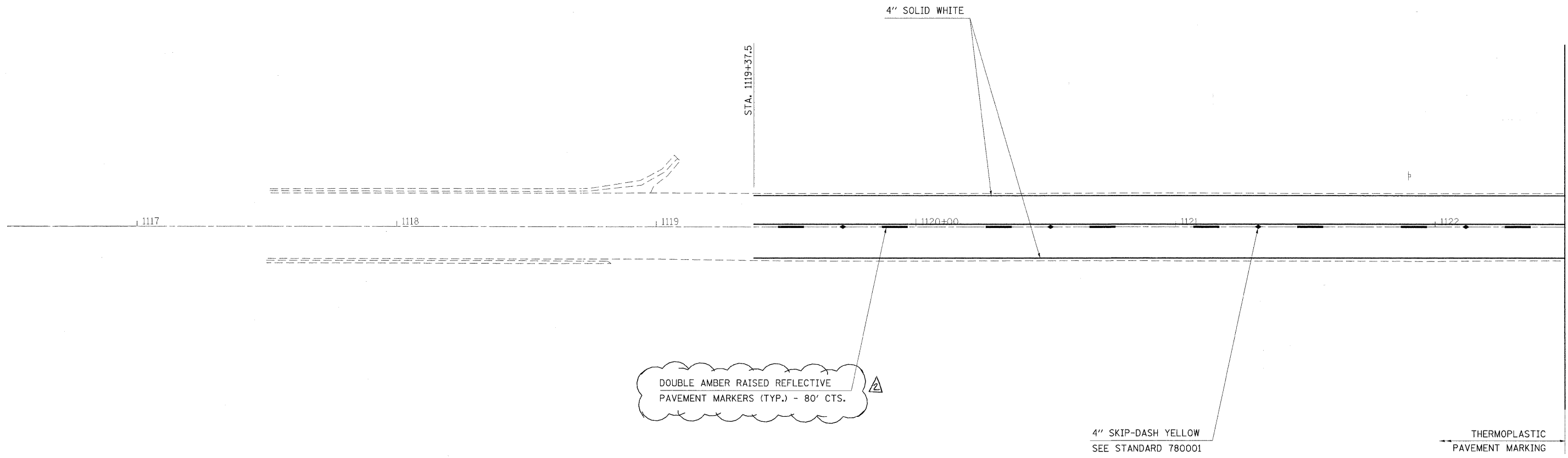

FILE NAME = e:\pwork\pwork\DOT\HARBAUGHRO\dms51889\	USER NAME = herbaughrd tg01506_0026_13.dgn	DESIGNED - DRAWN -	REVISED - REVISED -	<b>STATE OF ILLINOIS DEPARTMENT OF TRANSPORTATION</b>	<b>PAVEMENT MARKING (SN 031-0042)</b>	F.A.P. RTE.	SECTION	COUNTY	TOTAL SHEETS	SHEET NO.
PLOT SCALE = 20.0000' / IN.	CHECKED - DATE -	REVISED - REVISED -	761			104-BR-2	GREENE	82	48	
PLOT DATE = 2/6/2009			CONTRACT NO. 76987			FED. ROAD DIST. NO. ILLINOIS FED. AID PROJECT				

Rev. 2-18-09

SCALE: 20 SHEET NO. 1 OF 2 SHEETS STA. 1116+50 TO STA. 1122+50

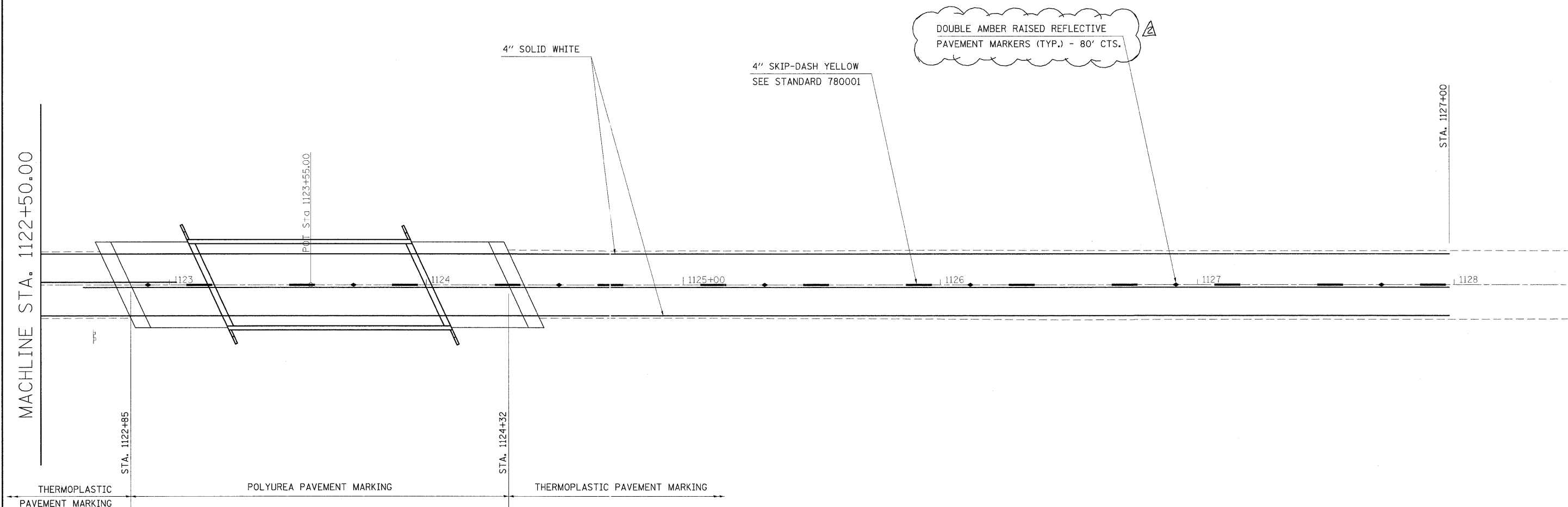

FILE NAME = c:\pw_work\pww\DOT\HARBAUGH\rd\dms51869\	USER NAME = herbaughrd	DESIGNED -	REVISED -	<b>STATE OF ILLINOIS DEPARTMENT OF TRANSPORTATION</b>	<b>PAVEMENT MARKING (SN 031-0042)</b>		F.A.P. RTE.	SECTION	COUNTY	TOTAL SHEETS	SHEET NO.
	tg01506_0026_13.dgn	DRAWN -	REVISED -				761	104-BR-2	GREENE	82	49
PLOT SCALE = 20.0000' / IN.	CHECKED -	REVISED -	SCALE: 20		SHEET NO. 2 OF 2 SHEETS	STA. 1122+50 TO STA. 1128+50	FED. ROAD DIST. NO. ILLINOIS FED. AID PROJECT		CONTRACT NO. 76987		
PLOT DATE = 2/6/2009	DATE -	REVISED -									

Rev. 2-18-09