

STATE OF ILLINOIS
DEPARTMENT OF TRANSPORTATION
DIVISION OF HIGHWAYS

**PROPOSED
HIGHWAY PLANS**

FAP ROUTE 322 (US 51)
SECTION D9 *PVMT* PRESERVATION FY09-2

UNION COUNTY
C-99-042-07

CONTRACT NO. 78017

F.A.P. RTE.	SECTION	COUNTY	TOTAL SHEETS	SHEET NO.
*	**	***	19	1

- * FAP 322 (US 51)
- ** D9 *PVMT* PRESERVATION FY09-2
- *** UNION COUNTY

D-99-040-07



FOR INDEX OF SHEETS, SEE SHEET NO. 3

ADT:
US 51 - 4050 (2005)
MU = 125
SU = 200
TRUCKS = 8%

EQUATION STATIONS: US 51
EQ. STA. 1047+55.55 (BK.) = STA. 52+01.25 (AH.)
EQ. STA. 103+30.75 (BK.) = STA. 103+86.85 (AH.)
EQ. STA. 118+04.60 (BK.) = STA. 2018+04.60 (AH.)
EQ. STA. 2081+73.95 (BK.) = STA. 187+61.39 (AH.)
EQ. STA. 240+04.17 (BK.) = STA. 3040+04.17 (AH.)
EQ. STA. 3101+03.20 (BK.) = STA. 304+62.66 (AH.)

OMISSION STATIONS:
STA. 3073+50 TO STA. 3075+71 (S.N. 091-0071)

TOWNSHIPS: ANNA, BALCOM

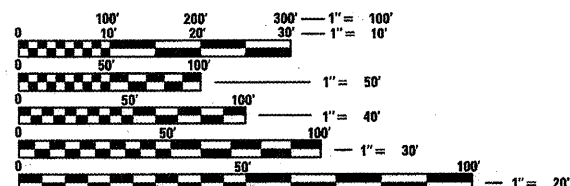

FULL SIZE PLANS HAVE BEEN PREPARED USING STANDARD ENGINEERING SCALES. REDUCED SIZED PLANS WILL NOT CONFORM TO STANDARD SCALES. IN MAKING MEASUREMENTS ON REDUCED PLANS, THE ABOVE SCALES MAY BE USED.

J.U.L.I.E.
JOINT UTILITY LOCATION INFORMATION FOR EXCAVATION
1-800-892-0123

CONTRACT NO. 78017

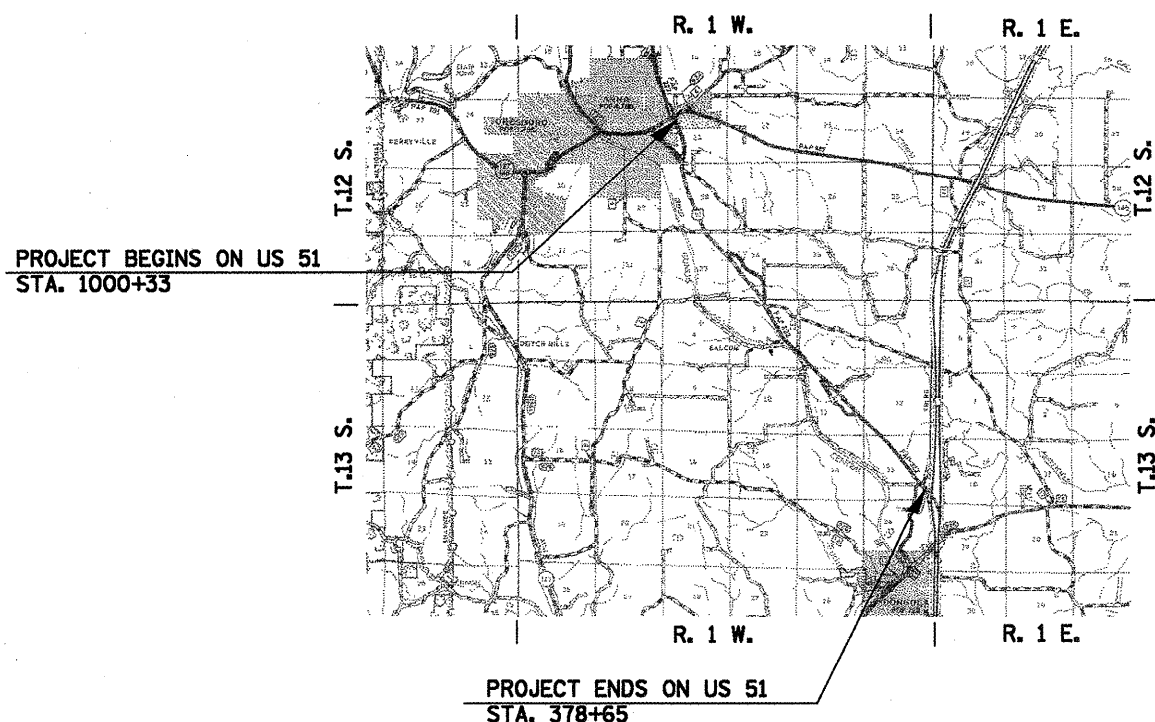

PROJECT LENGTH = 36,162.3 = 6.85 MILES

STATE OF ILLINOIS
DEPARTMENT OF TRANSPORTATION
DIVISION OF HIGHWAYS

SUBMITTED Nov 20 08
Way C. Rami
DEPUTY DIRECTOR OF HIGHWAYS, REGION ENGINEER

January 30 09
Charles J. Ingersoll
ENGINEER OF DESIGN AND ENVIRONMENT

January 30 09
Christine M. Reed
DIRECTOR OF HIGHWAYS, CHIEF ENGINEER

PRINTED BY THE AUTHORITY
OF THE STATE OF ILLINOIS