

F.A.P. RTE.	SECTION	COUNTY	TOTAL SHEETS	SHEET NO.
..	19	1

- FAP 322 (US 51)
- D9 PVMT PRESERVATION FY09-2
- UNION COUNTY

STATE OF ILLINOIS
DEPARTMENT OF TRANSPORTATION
DIVISION OF HIGHWAYS

**PROPOSED
HIGHWAY PLANS**

FAP ROUTE 322 (US 51)
SECTION D9 PVMT PRESERVATION FY09-2

UNION COUNTY
C-99-042-07

FOR INDEX OF SHEETS, SEE SHEET NO. 3

ADT:
US 51 - 4050 (2005)
MU = 125
SU = 200
TRUCKS = 8%

EQUATION STATIONS: US 51
EQ. STA. 1047+55.55 (BK.) = STA. 52+01.25 (AH.)
EQ. STA. 103+30.75 (BK.) = STA. 103+86.85 (AH.)
EQ. STA. 118+04.60 (BK.) = STA. 2018+04.60 (AH.)
EQ. STA. 2081+73.95 (BK.) = STA. 187+61.39 (AH.)
EQ. STA. 240+04.17 (BK.) = STA. 3040+04.17 (AH.)
EQ. STA. 3101+03.20 (BK.) = STA. 304+62.66 (AH.)

OMISSION STATIONS:
STA. 3073+50 TO STA. 3075+71 (S.N. 091-0071)

TOWNSHIPS: ANNA, BALCOM

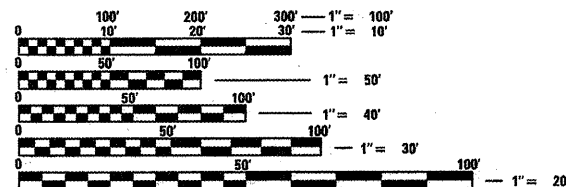

FULL SIZE PLANS HAVE BEEN PREPARED USING STANDARD ENGINEERING SCALES. REDUCED SIZED PLANS WILL NOT CONFORM TO STANDARD SCALES. IN MAKING MEASUREMENTS ON REDUCED PLANS, THE ABOVE SCALES MAY BE USED.

J.U.L.I.E.
JOINT UTILITY LOCATION INFORMATION FOR EXCAVATION
1-800-892-0123

CONTRACT NO. 78017

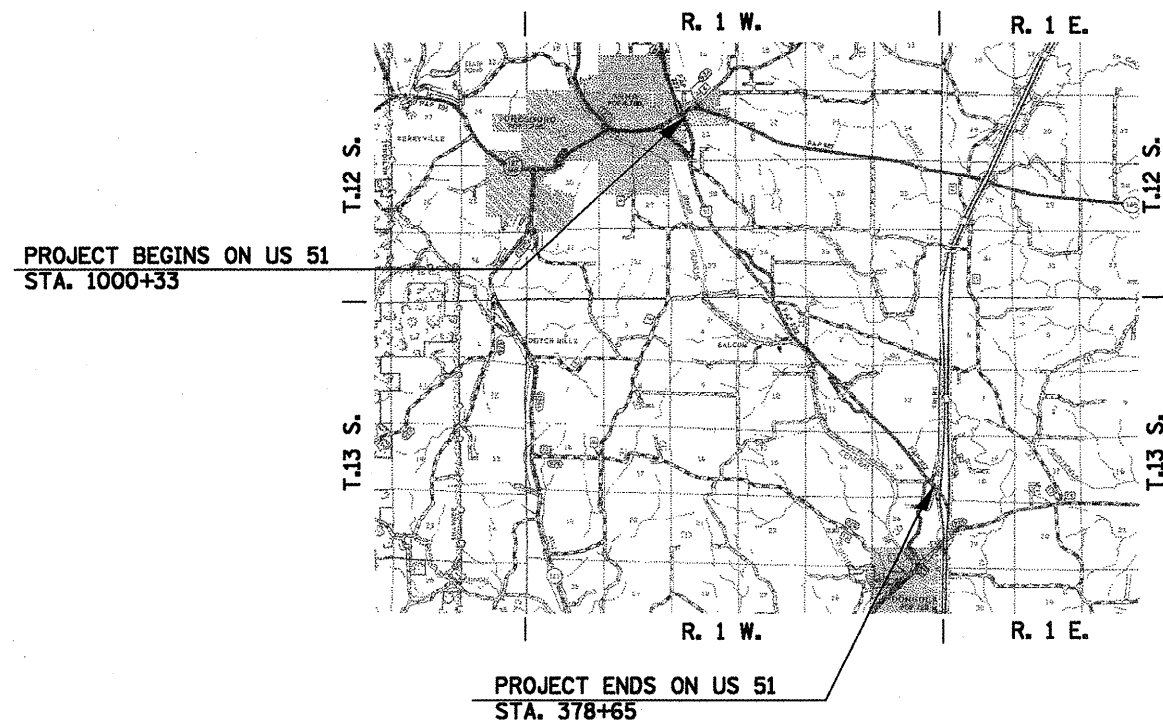

PROJECT LENGTH = 36,162.3 = 6.85 MILES

D-99-040-07

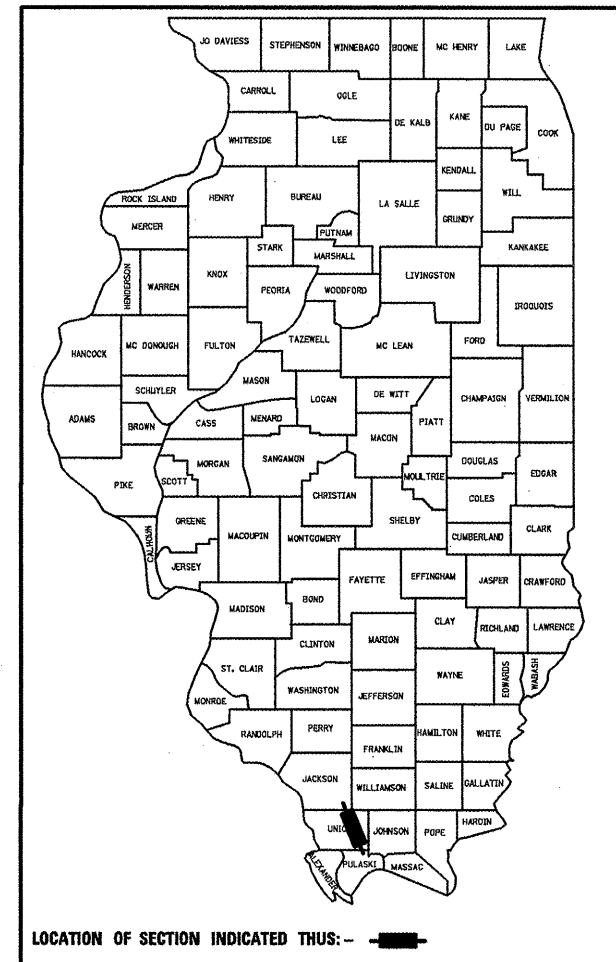

STATE OF ILLINOIS
DEPARTMENT OF TRANSPORTATION
DIVISION OF HIGHWAYS

SUBMITTED Nov 20 08
Way C. Hami
DEPUTY DIRECTOR OF HIGHWAYS, REGION ENGINEER

January 30 2009
Charles J. Ingersoll
ENGINEER OF DESIGN AND ENVIRONMENT

January 30 2009
Christine M. Reed
DIRECTOR OF HIGHWAYS, CHIEF ENGINEER

PRINTED BY THE AUTHORITY
OF THE STATE OF ILLINOIS

F.A.P. RTE.	SECTION	COUNTY	TOTAL SHEETS	SHEET NO.
*	**	***	19	2

STA. _____ TO STA. _____
 FED. ROAD DIST. NO. _____ ILLINOIS FED. AID PROJECT

- FAP 322 (US 51)
- D9 PAVEMENT PRESERVATION FY09-2
- UNION COUNTY

Prepared By:	<i>Jose Zdaniewicz</i> DISTRICT STUDIES & PLANS ENGINEER
Examined By:	<i>James Travis Emery</i> DISTRICT LAND ACQUISITION ENGINEER
Examined By:	<i>Carrie Nelson</i> DISTRICT PROGRAM DEVELOPMENT ENGINEER
Examined By:	<i>Kevin Hammer</i> DISTRICT OPERATIONS ENGINEER
Examined By:	<i>Jim Smother</i> DISTRICT CONSTRUCTION ENGINEER
Examined By:	<i>Bruce Trebbles</i> DISTRICT MATERIALS ENGINEER
Examined By:	<i>Jim Smother</i> DISTRICT PROJECT IMPLEMENTATION ENGINEER
Examined By:	<i>Dan Clayton</i> ASSISTANT REGIONAL ENGINEER
Approved By:	<i>Max Christie</i> DEPUTY DIRECTOR OF HIGHWAYS, REGION ENGINEER
	DATE <i>Nov 26</i> 20 <i>08</i>

PLOT DATE = 10/17/2008
 FILE NAME = c:\pva\work\pavdist\mason-dr\cma78017\MISC.DGN
 PLOT SCALE = 1/8"=1'-0"
 USER NAME = mason-dr

F.A.P. RTE.	SECTION	COUNTY	TOTAL SHEETS	SHEET NO.
*	**	***	19	3
STA. _____		TO STA. _____		
FED. ROAD DIST. NO. _____		ILLINOIS FED. AID PROJECT		

- FAP 322 (US 51)
- D9 PAVEMENT PRESERVATION FY09-2
- UNION COUNTY

INDEX OF SHEETS

SHEET NO.	DESCRIPTION
1	COVER SHEET
2	SIGNATURE BLOCK
3	INDEX OF SHEETS; HIGHWAY STANDARDS; STRUCTURE RATINGS; GENERAL NOTES
4	SUMMARY OF QUANTITIES
5 - 8	TYPICAL SECTIONS FOR FAP 322 (US 51)
9	RESURFACING SCHEDULE
10 - 11	PAVEMENT MARKING SCHEDULE
12	RAISED REFLECTIVE PAVEMENT MARKERS SCHEDULE
13	LOCATION MAP - FAP 322 (US 51) FROM INTERSECTION OF IL. 146 SOUTH TO I-57 CONNECTOR
14 - 17	DETAIL - PAVEMENT MARKING ON FAP 322 (US 51) FROM STA. 1000+33 TO STA. 1047+55.55.
18 - 19	DETAIL - PAVEMENT MARKING ON FAP 322 (US 51) FROM STA. 365+98 TO STA. 378+65.

HIGHWAY STANDARDS

701301-03	701901-01
701306-02	780001-02
701311-03	781001-03

STRUCTURE RATINGS

STRUCTURE NO.	INV. RATING	OPER. RATING	SUFF. RATING
FAP 322 (US 51) STA. 3074+60			
091-0071	27.7	44.5	93.8

GENERAL NOTES

FACTORS USED FOR ESTIMATING PLAN QUANTITIES ARE AS FOLLOWS AND SHALL NOT BE USED FOR THE BASIS OF FINAL QUANTITIES EXCEPT FOR QC/QA OF BITUMINOUS MIXTURES:

ALL BITUMINOUS CONCRETE.....2.016 TONS/CU.YD.
 ALL AGGREGATE.....2.05 TONS/CU.YD.

BITUMINOUS MATERIALS (PRIME COAT)
 ON PAVEMENT.....0.09 GAL/SQ YD

AGGREGATE (PRIME COAT).....0.0015 TONS/SQ. YD.

THE QUANTITY OF SHORT TERM PAVEMENT MARKING SHOWN IN THE PLANS WAS BASED ON ONE APPLICATION EACH FOR 1 LAYER FOR THE PRIME COAT AND 2 LAYERS OF SURFACE TREATMENT.

PRIOR TO PLACEMENT OF THE FINAL PAVEMENT MARKINGS THE RESIDENT ENGINEER SHOULD CONTACT THE BUREAU OF OPERATIONS AND ARRANGE FOR INSPECTION AND APPROVAL OF THE PAVEMENT MARKING LAYOUT.

THE CONTRACTOR SHALL PRESERVE EXISTING STAMPED STATIONING AS APPROVED BY THE ENGINEER IN THE FIELD.

THE AGGREGATE TO BE USED IN THE MICRO-SURFACING SHALL BE TYPE II APPLIED AT 20 LB/SQ YD.

BITUMINOUS MATERIAL (PRIME COAT) WILL BE REQUIRED AND SHALL BE APPLIED PRIOR TO PLACING THE MICRO-SURFACING AT A RATE OF 0.05 - 0.10 GAL/SQ. YD.

FIBER ASPHALT-CRACK FILLING SHALL ONLY BE PERFORMED ON CRACKS 3/8" WIDE AND GREATER. ALL CRACKS SHALL BE DRY AND FREE OF DIRT, VEGETATION, DEBRIS OR LOOSE FILLER BEFORE FILLING WITH THE FIBER-MODIFIED ASPHALT CRACK SEAL.

THE FRICTION AGGREGATE SHALL BE MIXTURE C.

F.A.P. RTE.	SECTION	COUNTY	TOTAL SHEETS	SHEET NO.
	**	***	19	6
STA. _____ TO STA. _____				
FED. ROAD DIST. NO. _____ ILLINOIS			FED. AID PROJECT	

FAP 322 (US 51)
TYPICALS

- FAP 322 (US 51)
- D9 PAVEMENT PRESERVATION FY09-2
- UNION COUNTY

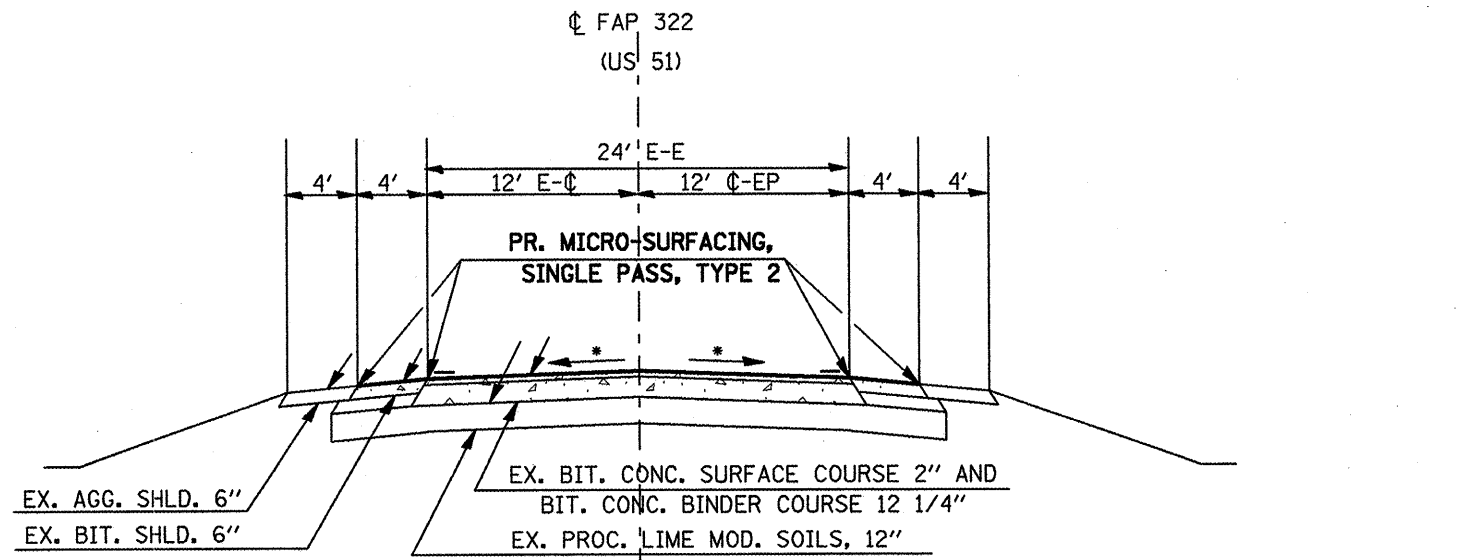

*MATCH EXISTING SLOPE.

TO BE USED:

- STA. 1010+23 TO STA. 1028+79 (1856.0')
- STA. 1044+78 TO STA. 1047+55.55 (277.55')
- STA. 52+01.25 TO STA. 103+30.75 (5129.5')
- STA. 103+86.85 TO STA. 118+04.60 (1417.75')
- STA. 2018+04.60 TO STA. 2081+73.95 (6369.35')
- STA. 187+61.39 TO STA. 240+04.17 (5242.78')

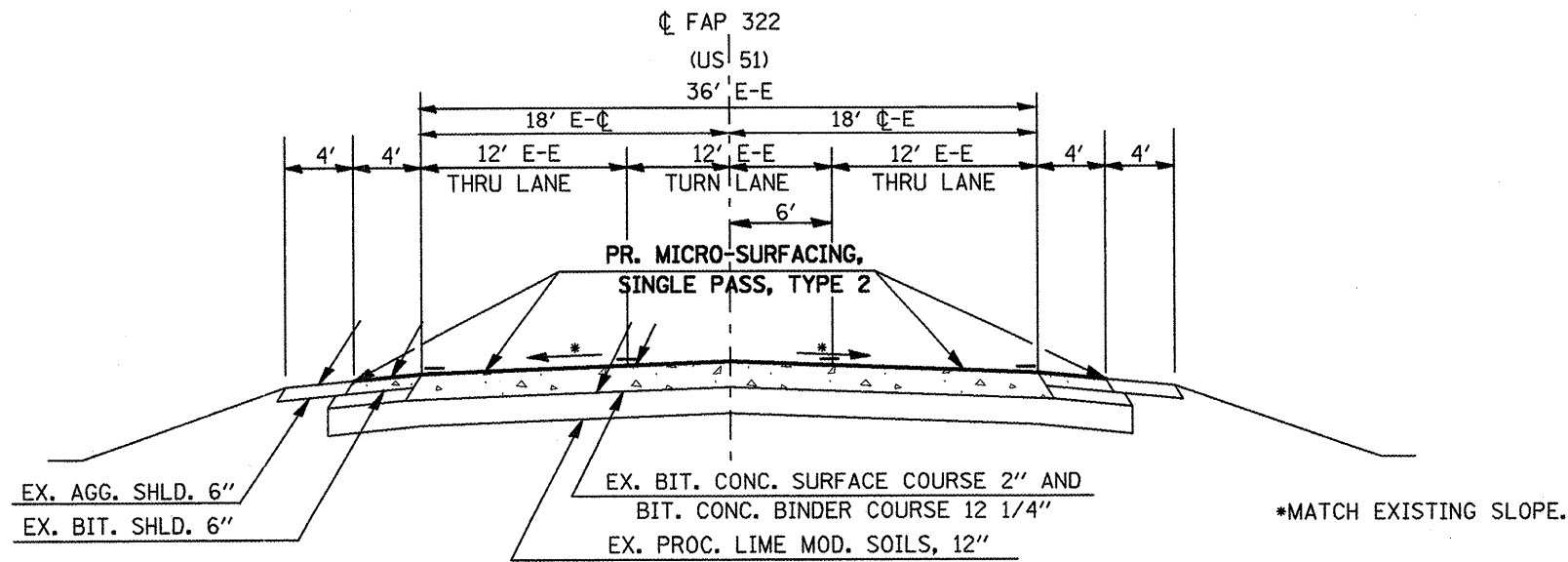

*MATCH EXISTING SLOPE.

TO BE USED:

- STA. 1031+10.21 TO STA. 1041+73 (1062.79')

PLOT DATE = 11/17/2009
 FILE NAME = s:\pav\work\us51\us51\us51.dwg
 PLOT SCALE = 1/8" = 1'-0"
 USER NAME = mcorcoran

F.A.P. RTE.	SECTION	COUNTY	TOTAL SHEETS	SHEET NO.
*	**	***	19	7
STA. _____		TO STA. _____		
FED. ROAD DIST. NO. _____		ILLINOIS FED. AID PROJECT		

- FAP 322 (US 51)
- ** D9 PAVEMENT PRESERVATION FY09-2
- *** UNION COUNTY

FAP 322 (US 51)
TYPICALS

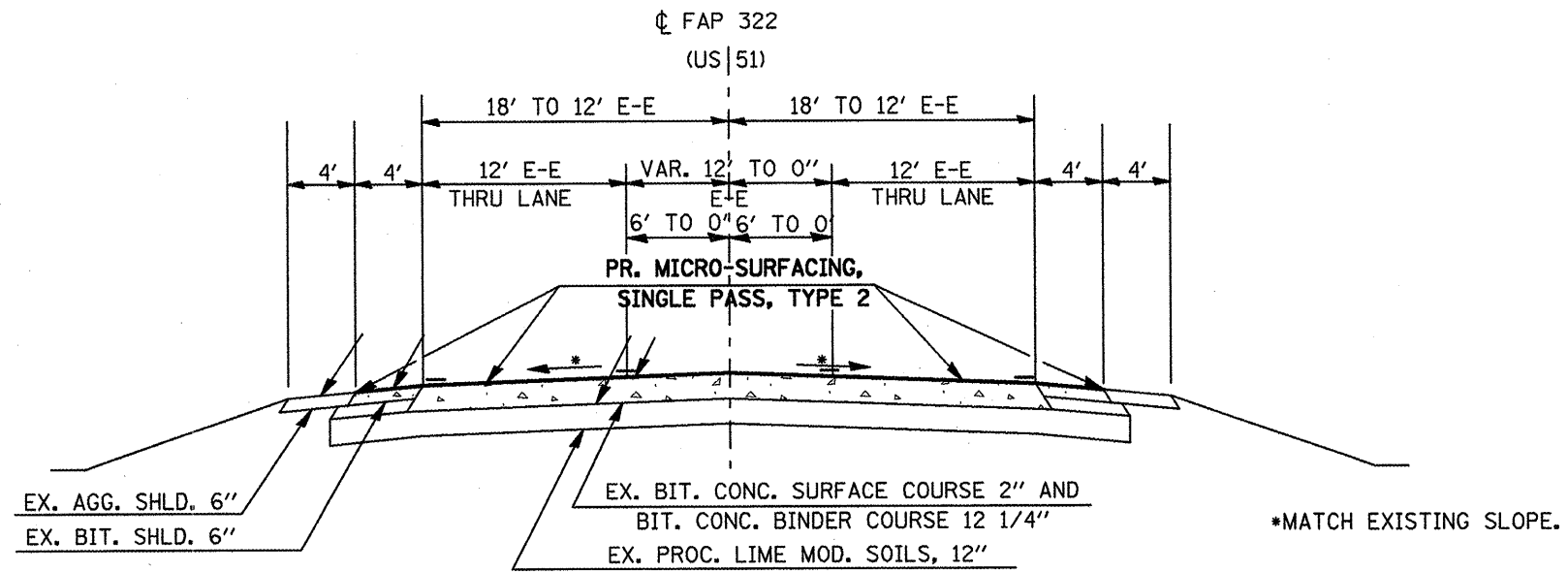

TO BE USED:
STA. 1041+73 TO STA. 1044+78 (305')

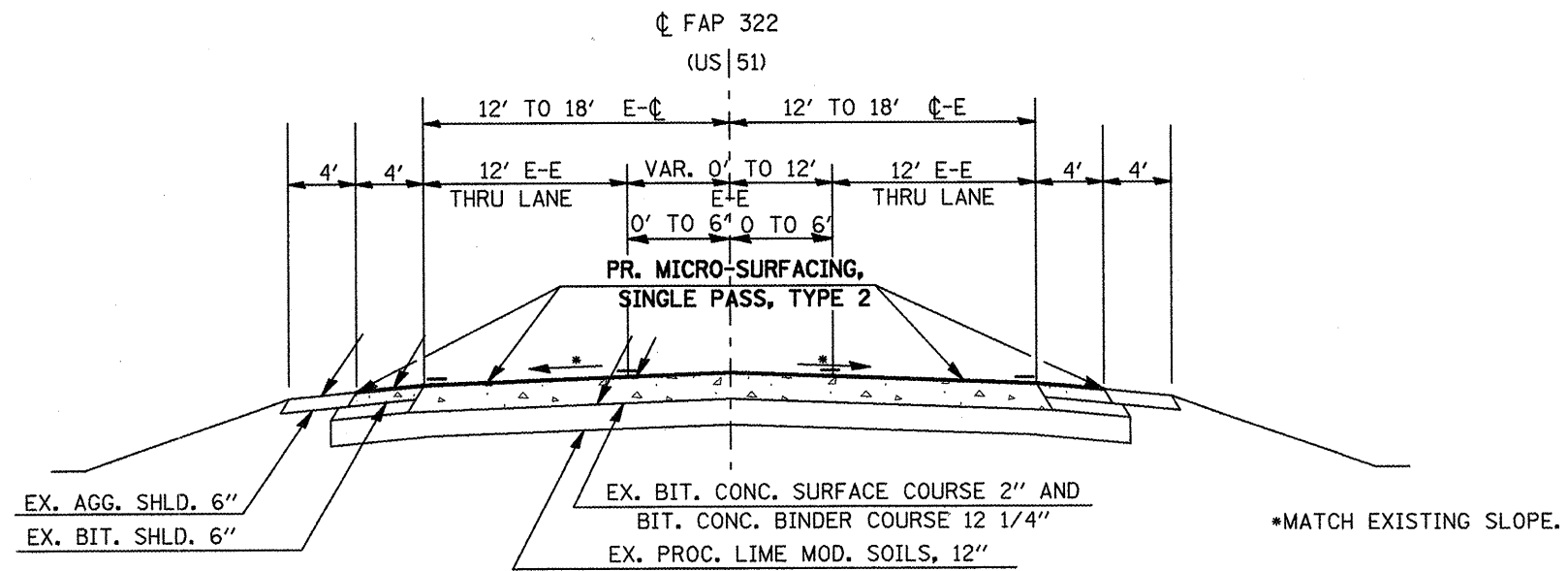

TO BE USED:
STA. 1028+79 TO STA. 1031+10.21 (231.21')

F.A.P. RTE.	SECTION	COUNTY	TOTAL SHEETS	SHEET NO.
*	**	***	19	8
STA. _____		TO STA. _____		
FED. ROAD DIST. NO. _____ ILLINOIS FED. AID PROJECT				

- FAP 322 (US 51)
- D9 PAVEMENT PRESERVATION FY09-2
- UNION COUNTY

FAP 322 (US 51)
TYPICALS

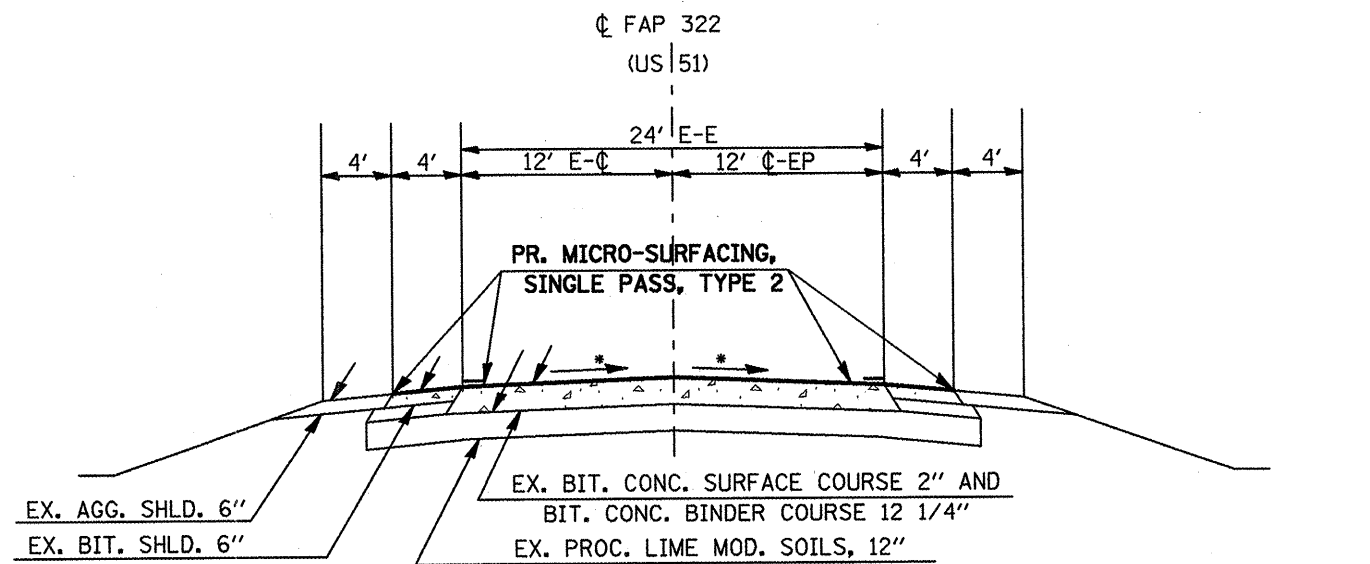

*MATCH EXISTING SLOPE.

TO BE USED:

- STA. 3040+04.17 TO STA. 3073+50 (3345.83')
- STA. 3075+71 TO STA. 3101+03.20 (2532.2')
- STA. 304+62.66 TO STA. 365+98 (6135.34')

EQUATION STATIONS:

- EQ. STA. 240+04.17 (BK.) = STA. 3040+04.17 (AH.)
- EQ. STA. 3101+03.20 (BK.) = STA. 304+62.66 (AH.)

OMISSION STATIONS:

- STA. 3073+50 TO STA. 3075+71 (S.N. 091-0071)

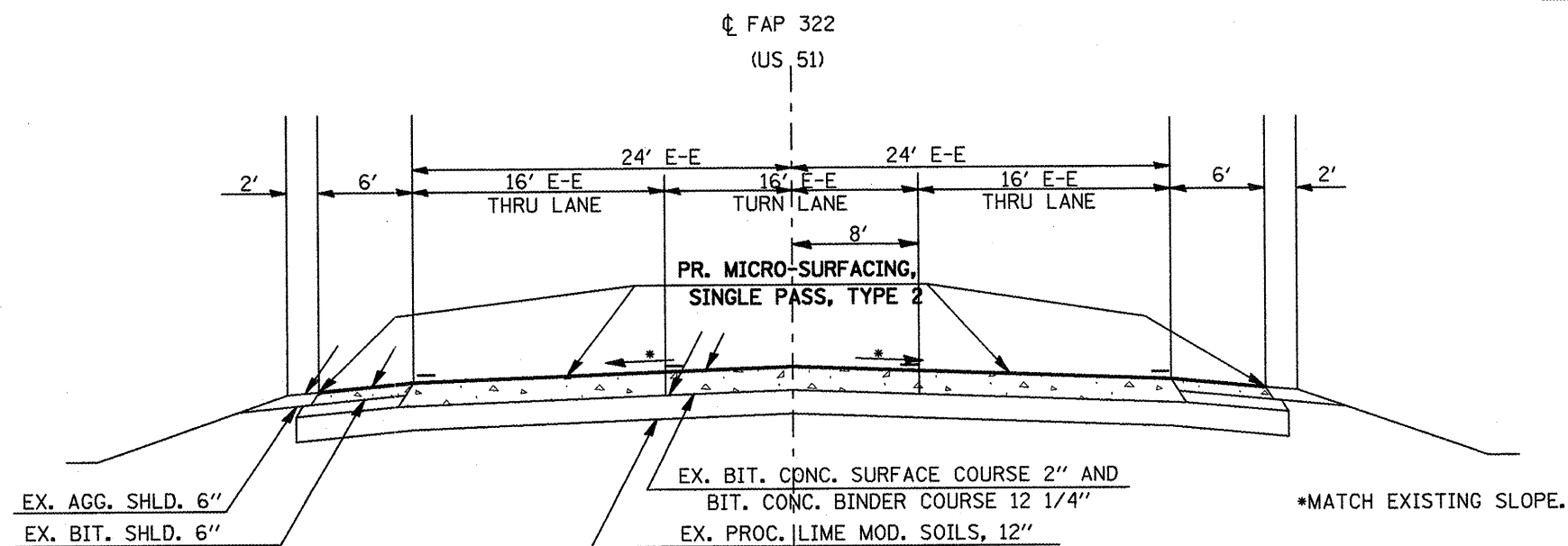

*MATCH EXISTING SLOPE.

TO BE USED:

- STA. 365+98 TO STA. 378+65 (1267.0')

PLOT DATE = 11/17/2008
 FILE NAME = c:\pav\work\pav\pav\msoor\dk\12m78888\NTSC.DGN
 PLOT SCALE = 1/8"=1'-0"
 USER NAME = msoor\dk

F.A.P. RTE.	SECTION	COUNTY	TOTAL SHEETS	SHEET NO.
*	**	***	19	9
STA. _____		TO STA. _____		
FED. ROAD DIST. NO. _____		ILLINOIS FED. AID PROJECT		

- * FAP 322 (US 51)
- ** 09 PAVEMENT PRESERVATION FY09-2
- *** UNION COUNTY

RESURFACING SCHEDULE

LOCATION - STATION TO STATION	LENGTH	ROADWAY WIDTH	ROADWAY AREA	SHOULDER WIDTH (FT)	MICRO-SURF. SINGLE PASS, TY. 2 SHOULDER AREA (SQ YD)	MICRO-SURF. SINGLE PASS, TY. 2 PAVEMENT AREA (SQ YD)	BIT. MATLS. (PR. CT.) (SEE NOTE 2) (GAL)	FIBER-MOD. ASPHALT CRK SEAL (SEE NOTE 1) (FOOT)	NOTES	
	FOR INFORMATIONAL PURPOSE ONLY									
	(FT)	(FT)	(SQ YD)							
FAP 322 (US 51)										
1000+33 TO 1005+83	550	42	2567	4.0	489	2,567	275.0	2,200	BIT. SHLDS.	
1000+33 TO 1010+23	990							990	LT. TURN LN. & MEDIAN ONLY	
1005+83 TO 1010+23	440	33	1613	4.0	391	1,613	180.4	1,760	BIT. SHLDS.	
1010+23 TO 1028+79	1856	24	4949	4.0	1650	4,949	593.9	7,424	BIT. SHLDS.	
1028+79 TO 1031+10	231	30	770	4.0	205	770	87.8	924	BIT. SHLDS.	
1031+10 TO 1041+73	1063	36	4252	4.0	945	4,252	467.7	4,252	BIT. SHLDS.	
1041+73 TO 1044+78	305	24	813	4.0	271	813	97.6	1,220	BIT. SHLDS.	
1044+78 TO 1047+56	278	24	741	4.0	247	741	89.0	1,112		
1028+79 TO 1044+78	1599							1,599	LT. TURN LN. & MEDIAN ONLY	
EQ. STA. 1047+55.55 (BK) = STA. 52+01.25 (AH)										
52+01.25 TO 103+30.75	5130	24	13,679	4.0	4560	13,679	1641.4	20,520	BIT. SHLDS.	
EQ. STA. 103+30.75 (BK) = STA. 103+86.85 (AH)										
103+86.85 TO 118+04.60	1418	24	3780.7	4.0	1260	3,781	453.7	5,672	BIT. SHLDS.	
EQ. STA. 118+04.60 (BK) = STA. 2018+04.60 (AH)										
2018+04.60 TO 2081+73.95	6369	24	16,985	4.0	5662	16,985	2038.2	25,477	BIT. SHLDS.	
EQ. STA. 2081+73.95 (BK) = STA. 187+61.39 (AH)										
187+61.39 TO 240+04.17	5243	24	13,981	4.0	4660	13,981	1677.7	20,356	BIT. SHLDS.	
EQ. STA. 240+04.17 (BK) = STA. 3040+04.17 (AH)										
3040+04.17 TO 3073+50	3346	24	8922	4.0	2974	8922	1070.7	13,383	BIT. SHLDS.	
SN 091-0071 OMISSION STA. 3073+50 TO STA. 3075+71										
3075+71 TO 3101+03.20	2532	24	6753	4.0	2251	6753	810.3	10129	BIT. SHLDS.	
EQ. STA. 3101+03.2 (BK) = STA. 304+62.66 (AH)										
304+62.66 TO 365+98	6135	24	16,361			16,361	1472.5	24541		
365+98 TO 378+65	1267	32	4505			4505	405.4	2534		
365+98 TO 371+98	600	8	533			533	48.0	600	TURN LANES	
371+98 TO 378+65	667	16	1186			1186	106.7	667	TURN LANES	
304+63 TO 365+98	6135			4.0	5453		490.8	12270	4' BIT. SHLDS.	
365+98 TO 378+65	1267			6.0	1689		47.1	2534	6' BIT. SHLDS.	
SUB TOTALS										
TOTALS										
						32,707	102,391	12054	160,165	
						135,098				

Note 1: Fiber-Mod. Asphalt Cr. Seal is calculated using 1 lb. of material per 2.8 lineal foot. Four (4) strips on US 51 locations through the length of the project and one (1) strip through median-left turn areas, unless otherwise noted on plans.

Note 2: Bituminous Materials (Prime Coat) quantity includes shoulder and pavement area.

PLOT DATE = 11/17/2008
 FILE NAME = c:\pwork\pav\resurf\unorder\un78017\RESURF.DGN
 USER NAME = hrcrcrcr

F.A.P. RTE.	SECTION	COUNTY	TOTAL SHEETS	SHEET NO.
*	**	***	19	11
STA. _____		TO STA. _____		
FED. ROAD DIST. NO. _____ ILLINOIS FED. AID PROJECT				

FAP 322 (US 51) PAVEMENT MARKING SCHEDULE
(CONT.)

- FAP 322 (US 51)
- D9 PAVEMENT PRESERVATION FY09-2
- UNION COUNTY

STATION TO STATION				PAINT PAVEMENT MARKING					THPL PAV'T MARKING	TEMPORARY				NOTES	
				4 INCH WHITE	4 INCH YELLOW	4 INCH SKIP-DASH YELLOW	12 INCH WHITE	24 INCH WHITE	LETTERS & SYMBOLS	4 INCH	12 INCH	24 INCH	LETTERS & SYMBOLS		
				FOOT	FOOT	FOOT	FOOT	FOOT	SQ FT	FOOT	FOOT	FOOT	SQ FT		
US 51															
	1000+50.0	TO	1010+23.0		3,892						3,892				NO PASSING ZONE
	1010+23.0	TO	1011+64.0		282						282				NO PASSING ZONE
	1027+93.0	TO	1028+79.0		172						172				NO PASSING ZONE
	1028+79.0	TO	1032+07.0		1312						1,312				NO PASSING ZONE
	1032+50.0	TO	1038+20.0		1140						1,140				NO PASSING ZONE
	1038+93.0	TO	1039+93.0		200						200				NO PASSING ZONE
	1039+93.0	TO	1044+78.0		1940						1,940				NO PASSING ZONE
LT	1044+78.0	TO	1047+55.6		278						278				NO PASSING ZONE
LT	52+01.3	TO	72+47.0		2046						2,046				NO PASSING ZONE
LT	81+81.0	TO	103+30.8		2150						2,150				NO PASSING ZONE
LT	103+86.9	TO	118+04.6		1418						1,418				NO PASSING ZONE
LT	2018+04.6	TO	2020+16.0		211						211				NO PASSING ZONE
LT	188+59.0	TO	238+19.0		4960						4,960				NO PASSING ZONE
RT	1044+78.0	TO	1047+55.6		278						278				NO PASSING ZONE
RT	52+01.3	TO	64+21.6		1220						1,220				NO PASSING ZONE
RT	71+91.0	TO	103+30.8		3140						3,140				NO PASSING ZONE
RT	103+86.9	TO	116+31.0		1244						1,244				NO PASSING ZONE
RT	2071+57.0	TO	2081+74.0		1017						1,017				NO PASSING ZONE
RT	187+61.4	TO	227+16.0		3955						3,955				NO PASSING ZONE
LT	3051+50.0	TO	3069+31.0		1,781						1,781				NO PASSING ZONE
LT	3097+65.0	TO	313+29.0		1,205.0						1,205				NO PASSING ZONE
LT	331+78.0	TO	344+85.0		1,307.0						1,307				NO PASSING ZONE
LT	365+98.0	TO	366+98.0		100.0						100				NO PASSING ZONE
LT	366+98.0	TO	373+78.0		1,360.0						1,360				NO PASSING ZONE
LT	373+78.0	TO	374+78.0		200.0						200				NO PASSING ZONE
LT	375+73.0	TO	376+73.0	100.0							100				LEFT TURN LANE
RT	3041+83.0	TO	3058+28.0		1,645.0						1,645				NO PASSING ZONE
RT	3087+30.0	TO	3098+84.0		1,154.0						1,154				NO PASSING ZONE
RT	321+09.0	TO	334+67.0		1,358.0						1,358				NO PASSING ZONE
RT	365+98.0	TO	366+98.0		100.0						100				
RT	366+98.0	TO	373+78.0		1,360.0						1,360				
RT	366+98.0	TO	373+78.0				310.0					310.0			NO PASSING ZONE
RT	373+78.0	TO	374+78.0	100.0			24.0				100		24.0		LEFT TURN LANE
RT	375+73.0	TO	376+73.0		200.0		24.0				200		24.0		NO PASSING ZONE
RT	376+73.0	TO	378+65.0		768.0		81.0				768		81.0		NO PASSING ZONE
LT	1001+17.0													15.6	LT TURN ARROW
LT	1001+45.0													20.8	"ONLY"
LT	1002+67.0													15.6	LT TURN ARROW
LT	1002+95.0													20.8	"ONLY"
LT	1034+06.0													15.6	LT TURN ARROW
LT	1034+34.0													20.8	"ONLY"
RT	1037+30.0													20.8	"ONLY"
RT	1037+58.0													15.6	LT TURN ARROW
LT	1039+47.0													15.6	LT TURN ARROW
LT	1039+75.0													20.8	"ONLY"
RT	373+88.0													20.8	"ONLY"
RT	374+16.0													15.6	LT TURN ARROW
LT	376+27.0													15.6	LT TURN ARROW
LT	376+55.0													20.8	"ONLY"
SUB-TOTALS				200	43,392	0	439	0	254.8		43,592	439	0	254.8	
SUB-TOTAL FROM PREVIOUS PAGE				72,302	0	5,326	694	66	182.0		77,628	694	66	182.0	
TOTALS					121,220		1133	66	436.8		121,220	1,133	66	436.8	

PLOT DATE = 11/17/2008
 FILE NAME = c:\pwworkspace\mcd\mcd\us51\us51.dgn
 PLOT SCALE = 1/8"=1'-0"
 USER NAME = mcdmcd

F.A.R. RTE.	SECTION	COUNTY	TOTAL SHEETS	SHEET NO.
*	**	***	19	12
STA. _____		TO STA. _____		
FED. ROAD DIST. NO. _ ILLINOIS FED. AID PROJECT				

- FAP 322 (US 51)
- D9 PAVEMENT PRESERVATION FY09-2
- UNION COUNTY

RAISED REFLECTIVE PAVEMENT MARKERS SCHEDULE

STATION TO STATION				RAISED REF PAVT MARKERS			NOTES
				CLEAR - ONE WAY	AMBER - ONE WAY	AMBER - TWO WAY	
				EACH	EACH	EACH	
US 51 - STA. 1000+33 TO STA. 378+65							
	1000+34.0	TO	1000+46.0	3			PAINTED ISLAND
LT	1000+44.0	TO	LT 1003+13.0	8			LANE LINE
RT	1000+41.0	TO	RT 1000+56.0	3			PAINTED ISLAND
	1000+50.0	TO	1010+23.0		53		MEDIAN
	1010+23.0	TO	1011+64.0			8	CENTERLINE
	1011+64.0	TO	1027+93.0			21	CENTERLINE
	1027+93.0	TO	1028+79.0			6	CENTERLINE
	1028+79.0	TO	1032+07.0		20		MEDIAN
RT	1032+50.0	TO	LT 1038+20.0			32	MEDIAN
LT	1032+50.0	TO	LT 1034+50.0	4			LANE LINE
RT	1037+20.0	TO	RT 1038+20.0	6			LANE LINE
LT	1038+93.0	TO	LT 1039+93.0	4			LANE LINE
RT	1038+93.0	TO	RT 1039+93.0			8	
RT	1039+93.0	TO	1044+78.0		22		MEDIAN
	1044+78.0	TO	1047+55.6			16	
EQ STA 1047+55.55 (BK) = STA 52+01.25 (AH)							
	52+01.3	TO	64+21.6			63	CENTERLINE
	64+21.6	TO	81+81.0			23	CENTERLINE
	81+81.0	TO	103+30.8			28	CENTERLINE
EQ STA 103+30.75 (BK) = STA. 103+86.85 (AH)							
	103+86.9	TO	116+31.0			17	
	116+31.0	TO	118+04.6			3	CENTERLINE
EQ STA 118+04.60 (BK.) = STA. 2018+04.60 (AH.)							
	2018+04.6	TO	2081+74.0			81	CENTERLINE
EQ STA 2081+73.95 (BK) = STA 187+61.39 (AH)							
	187+61.4	TO	240+04.2			67	CENTERLINE
EQ STA 3040+04.17 (BK) = STA 3073+50 (S.N. 091-0071)							
	3040+04.2	TO	3073+50.0			43	CENTERLINE
OMIT S.N. 091-0071 STA. 3073+50 TO STA. 3075+71							
	3075+71.0	TO	3101+03.2			33	CENTERLINE
EQ STA 3101+03.02 (BK) = STA. 304+62.66 (AH)							
	304+62.7	TO	365+98.0			78	CENTERLINE
	365+98.0	TO	366+98.0			10	CENTERLINE
	366+98.0	TO	LT 374+78.0		36		MEDIAN
RT	373+78.0	TO	RT 374+78.0	4			LANE LINE
LT	375+73.0	TO	LT 376+73.0	4			
RT	375+73.0	TO	378+65.0		18		MEDIAN
SUBTOTAL				36	149	535	
TOTAL					720		

PLOT DATE = 11/17/2008
 FILE NAME = c:\pwworkspace\mccorder\mccorder\78017\MISC.DGN
 PLOT SCALE = 1/8"=1'-0"
 USER NAME = mccorder

F.A.P. RTE.	SECTION	COUNTY	TOTAL SHEETS	SHEET NO.
322	02	003	19	14
STA. 1000+00 TO STA. 1010+44		FED. ROAD DIST. NO. - ILLINOIS FED. AID PROJECT		

- FAP 322 (US 51)
- D9 PAVEMENT PRESERVATION FY09-2
- UNION COUNTY



DETAIL OF LANE WIDTHS

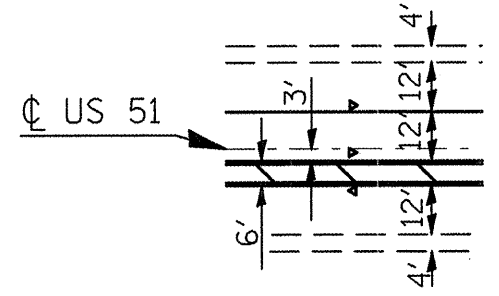

PAVEMENT MARKING DETAIL
FAP 322 (US 51)
STA. 1000+33 TO STA. 1010+44

PAINTED ISLAND DETAIL
SOUTHEAST QUAD

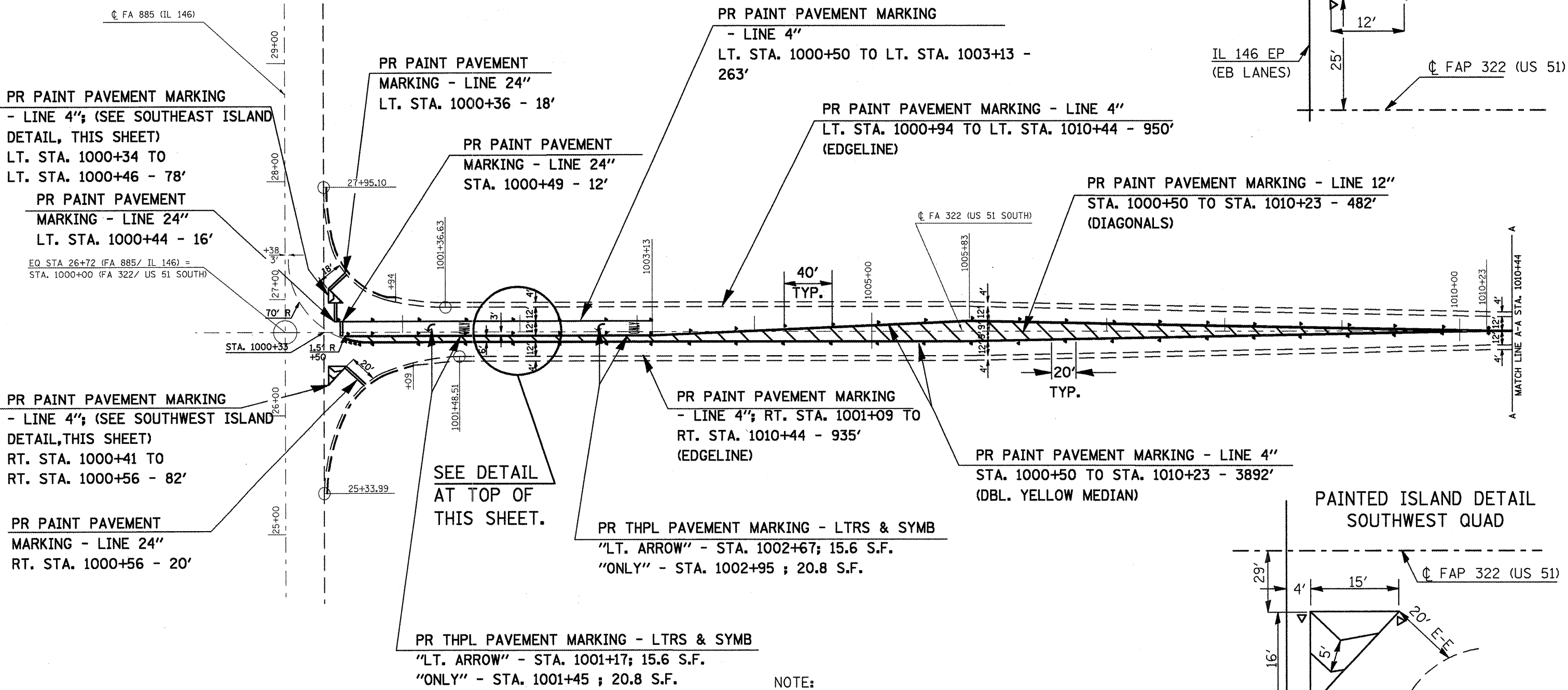
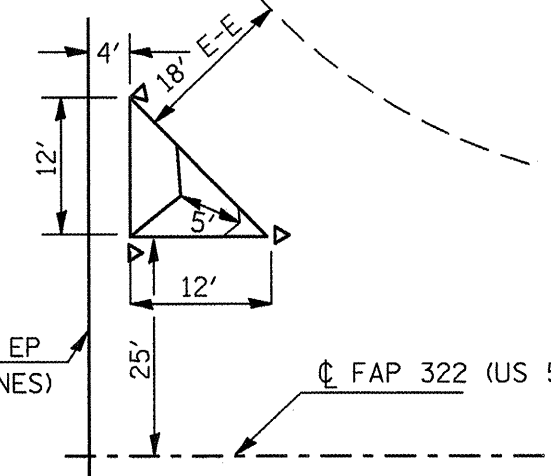

PAINTED ISLAND DETAIL
SOUTHWEST QUAD

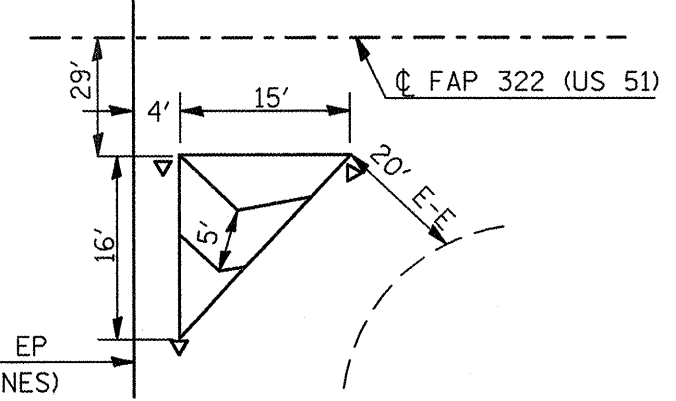

NOTE:
FOR RAISED REFLECTIVE PAVEMENT MARKERS,
SEE SCHEDULE ON SHEET 14.

PLOT DATE = 11/17/2009
 FILE NAME = \\va-ws-01\users\jdo\work\78017\14.dgn
 PLOT SCALE = 84.7859 / IN.
 USER NAME = jdo

F.A.B. RTE.	SECTION	COUNTY	TOTAL SHEETS	SHEET NO.
•	••	•••	19	15
STA. _____		TO STA. _____		
FED. ROAD DIST. NO. _____		ILLINOIS FED. AID PROJECT		

PAVEMENT MARKING DETAIL
 FAP 322 (US 51)
 STA. 1010+44 TO STA. 1022+39

- FAP 322 (US 51)
- D9 PAVEMENT PRESERVATION FY09-2
- UNION COUNTY

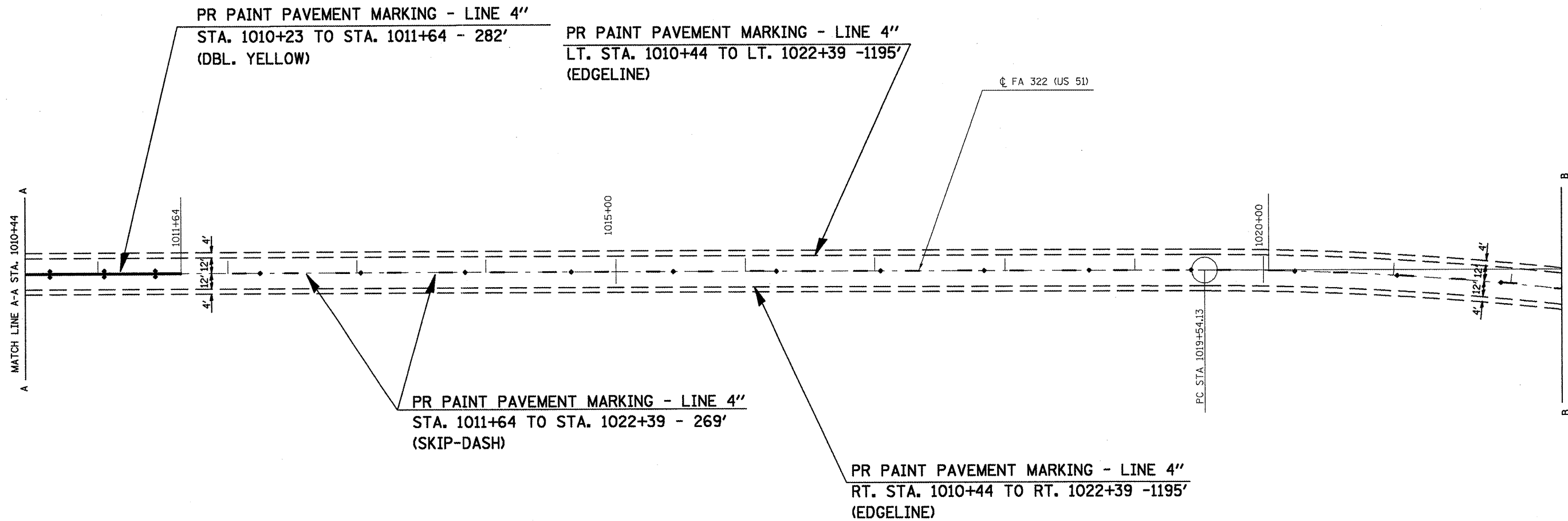

NOTE:
 FOR RAISED REFLECTIVE PAVEMENT MARKERS,
 SEE SCHEDULE ON SHEET 14.

PLOT DATE = 11/17/2009
 USER NAME = mrcorndr

F.A.P. RTE.	SECTION	COUNTY	TOTAL SHEETS	SHEET NO.
*	**	***	19	16
STA. _____		TO STA. _____		
FED. ROAD DIST. NO. _____		ILLINOIS FED. AID PROJECT		

PAVEMENT MARKING DETAIL
 FAP 322 (US 51)
 STA. 1022+39 TO STA. 1036+00

- FAP 322 (US 51)
- D9 PAVEMENT PRESERVATION FY09-2
- UNION COUNTY

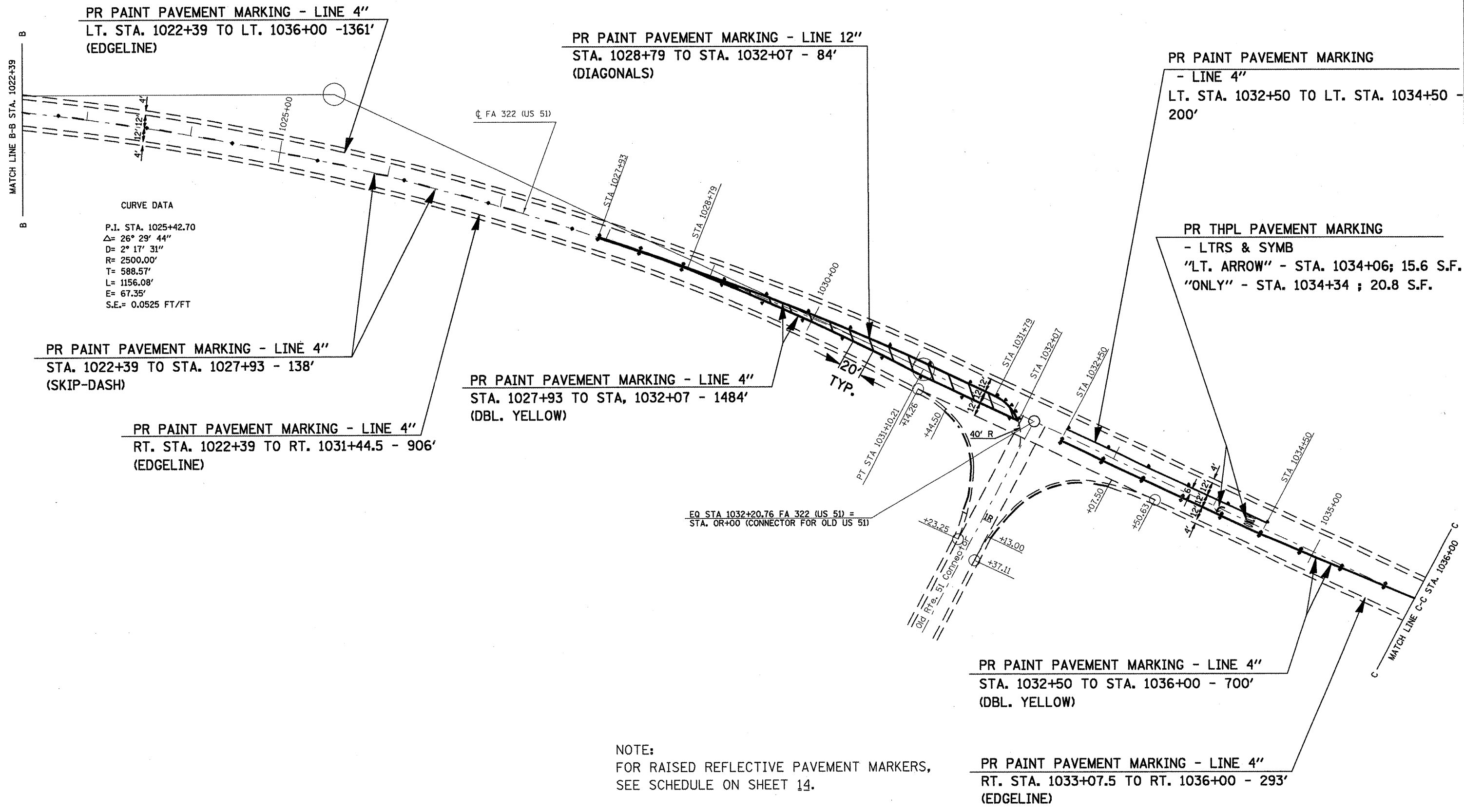

PLOT DATE = 11/17/2009
 FILE NAME = \\sundev\work\proj\1022+39\1022+39.dwg
 PLOT SCALE = 8.7883 / IN.
 USER NAME = mcorcor

F.A.P. RTE.	SECTION	COUNTY	TOTAL SHEETS	SHEET NO.
*	**	***	19	17
STA. _____ TO STA. _____				
FED. ROAD DIST. NO. - ILLINOIS FED. AID PROJECT				

PAVEMENT MARKING DETAIL
 FAP 322 (US 51)
 STA. 1036+00 TO STA. 1047+55.55

- FAP 322 (US 51)
- D9 PAVEMENT PRESERVATION FY09-2
- UNION COUNTY

PR PAINT PAVEMENT MARKING - LINE 4"
 STA. 1036+00 TO STA. 1038+20 - 440'
 (DBL. YELLOW)

PR PAINT PAVEMENT MARKING - LINE 4"
 LT. STA. 1036+00 TO LT. STA. 1038+00 - 200'
 (EDGE LINE)

PR THPL PAVEMENT MARKING
 - LTRS & SYMB
 "ONLY" - STA. 1037+30 ; 20.8 S.F.
 "LT. ARROW" - STA. 1037+58; 15.6 S.F.

CURVE DATA
 P.I. STA. 1043+13.91
 $\Delta = 20^\circ 27' 49''$
 $D = 2^\circ 17' 31''$
 $R = 2500.00'$
 $T = 451.26'$
 $L = 892.90'$
 $E = 40.40'$
 $S.E. = 0.0525 \text{ FT/FT}$

PR PAINT PAVEMENT MARKING
 - LINE 4"
 LT. STA. 1038+93 TO LT. STA. 1039+93 - 100'

PR PAINT PAVEMENT MARKING - LINE 4"
 LT. STA. 1039+12 TO LT. STA. 1047+55.55 - 844'
 (EDGE LINE)

PR PAINT PAVEMENT MARKING - LINE 4"
 STA. 1038+93 TO STA. 1047+55.55 - 2418'
 (DBL. YELLOW MEDIAN)

PR PAINT PAVEMENT MARKING - LINE 4"
 RT. STA. 1037+20 TO RT. STA. 1038+20 - 100'

PR PAINT PAVEMENT MARKING - LINE 4"
 RT. STA. 1036+00 TO RT. STA. 1037+95 - 195'
 (EDGE LINE)

PR THPL PAVEMENT MARKING
 - LTRS & SYMB
 "LT. ARROW" - STA. 1039+47; 15.6 S.F.
 "ONLY" - STA. 1039+75 ; 20.8 S.F.

PR PAINT PAVEMENT MARKING - LINE 12"
 STA. 1039+93 TO STA. 1044+78 - 128'
 (DIAGONALS)

PR PAINT PAVEMENT MARKING - LINE 4"
 RT. STA. 1039+14 TO RT. STA. 1047+55.55 - 842'
 (EDGE LINE)

NOTES:
 FOR RAISED REFLECTIVE PAVEMENT MARKERS,
 SEE SCHEDULE ON SHEET 14.
 FOR PAVEMENT MARKING BEYOND
 STATION 52+01.25,
 SEE SCHEDULE ON SHT. 12.

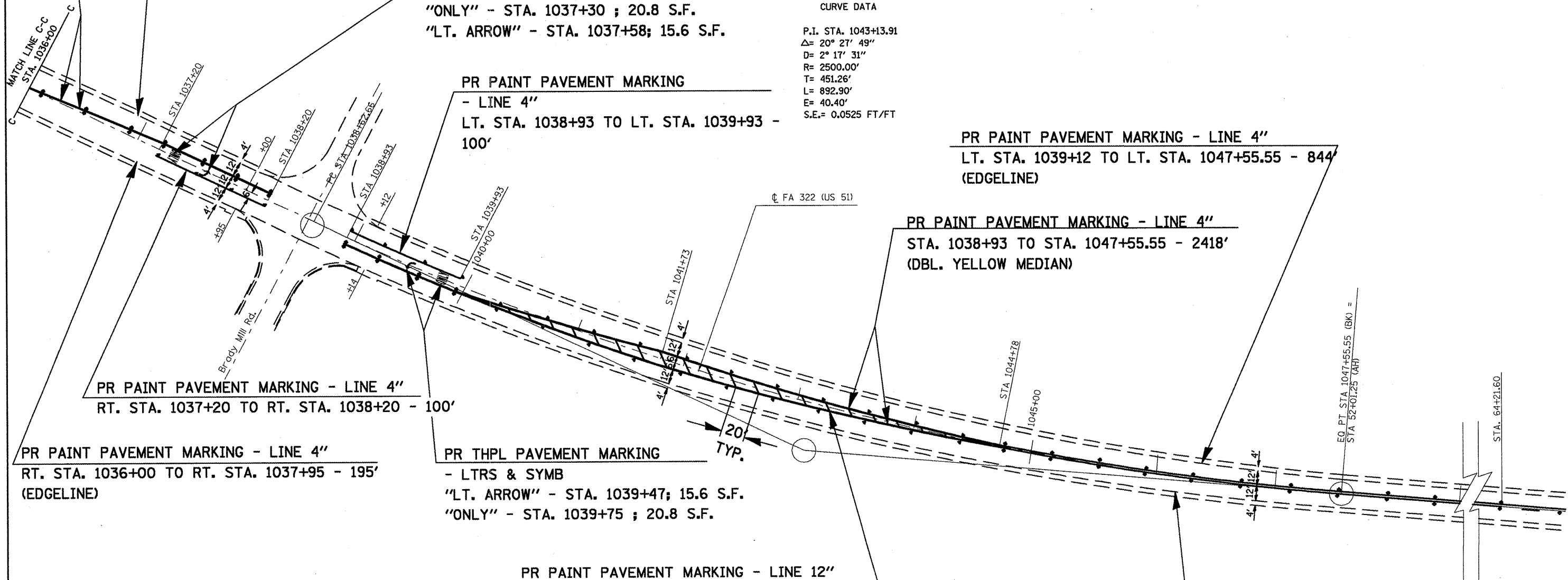

PLOT DATE = 11/17/2009
 PLOT SCALE = 1" = 40'
 USER NAME = masonrdr

F.A.P. RTE.	SECTION	COUNTY	TOTAL SHEETS	SHEET NO.
•	••	•••	19	19
STA. _____		TO STA. _____		
FED. ROAD DIST. NO. _____ ILLINOIS FED. AID PROJECT				

- FAP 322 (US 51)
- D9 PAVEMENT PRESERVATION FY09-2
- UNION COUNTY

PAVEMENT MARKING DETAIL
 FAP 322 (US 51)
 STA. 365+98 TO STA. 378+65

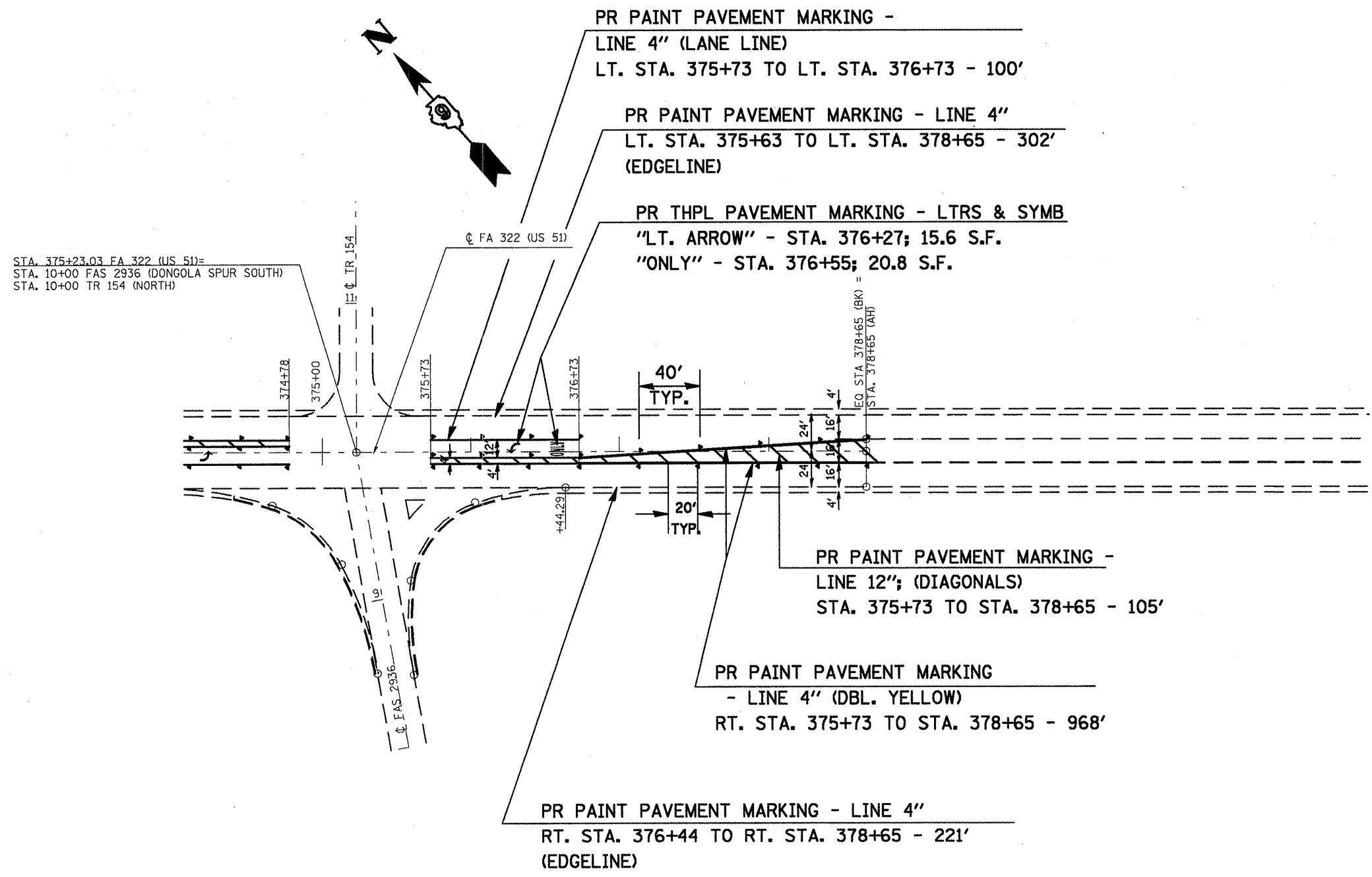

NOTE:
 FOR RAISED REFLECTIVE PAVEMENT MARKERS,
 SEE SCHEDULE ON SHEET 14.

PLT DATE = 11/17/2009
 USER = mscor
 USER NAME = mscor