

F.A.P. RTE.	SECTION	COUNTY	TOTAL SHEETS	SHEET NO.
328	109RS-2	WHITE	15	1

STATE OF ILLINOIS
DEPARTMENT OF TRANSPORTATION
DIVISION OF HIGHWAYS

PROPOSED HIGHWAY PLANS

FAP 328 (US 45)
SECTION 109RS-2
PROJECT NO. ACF-0328(025)
WHITE COUNTY
C-99-052-08

FOR INDEX OF SHEETS, SEE SHEET NO. 3
FOR SUMMARY OF QUANTITIES, SEE SHEET NO. 4

STATION EQUATIONS

STA EQ 163+35.9 @ BK = STA 163+39.7 @ AH
STA EQ 174+35.3 @ BK = STA 174+53.5 @ AH
STA EQ 238+92.8 @ BK = STA 238+95.9 @ AH
STA EQ 277+14.2 @ BK = STA 277+69.1 @ AH
STA EQ 303+08.5 @ BK = STA 304+13.3 @ AH

TRAFFIC DATA

US 45 TRAFFIC DATA
2005 ADT = 1,800 WITH 21% TRUCKS

TOWNSHIPS

INDIAN CREEK
ENFIELD



APPROXIMATE SCALE

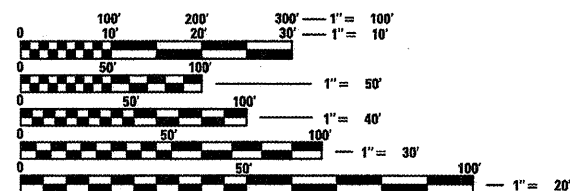

FULL SIZE PLANS HAVE BEEN PREPARED USING STANDARD ENGINEERING SCALES. REDUCED SIZED PLANS WILL NOT CONFORM TO STANDARD SCALES. IN MAKING MEASUREMENTS ON REDUCED PLANS, THE ABOVE SCALES MAY BE USED.

J.U.L.I.E.
JOINT UTILITY LOCATION INFORMATION FOR EXCAVATION
1-800-892-0123 or www.julie1call.com

CONTRACT NO. 78066

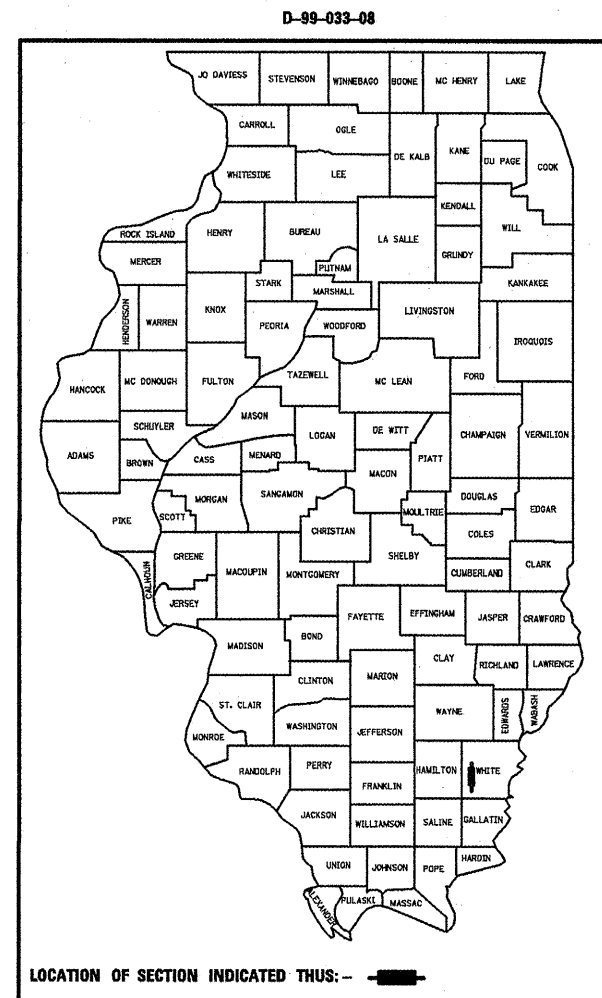

LOCATION OF SECTION INDICATED THUS: - [black rectangle] -

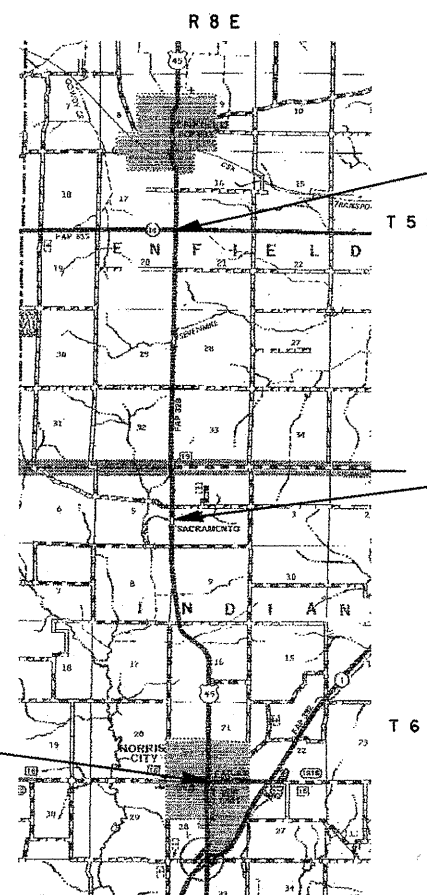

PROPOSED IMPROVEMENT
FAP 328 (US 45)
SECTION 109RS-2
WHITE COUNTY
BEGINS STA. 0+60.00

GAP IMPROVEMENT
STRUCTURE NUMBER 097-2007
STA. 193+82.0 TO STA. 194+24.0

PROPOSED IMPROVEMENT
FAP 328 (US 45)
SECTION 109RS-2
WHITE COUNTY
ENDS STA. 381+90.00

GROSS LENGTH OF PROJECT = 37,908.20 FT = 7.180 MILES
NET LENGTH OF PROJECT = 37,836.20 FT = 7.166 MILES

STATE OF ILLINOIS
DEPARTMENT OF TRANSPORTATION
DIVISION OF HIGHWAYS

SUBMITTED *Dec 2 2008*
Min [Signature]
DEPUTY DIRECTOR OF HIGHWAYS, REGION ENGINEER

January 30 2009
Charles J. Ingersoll
ENGINEER OF DESIGN AND ENVIRONMENT

January 30 2009
Christine M. Reed
DIRECTOR OF HIGHWAYS, CHIEF ENGINEER

PRINTED BY THE AUTHORITY
OF THE STATE OF ILLINOIS